

# Blacksmith Fork Park Master Plan

## Introduction

This master plan will direct the continued development of Blacksmith Fork Park in Hyrum, Utah. The park is an opportunity to add amenities like baseball/softball fields, a skate-park, BMX pump track, and community garden to the city.

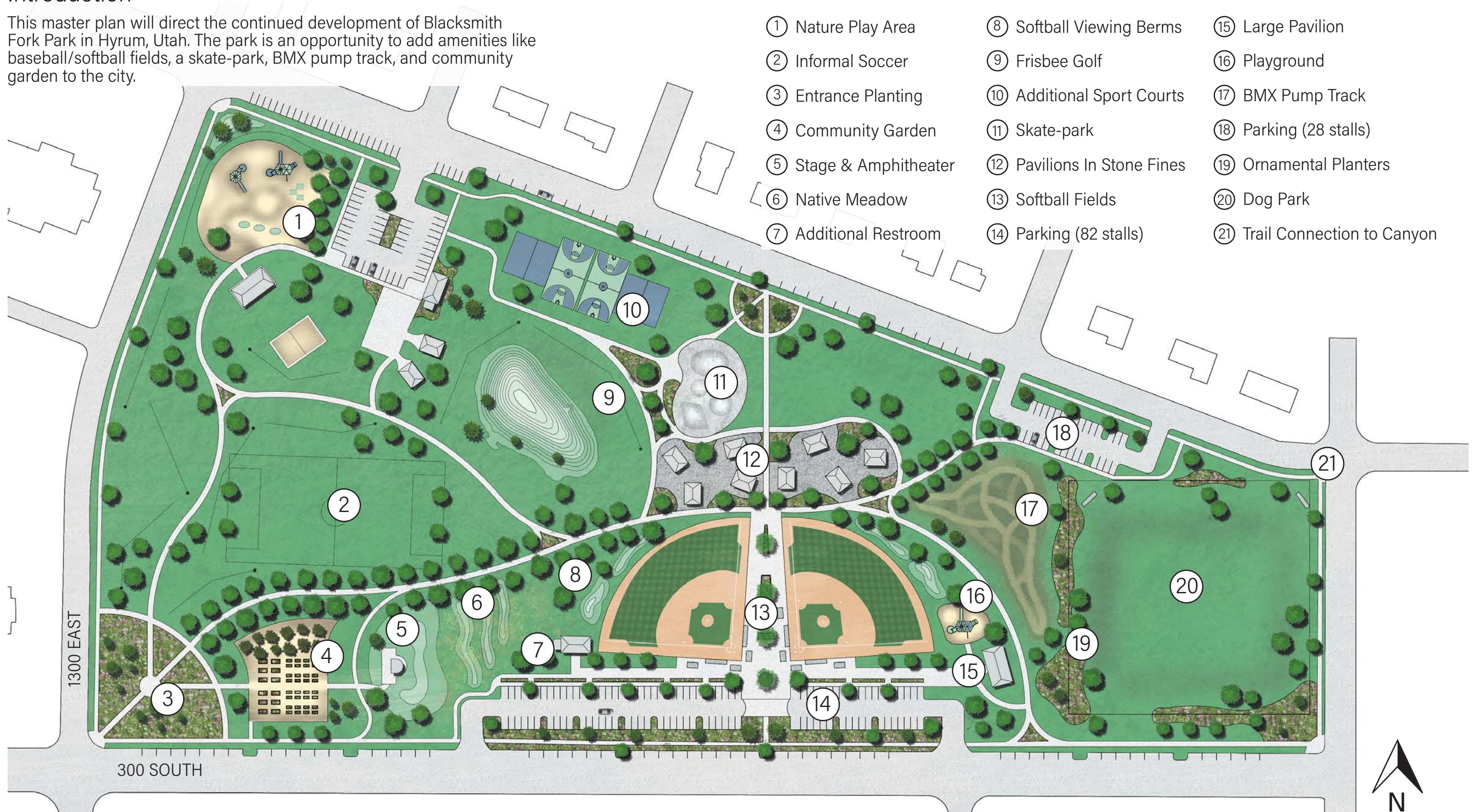

# Blacksmith Fork Park

## Playgrounds

---

### Nature Play/Inclusive Play

Children love to explore and create their own fun and nature play is the perfect way to allow them to do so. Almost any safe structure can be used as nature play, this means for an inexpensive play space that help kids boost their creative mind and test their physical abilities. The master plan proposes adding an ADA accessible playground on the East side of the park near the softball fields.



# Blacksmith Fork Park Gardens

## Community Garden & Dry Demonstration Garden

The main entrance to the park will be on the corner of 3rd S and 1300 E. At the entrance is an ornamental planting bed planted with native and climate adapted plants. There will be many flowering shrubs and perennials to showcase how beautiful and functional low water use landscapes can be as well as create a comfortable and interesting entrance to the park. The community garden will have raised garden beds to be maintained and harvested by Hyrum City residents as well as a small orchard of fruit trees.



# Blacksmith Fork Park Amphitheater

---

## Stage & Amphitheater

The amphitheater is designed to be used for community events like concerts, plays and other gatherings. The seating is a large semi-circular turf berm. Audience members can lay out blankets, use lawn chairs with the back legs shortened, or just sit on the grass. The berm could potentially be graded to include steps for flat seating areas if desired.



# Blacksmith Fork Park

## Native Meadow

### Wildflowers & Native Grasses

The area between the amphitheater and softball fields is designed to be a look into the history of Cache Valley as well as a peek into the wild areas up Blacksmith Fork Canyon. The space has small rolling berms covered in native grasses and wildflowers. This area serves as a beautiful buffer between the active play and parking areas and the amphitheater. This can become a great backdrop for photos as well as open space that feels like Utah's mountain meadows in your backyard.



# Blacksmith Fork Park

## Action Sports

### BMX Pump Track & Skate-park

Blacksmith Fork Park's proximity to Mountain Crest High School makes it a great place to incorporate recreational opportunities for adolescents. The pump track will give kids and adolescents a place to ride that is off of streets and away from cars. The skate-park and BMX course are located in areas that are easily seen from the road for safety purposes.



# Blacksmith Fork Park

## Softball Fields

### Viewing Berms

The baseball/softball fields in the plan have ample stadium seating behind home plate. There are also turf berms outside of the outfield fence as informal seating areas. These berms add another seating option as well as screen the fields from the other areas of the park. There is a small playground on the East side of the fields to allow parents to bring the rest of the family and keep younger kids entertained.

