

AGENDA ITEM XI. A.

**State of Utah – School and Institutional Trust Lands Administration
Proposed Project / Action Summary**

Sponsor Agency:

School and Institutional Trust Lands Administration (“SITLA”)
675 East 500 South, Suite 500
Salt Lake City, UT 84102
801-538-5100

Title of Proposed Action: SULA 1899 – Proposed Communication Tower Site

Project Abstract (Description of project):

This is being provided to you for informational purposes. We have a request to construct a proposed cellular-wireless communication tower site in Kane County, southwest of Big Water. The site will provide improved cellular phone service and related emergency communication service to rural areas.

This site will require a land survey and a cultural resource compliance. It will have an estimated size of less than one-half acre, and will be located just northeast of two existing water tanks and southwest of an existing large power transmission line. The estimated height of the tower is 300 feet.

Location of project:

Township 43 South, Range 2 East, SLB&M (see attached map showing general location)
Section 15: within the NW4 (estimated tower site location -111.680376, 37.074336)

County: Kane County

County Commission Office: (You are receiving this as part of our normal review)

Kane County Commission
76 North Main Street
Kanab, UT 84741

Association of Governments Office: (You are receiving this as part of our normal review)

Five County Association of Governments
1070 W. 1600 S. Bldg. B
St. George, UT 84770

Project Contact Information:

Gary D. Bagley, Trust Lands Resource Specialist, School and Institutional Trust Lands Administration
Phone: 801-538-5100; Email: garybagley@utah.gov

AGENDA ITEM XI. A. (continued)

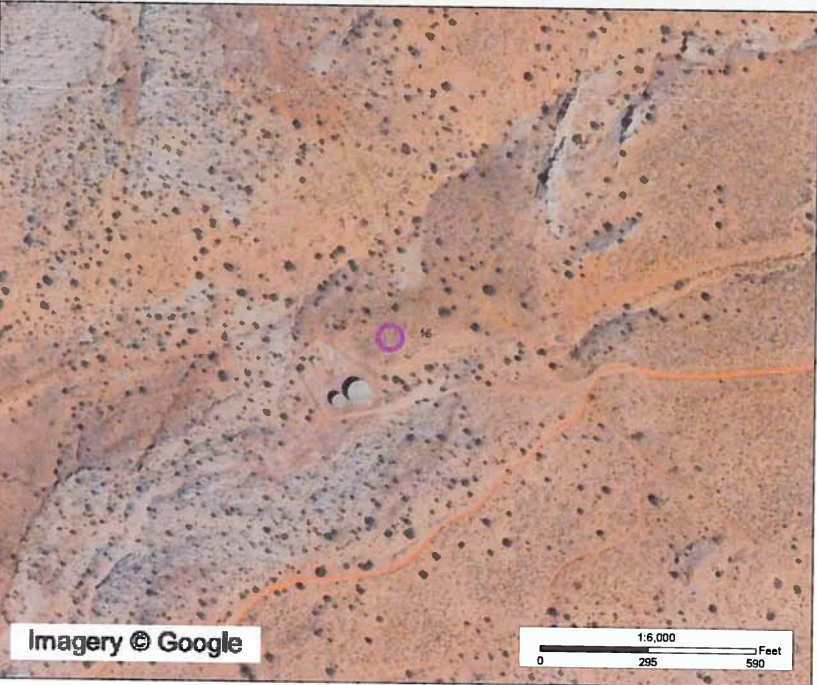
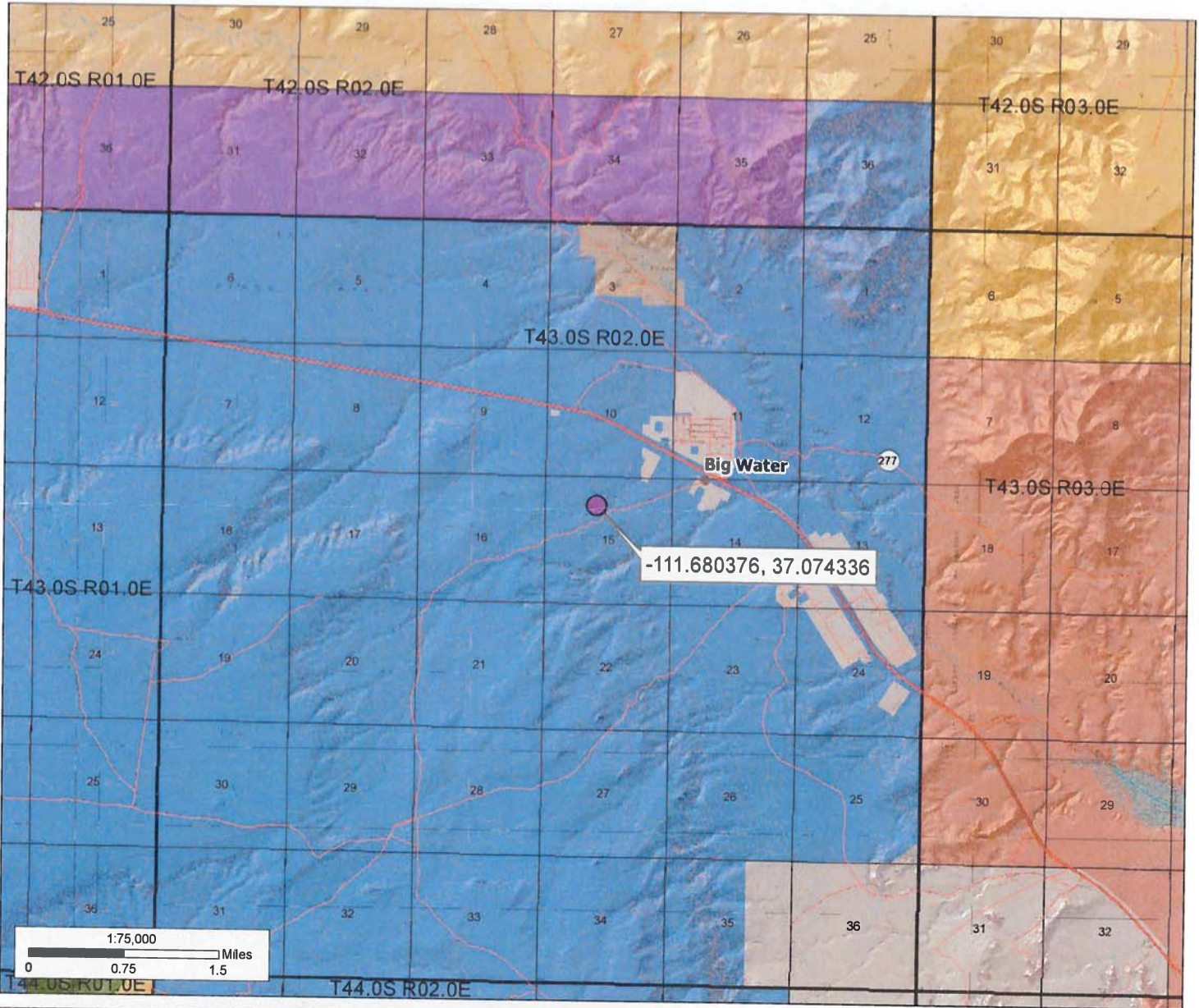

Special Use Lease Agreement No. 1899
Preliminary Site

Township 43 South, Range 2 East, SLB&M;
 Section 15
 Kane County

State of Utah
 Division of Institutional
 Trust Lands Administration
 December 18, 2018 SITLA

Land Ownership and Administration

- Bureau of Land Management
- Bureau of Reclamation
- Bankhead-Jones Land Use Lands
- National Recreation Area
- National Parks & Historic Sites
- National Monument
- National Forest
- National Wilderness Area
- National Wildlife Refuge
- Other Federal
- Military Reservations and Corps of Engineers
- Private
- State Trust Lands
- State Sovereign Land
- State Parks and Recreation
- State Wildlife Reserve/Management Area
- Other State
- Tribal Lands

N

User: bradyjohnson
 Coordinate System: NAD 1983 UTM Zone 12N
 Projection: Transverse Mercator
 Path: V:\GIS\GIS_Review\Surface\SpecialUseLeaseAgreement_SULA\AerialTopoTemp_SUI_A.mxd

Data represented on this map is for REFERENCE USE ONLY and is not suitable for legal, engineering, or surveying purposes. Users of this information should review or consult the primary data and information sources to ascertain the usability of the information. SITLA provides this data in good faith and shall in no event be liable for any incorrect results, or any special, indirect or consequential damages to any party, arising out of or in connection with the use of or the inability to use the data hereon.

Land parcels, lease boundaries and associated SITLA data layers may have been adjusted to allow for visual "best fit." The Surface Ownership Land Status data (if present) are maintained by SITLA to reflect current trust land status and surface ownership. Lakes, rivers, streams, highways, roads, county and state boundaries are distributed by the Utah Automated Geographic Reference Center and/or other sources as specified. Contour lines (if present) were generated from USGS 10 meter DEM.

Please Note: While SITLA seeks to verify data for accuracy and content, discrepancies may exist within the data. Acquiring the most updated SITLA ownership GIS data may require contacting the GIS staff directly 801-538-5100 or TLA-GIS@utah.gov. The SITLA GIS department welcomes your comments and concerns regarding the data and will attempt to resolve issues as they are brought to our attention. Color Aerial Photo (Google Imagery - 6 inch High Resolution).