

FILE: z:\1 - engineering\1 - projects\260304 - toquerville park2 - engineering\1 - design\2 - sheets\Site Plan.dwg TIME: 28 April 2026

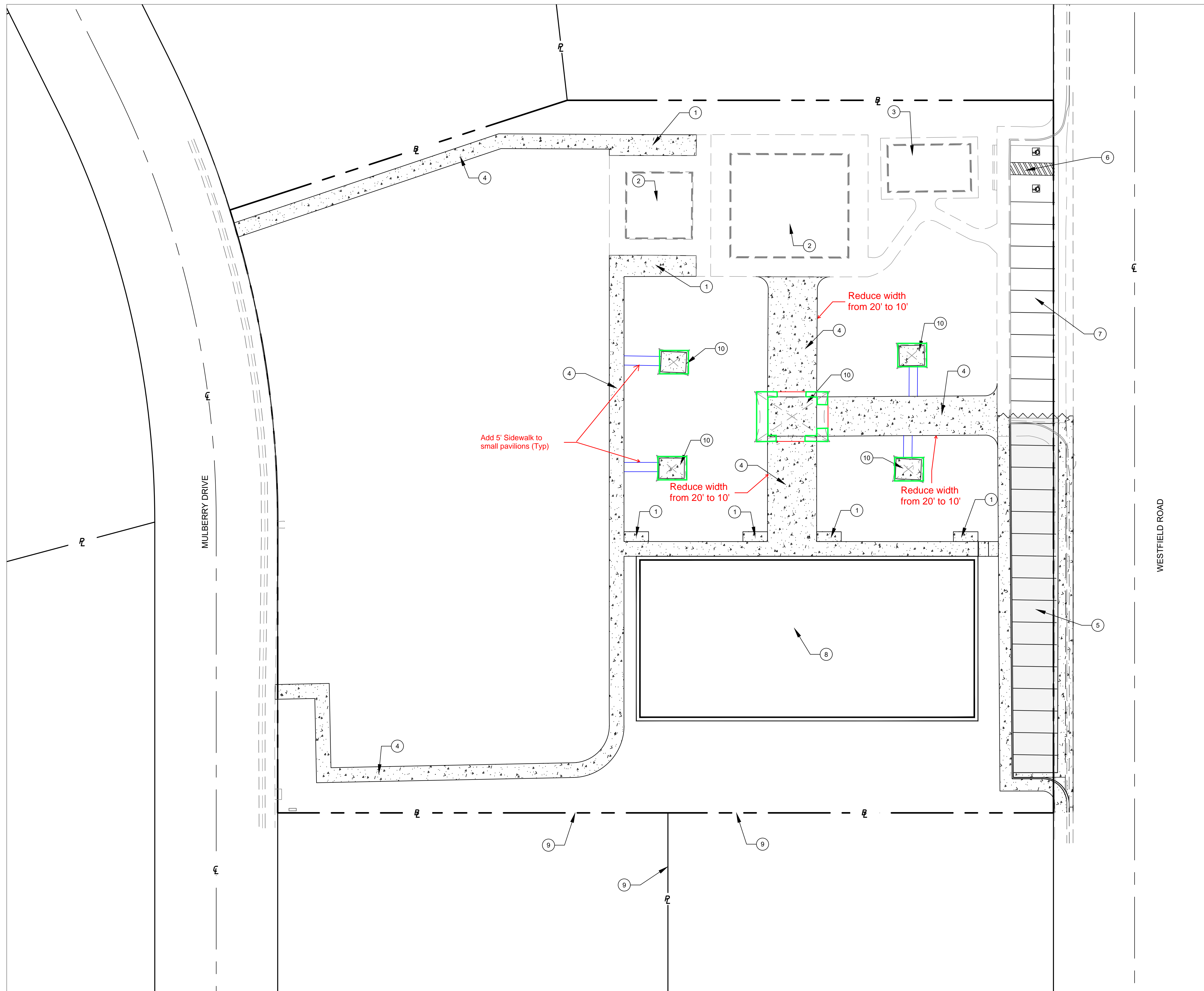

- LEGEND**
- ① NEW PARK BENCH LOCATION
  - ② EXISTING PLAYGROUND
  - ③ EXISTING BATHROOM BUILDING
  - ④ NEW CONCRETE WALKWAY
  - ⑤ NEW PARKING SPACES (3 DT1.1)
  - ⑥ NEW ADA - SEE C2.1 FOR INFO
  - ⑦ EXISTING PARKING AREA
  - ⑧ PICKLE BALL COURTS - SEE TARKET PLAN SET
  - ⑨ EXISTING WALLS
  - ⑩ EXISTING PAVILIONS PROTECT IN PLACE

**NOTES**

PAVILION CANOPIES ARE EXISTING AND ARE TO BE PROTECTED IN PLACE.

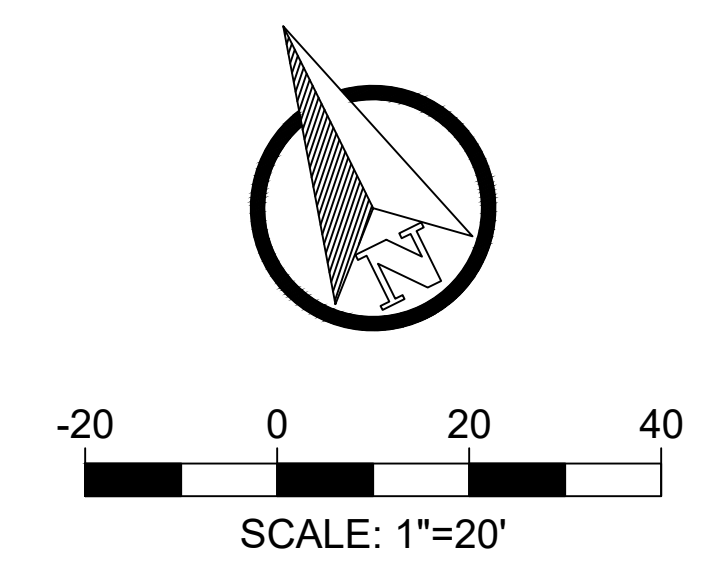

**SITEWORKS**  
ENGINEERING

52 S 850 W SUITE 103, HURRICANE, UTAH 84737  
P: 435-635-8143 | E: INFO@SITEWORKS-ENG.COM

PROFESSIONAL ENGINEER  
28 APRIL 26  
No. 14235570  
KYSON KEITH SPENDLOVE  
K. Spill  
STATE OF UTAH

DESIGNED BY KM  
DRAWN BY MB  
CHECKED BY LP

CITY OF TOQUERVILLE			
SITE PLAN			
WESTFIELD PARK			
1280 S WESTFIELD RD, TOQUERVILLE, UT 84774			

REV.	DATE	DESCRIPTION	BY

DATE: 28 APRIL 26  
PROJ.#: 260304 PAGE#: C2.0