

SURFACE SLOPE DATA			
NUMBER	MINIMUM SLOPE	MAXIMUM SLOPE	COLOR
1	0.016%	1.000%	Red
2	1.000%	3.000%	Orange
3	3.000%	5.000%	Yellow
4	5.000%	7.000%	Light Green
5	7.000%	9.000%	Green
6	9.000%	11.000%	Light Blue
7	11.000%	15.000%	Blue
8	15.000%	30.000%	Dark Blue
9	30.000%	100.000%	Purple

SLOPE EXHIBIT OF EXISTING ROAD AS INSTALLED

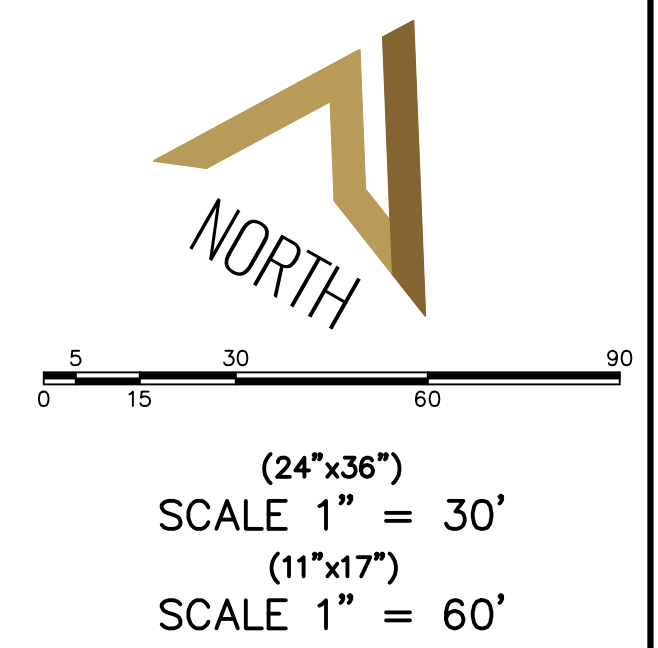

CANYON VIEW DRIVE

ATLAS ENGINEERING  
 CIVIL · STRUCTURAL · SURVEY

PHONE: 801-455-4566  
 946 E. 800 N. SUITE A  
 SPANISH FORK, UT 84660

SIGHT TRIANGLE EXHIBIT

ELK RIDGE, UTAH

SHEET NO.

5

NO.	REVISIONS	BY	DATE
12			
11			
10			
9			
8			
7			
6			
5			
4			
3			
2			
1			