

WHEN RECORDED, RETURN TO:

Randall M. Larsen
Gilmore & Bell, P.C.
15 West South Temple, Suite 1400
Salt Lake City, Utah 84101

NOTICE OF AMENDMENT TO ASSESSMENT INTEREST
FIREFLY PUBLIC INFRASTRUCTURE DISTRICT NO. 1

FIREFLY ASSESSMENT AREA NO. 1
THIRD AMENDMENT TO ASSESSMENT ORDINANCE

DATED AS OF JULY 1, 2025

WHEREAS, the Board of Trustees (the “Board”) of the Firefly Public Infrastructure District No. 1 (the “District”), adopted Resolution No. 2023-06 on December 21, 2023 (the “Authorizing Resolution”), pursuant to which the Board authorized and approved the form of an Assessment Ordinance (the “Original Assessment Ordinance”) and the form of the related designation resolution (the “Designation Resolution”); and

WHEREAS, the District, pursuant to the Assessment Area Act, Title 11, Chapter 42, Utah Code Annotated 1953, as amended (the “Act”), and pursuant to the Authorizing Resolution and the Designation Resolution, designated the Firefly Assessment Area No. 1 (the “Assessment Area”); and

WHEREAS, the final Original Assessment Ordinance dated as of December 21, 2023, was signed by the Board and recorded with the Utah County Recorder; and

WHEREAS, on April 9, 2024, the District adopted a First Amendment to Assessment Ordinance (the “First Amendment to Assessment Ordinance”) and on July 16, 2024, adopted a Second Amendment to Assessment Ordinance (the “Second Amendment to Assessment Ordinance”) and collectively with the First Amendment to Assessment Ordinance and the Original Assessment Ordinance, the “Assessment Ordinance”); and

WHEREAS, pursuant to Section 6(d) of the Assessment Ordinance, an Owner has requested the consent of the District in connection with the subdivision of certain parcels of land within the Assessment Area; and

WHEREAS, the Owner has provided the Board with documentation to demonstrate the requirements of the Assessment Ordinance have been complied with in connection with the allocation of ERUs; and

WHEREAS, Section 6(d) of the Assessment Ordinance permits the reallocation of Assessments within the Assessment Area and the District desires to amend Exhibit A of the Assessment Ordinance to accordingly reallocate Assessments; and

WHEREAS, certain Owners have paid the outstanding Assessments on their parcels in full and the Board desires to release the lien of the Assessments against those properties; and

WHEREAS, the District has prepared a revised assessment list to reflect such changes; and

WHEREAS, pursuant to, and in compliance with, the provisions of Section 6 of the Assessment Ordinance, the Board desires to adopt this Third Amendment to Assessment Ordinance to effectuate the amendments described herein:

NOW THEREFORE, BE IT ORDAINED BY THE BOARD OF TRUSTEES OF THE FIREFLY PUBLIC INFRASTRUCTURE DISTRICT NO. 1:

Section 1. Subdivision of Parcels in Accordance with Assessment Ordinance. In accordance with Section 6(d) of the Assessment Ordinance, the District has been requested to approve the reallocation of ERUs as shown on the attached Exhibit A. The District hereby finds and determines that the number of ERUs is not being reduced and that the fair market value of each parcel after the subdivision is greater than three times the sum of (A) the remaining unpaid Assessment on each subdivided parcel, plus (B) any other unpaid assessment liens or property tax liens on each subdivided parcel (such fair market value determined using appraised value by a certified appraiser and presented by the Owner of such parcel). The Owner has represented to the District in the certificate attached hereto as Exhibit B that the Owner has the entitlements and property to develop the remaining number and type of units as detailed in the Appraisal attached to said certificate. The District hereby approves of the reallocation of such ERUs as shown on the attached Exhibit A.

Section 2. Release of Properties. The properties attached hereto as Exhibit C have paid their assessments in full and the District hereby approves of the release of the assessment lien on such parcels and authorizes the recordation of any notices required in connection therewith.

Section 3. Approval of Revised Assessment List. In order to reflect the reallocation and releases approved herein, the District hereby confirms and approves the revised assessment list for the Assessment Area, a copy of which is attached hereto as

Exhibit D and incorporated herein by reference (the “Assessment List”). The Assessment List hereby amends and replaces the assessment list attached as Exhibit A in the Assessment Ordinance.

Section 4. All Necessary Action Approved. The officials of the District are hereby authorized and directed to take all action necessary and appropriate to effectuate the provisions of this Third Amendment to Assessment Ordinance, including the filing of a notice with the Utah County Recorder.

Section 5. Assessment Ordinance. Except as specifically amended by this Third Amendment to Assessment Ordinance, the Assessment Ordinance shall remain in full force and effect without change.

Section 6. Repeal of Conflicting Provisions; Amendment. All ordinances or parts thereof in conflict with this Third Amendment to Assessment Ordinance are hereby repealed. The Chair (or any assigned designee of the Chair) may make any alterations, changes or additions to this Third Amendment to Assessment Ordinance which may be necessary to correct errors or omissions herein, to complete the same, to remove ambiguities herefrom, or to conform the same to other provisions of this Third Amendment to Assessment Ordinance or any resolution adopted by the Board or the provisions of the laws of the State of Utah or the United States.

Section 7. Posting of Ordinance. This Third Amendment to Assessment Ordinance shall be signed by the Chair and Clerk/Secretary and shall be recorded in the ordinance book kept for that purpose. A copy of this Third Amendment to Assessment Ordinance shall be posted in a public location within or near the District’s boundaries that is reasonably likely to be seen by individuals who pass through or near the affected area for at least 21 days and a copy of this Third Amendment to Assessment Ordinance shall also be posted on the Utah Public Notice Website (<http://pmn.utah.gov>) for at least 21 days. This Third Amendment to Assessment Ordinance shall take effect immediately upon its passage and approval and posting as required by law.

Section 8. Defined Terms. Capitalized terms used herein but not otherwise defined shall have the meanings ascribed to such terms in the Assessment Ordinance.

PASSED AND APPROVED this July 1, 2025.

FIREFLY PUBLIC
INFRASTRUCTURE DISTRICT NO. 1

By: 
Chair

ATTEST:

By: _____
Clerk/Secretary

PASSED AND APPROVED this July 1, 2025.

FIREFLY PUBLIC
INFRASTRUCTURE DISTRICT NO. 1

By: _____
Chair

ATTEST:

By: 
Clerk/Secretary

STATE OF UTAH)
 : ss.
COUNTY OF UTAH)

The foregoing instrument was acknowledged before me this July 1, 2025, by Nate Shipp, the Chair of the Board of Trustees of the Firefly Public Infrastructure District No. 1 (the "District"), who represented and acknowledged that s/he signed the same for and on behalf of the District.





NOTARY PUBLIC

STATE OF UTAH)
 : ss.
COUNTY OF UTAH)

The foregoing instrument was acknowledged before me this July ____, 2025, by Jared Westhoff, the Clerk/Secretary of the Firefly Public Infrastructure District No. 1 (the "District"), who represented and acknowledged that s/he signed the same for and on behalf of the District.

NOTARY PUBLIC

STATE OF UTAH)
 : ss.
COUNTY OF UTAH)

The foregoing instrument was acknowledged before me this July ____, 2025, by Nate Shipp, the Chair of the Board of Trustees of the Firefly Public Infrastructure District No. 1 (the "District"), who represented and acknowledged that s/he signed the same for and on behalf of the District.

NOTARY PUBLIC

STATE OF UTAH)
 : ss.
COUNTY OF UTAH)

The foregoing instrument was acknowledged before me this July 1, 2025, by Jared Westhoff, the Clerk/Secretary of the Firefly Public Infrastructure District No. 1 (the "District"), who represented and acknowledged that s/he signed the same for and on behalf of the District.

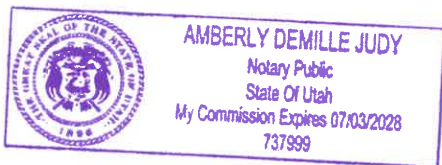

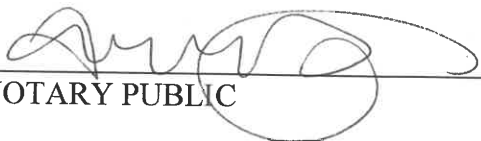

NOTARY PUBLIC

EXHIBIT A

REALLOCATION OF ASSESSMENTS

Firefly
Public Infrastructure District No. 1
Special Assessment Bonds, Series 2024A-2
Assessment Roll as of 1/1/2025

No.	PARCEL NO.	NAME OF OWNER	PRODUCT TYPE	ERUs	ASSESSMENT
1	39-384-0301	DAICLH LLC	SFD Alley (0.10 Ac.)	1.00	\$ 27,320
2	39-384-0302	DAICLH LLC	SFD Alley (0.11 Ac.)	1.02	\$ 27,866
3	39-384-0303	DAICLH LLC	SFD Alley (0.10 Ac.)	1.00	\$ 27,320
4	39-384-0304	DAICLH LLC	SFD Alley (0.11 Ac.)	1.02	\$ 27,866
5	39-384-0305	DAICLH LLC	SFD Alley (0.10 Ac.)	1.00	\$ 27,320
6	39-384-0306	DAICLH LLC	SFD Alley (0.11 Ac.)	1.02	\$ 27,368
7	39-384-0307	DAICLH LLC	SFD Alley (0.11 Ac.)	1.02	\$ 27,368
8	39-384-0308	DAICLH LLC	SFD Alley (0.11 Ac.)	1.02	\$ 27,268
9	39-384-0309	DAICLH LLC	SFD Alley (0.10 Ac.)	1.00	\$ 26,831
10	39-384-0310	DAICLH LLC	SFD Alley (0.11 Ac.)	1.02	\$ 27,866
11	39-384-0311	DAICLH LLC	SFD Alley (0.11 Ac.)	1.02	\$ 27,368
12	39-384-0312	DAICLH LLC	SFD Alley (0.10 Ac.)	1.00	\$ 27,320
13	39-384-0313	DAICLH LLC	SFD Alley (0.11 Ac.)	1.02	\$ 27,368
14	39-384-0314	DAICLH LLC	SFD Alley (0.11 Ac.)	1.02	\$ 27,866
15	39-384-0315	DAICLH LLC	SFD Alley (0.10 Ac.)	1.00	\$ 27,320
16	39-384-0316	DAICLH LLC	SFD Alley (0.11 Ac.)	1.02	\$ 27,866
17	39-384-0317	DAICLH LLC	SFD Alley (0.11 Ac.)	1.02	\$ 27,866
18	39-384-0318	DAICLH LLC	SFD Alley (0.10 Ac.)	1.00	\$ 27,320
19	39-384-0319	DAICLH LLC	SFD Alley (0.11 Ac.)	1.02	\$ 27,866
20	39-384-0320	DAICLH LLC	SFD Alley (0.11 Ac.)	1.02	\$ 27,866
21	39-384-0321	DAICLH LLC	SFD Alley (0.10 Ac.)	1.00	\$ 27,320
22	39-384-0322	DAICLH LLC	SFD Alley (0.10 Ac.)	1.00	\$ 27,320
23	39-384-0323	DAICLH LLC	SFD Alley (0.11 Ac.)	1.02	\$ 27,866
24	39-384-0324	DAICLH LLC	TH Alley 13.5 DU/Ac	0.81	\$ 22,129
25	39-384-0325	DAICLH LLC	TH Alley 13.5 DU/Ac	0.81	\$ 22,129
26	39-384-0326	DAICLH LLC	TH Alley 13.5 DU/Ac	0.81	\$ 22,129
27	39-384-0327	DAICLH LLC	TH Alley 13.5 DU/Ac	0.81	\$ 22,129
28	39-384-0328	DAICLH LLC	TH Alley 13.5 DU/Ac	0.81	\$ 22,129
29	39-384-0329	DAICLH LLC	TH Alley 13.5 DU/Ac	0.81	\$ 22,129
30	39-384-0330	DAICLH LLC	TH Alley 13.5 DU/Ac	0.81	\$ 22,129
31	39-384-0331	DAICLH LLC	TH Alley 13.5 DU/Ac	0.81	\$ 21,733
32	39-384-0332	DAICLH LLC	TH Alley 13.5 DU/Ac	0.81	\$ 22,129
33	39-384-0333	DAICLH LLC	TH Alley 13.5 DU/Ac	0.81	\$ 22,129
34	39-384-0334	DAICLH LLC	SFDS (0.14 - 0.16 Ac)	1.08	\$ 28,505
35	39-384-0335	DAICLH LLC	SFDS (0.10 - 0.12 Ac)	1.00	\$ 27,320
36	39-384-0336	DAICLH LLC	SFDS (0.10 - 0.12 Ac)	1.00	\$ 27,320
37	39-384-0337	DAICLH LLC	SFDS (0.10 - 0.12 Ac)	1.00	\$ 27,320
38	39-384-0338	DAICLH LLC	SFDS (0.10 - 0.12 Ac)	1.00	\$ 27,320
39	39-384-0339	DAICLH LLC	SFDS (0.17 - 0.19 Ac)	1.13	\$ 30,319
40	39-388-0401	DAICLH LLC	SFDS (0.17 - 0.19 Ac)	1.13	\$ 30,319
41	39-388-0402	DAICLH LLC	SFDS (0.14 - 0.16 Ac)	1.08	\$ 28,977
42	39-388-0403	DAICLH LLC	SFDS (0.17 - 0.19 Ac)	1.13	\$ 30,319

43	39-388-0404	DAICLH LLC	SFDS (0.14 - 0.16 Ac)	1.08	\$	29,505
44	39-388-0405	DAICLH LLC	SFDS (0.12 - 0.14 Ac)	1.04	\$	28,977
45	39-388-0406	DAICLH LLC	SFDS (0.17 - 0.19 Ac)	1.13	\$	30,319
46	39-388-0407	DAICLH LLC	SFDS (0.17 - 0.19 Ac)	1.13	\$	30,319
47	39-388-0408	DAICLH LLC	SFDS (0.17 - 0.19 Ac)	1.13	\$	30,319
48	39-388-0409	DAICLH LLC	SFDS (0.17 - 0.19 Ac)	1.13	\$	30,319
49	39-388-0410	DAICLH LLC	SFDS (0.17 - 0.19 Ac)	1.13	\$	30,319
50	39-388-0411	DAICLH LLC	SFDS (0.14 - 0.16 Ac)	1.08	\$	29,505
51	39-388-0412	DAICLH LLC	SFDS (0.17 - 0.19 Ac)	1.13	\$	30,871
52	39-388-0413	DAICLH LLC	SFDS (0.17 - 0.19 Ac)	1.13	\$	30,871
53	39-388-0414	DAICLH LLC	SFDS (0.17 - 0.19 Ac)	1.13	\$	30,871
54	39-388-0415	DAICLH LLC	SFDS (0.12 - 0.14 Ac)	1.04	\$	27,904
55	39-388-0416	DAICLH LLC	SFDS (0.12 - 0.14 Ac)	1.04	\$	28,412
56	39-388-0417	DAICLH LLC	SFDS (0.12 - 0.14 Ac)	1.04	\$	27,904
57	39-388-0418	DAICLH LLC	SFDS (0.14 - 0.16 Ac)	1.08	\$	28,977
58	39-388-0419	DAICLH LLC	SFDS (0.17 - 0.19 Ac)	1.13	\$	30,871
59	39-388-0420	DAICLH LLC	SFDS (0.10 - 0.12 Ac)	1.00	\$	27,320
60	39-388-0421	DAICLH LLC	SFDS (0.10 - 0.12 Ac)	1.00	\$	27,320
61	39-388-0422	DAICLH LLC	SFDS (0.10 - 0.12 Ac)	1.00	\$	27,320
62	39-388-0423	DAICLH LLC	SFDS (0.10 - 0.12 Ac)	1.00	\$	27,320
63	39-388-0424	DAICLH LLC	SFDS (0.12 - 0.14 Ac)	1.04	\$	28,412
64	39-388-0425	DAICLH LLC	SFDS (0.17 - 0.19 Ac)	1.13	\$	30,871
65	39-388-0426	DAICLH LLC	SFDS (0.17 - 0.19 Ac)	1.13	\$	30,871
66	39-388-0427	DAICLH LLC	SFDS (0.12 - 0.14 Ac)	1.04	\$	28,412
67	39-388-0428	DAICLH LLC	SFDS (0.12 - 0.14 Ac)	1.04	\$	28,412
68	39-388-0429	DAICLH LLC	SFDS (0.12 - 0.14 Ac)	1.04	\$	28,412
69	39-388-0430	DAICLH LLC	SFDS (0.14 - 0.16 Ac)	1.08	\$	29,505
70	39-388-0431	DAICLH LLC	SFDS (0.17 - 0.19 Ac)	1.13	\$	30,871
71	39-388-0432	DAICLH LLC	SFDS (0.14 - 0.16 Ac)	1.08	\$	29,505
72	39-388-0433	DAICLH LLC	SFDS (0.12 - 0.14 Ac)	1.04	\$	28,412
73	39-388-0434	DAICLH LLC	SFDS (0.10 - 0.12 Ac)	1.00	\$	27,320
74	39-388-0435	DAICLH LLC	SFDS (0.10 - 0.12 Ac)	1.00	\$	27,320
75	39-388-0436	DAICLH LLC	TH FL 11 DU/Ac	0.81	\$	22,129
76	39-388-0437	DAICLH LLC	TH FL 11 DU/Ac	0.81	\$	22,129
77	39-388-0438	DAICLH LLC	TH FL 11 DU/Ac	0.81	\$	22,129
78	39-388-0439	DAICLH LLC	TH FL 11 DU/Ac	0.81	\$	22,129
79	39-388-0440	DAICLH LLC	TH FL 11 DU/Ac	0.81	\$	22,129
80	39-388-0441	DAICLH LLC	TH FL 11 DU/Ac	0.81	\$	22,129
81	39-388-0442	DAICLH LLC	TH FL 11 DU/Ac	0.81	\$	22,129
82	39-388-0443	DAICLH LLC	TH FL 11 DU/Ac	0.81	\$	22,129
83	39-388-0444	DAICLH LLC	TH FL 11 DU/Ac	0.81	\$	22,129
84	39-388-0445	DAICLH LLC	TH FL 11 DU/Ac	0.81	\$	22,129
85	39-388-0446	DAICLH LLC	TH FL 11 DU/Ac	0.81	\$	22,129
86	39-388-0447	DAICLH LLC	TH FL 11 DU/Ac	0.81	\$	22,129
87	39-388-0448	DAICLH LLC	TH FL 11 DU/Ac	0.81	\$	21,733
88	39-388-0449	DAICLH LLC	TH FL 11 DU/Ac	0.81	\$	21,733
89	39-388-0450	DAICLH LLC	TH FL 11 DU/Ac	0.81	\$	21,733
90	39-388-0451	DAICLH LLC	TH FL 11 DU/Ac	0.81	\$	21,733
91	39-388-0452	DAICLH LLC	TH FL 11 DU/Ac	0.81	\$	21,733
92	39-388-0453	DAICLH LLC	TH FL 11 DU/Ac	0.81	\$	21,733
93	39-388-0454	DAICLH LLC	TH FL 11 DU/Ac	0.81	\$	21,733

94	39-393-0501	DAICLH LLC	SFD Alley (0.11 Ac.)	1.02	\$	27,866
95	39-393-0502	DAICLH LLC	SFD Alley (0.10 Ac.)	1.00	\$	27,320
96	39-393-0503	DAICLH LLC	SFD Alley (0.11 Ac.)	1.02	\$	27,866
97	39-393-0504	DAICLH LLC	SFD Alley (0.10 Ac.)	1.00	\$	27,320
98	39-393-0505	DAICLH LLC	SFD Alley (0.11 Ac.)	1.02	\$	27,866
99	39-393-0506	DAICLH LLC	SFD Alley (0.11 Ac.)	1.02	\$	27,866
100	39-393-0507	DAICLH LLC	SFD Alley (0.11 Ac.)	1.02	\$	27,866
101	39-393-0508	DAICLH LLC	SFD Alley (0.11 Ac.)	1.02	\$	27,866
102	39-393-0509	DAICLH LLC	SFD Alley (0.10 Ac.)	1.00	\$	27,320
103	39-393-0510	DAICLH LLC	SFD Alley (0.10 Ac.)	1.00	\$	27,320
104	39-393-0511	DAICLH LLC	SFD Alley (0.11 Ac.)	1.02	\$	27,866
105	39-393-0512	DAICLH LLC	SFD Alley (0.11 Ac.)	1.02	\$	27,866
106	39-393-0513	DAICLH LLC	SFD Alley (0.11 Ac.)	1.02	\$	27,866
107	39-393-0514	DAICLH LLC	SFD Alley (0.10 Ac.)	1.00	\$	27,320
108	39-393-0515	DAICLH LLC	SFD Alley (0.10 Ac.)	1.00	\$	27,320
109	39-393-0516	DAICLH LLC	SFD Alley (0.11 Ac.)	1.02	\$	27,866
110	39-393-0517	DAICLH LLC	SFD Alley (0.11 Ac.)	1.02	\$	27,866
111	39-393-0518	DAICLH LLC	SFD Alley (0.10 Ac.)	1.00	\$	27,320
112	39-393-0519	DAICLH LLC	SFD Alley (0.10 Ac.)	1.00	\$	27,320
113	39-393-0520	DAICLH LLC	SFD Alley (0.11 Ac.)	1.02	\$	27,866
114	39-393-0521	DAICLH LLC	TH Alley 13.5 DU/Ac	0.81	\$	22,129
115	39-393-0522	DAICLH LLC	TH Alley 13.5 DU/Ac	0.81	\$	22,129
116	39-393-0523	DAICLH LLC	TH Alley 13.5 DU/Ac	0.81	\$	22,129
117	39-393-0524	DAICLH LLC	TH Alley 13.5 DU/Ac	0.81	\$	22,129
118	39-393-0525	DAICLH LLC	TH Alley 13.5 DU/Ac	0.81	\$	22,129
119	39-393-0526	DAICLH LLC	TH Alley 13.5 DU/Ac	0.81	\$	22,129
120	39-393-0527	DAICLH LLC	TH Alley 13.5 DU/Ac	0.81	\$	22,129
121	39-393-0528	DAICLH LLC	TH Alley 13.5 DU/Ac	0.81	\$	22,129
122	39-393-0529	DAICLH LLC	TH Alley 13.5 DU/Ac	0.81	\$	22,129
123	39-393-0530	DAICLH LLC	TH Alley 13.5 DU/Ac	0.81	\$	22,129
124	39-393-0531	DAICLH LLC	TH Alley 13.5 DU/Ac	0.81	\$	22,129
125	39-393-0532	DAICLH LLC	TH Alley 13.5 DU/Ac	0.81	\$	22,129
126	39-393-0533	DAICLH LLC	TH Alley 13.5 DU/Ac	0.81	\$	22,129
127	39-393-0534	DAICLH LLC	TH Alley 13.5 DU/Ac	0.81	\$	22,129
128	39-393-0535	DAICLH LLC	TH Alley 13.5 DU/Ac	0.81	\$	22,129
129	39-393-0536	DAICLH LLC	TH Alley 13.5 DU/Ac	0.81	\$	22,129
130	39-393-0537	DAICLH LLC	TH Alley 13.5 DU/Ac	0.81	\$	22,129
131	39-393-0538	DAICLH LLC	TH Alley 13.5 DU/Ac	0.81	\$	22,129
132	39-393-0539	DAICLH LLC	TH Alley 13.5 DU/Ac	0.81	\$	22,129
133	39-393-0540	DAICLH LLC	TH Alley 13.5 DU/Ac	0.81	\$	22,129
134	39-393-0541	DAICLH LLC	TH Alley 13.5 DU/Ac	0.81	\$	22,129
135	39-393-0542	DAICLH LLC	TH Alley 13.5 DU/Ac	0.81	\$	22,129
136	39-393-0543	DAICLH LLC	TH Alley 13.5 DU/Ac	0.81	\$	22,129
137	39-393-0544	DAICLH LLC	TH Alley 13.5 DU/Ac	0.81	\$	22,129
138	39-393-0545	DAICLH LLC	TH Alley 13.5 DU/Ac	0.81	\$	22,129
139	39-393-0546	DAICLH LLC	TH Alley 13.5 DU/Ac	0.81	\$	22,129
140	39-393-0547	DAICLH LLC	TH FL 11 DU/Ac	0.81	\$	22,129
141	39-393-0548	DAICLH LLC	TH FL 11 DU/Ac	0.81	\$	22,129
142	39-393-0549	DAICLH LLC	TH FL 11 DU/Ac	0.81	\$	22,129
143	39-393-0550	DAICLH LLC	TH FL 11 DU/Ac	0.81	\$	22,129
144	39-393-0551	DAICLH LLC	TH FL 11 DU/Ac	0.81	\$	22,129
145	39-393-0552	DAICLH LLC	TH FL 11 DU/Ac	0.81	\$	22,129
146	39-393-0553	DAICLH LLC	TH FL 11 DU/Ac	0.81	\$	22,129
147	39-393-0554	DAICLH LLC	TH FL 11 DU/Ac	0.81	\$	22,129
148	39-393-0555	DAICLH LLC	TH FL 11 DU/Ac	0.81	\$	22,129
149	39-393-0556	DAICLH LLC	TH FL 11 DU/Ac	0.81	\$	22,129
150	39-393-0557	DAICLH LLC	TH FL 11 DU/Ac	0.81	\$	22,129
151	39-393-0558	DAICLH LLC	TH FL 11 DU/Ac	0.81	\$	22,129
152	39-393-0559	DAICLH LLC	TH FL 11 DU/Ac	0.81	\$	22,129
153	39-393-0560	DAICLH LLC	TH FL 11 DU/Ac	0.81	\$	22,129
154	39-393-0561	DAICLH LLC	TH FL 11 DU/Ac	0.81	\$	22,129
155	39-393-0562	DAICLH LLC	TH FL 11 DU/Ac	0.81	\$	22,129
156	39-393-0563	DAICLH LLC	TH FL 11 DU/Ac	0.81	\$	22,129
157	39-393-0564	DAICLH LLC	TH FL 11 DU/Ac	0.81	\$	22,129
158	39-393-0565	DAICLH LLC	TH FL 11 DU/Ac	0.81	\$	22,129
159	59.051.0030	GSEJV LLC	N/A	50.96	\$	2,433,731
160	59.051.0031	Multiple	N/A	154.94	\$	4,172,220
161	59.049.0051	OQUIRRH WOOD RANCH LLC	N/A	250.14	\$	6,735,781
162	59.052.0022	OQUIRRH WOOD RANCH LLC	N/A	161.01	\$	4,874,180
163	59.052.0026	DAICLH LLC	N/A	773.64	\$	21,147,601
164	59.048.0107	OQUIRRH WOOD RANCH LLC	N/A	125.26	\$	3,372,908
165	59.053.0050	OQUIRRH WOOD RANCH LLC	N/A	39.20	\$	1,055,854

EXHIBIT B

CERTIFICATE OF OWNER

CERTIFICATE OF PROPERTY OWNERS

The undersigned, the duly authorized representatives of Oquirrh Wood Ranch, LLC, a Utah limited liability company, GSFJV, LLC, a Utah limited liability company, DAICLH, LLC, a Utah limited liability company and White Hills Water Company, INC., a Utah corporation (collectively, the "Property Owner"), the owners of all real property in the Firefly Assessment Area #1 (the "Assessment Area"), do hereby certify and agree as follows:

1. This certificate is delivered by the Property Owner in connection with the request for the reallocation of assessments on property within the Assessment Area. In accordance with the Assessment Ordinance dated as of December 21, 2023, as previously amended, the Property Owner requests the reallocation of assessments on the subdivided property as shown on the attached Exhibit A. Such reallocation of assessments is consistent with the Appraisal attached hereto as Exhibit B and the number of ERUs is not being reduced and the fair market value of each parcel after the subdivision is greater than three times the sum of (A) the remaining unpaid Assessment on each subdivided parcel, plus (B) any other unpaid assessment liens or property tax liens on each subdivided parcel (such fair market value determined using the Appraisal attached hereto as Exhibit B).

2. To the best of the Property Owner's knowledge, after due inquiry, a review of current entitlements, consultation with its engineer(s) and other professionals, the Property Owner hereby certifies that after the subdivision and allocation of ERUs requested herein, the Property Owner has the remaining density, entitlements and property available to develop the units in the amounts and product types contemplated in the Appraisal attached hereto as Exhibit B.

3. The Property Owner owns all parcels shown in Exhibits A and B hereto and the undersigned are authorized to execute and deliver this Certificate for and on behalf of the Property Owner.

4. The Property Owner acknowledges that the Firefly Public Infrastructure District No. 1 (the "District") is relying on the certifications herein in order to preserve the security for the District's Special Assessment Bonds, Series 2024A-2 (Firefly Assessment Area No. 1).

5. The Property Owner hereby waives its rights for contesting, protesting, or challenging the legality or validity of the equitability or fairness of the proposed reallocation of Assessments shown on Exhibit A hereto and hereby consents to not suing or enjoining the levy, collection, or enforcement of the Assessment levied pursuant to the Assessment Ordinance, as amended, or in any manner attacking or questioning the legality of said Assessment as reallocated in Exhibit A hereto.

6. Capitalized terms used but not otherwise defined herein shall have the meanings ascribed to such terms in the Assessment Area Assessment Ordinance dated as of December 21, 2023, as amended.

IN WITNESS WHEREOF, the undersigned have hereunto set their hands for and on behalf of the Property Owner as of this May 29, 2025.

Oquirrh Wood Ranch, LLC, a Utah limited liability company

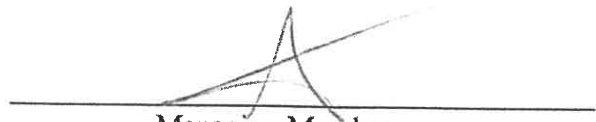
By: 
Managing Member

GSFJV, LLC, a Utah limited liability company

By: 
Managing Member

WHITE HILLS WATER COMPANY, INC., a Utah corporation

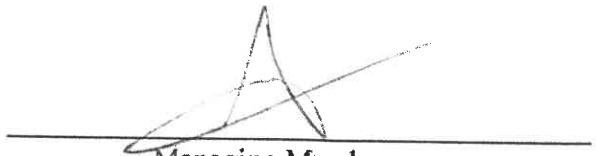
By: 
Managing Member

DAICLH, LLC, a Utah limited liability company

By: 
Managing Member

EXHIBIT A

ASSESSMENT ALLOCATION

(Exhibit excluded from recorded copy)

EXHIBIT C

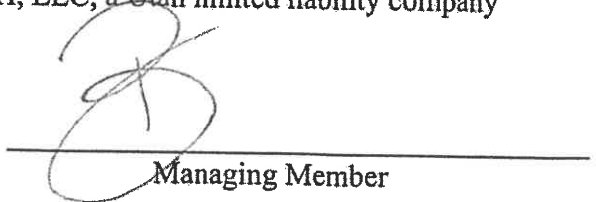
PARCELS RELEASED FROM ASSESSMENT

Firefly

Public Infrastructure District No. 1

Special Assessment Bonds, Series 2024A-2⁽¹⁾

Prepayments as of March 1, 2025

Parcel Number	Lot Number	(A) Assessment Prepayment	(B) Amount to be Transferred by Trustee from Reserve Fund ⁽²⁾	(C) Amount to be Transferred by Trustee from Capitalized Interest Fund ⁽³⁾	(A)+(B)+(C) Total Principal Payment Amount	(D) Accrued Interest to Next Redemption Date	(A)+(D) Total Developer Prepayment Amount	(B)+(C) Total Transfers by Trustee
39-384-0310	310	\$ 27,865.99	\$ 2,420.78	\$ 1,567.46	\$ 31,854.22	\$ 895.90	\$ 28,761.89	\$ 3,988.24
39-384-0314	314	\$ 27,865.99	\$ 2,420.78	\$ 1,567.46	\$ 31,854.22	\$ 895.90	\$ 28,761.89	\$ 3,988.24
39-384-0324	324	\$ 22,128.87	\$ 1,922.38	\$ 1,244.75	\$ 25,296.00	\$ 711.45	\$ 22,840.32	\$ 3,167.13
39-384-0325	325	\$ 22,128.87	\$ 1,922.38	\$ 1,244.75	\$ 25,296.00	\$ 711.45	\$ 22,840.32	\$ 3,167.13
39-384-0326	326	\$ 22,128.87	\$ 1,922.38	\$ 1,244.75	\$ 25,296.00	\$ 711.45	\$ 22,840.32	\$ 3,167.13
39-384-0327	327	\$ 22,128.87	\$ 1,922.38	\$ 1,244.75	\$ 25,296.00	\$ 711.45	\$ 22,840.32	\$ 3,167.13
39-384-0328	328	\$ 22,128.87	\$ 1,922.38	\$ 1,244.75	\$ 25,296.00	\$ 711.45	\$ 22,840.32	\$ 3,167.13
39-384-0329	329	\$ 22,128.87	\$ 1,922.38	\$ 1,244.75	\$ 25,296.00	\$ 711.45	\$ 22,840.32	\$ 3,167.13
39-384-0330	330	\$ 22,128.87	\$ 1,922.38	\$ 1,244.75	\$ 25,296.00	\$ 711.45	\$ 22,840.32	\$ 3,167.13
39-384-0332	332	\$ 22,128.87	\$ 1,922.38	\$ 1,244.75	\$ 25,296.00	\$ 711.45	\$ 22,840.32	\$ 3,167.13
39-384-0333	333	\$ 22,128.87	\$ 1,922.38	\$ 1,244.75	\$ 25,296.00	\$ 711.45	\$ 22,840.32	\$ 3,167.13
39-384-0334	334	\$ 29,505.16	\$ 2,563.17	\$ 1,659.67	\$ 33,728.00	\$ 948.60	\$ 30,453.76	\$ 4,222.84
39-384-0335	335	\$ 27,319.59	\$ 2,373.31	\$ 1,536.73	\$ 31,229.63	\$ 878.33	\$ 28,197.93	\$ 3,910.04
39-384-0336	336	\$ 27,319.59	\$ 2,373.31	\$ 1,536.73	\$ 31,229.63	\$ 878.33	\$ 28,197.93	\$ 3,910.04
39-384-0337	337	\$ 27,319.59	\$ 2,373.31	\$ 1,536.73	\$ 31,229.63	\$ 878.33	\$ 28,197.93	\$ 3,910.04
39-384-0338	338	\$ 392,676.34	\$ 34,199.39	\$ 22,144.24	\$ 450,018.97	\$ 12,656.78	\$ 406,332.13	\$ 56,343.63
Total								

Footnotes:

(1) \$47,805,000 Firefly Public Infrastructure District No. 1, Special Assessment Bonds, Series 2024A-2.

(2) Per Section 5.4(d) of the Indenture of Trust and Pledge dated as of April 1, 2024 between Firefly Public Infrastructure District No. 1 as issuer and UMB Bank, N.A. as Trustee Authorizing the issuance of \$47,805,000 Special Assessment Bonds Series 2024A-2 (Firefly Assessment Area No. 1) (the "Indenture"), in the event an assessment prepayment is received the Trustee shall transfer monies from the Reserve Account to the Redemption Account in an amount equal to the respective prepaid parcel's pro rata share of the monies in the Reserve Account as shown above.

(3) Per Section 5.6 of the Indenture, in the event an assessment prepayment is received, the Trustee shall transfer monies from the Capitalized Interest Account to the Redemption Account in an amount equal to the respective prepaid parcel's pro rata share of the monies in the Capitalized Interest Account as shown above.

Firefly
Public Infrastructure District No. 1
Special Assessment Bonds, Series 2024A-2⁽¹⁾
Prepayments as of May 1, 2025

Parcel Number	Lot Number	(A)	(B)	(C)	(A)+(B)+(C)	(D)	(A)+(D)	(B)+(C)
		Assessment Prepayment	Amount to be Transferred by Trustee from Reserve Fund ⁽²⁾	Amount to be Transferred by Trustee from Capitalized Interest Fund ⁽³⁾	Total Principal Payment Amount	Accrued Interest to Next Redemption Date	Total Developer Prepayment Amount	Total Transfers by Trustee
39-384-0306	306	\$ 27,367.58	\$ 2,380.31	\$ 1,541.26	\$ 31,289.14	\$ 880.01	\$ 28,247.58	\$ 3,921.56
39-384-0307	307	\$ 27,367.58	\$ 2,380.31	\$ 1,541.26	\$ 31,289.14	\$ 880.01	\$ 28,247.58	\$ 3,921.56
39-384-0308	308	\$ 27,367.58	\$ 2,380.31	\$ 1,541.26	\$ 31,289.14	\$ 880.01	\$ 28,247.58	\$ 3,921.56
39-384-0311	311	\$ 27,367.58	\$ 2,380.31	\$ 1,541.26	\$ 31,289.14	\$ 880.01	\$ 28,247.58	\$ 3,921.56
39-384-0313	313	\$ 27,367.58	\$ 2,380.31	\$ 1,541.26	\$ 31,289.14	\$ 880.01	\$ 28,247.58	\$ 3,921.56
39-384-0331	331	\$ 21,793.08	\$ 1,890.24	\$ 1,223.94	\$ 24,847.26	\$ 698.83	\$ 22,431.91	\$ 3,114.18
39-384-0339	339	\$ 30,318.98	\$ 2,637.01	\$ 1,707.47	\$ 34,663.46	\$ 974.91	\$ 31,293.89	\$ 4,344.48
39-388-0401	401	\$ 30,318.98	\$ 2,637.01	\$ 1,707.47	\$ 34,663.46	\$ 974.91	\$ 31,293.89	\$ 4,344.48
39-388-0402	402	\$ 28,977.44	\$ 2,520.32	\$ 1,631.92	\$ 33,129.68	\$ 931.77	\$ 29,909.21	\$ 4,152.24
39-388-0403	403	\$ 30,318.98	\$ 2,637.01	\$ 1,707.47	\$ 34,663.46	\$ 974.91	\$ 31,293.89	\$ 4,344.48
39-388-0405	405	\$ 28,977.44	\$ 2,520.32	\$ 1,631.92	\$ 33,129.68	\$ 931.77	\$ 29,909.21	\$ 4,152.24
39-388-0406	406	\$ 30,318.98	\$ 2,637.01	\$ 1,707.47	\$ 34,663.46	\$ 974.91	\$ 31,293.89	\$ 4,344.48
39-388-0407	407	\$ 30,318.98	\$ 2,637.01	\$ 1,707.47	\$ 34,663.46	\$ 974.91	\$ 31,293.89	\$ 4,344.48
39-388-0408	408	\$ 30,318.98	\$ 2,637.01	\$ 1,707.47	\$ 34,663.46	\$ 974.91	\$ 31,293.89	\$ 4,344.48
Total		\$ 398,439.74	\$ 34,654.46	\$ 22,438.90	\$ 455,533.10	\$ 12,811.87	\$ 411,251.60	\$ 57,093.36

Footnotes:
(1) \$47,805,000 Firefly Public Infrastructure District No. 1, Special Assessment Bonds, Series 2024A-2.
(2) Per Section 5.4(d) of the Indenture of Trust and Pledge dated as of April 1, 2024 between Firefly Public Infrastructure District No. 1 as Issuer and UMB Bank, N.A. as Trustee Authorizing the issuance of \$47,805,000 Special Assessment Bonds Series 2024A-2 (Firefly Assessment Area No. 1) (the "Indenture"), in the event an assessment prepayment is received the Trustee shall transfer monies from the Reserve Account to the Redemption Account in an amount equal to the respective prepaid parcel's pro rata share of the monies in the Reserve Account as shown above.
(3) Per Section 5.6 of the Indenture, in the event an assessment prepayment is received, the Trustee shall transfer monies from the Capitalized Interest Account to the Redemption Account in an amount equal to the respective prepaid parcel's pro rata share of the monies in the Capitalized Interest Account as shown above.

**Firefly
Public Infrastructure District No. 1
Special Assessment Bonds, Series 2024A-2⁽¹⁾
Upcoming Prepayments for May Closings**

Parcel Number	Lot Number	(A) Assessment Prepayment	(B) Amount to be Transferred by Trustee from Reserve Fund ⁽²⁾	(C) Amount to be Transferred by Trustee from Capitalized Interest Fund ⁽³⁾	(A)+(B)+(C)	(D) Accrued Interest to Next Redemption Date	(A)+(D) Total Developer Prepayment Amount	(B)+(C) Total Transfers by Trustee
39-384-0309	309	\$ 26,830.96	\$ 2,333.63	\$ 1,511.04	\$ 30,675.63	\$ 862.75	\$ 27,693.71	\$ 3,844.67
39-388-0409	409	\$ 30,318.98	\$ 2,637.01	\$ 1,707.47	\$ 34,663.46	\$ 974.91	\$ 31,293.89	\$ 4,344.48
39-388-0410	410	\$ 30,318.98	\$ 2,637.01	\$ 1,707.47	\$ 34,663.46	\$ 974.91	\$ 31,293.89	\$ 4,344.48
39-388-0415	415	\$ 27,904.20	\$ 2,426.98	\$ 1,571.48	\$ 31,902.65	\$ 897.26	\$ 28,801.46	\$ 3,998.46
39-388-0417	417	\$ 27,904.20	\$ 2,426.98	\$ 1,571.48	\$ 31,902.65	\$ 897.26	\$ 28,801.46	\$ 3,998.46
39-388-0418	418	\$ 28,977.44	\$ 2,520.32	\$ 1,631.92	\$ 33,129.68	\$ 931.77	\$ 29,909.21	\$ 4,152.24
39-388-0448	448	\$ 21,733.08	\$ 1,890.24	\$ 1,223.94	\$ 24,847.26	\$ 698.83	\$ 22,431.91	\$ 3,114.18
39-388-0449	449	\$ 21,733.08	\$ 1,890.24	\$ 1,223.94	\$ 24,847.26	\$ 698.83	\$ 22,431.91	\$ 3,114.18
39-388-0450	450	\$ 21,733.08	\$ 1,890.24	\$ 1,223.94	\$ 24,847.26	\$ 698.83	\$ 22,431.91	\$ 3,114.18
39-388-0451	451	\$ 21,733.08	\$ 1,890.24	\$ 1,223.94	\$ 24,847.26	\$ 698.83	\$ 22,431.91	\$ 3,114.18
39-388-0452	452	\$ 21,733.08	\$ 1,890.24	\$ 1,223.94	\$ 24,847.26	\$ 698.83	\$ 22,431.91	\$ 3,114.18
39-388-0453	453	\$ 21,733.08	\$ 1,890.24	\$ 1,223.94	\$ 24,847.26	\$ 698.83	\$ 22,431.91	\$ 3,114.18
39-388-0454	454	\$ 21,733.08	\$ 1,890.24	\$ 1,223.94	\$ 24,847.26	\$ 698.83	\$ 22,431.91	\$ 3,114.18
Total		\$ 324,386.29	\$ 28,213.63	\$ 18,268.44	\$ 370,868.36	\$ 10,430.67	\$ 334,816.96	\$ 46,482.07

Footnotes:

- (1) \$47,805,000 Firefly Public Infrastructure District No. 1, Special Assessment Bonds, Series 2024A-2.
(2) Per Section 5.4(d) of the Indenture of Trust and Pledge dated as of April 1, 2024 between Firefly Public Infrastructure District No. 1 as Issuer and UMB Bank, N.A. as Trustee Authorizing the issuance of \$47,805,000 Special Assessment Bonds Series 2024A-2 (Firefly Assessment Area No. 1) (the "Indenture"), in the event an assessment prepayment is received the Trustee shall transfer monies from the Reserve Account to the Redemption Account in an amount equal to the respective prepaid parcel's pro rata share of the monies in the Reserve Account as shown above.
(3) Per Section 5.6 of the Indenture, in the event an assessment prepayment is received, the Trustee shall transfer monies from the Capitalized Interest Account to the Redemption Account in an amount equal to the respective prepaid parcel's pro rata share of the monies in the Capitalized Interest Account as shown above.

EXHIBIT D

AMENDED ASSESSMENT LIST

Assessment Method and Amount

Firefly
Public Infrastructure District No. 1
Assessment Allocation as of 6/1/2025

Description	Total Planned Units	Candlelight Homes Remaining	ERU per Unit	DAI Units Remaining	ERU per Unit	Total Outstanding Assessments	Appraised Value	VtL Ratio
Neighborhood Planning Area 5								
SDL (0.50 Ac.) - 120'	34	-	-	34	2.07	\$ 1,895,185	\$ 10,200,000	5.3821
SFDL (0.50 Ac.) - 95'	35	-	-	35	2.07	\$ 1,950,926	\$ 10,500,000	5.3821
SDL (1.15 Ac.)	37	-	-	37	2.77	\$ 2,759,840	\$ 14,800,000	5.3626
Subtotal	106	-		106		\$ 6,605,951	\$ 35,500,000	
Neighborhood Planning Area 7								
SFD Cottage (0.08 Ac.)	52	-	-	52	0.86	\$ 1,204,215	\$ 6,500,000	5.3977
SFD Alley (0.10 Ac.)	9	-	-	9	0.90	\$ 218,116	\$ 1,170,000	5.3641
SFD Alley (0.11 Ac.)	12	-	-	12	0.92	\$ 297,284	\$ 1,590,000	5.3484
SFDS (0.10 - 0.12 Ac.)	208	-	-	208	0.90	\$ 5,040,902	\$ 27,040,000	5.3641
SFDS (0.12 - 0.14 Ac.)	28	-	-	28	0.93	\$ 701,202	\$ 3,780,000	5.3907
SFDS (0.14 - 0.16 Ac.)	24	-	-	24	0.97	\$ 626,881	\$ 3,360,000	5.3599
SFDS (0.17 - 0.19 Ac.)	19	-	-	19	1.02	\$ 521,863	\$ 2,802,500	5.3702
Subtotal	352	-		352		\$ 8,610,463	\$ 46,242,500	
Neighborhood Planning Area 8								
THFL 11 DU/Ac	132	124	0.81	-	0.73	\$ 2,732,345	\$ 13,020,000	4.7651
TH Alley 13.5 DU/Ac	314	303	0.81	-	0.73	\$ 6,676,618	\$ 31,815,000	4.7651
SFD Alley (0.10 Ac.)	99	92	1.00	4	0.90	\$ 2,539,686	\$ 12,480,000	4.8006
SFD Alley (0.11 Ac.)	90	80	1.02	1	0.92	\$ 2,244,600	\$ 10,732,500	4.7815
SFDS (0.10 - 0.12 Ac)	189	151	1.00	33	0.90	\$ 4,907,526	\$ 23,920,000	4.8741
SFDS (0.12 - 0.14 Ac)	138	102	1.04	32	0.93	\$ 3,667,149	\$ 18,090,000	4.9062
SFDS (0.14 - 0.16 Ac)	100	63	1.08	31	0.97	\$ 2,660,666	\$ 13,160,000	4.9461
SFDS (0.17 - 0.19 Ac)	56	31	1.13	17	1.02	\$ 1,419,877	\$ 7,080,000	4.9863
Subtotal	1,118	946		118		\$ 26,928,468	\$ 130,297,500	
Neighborhood Planning Area 9								
Condo	278	-	-	278	0.35	\$ 2,620,084	\$ 13,900,000	5.3052
THFL 11 DU/Ac	24	-	-	24	0.73	\$ 471,777	\$ 2,520,000	5.3415
TH Alley 13.5 DU/Ac	24	-	-	24	0.73	\$ 471,777	\$ 2,520,000	5.3415
TH Alley 15 DU/Ac	44	-	-	44	0.73	\$ 864,924	\$ 4,620,000	5.3415
Subtotal	370	-		370		\$ 4,428,561	\$ 23,560,000	
Total	1,946	946		946		\$ 46,573,444	\$ 235,600,000	

**Firefly
Public Infrastructure District No. 1
Special Assessment Bonds, Series 2024A-2
Assessment Roll as of 6/1/2025**

No.	PARCEL NO.	NAME OF OWNER	PRODUCT TYPE	ERUs	ASSESSMENT
1	39-384-0301	DAICLH LLC	SFD Alley (0.10 Ac.)	1.00	\$ 27,204
2	39-384-0302	DAICLH LLC	SFD Alley (0.11 Ac.)	1.02	\$ 27,748
3	39-384-0303	DAICLH LLC	SFD Alley (0.10 Ac.)	1.00	\$ 27,204
4	39-384-0304	DAICLH LLC	SFD Alley (0.11 Ac.)	1.02	\$ 27,748
5	39-384-0305	DAICLH LLC	SFD Alley (0.10 Ac.)	1.00	\$ 27,204
6	39-384-0312	DAICLH LLC	SFD Alley (0.10 Ac.)	1.00	\$ 27,204
7	39-384-0315	DAICLH LLC	SFD Alley (0.10 Ac.)	1.00	\$ 27,204
8	39-384-0316	DAICLH LLC	SFD Alley (0.11 Ac.)	1.02	\$ 27,748
9	39-384-0317	DAICLH LLC	SFD Alley (0.11 Ac.)	1.02	\$ 27,748
10	39-384-0318	DAICLH LLC	SFD Alley (0.10 Ac.)	1.00	\$ 27,204
11	39-384-0319	DAICLH LLC	SFD Alley (0.11 Ac.)	1.02	\$ 27,748
12	39-384-0320	DAICLH LLC	SFD Alley (0.11 Ac.)	1.02	\$ 27,748
13	39-384-0321	DAICLH LLC	SFD Alley (0.10 Ac.)	1.00	\$ 27,204
14	39-384-0322	DAICLH LLC	SFD Alley (0.10 Ac.)	1.00	\$ 27,204
15	39-384-0323	DAICLH LLC	SFD Alley (0.11 Ac.)	1.02	\$ 27,748
16	39-388-0404	DAICLH LLC	SFDS (0.14 - 0.16 Ac)	1.08	\$ 29,380
17	39-388-0411	DAICLH LLC	SFDS (0.14 - 0.16 Ac)	1.08	\$ 29,380
18	39-388-0412	DAICLH LLC	SFDS (0.17 - 0.19 Ac)	1.13	\$ 30,740
19	39-388-0413	DAICLH LLC	SFDS (0.17 - 0.19 Ac)	1.13	\$ 30,740
20	39-388-0414	DAICLH LLC	SFDS (0.17 - 0.19 Ac)	1.13	\$ 30,740
21	39-388-0416	DAICLH LLC	SFDS (0.12 - 0.14 Ac)	1.04	\$ 28,292
22	39-388-0419	DAICLH LLC	SFDS (0.17 - 0.19 Ac)	1.13	\$ 30,740
23	39-388-0420	DAICLH LLC	SFDS (0.10 - 0.12 Ac)	1.00	\$ 27,204
24	39-388-0421	DAICLH LLC	SFDS (0.10 - 0.12 Ac)	1.00	\$ 27,204
25	39-388-0422	DAICLH LLC	SFDS (0.10 - 0.12 Ac)	1.00	\$ 27,204
26	39-388-0423	DAICLH LLC	SFDS (0.10 - 0.12 Ac)	1.00	\$ 27,204
27	39-388-0424	DAICLH LLC	SFDS (0.12 - 0.14 Ac)	1.04	\$ 28,292
28	39-388-0425	DAICLH LLC	SFDS (0.17 - 0.19 Ac)	1.13	\$ 30,740
29	39-388-0426	DAICLH LLC	SFDS (0.17 - 0.19 Ac)	1.13	\$ 30,740
30	39-388-0427	DAICLH LLC	SFDS (0.12 - 0.14 Ac)	1.04	\$ 28,292
31	39-388-0428	DAICLH LLC	SFDS (0.12 - 0.14 Ac)	1.04	\$ 28,292
32	39-388-0429	DAICLH LLC	SFDS (0.12 - 0.14 Ac)	1.04	\$ 28,292

33	39-388-0430	DAICLHLLC	SFDS (0.14 - 0.16 Ac)	1.08	\$	29,380
34	39-388-0431	DAICLHLLC	SFDS (0.17 - 0.19 Ac)	1.13	\$	30,740
35	39-388-0432	DAICLHLLC	SFDS (0.14 - 0.16 Ac)	1.08	\$	29,380
36	39-388-0433	DAICLHLLC	SFDS (0.12 - 0.14 Ac)	1.04	\$	28,292
37	39-388-0434	DAICLHLLC	SFDS (0.10 - 0.12 Ac)	1.00	\$	27,204
38	39-388-0435	DAICLHLLC	SFDS (0.10 - 0.12 Ac)	1.00	\$	27,204
39	39-388-0436	DAICLHLLC	THFL 11 DU/Ac	0.81	\$	22,035
40	39-388-0437	DAICLHLLC	THFL 11 DU/Ac	0.81	\$	22,035
41	39-388-0438	DAICLHLLC	THFL 11 DU/Ac	0.81	\$	22,035
42	39-388-0439	DAICLHLLC	THFL 11 DU/Ac	0.81	\$	22,035
43	39-388-0440	DAICLHLLC	THFL 11 DU/Ac	0.81	\$	22,035
44	39-388-0441	DAICLHLLC	THFL 11 DU/Ac	0.81	\$	22,035
45	39-388-0442	DAICLHLLC	THFL 11 DU/Ac	0.81	\$	22,035
46	39-388-0443	DAICLHLLC	THFL 11 DU/Ac	0.81	\$	22,035
47	39-388-0444	DAICLHLLC	THFL 11 DU/Ac	0.81	\$	22,035
48	39-388-0445	DAICLHLLC	THFL 11 DU/Ac	0.81	\$	22,035
49	39-388-0446	DAICLHLLC	THFL 11 DU/Ac	0.81	\$	22,035
50	39-388-0447	DAICLHLLC	THFL 11 DU/Ac	0.81	\$	22,035
51	39-393-0501	DAICLHLLC	SFD Alley (0.11 Ac.)	1.02	\$	27,748
52	39-393-0502	DAICLHLLC	SFD Alley (0.10 Ac.)	1.00	\$	27,204
53	39-393-0503	DAICLHLLC	SFD Alley (0.11 Ac.)	1.02	\$	27,748
54	39-393-0504	DAICLHLLC	SFD Alley (0.10 Ac.)	1.00	\$	27,204
55	39-393-0505	DAICLHLLC	SFD Alley (0.11 Ac.)	1.02	\$	27,748
56	39-393-0506	DAICLHLLC	SFD Alley (0.11 Ac.)	1.02	\$	27,748
57	39-393-0507	DAICLHLLC	SFD Alley (0.11 Ac.)	1.02	\$	27,748
58	39-393-0508	DAICLHLLC	SFD Alley (0.11 Ac.)	1.02	\$	27,748
59	39-393-0509	DAICLHLLC	SFD Alley (0.10 Ac.)	1.00	\$	27,204
60	39-393-0510	DAICLHLLC	SFD Alley (0.10 Ac.)	1.00	\$	27,204
61	39-393-0511	DAICLHLLC	SFD Alley (0.11 Ac.)	1.02	\$	27,748
62	39-393-0512	DAICLHLLC	SFD Alley (0.11 Ac.)	1.02	\$	27,748
63	39-393-0513	DAICLHLLC	SFD Alley (0.11 Ac.)	1.02	\$	27,748
64	39-393-0514	DAICLHLLC	SFD Alley (0.10 Ac.)	1.00	\$	27,204
65	39-393-0515	DAICLHLLC	SFD Alley (0.10 Ac.)	1.00	\$	27,204
66	39-393-0516	DAICLHLLC	SFD Alley (0.11 Ac.)	1.02	\$	27,748
67	39-393-0517	DAICLHLLC	SFD Alley (0.11 Ac.)	1.02	\$	27,748
68	39-393-0518	DAICLHLLC	SFD Alley (0.10 Ac.)	1.00	\$	27,204
69	39-393-0519	DAICLHLLC	SFD Alley (0.10 Ac.)	1.00	\$	27,204
70	39-393-0520	DAICLHLLC	SFD Alley (0.11 Ac.)	1.02	\$	27,748
71	39-393-0521	DAICLHLLC	TH Alley 13.5 DU/Ac	0.81	\$	22,035
72	39-393-0522	DAICLHLLC	TH Alley 13.5 DU/Ac	0.81	\$	22,035
73	39-393-0523	DAICLHLLC	TH Alley 13.5 DU/Ac	0.81	\$	22,035

74	39-393-0524	DAICLH LLC	TH Alley 13.5 DU/Ac	0.81	\$	22,035
75	39-393-0525	DAICLH LLC	TH Alley 13.5 DU/Ac	0.81	\$	22,035
76	39-393-0526	DAICLH LLC	TH Alley 13.5 DU/Ac	0.81	\$	22,035
77	39-393-0527	DAICLH LLC	TH Alley 13.5 DU/Ac	0.81	\$	22,035
78	39-393-0528	DAICLH LLC	TH Alley 13.5 DU/Ac	0.81	\$	22,035
79	39-393-0529	DAICLH LLC	TH Alley 13.5 DU/Ac	0.81	\$	22,035
80	39-393-0530	DAICLH LLC	TH Alley 13.5 DU/Ac	0.81	\$	22,035
81	39-393-0531	DAICLH LLC	TH Alley 13.5 DU/Ac	0.81	\$	22,035
82	39-393-0532	DAICLH LLC	TH Alley 13.5 DU/Ac	0.81	\$	22,035
83	39-393-0533	DAICLH LLC	TH Alley 13.5 DU/Ac	0.81	\$	22,035
84	39-393-0534	DAICLH LLC	TH Alley 13.5 DU/Ac	0.81	\$	22,035
85	39-393-0535	DAICLH LLC	TH Alley 13.5 DU/Ac	0.81	\$	22,035
86	39-393-0536	DAICLH LLC	TH Alley 13.5 DU/Ac	0.81	\$	22,035
87	39-393-0537	DAICLH LLC	TH Alley 13.5 DU/Ac	0.81	\$	22,035
88	39-393-0538	DAICLH LLC	TH Alley 13.5 DU/Ac	0.81	\$	22,035
89	39-393-0539	DAICLH LLC	TH Alley 13.5 DU/Ac	0.81	\$	22,035
90	39-393-0540	DAICLH LLC	TH Alley 13.5 DU/Ac	0.81	\$	22,035
91	39-393-0541	DAICLH LLC	TH Alley 13.5 DU/Ac	0.81	\$	22,035
92	39-393-0542	DAICLH LLC	TH Alley 13.5 DU/Ac	0.81	\$	22,035
93	39-393-0543	DAICLH LLC	TH Alley 13.5 DU/Ac	0.81	\$	22,035
94	39-393-0544	DAICLH LLC	TH Alley 13.5 DU/Ac	0.81	\$	22,035
95	39-393-0545	DAICLH LLC	TH Alley 13.5 DU/Ac	0.81	\$	22,035
96	39-393-0546	DAICLH LLC	TH Alley 13.5 DU/Ac	0.81	\$	22,035
97	39-393-0547	DAICLH LLC	THFL 11 DU/Ac	0.81	\$	22,035
98	39-393-0548	DAICLH LLC	THFL 11 DU/Ac	0.81	\$	22,035
99	39-393-0549	DAICLH LLC	THFL 11 DU/Ac	0.81	\$	22,035
100	39-393-0550	DAICLH LLC	THFL 11 DU/Ac	0.81	\$	22,035
101	39-393-0551	DAICLH LLC	THFL 11 DU/Ac	0.81	\$	22,035
102	39-393-0552	DAICLH LLC	THFL 11 DU/Ac	0.81	\$	22,035
103	39-393-0553	DAICLH LLC	THFL 11 DU/Ac	0.81	\$	22,035
104	39-393-0554	DAICLH LLC	THFL 11 DU/Ac	0.81	\$	22,035
105	39-393-0555	DAICLH LLC	THFL 11 DU/Ac	0.81	\$	22,035
106	39-393-0556	DAICLH LLC	THFL 11 DU/Ac	0.81	\$	22,035
107	39-393-0557	DAICLH LLC	THFL 11 DU/Ac	0.81	\$	22,035
108	39-393-0558	DAICLH LLC	THFL 11 DU/Ac	0.81	\$	22,035
109	39-393-0559	DAICLH LLC	THFL 11 DU/Ac	0.81	\$	22,035
110	39-393-0560	DAICLH LLC	THFL 11 DU/Ac	0.81	\$	22,035
111	39-393-0561	DAICLH LLC	THFL 11 DU/Ac	0.81	\$	22,035
112	39-393-0562	DAICLH LLC	THFL 11 DU/Ac	0.81	\$	22,035
113	39-393-0563	DAICLH LLC	THFL 11 DU/Ac	0.81	\$	22,035
114	39-393-0564	DAICLH LLC	THFL 11 DU/Ac	0.81	\$	22,035
115	39-393-0565	DAICLH LLC	THFL 11 DU/Ac	0.81	\$	22,035
116	53:051:0030	GSFJV LLC	N/A	90.36	\$	2,433,731
117	53:051:0031	Multiple	N/A	154.94	\$	4,172,220
118	53:049:0051	OQUIRRH WOOD RANCH LLC	N/A	250.14	\$	6,735,761
119	53:052:0022	OQUIRRH WOOD RANCH LLC	N/A	161.01	\$	4,874,180
120	53:052:0026	DAICLH LLC	N/A	773.64	\$	21,044,828
121	53:048:0107	OQUIRRH WOOD RANCH LLC	N/A	125.26	\$	3,372,908
122	53:053:0050	OQUIRRH WOOD RANCH LLC	N/A	39.20	\$	1,055,654

Legal Description

The Assessment Area is more particularly described as follows:

That certain real property located in Utah County, State of Utah and described as follows:

NPA-5

A parcel of land situate within the North Half (N-1/2) of Section 19, Township 6 South, Range 2 West, Salt Lake Base and Meridian, located in Eagle Mountain City, County of Utah, State of Utah, being described as follows:

Beginning at a point in the Section Line common to Sections 19 & 20, said point being S 00° 30' 42" W, along the Section line, a distance of 79.55 feet from the Section Corner common to Sections 17, 18, 19, & 20, Township 6 South, Range 2 West, more or less, to the Northerly line of NPA-5; and running thence along said Northerly line the following Twenty-Four (24) courses: (1) West, a distance of 58.43 feet; (2) North, a distance of 28.50 feet; (3) West, a distance of 69.02 feet to the beginning of a curve: (4) along the arc of said curve turning to the right through an angle of 90° 00' 00", having a radius of 15.00 feet, and whose long chord bears N 45° 00' 00" W, a distance of 21.21 feet to a point of intersection with a non-tangential line: (5) West, a distance of 57.00 feet to the beginning of a non-tangential curve; (6) along the arc of said curve turning to the right through an angle of 90° 00' 00", having a radius of 15.00 feet, and whose long chord bears S 45° 00' 00" W, a distance of 21.21 feet; (7) West, a distance of 621.55 feet to the beginning of a curve; (8) along the arc of said curve turning to the right through an angle of 92° 56' 20", having a radius of 15.00 feet, and whose long chord bears N 43° 31' 50" W, a distance of 21.75 feet to a point of intersection with a non-tangential line; (9) N 87° 03' 39" W, a distance of 12.50 feet; (10) S 84° 44' 32" W, a distance of 32.34 feet; (11) N 86° 45' 40" W, a distance of 12.50 feet to the beginning of a non-tangential curve; (12) along the arc of said curve turning to the right through an angle of 86° 45' 40", having a radius of 15.00 feet, and whose long chord bears S 46° 37' 10" W, a distance of 20.61 feet; (13) West, a distance of 165.31 feet to the beginning of a curve; (14) along the arc of said curve turning to the right through an angle of 07° 47' 39", having a radius of 221.50 feet, and whose long chord bears N 86° 06' 11" W, a distance of 30.11 feet; (15) N 82° 12' 21" W, a distance of 16.02 feet to the beginning of a curve; (16) along the arc of said curve turning to the right through an angle of 90° 00' 00", having a radius of 15.00 feet, and whose long chord bears N 37° 12' 21" W, a distance of 21.21 feet to a point of intersection with a non-tangential line; (17) N 82° 12' 21" W, a distance of 57.00 feet; (18) S 07° 47' 39" W, a distance of 43.50 feet to the beginning of a curve; (19) along the arc of said curve turning to the right through 77° 03' 14", having a radius of 571.50 feet, and whose long chord bears S 46° 19' 16" W, a distance of 711.95 feet to the beginning of a non-tangential curve; (20) along the arc of said curve turning to the left through an angle of 25° 54' 02", having a radius of 980.00 feet, and whose long chord bears S 71° 53' 51" W, a distance of 439.25 feet; (21) S 58° 56' 50" W, a distance of 448.58 feet to the beginning of a curve; (22) along the arc of said curve turning to the right through an angle of 31° 03' 10", having a radius of 700.00 feet, and whose long chord bears S 74° 28' 25" W, a distance of 374.75 feet; (23) West, for a distance of 594.80 feet, to a phase line; (24) West for a distance of 531.44 feet, to the North-South 1/16th line of the Northwest Quarter of said Section 19; thence S 0°21'12" W, along said 1/16th line, a distance

of 1627.04 feet, to the Quarter Corner common to Section 19, Township 6 South, Range 2 West and Section 24, Township 6 South, Range 3 West, Salt Lake Base and Meridian; thence South 89°54'04" East, along the East-West Center Quarter Line of said Section 19, a distance of 2669.96 feet, to the North-South 1/16th line of the Northeast Quarter of said Section 19; thence N 0°22'47" E, a distance of 1334.90 feet, to the Northeast 1/16th corner; thence South 89°40'33" East, along the East-West 1/16th line, a distance of 733.66 feet, to the southerly projection of the West line of the J&J Ranch Subdivision; thence North 0°30'42" East, along the West line of said J& J Ranch Subdivision and the projection thereof, a distance of 977.96 feet, to the Northwest corner of said subdivision; thence S 89°27'13" E, along the North line of said Subdivision, a distance of 600.00 feet, to the Northeast corner of said subdivision, and the Section Line common to Sections 19 & 20; thence North 0°30'42" East, along said section line, a distance of 274.33 feet, to the point of beginning.

Contains: 5,917,975 Sq. Ft., or 135.858 Acres.

NPA-7

A parcel of land situate within the Southwest Quarter (SW-1/4) of section 17, and the Northwest Quarter (NW-1/4) of Section 20, Township 6 South, Range 2 West, Salt Lake Base and Meridian, located in Eagle Mountain City, County of Utah, State of Utah, being described as follows:

Beginning at a point in the Easterly Right-of-Way line of S.R.-73, said point being S 2°55'59" W, along the North-South Center Quarter line of said Section 20, a distance of 2499.48 feet, and N 87°04'01" W, perpendicular to said Center Quarter line, a distance of 1074.44 feet, from the Quarter Corner common to said Sections 17 & 20, Township 6 South, Range 2 West, Salt Lake Base and Meridian; and running thence N 08° 51' 32" W, a distance of 4249.61 feet, to the Southerly Right-of-Way line of Pole Canyon Boulevard, per the Tyson Subdivision; thence along said Southerly Right-of-Way line the following Three (3) courses: (1) S 89° 52' 16" E, a distance of 797.11 feet to the beginning of a curve; (2) along the arc of said curve turning to the right through an angle of 31° 37' 21", a distance of 510.52 feet, having a radius of 925.00 feet, and whose long chord bears S 74° 03' 36" E, a distance of 504.07 feet; (3) S 58° 14' 55" E, a distance of 164.94 feet; thence S 31° 45' 08" W, a distance of 44.39 feet to the beginning of a curve; thence along the arc of said curve turning to the right through 23° 26' 40", a distance of 327.35 feet, having a radius of 800.00 feet, and whose long chord bears S 43° 28' 28" W, a distance of 325.07 feet to the beginning of a non-tangential curve; thence along the arc of said curve turning to the left through an angle of 100° 07' 52", a distance of 812.64 feet, having a radius of 465.00 feet, and whose long chord bears S 05° 07' 52" W, a distance of 713.11 feet to a point of intersection with a non-tangential line; thence S 45° 03' 56" W, a distance of 95.31 feet to the beginning of a curve; thence along the arc of said curve turning to the left through an angle of 76° 15' 43", 465.86 feet, having a radius of 350.00 feet, and whose long chord bears S 06° 56' 04" W, a distance of 432.22 feet; thence S 31° 11' 47" E, a distance of 53.06 feet; thence S 31° 11' 47" E, a distance of 114.55 feet to the beginning of a curve; thence along the arc of said curve turning to the right through an angle of 12° 01' 49", a distance of 41.99 feet, having a radius of 200.00 feet, and whose long chord bears S 25° 10' 53" E, a distance of 41.9165 feet; S 19° 09' 58" E, a distance of 182.21 feet to the beginning

of a curve; thence along the arc of said curve turning to the right through $24^{\circ} 16' 10''$, a distance of 338.86 feet, having a radius of 800.00 feet, and whose long chord bears $S 07^{\circ} 01' 53'' E$, a distance of 336.34 feet to the beginning of a non-tangential curve; thence along the arc of said curve turning to the right through an angle of $07^{\circ} 04' 25''$, a distance of 98.77 feet, having a radius of 800.00 feet, and whose long chord bears $S 08^{\circ} 38' 24'' W$, a distance of 98.70 feet; thence $S 12^{\circ} 10' 37'' W$, a distance of 188.93 feet to the beginning of a curve; thence along the arc of said curve turning to the left through an angle of $38^{\circ} 38' 19''$, a distance of 337.19 feet, having a radius of 500.00 feet, and whose long chord bears $S 07^{\circ} 08' 33'' E$ for a distance of 330.83 feet; thence $S 26^{\circ} 27' 42'' E$, a distance of 972.55 feet to the beginning of a curve; thence along the arc of said curve turning to the right through an angle of $20^{\circ} 22' 43''$, a distance of 177.84 feet, having a radius of 500.00 feet, and whose long chord bears $S 16^{\circ} 16' 21'' E$, a distance of 176.90 feet; thence $S 06^{\circ} 05' 00'' E$, a distance of 148.44 feet to the Southerly Right-of-Way line of proposed Tyson Parkway and the beginning of a non-tangential curve; thence along said proposed Southerly Right-of-Way line the following Two (2) Courses: (1) along the arc of said curve turning to the right through an angle of $06^{\circ} 05' 00''$, a distance of 109.30 feet, having a radius of 1029.50 feet, and whose long chord bears $S 86^{\circ} 57' 30'' W$, a distance of 109.25 feet; (2) West, a distance of 918.84 feet to the point of beginning.

Contains: 3,719,247 Sq. Ft., or 85.382 Acres

NPA-8

A parcel of land situate within the South Half (S-1/2) of Section 17, the Southwest Quarter (SW-1/4) of Section 16, the Northwest Quarter (NW-1/4) of Section 21, and the North Half (N1/2) of Section 20, all in Township 6 South, Range 2 West, Salt Lake Base and Meridian, located in Eagle Mountain City, County of Utah, State of Utah, being described as follows:

Beginning at a point in the Southerly Right-of-Way line of Pole Canyon Boulevard, per the Tyson Subdivision, said point being $S 89^{\circ} 29' 39'' E$, along the Section line common to said Sections 17 & 20, a distance of 415.11 feet and $N 0^{\circ} 30' 21'' E$, perpendicular to said section line, a distance of 1186.84 feet, from the Quarter Corner common to said Sections 17 & 20, Township 6 South, Range 2 West, Salt Lake Base and Meridian; and running thence along said Southerly Right-of-Way line the following Three (3) courses: (1) $S 89^{\circ} 32' 56'' E$, a distance of 2253.72 feet to the beginning of a curve; (2) along the arc of said curve turning to the right through an angle of $30^{\circ} 28' 59''$, a distance of 492.13 feet, having a radius of 925.00 feet, and whose long chord bears $S 74^{\circ} 18' 27'' E$, a distance of 486.35 feet; (3) $S 59^{\circ} 03' 57'' E$, a distance of 1231.40 feet, to the Southerly Right-of-Way line of proposed Tyson Parkway; thence along said Southerly line the following Two (2) courses: (1) $S 30^{\circ} 56' 04'' W$, a distance of 241.00 feet to the beginning of a curve; (2) along the arc of said curve turning to the right through an angle of $15^{\circ} 06' 41''$, a distance of 403.49 feet, having a radius of 1529.50 feet, and whose long chord bears $S 38^{\circ} 29' 25'' W$, a distance of 402.23 feet to a point of intersection with the White Hills Water Company Parcel; thence along the lines of said White Hills Water Company Parcel the following Four (4) courses: (1) $N 00^{\circ} 37' 31'' E$, a distance of 166.06 feet; (2) $N 89^{\circ} 22' 57'' W$, a distance of 200.00 feet; (3) $S 00^{\circ} 37' 31'' W$, a distance of 200.00 feet; (4) $S 89^{\circ} 22' 57'' E$, a distance of 164.42 feet to aforesaid Southerly line of proposed

Tyson Parkway and the beginning of a non-tangential curve; thence along said Southerly line of proposed Tyson Parkway the following along Eleven (11) courses: (1) along the arc of said curve turning to the right through an angle of $05^{\circ} 54' 51''$, a distance of 157.87 feet, having a radius of 1529.50 feet, and whose long chord bears S $50^{\circ} 50' 42''$ W, a distance of 157.80 feet; (2) S $53^{\circ} 48' 08''$ W, a distance of 377.53 feet to the beginning of a curve; (3) along the arc of said curve turning to the right through an angle of $06^{\circ} 25' 35''$, a distance of 187.70 feet, having a radius of 1673.50 feet, and whose long chord bears S $57^{\circ} 00' 55''$ W, a distance of 187.60 feet; (4) S $60^{\circ} 13' 42''$ W, a distance of 192.16 feet to the beginning of a curve; (5) along the arc of said curve turning to the left through an angle of $30^{\circ} 45' 57''$, a distance of 735.91 feet, having a radius of 1370.50 feet, and whose long chord bears S $44^{\circ} 50' 44''$ W, a distance of 727.10 feet; (6) S $29^{\circ} 27' 45''$ W, a distance of 372.32 feet to the beginning of a curve; (7) thence along the arc of said curve turning to the right through $70^{\circ} 51' 45''$, a distance of 1158.87 feet, having a radius of 937.00 feet, and whose long chord bears S $64^{\circ} 53' 38''$ W, a distance of 1086.41 feet to the beginning of a reverse curve; (8) along the arc of said curve turning to the left through $23^{\circ} 22' 27''$, a distance of 447.73 feet, having a radius of 1097.50 feet, and whose long chord bears S $88^{\circ} 38' 17''$ W, a distance of 444.63 feet; (9) S $76^{\circ} 57' 04''$ W, a distance of 21.35 feet to the beginning of a curve; (10) along the arc of said curve turning to the left through $22^{\circ} 09' 31''$, a distance of 646.05 feet, having a radius of 1670.50 feet, and whose long chord bears S $65^{\circ} 52' 19''$ W, a distance of 642.03 feet to a point of a reverse curve; (11) thence along the arc of curve turning to the right through an angle of $29^{\circ} 07' 27''$, a distance of 523.31 feet, having a radius of 1029.50 feet, and whose long chord bears S $69^{\circ} 21' 17''$ W, a distance of 517.6915 feet to a point of intersection with the centerline of proposed Wildwood Drive and the aforesaid Southerly line of Tyson parkway; thence along said centerline the following Fourteen (14) courses: (1) N $06^{\circ} 05' 00''$ W for a distance of 148.44 feet to the beginning of a curve; (2) along the arc of said curve turning to the left through an angle of $20^{\circ} 22' 43''$, a distance of 177.74 having a radius of 500.00 feet, and whose long chord bears N $16^{\circ} 16' 21.0''$ W for a distance of 176.90 feet; (3) N $26^{\circ} 27' 42''$ W, a distance of 972.55 feet to the beginning of a curve; (4) along the arc of said curve turning to the right through an angle of $38^{\circ} 38' 19''$, a distance of 337.19 feet, having a radius of 500.00 feet, and whose long chord bears N $07^{\circ} 08' 33''$ W, a distance of 330.83 feet; (5) N $12^{\circ} 10' 37''$ E, a distance of 188.93 feet to the beginning of a curve; (6) along the arc of said curve turning to the left through $31^{\circ} 20' 36''$, a distance of 437.63 feet, having a radius of 800.00 feet, and whose long chord bears N $03^{\circ} 29' 41''$ W, a distance of 432.19 feet; (7) N $19^{\circ} 09' 58''$ W, a distance of 182.21 feet to the beginning of a curve; (8) along the arc of said curve turning to the left through an angle of $12^{\circ} 01' 49''$, a distance of 41.99 feet, having a radius of 200.00 feet, and whose long chord bears N $25^{\circ} 10' 53''$ W, a distance of 41.92 feet; (9) N $31^{\circ} 11' 47''$ W, a distance of 167.61 feet to the beginning of a curve; (10) along the arc of said curve turning to the right through an angle of $76^{\circ} 15' 43''$, a distance of 465.86 feet, having a radius of 350.00 feet, and whose long chord bears N $06^{\circ} 56' 04''$ E, a distance of 432.22 feet; (11) N $45^{\circ} 03' 56''$ E, a distance of 95.31 feet to the beginning of a non-tangential curve; (12) along the arc of said curve turning to the right through $100^{\circ} 07' 52''$, a distance of 812.64 feet, having a radius of 465.00 feet, and whose long chord bears N $05^{\circ} 07' 52''$ E, a distance of 713.11 feet to the beginning of a reverse curve; (13) along the arc of aid curve turning to the left through an angle of $23^{\circ} 26' 40''$, a distance of 327.35 feet, having a radius of 800.00 feet, and whose long chord bears N $43^{\circ} 28' 28''$ E, a distance of 325.07 feet.; (14) N $31^{\circ} 45' 08''$ E, a distance of 44.39 feet to the aforesaid Southerly Right-of-Way Line of Pole Canyon Boulevard, per the

Tyson Subdivision; thence along said Southerly Right-of-Way Line the following two (2) courses: (1) S 58° 14' 55" E, a distance of 354.75 feet to the beginning of a curve; (2) along the arc of said curve turning to the left through 31° 18' 01", a distance of 587.27 feet, having a radius of 1075.00 feet, and whose long chord bears S 73° 53' 56" E, a distance of 579.99 feet to the point of beginning.

Contains: 12,521,219 Sq. Ft., or 287.448 Acres

NPA-9

A parcel of land situate within the Southwest Quarter (SW-1/4) of Section 16, and the North half (N-1/2) of Section 21, Township 6 South, Range 2 West, Salt Lake Base and Meridian, located in Eagle Mountain City, County of Utah, State of Utah, being described as follows:

Beginning at a point the Southwesterly line Right-of-Way line of Pole Canyon Boulevard, per Tyson Subdivision, said point being N 89° 23' 00" W, along the Section Line common to said Sections 16 & 21, a distance of 1032.29 feet, and N 0° 37' 00" E, perpendicular to said Sections Line, a distance of 440.91 feet, from the Quarter Corner common to said Sections 16 & 21, Township 6 South, Range 2 West, Salt Lake Base and Meridian; and running thence said Right-of-Way line the following Three (3) Courses: (1) S 59° 03' 57" E, a distance of 731.32 feet the beginning of a curve; (2) along the arc of said curve turning to the left through an angle of 30° 36' 36", a distance of 574.31 feet, having a radius of 1075.00 feet, and whose long chord bears S 74° 22' 15" E, a distance of 567.51 feet; (3) S 89° 40' 33" E, a distance of 432.25 feet; thence S 00° 19' 30" W, a distance of 409.12 feet to the beginning of a curve; thence along the arc of said curve turning to the right through an angle of 74° 29' 58", a distance of 1170.23 feet, having a radius of 900.00 feet, and whose long chord bears S 37° 34' 30" W, a distance of 1089.52 feet; thence S 74° 49' 29" W, a distance of 185.03 feet to the beginning of a curve; thence along the arc of said curve turning to the left through an angle of 54° 56' 14", a distance of 383.53 feet, having a radius of 400.00 feet, and whose long chord bears S 47° 21' 22" W, a distance of 369.01 feet; thence S 19° 53' 15" W, a distance of 98.94 feet; thence N 70° 06' 45" W, a distance of 501.92 feet to the beginning of a curve; thence along the arc of said curve turning to the right through an angle of 31° 41' 38", a distance of 331.90 feet, having a radius of 600.00 feet, and whose long chord bears N 54° 15' 55" W, a distance of 327.68 feet to a point of intersection with a non-tangential line; thence N 33° 33' 29" W, a distance of 111.09 feet, to the White Hills Water parcel; thence along the lines of said White Hills Water Parcel the following Two (2) courses: (1) N 00° 37' 31" E, a distance of 113.46 feet; (2) N 89° 22' 57" W, a distance of 77.05 feet; thence N 33° 33' 29" W, a distance of 31.26 feet to the beginning of a non-tangential curve; thence along the arc of said curve turning to the left through an angle of 27° 40' 44", a distance of 289.85 feet, having a radius of 600.00 feet, and whose long chord bears N 46° 51' 00" W, a distance of 287.04 feet to a point of intersection with a non-tangential line; thence N 60° 06' 28" W, a distance of 22.19; thence N 57° 55' 54" W, a distance of 61.56 feet to the beginning of a non-tangential curve; thence along the arc of said curve turning to the right through an angle of 24° 59' 47", a distance of 484.96 feet, having a radius of 1111.61 feet, and whose long chord bears N 43° 45' 45" W, a distance of 481.12 feet to a point of intersection with the Southeasterly line of

proposed Tyson Parkway; thence along said Southeasterly line the following Four (4) Courses: (1) N 60° 13' 42" E, a distance of 65.57 feet to the beginning of a curve; (2) along the arc of said curve turning to the left through an angle of 06° 25' 35", a distance of 187.70 feet, having a radius of 1673.50 feet, and whose long chord bears N 57° 00' 55" E, a distance of 187.60 feet; (3) N 53° 48' 08" E, a distance of 377.53 feet to the beginning of a curve; (4) along the arc of said curve turning to the left through an angle of 05° 54' 51", a distance of 157.87 feet, having a radius of 1529.50 feet, and whose long chord bears N 50° 50' 42" E, a distance of 157.80 feet to the White Hills Water Company Parcel; thence along the lines of said White Hills Water Company Parcel the following Two (2) courses: (1) S 89° 22' 57" E, a distance of 35.58 feet to the Southeast Corner thereof; (2) N 00° 37' 31" E, a distance of 33.94 feet to the Southeasterly line of aforesaid proposed Tyson Parkway; thence along said proposed Tyson Parkway the following Two (2) courses: (1) along the arc of a curve turning to the left through an angle of 15° 06' 41", a distance of 403.39 feet, having a radius of 1529.50 feet, and whose long chord bears N 38° 29' 25" E, a distance of 402.23 feet; (2) N 30° 56' 04" E, a distance of 241.00 feet to the point of beginning.

Contains: 3,316,762 Sw. Ft. or 76.142 Acres.

DESCRIPTION OF PROPERTY WITHIN CLASSIFICATION 1

A parcel of land situate within the Northwest Quarter (NW-1/4) of Section 21, the Southwest Quarter (SW-1/4) of Section 16, the Southeast Quarter (SE-1/4) of Section 17, the South Half (S-1/2) of Section 20, and the Northwest Quarter (NW-1/4) of Section 21, all in Township 6 South, Range 2 West, Salt Lake Base and Meridian, located in Eagle Mountain City, County of Utah, State of Utah and being described as follows:

Beginning at a point in the Section line common to Sections 16 & 21, said point being S 89°23'00" E, along said Section line, a distance of 144.74 feet, from the Section Corner common to Section 16, 17, 20, & 21, Township 6 South, Range 2 West, Salt Lake Base and Meridian; and running thence S 32° 58' 10" E, a distance of 608.21 feet to the beginning of a curve; thence along the arc of said curve, turning to the left through an angle of 86° 41' 43", a distance of 22.70 feet, having a radius of 15.00 feet, and whose long chord bears S 76° 19' 02" E, a distance of 20.59 feet to a point of intersection with a non-tangential line; thence S 29° 46' 18" E, a distance of 13.50 feet; thence S 36° 47' 49" E, a distance of 32.24 feet; thence S 29° 46' 18" E, a distance of 13.50 feet, more or less, to the Southeasterly Right-of-Way line of Tyson Parkway; thence along said Southeasterly Right-of-Way line, the following Eight (8) courses: (1) S 60° 13' 42" W, a distance of 171.09 feet to the beginning of a curve; (2) along the arc of said curve turning to the left through an angle of 30° 45' 57", a distance of 735.91 feet, having a radius of 1370.50 feet, and whose long chord bears S 44° 50' 44" W, a distance of 727.10 feet to a point of intersection with a non-tangential line; (3) S 29° 36' 59" W, a distance of 372.32 feet to the beginning of a non-tangential curve; (4) along the arc of said curve turning to the right through 70° 51' 45", a distance of 1157.63 feet; having a radius of 936.00 feet, and whose long chord bears S 64° 53' 38" W, a distance of 1085.25 feet to the beginning of a non-tangential curve; (5) along the arc of said curve turning to the left through an angle of 23° 22' 26", a distance of 448.14 feet, having a radius of 1098.50 feet, and whose long chord bears S 88° 38' 17" W, a distance of 445.03 feet; (6) S 76° 57' 04" W, a distance of 21.35 feet to the beginning of a curve; (7) along the arc of said curve turning to the left through 22° 09' 31", a distance of 646.43 feet, having a radius of 1671.50 feet, and whose long chord bears S 65° 52' 19" W, a distance of 642.41 feet to the beginning of a non-tangential curve; (8) along the arc of said curve turning to the right through an angle of 20° 37' 14", a distance of 370.15 feet, having a radius of 1028.50 feet, and whose long chord bears S 65° 06' 10" W, a distance of 368.16 feet to a point of intersection with a non-tangential line; thence N 10° 28' 44" W, a distance of 172.04 feet; thence N 09° 20' 05" W, a distance of 19.04 feet; thence N 13° 47' 39" W, a distance of 36.82 feet; thence N 12° 49' 03" W, a distance of 17.00 feet; thence N 18° 18' 48" W, a distance of 46.82 feet; thence N 20° 17' 42" W, a distance of 17.02 feet; thence N 23° 17' 02" W, a distance of 36.84 feet; thence N 28° 58' 23" W, a distance of 21.36 feet; N 26° 27' 42" W, a distance of 636.28 feet; thence N 63° 32' 18" E, a distance of 110.00 feet N 26° 27' 42" W, a distance of 167.00 feet; S 63° 32' 18" W for a distance of 110.00 feet; thence N 26° 27' 42" W, a distance of 131.60 feet; thence N 26° 48' 38" W, a distance of 22.29 feet; thence N 24° 18' 53" W, a distance of 29.82 feet; thence N 20° 51' 21" W, a distance of 32.14 feet; thence N 15° 17' 05" W, a distance of 29.82 feet; N 10° 58' 16" W, a distance of 32.15 feet; N 06° 12' 59" W, a distance of 29.82 feet; thence N 01° 09' 58" W, a distance of 33.22 feet; thence N 03° 34' 05" E, a distance of 46.85 feet; thence N 12° 00' 15" E, a distance of 60.50 feet; thence N 12° 13' 35" E, a distance of 65.81 feet; thence N 12°

13' 35" E, a distance of 65.00 feet; thence N 12° 10' 51" E, a distance of 65.00 feet; thence N 07° 18' 04" E, a distance of 73.14 feet; thence N 04° 12' 47" E, a distance of 26.03 feet; thence N 01° 36' 19" E, a distance of 46.82 feet; thence N 05° 06' 28" E, a distance of 107.18 feet; thence N 78° 08' 58" E, a distance of 100.45 feet; thence N 79° 05' 53" E, a distance of 1.87 feet; thence N 10° 32' 19" W, a distance of 110.24 feet; thence S 79° 27' 41" W, a distance of 5.53 feet, to the beginning of a non-tangential curve thence along the arc of said curve turning to the left through an angle of 03° 07' 05", a distance of 57.11 feet, having a radius of 1049.50 feet, and whose long chord bears N 14° 02' 11" W, a distance of 57.11 feet to a point of intersection with a non-tangential line; thence S 79° 27' 41" W, a distance of 109.20 feet; thence N 19° 09' 58" W, a distance of 232.28 feet; thence N 20° 45' 27" W, a distance of 14.26 feet; thence N 31° 17' 41" W, a distance of 46.82 feet; thence N 37° 42' 27" W, a distance of 11.03 feet; thence N 52° 09' 08" W, a distance of 46.82 feet; thence N 62° 14' 30" W, a distance of 13.45 feet; thence N 65° 08' 02" W, a distance of 56.82 feet; thence N 59° 50' 39" W, a distance of 15.20 feet; thence N 74° 40' 50" W, a distance of 61.45 feet to the beginning of a non-tangential curve; thence along the arc of said curve turning to the right through an angle of 30° 32' 56", a distance of 171.42 feet, having a radius of 321.50 feet, and whose long chord bears N 16° 50' 49" W, a distance of 169.39 feet to a point of intersection with a non-tangential line; thence N 83° 20' 31" E, a distance of 51.04 feet to the beginning of a curve; thence along the arc of said curve turning to the right through 22° 21' 09", a distance of 59.88 feet, having a radius of 153.50 feet, and whose long chord bears S 85° 28' 55" E, a distance of 59.51 feet to the beginning of a non-tangential curve; thence along the arc of said curve turning to the right through an angle of 47° 07' 21", a distance of 173.95, having a radius of 211.50 feet, and whose long chord bears N 21° 30' 15" E, a distance of 169.09 feet; thence N 45° 03' 56" E, a distance of 147.42 feet to the beginning of a non-tangential curve; thence along the arc of said curve turning to the left through an angle of 01° 39' 21", a distance of 12.59 feet, having a radius of 435.50 feet, and whose long chord bears S 64° 18' 22" E, a distance of 12.59 feet; thence S 65° 08' 02" E, a distance of 557.30 feet, to the beginning of a curve; thence along the arc of said curve turning to the right through an angle of 03° 47' 12", a distance of 35.00 feet, having a radius of 529.50 feet, and whose long chord bears S 63° 14' 26" E, a distance of 34.99 feet to the White Hills Water Company parcel; thence along the lines of said White Hills Water Company Parcel the following Four (4) courses: (1) S 00° 35' 13" W, a distance of 148.07 feet; (2) S 89° 30' 09" E, a distance of 200.00 feet; (3) N 00° 35' 13" E, a distance of 200.00 feet; (4) N 89° 30' 09" W, a distance of 6.48 feet; thence N 43° 18' 50" E, a distance of 3.27 feet; thence N 46° 46' 07" E, a distance of 55.65 feet to the beginning of a non-tangential curve; thence along the arc of said curve turning to the left through an angle of 11° 34' 23", a distance of 106.75 feet, having a radius of 528.50 feet, and whose long chord bears N 52° 06' 32" W, a distance of 106.57 feet to a point of intersection with a non-tangential line; thence N 34° 48' 33" E, a distance of 170.85 feet; thence N 72° 48' 53" W, a distance of 25.87 feet; thence N 08° 28' 48" E, for a distance of 133.49 feet; thence S 78° 59' 57" W, a distance of 6.39 feet; thence N 13° 16' 19" W, a distance of 55.54 feet; thence N 76° 11' 51" E, a distance of 6.31 feet to the beginning of a curve; thence along the arc of said curve turning to the right through 45° 11' 18", a distance of 543.37 feet, having a radius of 688.96 feet, and whose long chord bears S 81° 12' 57" E, a distance of 529.40 feet to the beginning of a non-tangential curve; thence along the arc of said curve turning to the left through 24° 37' 33", a distance of 157.91 having a radius of 367.41 feet, and whose long chord bears S 70° 50' 47" E, a distance of 156.70 feet to the beginning of a non-tangential curve; thence along the arc of

said curve turning to the left through $48^{\circ} 00' 20''$, a distance of 307.07 feet; having a radius of 366.50 feet, and whose long chord bears $N 73^{\circ} 01' 15'' E$, a distance of 298.17 feet to the beginning of a non-tangential curve; thence along the arc of said curve turning to the right through $22^{\circ} 22' 54''$, a distance of 103.52 feet, having a radius of 265.00 feet, and whose long chord bears $N 60^{\circ} 12' 32'' E$, a distance of 102.86 feet to the beginning of a non-tangential curve; thence along the arc of curve turning to the left through an angle of $161^{\circ} 23' 55''$, a distance of 8.45 feet, having a radius of 3.00 feet, and whose long chord bears $N 09^{\circ} 18' 01'' W$, a distance of 5.92 feet to a point of intersection with a non-tangential line; thence North, a distance of 8.00 feet; East, a distance of 138.98 feet; thence $N 00^{\circ} 00' 04'' E$, a distance of 3.39 feet to the beginning of a curve; thence along the arc of said curve turning to the left through $73^{\circ} 06' 18''$, a distance of 22.33 feet, having a radius of 17.50 feet, and whose long chord bears $N 36^{\circ} 33' 06'' W$, a distance of 20.84 feet to the beginning of a non-tangential curve; thence along the arc of said curve turning to the right through $102^{\circ} 49' 18''$, a distance of 94.22 feet, having a radius of 52.50 feet, and whose long chord bears $N 21^{\circ} 41' 35'' W$, a distance of 82.07 feet to the beginning of a non-tangential curve; thence along the arc of said curve turning to the left through $54^{\circ} 22' 32''$, a distance of 198.35 feet, having a radius of 209.00 feet, and whose long chord bears $N 02^{\circ} 31' 48'' E$, a distance of 190.99 feet to the beginning of a non-tangential curve; thence along the arc of said curve turning to the right through $21^{\circ} 04' 47''$, a distance of 36.79 feet, having a radius of 100.00 feet, and whose long chord bears $N 14^{\circ} 07' 04'' W$, a distance of 36.58 feet to the beginning of a non-tangential curve; thence along the arc of said curve turning to the left through an angle of $21^{\circ} 33' 59''$, a distance of 18.82 feet; having a radius of 50.00 feet, and whose long chord bears $N 14^{\circ} 21' 41'' W$, a distance of 18.71 feet; thence $N 25^{\circ} 08' 40'' W$, a distance of 1.85 feet to the beginning of a curve; thence along the arc of said curve turning to the left through $25^{\circ} 08' 11''$, a distance of 39.48 feet, having a radius of 90.00 feet, and whose long chord bears $N 37^{\circ} 42' 46'' W$, a distance of 39.17 feet to the beginning of a non-tangential curve; thence along the arc of said curve turning to the right through $96^{\circ} 48' 53''$, a distance of 49.00 feet, having a radius of 29.00 feet, and whose long chord bears $N 01^{\circ} 52' 25'' W$, a distance of 43.37 feet to the beginning of a non-tangential curve; thence along the arc of said curve turning to the left through an angle of $46^{\circ} 31' 58''$, a distance of 14.62 feet, having a radius of 18.00 feet, and whose long chord bears $N 23^{\circ} 16' 02'' E$, a distance of 14.22 feet to a point of intersection with a non-tangential line; thence $N 00^{\circ} 27' 07'' E$, a distance of 6.28 feet; thence $S 89^{\circ} 32' 50'' E$, a distance of 1390.34 feet to the beginning of a non-tangential curve; thence along the arc of said curve turning to the right through an angle of $18^{\circ} 18' 32''$, a distance of 295.58 feet, having a radius of 925.00 feet, and whose long chord bears $S 80^{\circ} 32' 55'' E$, a distance of 294.33 feet to a point of intersection with a non-tangential line; thence $S 15^{\circ} 41' 35'' W$, a distance of 105.35 feet to the beginning of a non-tangential curve; thence along the arc of said curve turning to the left through $01^{\circ} 28' 21''$, a distance of 20.49 feet, having a radius of 797.29 feet, and whose long chord bears $S 14^{\circ} 56' 15'' W$, a distance of 20.49 feet to the beginning of a non-tangential curve; thence along the arc of said curve turning to the right through $09^{\circ} 21' 30''$, a distance of 18.54 feet, having a radius of 113.50 feet, and whose long chord bears $S 19^{\circ} 34' 18'' W$, a distance of 18.52 feet to the beginning of a non-tangential curve; thence along the arc of said curve turning to the left through an angle of $24^{\circ} 24' 44''$, a distance of 164.68 feet, having a radius of 386.50 feet, and whose long chord bears $S 12^{\circ} 02' 41'' W$, a distance of 163.43 feet; thence $S 00^{\circ} 09' 40'' E$, a distance of 8.76 feet to the beginning of a curve; thence along the arc of said curve turning to the left through an angle of $23^{\circ} 03' 20''$, a distance

of 310.05 feet, having a radius of 770.50 feet, and whose long chord bears S 11° 41' 20" E, a distance of 307.96 feet; thence S 23° 13' 00" E, a distance of 50.66 feet to the beginning of a curve; along the arc of said curve turning to the right through an angle of 80° 35' 36", a distance of 386.12 feet, having a radius of 274.50 feet, and whose long chord bears S 17° 04' 48" W, a distance of 355.06 feet; thence S 57° 22' 35" W, a distance of 118.75 feet to the beginning of a curve; thence along the arc of said curve turning to the left through an angle of 90° 20' 46", a distance of 23.65 feet, having a radius of 15.00 feet, and whose long chord bears S 12° 12' 13" W, a distance of 21.28 feet; thence S 32° 58' 10" E, a distance of 74.53 feet to the point of beginning.

Contains: 9,284,252 Sq. Ft., or 213.137 Acres

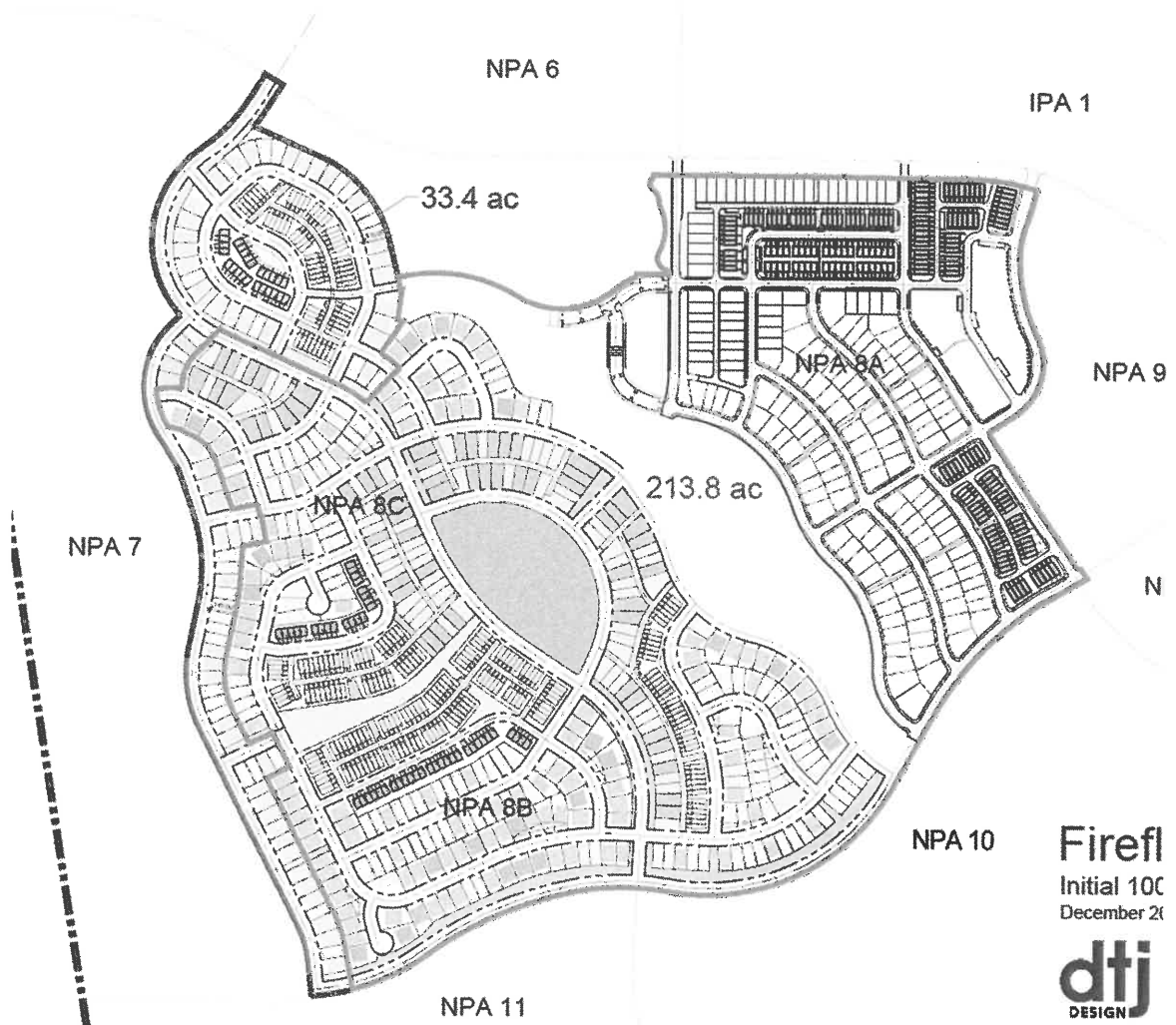

Firefl
Initial 10C
December 21
dtj
DESIGN

DESCRIPTION OF PROPERTY WITHIN CLASSIFICATION 2

NPA-5

A parcel of land situate within the North Half (N-1/2) of Section 19, Township 6 South, Range 2 West, Salt Lake Base and Meridian, located in Eagle Mountain City, County of Utah, State of Utah, being described as follows:

Beginning at a point in the Section Line common to Sections 19 & 20, said point being S 00° 30' 42" W, along the Section line, a distance of 79.55 feet from the Section Corner common to Sections 17, 18, 19, & 20, Township 6 South, Range 2 West, more or less, to the Northerly line of NPA-5; and running thence along said Northerly line the following Twenty-Four (24) courses: (1) West, a distance of 58.43 feet; (2) North, a distance of 28.50 feet; (3) West, a distance of 69.02 feet to the beginning of a curve: (4) along the arc of said curve turning to the right through an angle of 90° 00' 00", having a radius of 15.00 feet, and whose long chord bears N 45° 00' 00" W, a distance of 21.21 feet to a point of intersection with a non-tangential line: (5) West, a distance of 57.00 feet to the beginning of a non-tangential curve; (6) along the arc of said curve turning to the right through an angle of 90° 00' 00", having a radius of 15.00 feet, and whose long chord bears S 45° 00' 00" W, a distance of 21.21 feet; (7) West, a distance of 621.55 feet to the beginning of a curve; (8) along the arc of said curve turning to the right through an angle of 92° 56' 20", having a radius of 15.00 feet, and whose long chord bears N 43° 31' 50" W, a distance of 21.75 feet to a point of intersection with a non-tangential line; (9) N 87° 03' 39" W, a distance of 12.50 feet; (10) S 84° 44' 32" W, a distance of 32.34 feet; (11) N 86° 45' 40" W, a distance of 12.50 feet to the beginning of a non-tangential curve; (12) along the arc of said curve turning to the right through an angle of 86° 45' 40", having a radius of 15.00 feet, and whose long chord bears S 46° 37' 10" W, a distance of 20.61 feet; (13) West, a distance of 165.31 feet to the beginning of a curve; (14) along the arc of said curve turning to the right through an angle of 07° 47' 39", having a radius of 221.50 feet, and whose long chord bears N 86° 06' 11" W, a distance of 30.11 feet; (15) N 82° 12' 21" W, a distance of 16.02 feet to the beginning of a curve; (16) along the arc of said curve turning to the right through an angle of 90° 00' 00", having a radius of 15.00 feet, and whose long chord bears N 37° 12' 21" W, a distance of 21.21 feet to a point of intersection with a non-tangential line; (17) N 82° 12' 21" W, a distance of 57.00 feet; (18) S 07° 47' 39" W, a distance of 43.50 feet to the beginning of a curve; (19) along the arc of said curve turning to the right through 77° 03' 14", having a radius of 571.50 feet, and whose long chord bears S 46° 19' 16" W, a distance of 711.95 feet to the beginning of a non-tangential curve; (20) along the arc of said curve turning to the left through an angle of 25° 54' 02", having a radius of 980.00 feet, and whose long chord bears S 71° 53' 51" W, a distance of 439.25 feet; (21) S 58° 56' 50" W, a distance of 448.58 feet to the beginning of a curve; (22) along the arc of said curve turning to the right through an angle of 31° 03' 10", having a radius of 700.00 feet, and whose long chord bears S 74° 28' 25" W, a distance of 374.75 feet; (23) West, for a distance of 594.80 feet, to a phase line; (24) West for a distance of 531.44 feet, to the North-South 1/16th line of the Northwest Quarter of said Section 19; thence S 0°21'12" W, along said 1/16th line, a distance of 1627.04 feet, to the Quarter Corner common to Section 19, Township 6 South, Range 2 West and Section 24, Township 6 South, Range 3 West, Salt Lake Base and Meridian; thence South 89°54'04" East, along the East-West Center Quarte Line of said Section 19, a distance

of 2669.96 feet, to the North-South 1/16th line of the Northeast Quarter of said Section 19; thence N 0°22'47" E, a distance of 1334.90 feet, to the Northeast 1/16th corner; thence South 89°40'33" East, along the East-West 1/16th line, a distance of 733.66 feet, to the southerly projection of the West line of the J&J Ranch Subdivision; thence North 0°30'42" East, along the West line of said J& J Ranch Subdivision and the projection thereof, a distance of 977.96 feet, to the Northwest corner of said subdivision; thence S 89°27'13" E, along the North line of said Subdivision, a distance of 600.00 feet, to the Northeast corner of said subdivision, and the Section Line common to Sections 19 & 20; thence North 0°30'42" East, along said section line, a distance of 274.33 feet, to the point of beginning.

Contains: 5,917,975 Sq. Ft., or 135.858 Acres.

NPA-7

A parcel of land situate within the Southwest Quarter (SW-1/4) of section 17, and the Northwest Quarter (NW-1/4) of Section 20, Township 6 South, Range 2 West, Salt Lake Base and Meridian, located in Eagle Mountain City, County of Utah, State of Utah, being described as follows:

Beginning at a point in the Easterly Right-of-Way line of S.R.-73, said point being S 2°55'59" W, along the North-South Center Quarter line of said Section 20, a distance of 2499.48 feet, and N 87°04'01" W, perpendicular to said Center Quarter line, a distance of 1074.44 feet, from the Quarter Corner common to said Sections 17 & 20, Township 6 South, Range 2 West, Salt Lake Base and Meridian; and running thence N 08° 51' 32" W, a distance of 4249.61 feet, to the Southerly Right-of-Way line of Pole Canyon Boulevard, per the Tyson Subdivision; thence along said Southerly Right-of-Way line the following Three (3) courses: (1) S 89° 52' 16" E, a distance of 797.11 feet to the beginning of a curve; (2) along the arc of said curve turning to the right through an angle of 31° 37' 21", a distance of 510.52 feet, having a radius of 925.00 feet, and whose long chord bears S 74° 03' 36" E, a distance of 504.07 feet; (3) S 58° 14' 55" E, a distance of 164.94 feet; thence S 31° 45' 08" W, a distance of 44.39 feet to the beginning of a curve; thence along the arc of said curve turning to the right through 23° 26' 40", a distance of 327.35 feet, having a radius of 800.00 feet, and whose long chord bears S 43° 28' 28" W, a distance of 325.07 feet to the beginning of a non-tangential curve; thence along the arc of said curve turning to the left through an angle of 100° 07' 52", a distance of 812.64 feet, having a radius of 465.00 feet, and whose long chord bears S 05° 07' 52" W, a distance of 713.11 feet to a point of intersection with a non-tangential line; thence S 45° 03' 56" W, a distance of 95.31 feet to the beginning of a curve; thence along the arc of said curve turning to the left through an angle of 76° 15' 43", 465.86 feet, having a radius of 350.00 feet, and whose long chord bears S 06° 56' 04" W, a distance of 432.22 feet; thence S 31° 11' 47" E, a distance of 53.06 feet; thence S 31° 11' 47" E, a distance of 114.55 feet to the beginning of a curve; thence along the arc of said curve turning to the right through an angle of 12° 01' 49", a distance of 41.99 feet, having a radius of 200.00 feet, and whose long chord bears S 25° 10' 53" E, a distance of 41.9165 feet; S 19° 09' 58" E, a distance of 182.21 feet to the beginning of a curve; thence along the arc of said curve turning to the right through 24° 16' 10", a distance of 338.86 feet, having a radius of 800.00 feet, and whose long chord bears S 07° 01' 53" E, a distance of 336.34 feet to the beginning of a non-tangential curve; thence along the arc of said

curve turning to the right through an angle of $07^{\circ} 04' 25''$, a distance of 98.77 feet, having a radius of 800.00 feet, and whose long chord bears $S 08^{\circ} 38' 24'' W$, a distance of 98.70 feet; thence $S 12^{\circ} 10' 37'' W$, a distance of 188.93 feet to the beginning of a curve; thence along the arc of said curve turning to the left through an angle of $38^{\circ} 38' 19''$, a distance of 337.19 feet, having a radius of 500.00 feet, and whose long chord bears $S 07^{\circ} 08' 33'' E$ for a distance of 330.83 feet; thence $S 26^{\circ} 27' 42'' E$, a distance of 972.55 feet to the beginning of a curve; thence along the arc of said curve turning to the right through an angle of $20^{\circ} 22' 43''$, a distance of 177.84 feet, having a radius of 500.00 feet, and whose long chord bears $S 16^{\circ} 16' 21'' E$, a distance of 176.90 feet; thence $S 06^{\circ} 05' 00'' E$, a distance of 148.44 feet to the Southerly Right-of-Way line of proposed Tyson Parkway and the beginning of a non-tangential curve; thence along said proposed Southerly Right-of-Way line the following Two (2) Courses: (1) along the arc of said curve turning to the right through an angle of $06^{\circ} 05' 00''$, a distance of 109.30 feet, having a radius of 1029.50 feet, and whose long chord bears $S 86^{\circ} 57' 30'' W$, a distance of 109.25 feet; (2) West, a distance of 918.84 feet to the point of beginning.

Contains: 3,719,247 Sq. Ft., or 85.382 Acres

NPA-8

A parcel of land situate within the South Half (S-1/2) of Section 17, the Southwest Quarter (SW-1/4) of Section 16, the Northwest Quarter (NW-1/4) of Section 21, and the North Half (N1/2) of Section 20, all in Township 6 South, Range 2 West, Salt Lake Base and Meridian, located in Eagle Mountain City, County of Utah, State of Utah, being described as follows:

Beginning at a point in the Southerly Right-of-Way line of Pole Canyon Boulevard, per the Tyson Subdivision, said point being $S 89^{\circ} 29' 39'' E$, along the Section line common to said Sections 17 & 20, a distance of 415.11 feet and $N 0^{\circ} 30' 21'' E$, perpendicular to said section line, a distance of 1186.84 feet, from the Quarter Corner common to said Sections 17 & 20, Township 6 South, Range 2 West, Salt Lake Base and Meridian; and running thence along said Southerly Right-of-Way line the following Three (3) courses: (1) $S 89^{\circ} 32' 56'' E$, a distance of 2253.72 feet to the beginning of a curve; (2) along the arc of said curve turning to the right through an angle of $30^{\circ} 28' 59''$, a distance of 492.13 feet, having a radius of 925.00 feet, and whose long chord bears $S 74^{\circ} 18' 27'' E$, a distance of 486.35 feet; (3) $S 59^{\circ} 03' 57'' E$, a distance of 1231.40 feet, to the Southerly Right-of-Way line of proposed Tyson Parkway; thence along said Southerly line the following Two (2) courses: (1) $S 30^{\circ} 56' 04'' W$, a distance of 241.00 feet to the beginning of a curve; (2) along the arc of said curve turning to the right through an angle of $15^{\circ} 06' 41''$, a distance of 403.49 feet, having a radius of 1529.50 feet, and whose long chord bears $S 38^{\circ} 29' 25'' W$, a distance of 402.23 feet to a point of intersection with the White Hills Water Company Parcel; thence along the lines of said White Hills Water Company Parcel the following Four (4) courses: (1) $N 00^{\circ} 37' 31'' E$, a distance of 166.06 feet; (2) $N 89^{\circ} 22' 57'' W$, a distance of 200.00 feet; (3) $S 00^{\circ} 37' 31'' W$, a distance of 200.00 feet; (4) $S 89^{\circ} 22' 57'' E$, a distance of 164.42 feet to aforesaid Southerly line of proposed Tyson Parkway and the beginning of a non-tangential curve; thence along said Southerly line of proposed Tyson Parkway the following along Eleven (11) courses: (1) along the arc of said curve turning to the right through an angle of $05^{\circ} 54' 51''$, a distance of 157.87 feet, having a

radius of 1529.50 feet, and whose long chord bears S 50° 50' 42" W, a distance of 157.80 feet; (2) S 53° 48' 08" W, a distance of 377.53 feet to the beginning of a curve; (3) along the arc of said curve turning to the right through an angle of 06° 25' 35", a distance of 187.70 feet, having a radius of 1673.50 feet, and whose long chord bears S 57° 00' 55" W, a distance of 187.60 feet; (4) S 60° 13' 42" W, a distance of 192.16 feet to the beginning of a curve; (5) along the arc of said curve turning to the left through an angle of 30° 45' 57", a distance of 735.91 feet, having a radius of 1370.50 feet, and whose long chord bears S 44° 50' 44" W, a distance of 727.10 feet; (6) S 29° 27' 45" W, a distance of 372.32 feet to the beginning of a curve; (7) thence along the arc of said curve turning to the right through 70° 51' 45", a distance of 1158.87 feet, having a radius of 937.00 feet, and whose long chord bears S 64° 53' 38" W, a distance of 1086.41 feet to the beginning of a reverse curve; (8) along the arc of said curve turning to the left through 23° 22' 27", a distance of 447.73 feet, having a radius of 1097.50 feet, and whose long chord bears S 88° 38' 17" W, a distance of 444.63 feet; (9) S 76° 57' 04" W, a distance of 21.35 feet to the beginning of a curve; (10) along the arc of said curve turning to the left through 22° 09' 31", a distance of 646.05 feet, having a radius of 1670.50 feet, and whose long chord bears S 65° 52' 19" W, a distance of 642.03 feet to a point of a reverse curve; (11) thence along the arc of curve turning to the right through an angle of 29° 07' 27", a distance of 523.31 feet, having a radius of 1029.50 feet, and whose long chord bears S 69° 21' 17" W, a distance of 517.6915 feet to a point of intersection with the centerline of proposed Wildwood Drive and the aforesaid Southerly line of Tyson parkway; thence along said centerline the following Fourteen (14) courses: (1) N 06° 05' 00" W for a distance of 148.44 feet to the beginning of a curve; (2) along the arc of said curve turning to the left through an angle of 20° 22' 43", a distance of 177.74 having a radius of 500.00 feet, and whose long chord bears N 16° 16' 21.0" W for a distance of 176.90 feet; (3) N 26° 27' 42" W, a distance of 972.55 feet to the beginning of a curve; (4) along the arc of said curve turning to the right through an angle of 38° 38' 19", a distance of 337.19 feet, having a radius of 500.00 feet, and whose long chord bears N 07° 08' 33" W, a distance of 330.83 feet; (5) N 12° 10' 37" E, a distance of 188.93 feet to the beginning of a curve; (6) along the arc of said curve turning to the left through 31° 20' 36", a distance of 437.63 feet, having a radius of 800.00 feet, and whose long chord bears N 03° 29' 41" W, a distance of 432.19 feet; (7) N 19° 09' 58" W, a distance of 182.21 feet to the beginning of a curve; (8) along the arc of said curve turning to the left through an angle of 12° 01' 49", a distance of 41.99 feet, having a radius of 200.00 feet, and whose long chord bears N 25° 10' 53" W, a distance of 41.92 feet; (9) N 31° 11' 47" W, a distance of 167.61 feet to the beginning of a curve; (10) along the arc of said curve turning to the right through an angle of 76° 15' 43", a distance of 465.86 feet, having a radius of 350.00 feet, and whose long chord bears N 06° 56' 04" E, a distance of 432.22 feet; (11) N 45° 03' 56" E, a distance of 95.31 feet to the beginning of a non-tangential curve; (12) along the arc of said curve turning to the right through 100° 07' 52", a distance of 812.64 feet, having a radius of 465.00 feet, and whose long chord bears N 05° 07' 52" E, a distance of 713.11 feet to the beginning of a reverse curve; (13) along the arc of aid curve turning to the left through an angle of 23° 26' 40", a distance of 327.35 feet, having a radius of 800.00 feet, and whose long chord bears N 43° 28' 28" E, a distance of 325.07 feet.; (14) N 31° 45' 08" E, a distance of 44.39 feet to the aforesaid Southerly Right-of-Way Line of Pole Canyon Boulevard, per the Tyson Subdivision; thence along said Southerly Right-of-Way Line the following two (2) courses: (1) S 58° 14' 55" E, a distance of 354.75 feet to the beginning of a curve; (2) along the arc of said curve turning to the left through 31° 18' 01", a distance of 587.27 feet, having

a radius of 1075.00 feet, and whose long chord bears S 73° 53' 56" E, a distance of 579.99 feet to the point of beginning.

Contains: 12,521,219 Sq. Ft., or 287.448 Acres

NPA-9

A parcel of land situate within the Southwest Quarter (SW-1/4) of Section 16, and the North half (N-1/2) of Section 21, Township 6 South, Range 2 West, Salt Lake Base and Meridian, located in Eagle Mountain City, County of Utah, State of Utah, being described as follows:

Beginning at a point the Southwesterly line Right-of-Way line of Pole Canyon Boulevard, per Tyson Subdivision, said point being N 89° 23' 00" W, along the Section Line common to said Sections 16 & 21, a distance of 1032.29 feet, and N 0° 37' 00" E, perpendicular to said Sections Line, a distance of 440.91 feet, from the Quarter Corner common to said Sections 16 & 21, Township 6 South, Range 2 West, Salt Lake Base and Meridian; and running thence said Right-of-Way line the following Three (3) Courses: (1) S 59° 03' 57" E, a distance of 731.32 feet the beginning of a curve; (2) along the arc of said curve turning to the left through an angle of 30° 36' 36", a distance of 574.31 feet, having a radius of 1075.00 feet, and whose long chord bears S 74° 22' 15" E, a distance of 567.51 feet; (3) S 89° 40' 33" E, a distance of 432.25 feet; thence S 00° 19' 30" W, a distance of 409.12 feet to the beginning of a curve; thence along the arc of said curve turning to the right through an angle of 74° 29' 58", a distance of 1170.23 feet, having a radius of 900.00 feet, and whose long chord bears S 37° 34' 30" W, a distance of 1089.52 feet; thence S 74° 49' 29" W, a distance of 185.03 feet to the beginning of a curve; thence along the arc of said curve turning to the left through an angle of 54° 56' 14", a distance of 383.53 feet, having a radius of 400.00 feet, and whose long chord bears S 47° 21' 22" W, a distance of 369.01 feet; thence S 19° 53' 15" W, a distance of 98.94 feet; thence N 70° 06' 45" W, a distance of 501.92 feet to the beginning of a curve; thence along the arc of said curve turning to the right through an angle of 31° 41' 38", a distance of 331.90 feet, having a radius of 600.00 feet, and whose long chord bears N 54° 15' 55" W, a distance of 327.68 feet to a point of intersection with a non-tangential line; thence N 33° 33' 29" W, a distance of 111.09 feet, to the White Hills Water parcel; thence along the lines of said White Hills Water Parcel the following Two (2) courses: (1) N 00° 37' 31" E, a distance of 113.46 feet; (2) N 89° 22' 57" W, a distance of 77.05 feet; thence N 33° 33' 29" W, a distance of 31.26 feet to the beginning of a non-tangential curve; thence along the arc of said curve turning to the left through an angle of 27° 40' 44", a distance of 289.85 feet, having a radius of 600.00 feet, and whose long chord bears N 46° 51' 00" W, a distance of 287.04 feet to a point of intersection with a non-tangential line; thence N 60° 06' 28" W, a distance of 22.19; thence N 57° 55' 54" W, a distance of 61.56 feet to the beginning of a non-tangential curve; thence along the arc of said curve turning to the right through an angle of 24° 59' 47", a distance of 484.96 feet, having a radius of 1111.61 feet, and whose long chord bears N 43° 45' 45" W, a distance of 481.12 feet to a point of intersection with the Southeasterly line of proposed Tyson Parkway; thence along said Southeasterly line the following Four (4) Courses: (1) N 60° 13' 42" E, a distance of 65.57 feet to the beginning of a curve; (2) along the arc of said curve turning to the left through an angle of 06° 25' 35", a distance of 187.70

feet, having a radius of 1673.50 feet, and whose long chord bears N 57° 00' 55" E, a distance of 187.60 feet; (3) N 53° 48' 08" E, a distance of 377.53 feet to the beginning of a curve; (4) along the arc of said curve turning to the left through an angle of 05° 54' 51", a distance of 157.87 feet, having a radius of 1529.50 feet, and whose long chord bears N 50° 50' 42" E, a distance of 157.80 feet to the White Hills Water Company Parcel; thence along the lines of said White Hills Water Company Parcel the following Two (2) courses: (1) S 89° 22' 57" E, a distance of 35.58 feet to the Southeast Corner thereof; (2) N 00° 37' 31" E, a distance of 33.94 feet to the Southeasterly line of aforesaid proposed Tyson Parkway; thence along said proposed Tyson Parkway the following Two (2) courses: (1) along the arc of a curve turning to the left through an angle of 15° 06' 41", a distance of 403.39 feet, having a radius of 1529.50 feet, and whose long chord bears N 38° 29' 25" E, a distance of 402.23 feet; (2) N 30° 56' 04" E, a distance of 241.00 feet to the point of beginning.

Contains: 3,316,762 Sw. Ft. or 76.142 Acres.

LESS AND EXCEPTING:

A parcel of land situate within the Northwest Quarter (NW-1/4) of Section 21, the Southwest Quarter (SW-1/4) of Section 16, the Southeast Quarter (SE-1/4) of Section 17, the South Half (S-1/2) of Section 20, and the Northwest Quarter (NW-1/4) of Section 21, all in Township 6 South, Range 2 West, Salt Lake Base and Meridian, located in Eagle Mountain City, County of Utah, State of Utah and being described as follows:

Beginning at a point in the Section line common to Sections 16 & 21, said point being S 89°23'00" E, along said Section line, a distance of 144.74 feet, from the Section Corner common to Section 16, 17, 20, & 21, Township 6 South, Range 2 West, Salt Lake Base and Meridian; and running thence S 32° 58' 10" E, a distance of 608.21 feet to the beginning of a curve; thence along the arc of said curve, turning to the left through an angle of 86° 41' 43", a distance of 22.70 feet, having a radius of 15.00 feet, and whose long chord bears S 76° 19' 02" E, a distance of 20.59 feet to a point of intersection with a non-tangential line; thence S 29° 46' 18" E, a distance of 13.50 feet; thence S 36° 47' 49" E, a distance of 32.24 feet; thence S 29° 46' 18" E, a distance of 13.50 feet, more or less, to the Southeasterly Right-of-Way line of Tyson Parkway; thence along said Southeasterly Right-of-Way line, the following Eight (8) courses: (1) S 60° 13' 42" W, a distance of 171.09 feet to the beginning of a curve; (2) along the arc of said curve turning to the left through an angle of 30° 45' 57", a distance of 735.91 feet, having a radius of 1370.50 feet, and whose long chord bears S 44° 50' 44" W, a distance of 727.10 feet to a point of intersection with a non-tangential line; (3) S 29° 36' 59" W, a distance of 372.32 feet to the beginning of a non-tangential curve; (4) along the arc of said curve turning to the right through 70° 51' 45", a distance of 1157.63 feet; having a radius of 936.00 feet, and whose long chord bears S 64° 53' 38" W, a distance of 1085.25 feet to the beginning of a non-tangential curve; (5) along the arc of said curve turning to the left through an angle of 23° 22' 26", a distance of 448.14 feet, having a radius of 1098.50 feet, and whose long chord bears S 88° 38' 17" W, a distance of 445.03 feet; (6) S 76° 57' 04" W, a distance of 21.35 feet to the beginning of a curve; (7) along the arc of said curve turning to the left through 22° 09' 31", a distance of 646.43 feet, having a radius of 1671.50 feet, and whose long chord bears S 65° 52' 19" W, a distance of 642.41 feet to the beginning of a non-tangential

curve; (8) along the arc of said curve turning to the right through an angle of $20^{\circ} 37' 14''$, a distance of 370.15 feet, having a radius of 1028.50 feet, and whose long chord bears $S 65^{\circ} 06' 10'' W$, a distance of 368.16 feet to a point of intersection with a non-tangential line; thence $N 10^{\circ} 28' 44'' W$, a distance of 172.04 feet; thence $N 09^{\circ} 20' 05'' W$, a distance of 19.04 feet; thence $N 13^{\circ} 47' 39'' W$, a distance of 36.82 feet; thence $N 12^{\circ} 49' 03'' W$, a distance of 17.00 feet; thence $N 18^{\circ} 18' 48'' W$, a distance of 46.82 feet; thence $N 20^{\circ} 17' 42'' W$, a distance of 17.02 feet; thence $N 23^{\circ} 17' 02'' W$, a distance of 36.84 feet; thence $N 28^{\circ} 58' 23'' W$, a distance of 21.36 feet; $N 26^{\circ} 27' 42'' W$, a distance of 636.28 feet; thence $N 63^{\circ} 32' 18'' E$, a distance of 110.00 feet $N 26^{\circ} 27' 42'' W$, a distance of 167.00 feet; $S 63^{\circ} 32' 18'' W$ for a distance of 110.00 feet; thence $N 26^{\circ} 27' 42'' W$, a distance of 131.60 feet; thence $N 26^{\circ} 48' 38'' W$, a distance of 22.29 feet; thence $N 24^{\circ} 18' 53'' W$, a distance of 29.82 feet; thence $N 20^{\circ} 51' 21'' W$, a distance of 32.14 feet; thence $N 15^{\circ} 17' 05'' W$, a distance of 29.82 feet; $N 10^{\circ} 58' 16'' W$, a distance of 32.15 feet; $N 06^{\circ} 12' 59'' W$, a distance of 29.82 feet; thence $N 01^{\circ} 09' 58'' W$, a distance of 33.22 feet; thence $N 03^{\circ} 34' 05'' E$, a distance of 46.85 feet; thence $N 12^{\circ} 00' 15'' E$, a distance of 60.50 feet; thence $N 12^{\circ} 13' 35'' E$, a distance of 65.81 feet; thence $N 12^{\circ} 13' 35'' E$, a distance of 65.00 feet; thence $N 12^{\circ} 10' 51'' E$, a distance of 65.00 feet; thence $N 07^{\circ} 18' 04'' E$, a distance of 73.14 feet; thence $N 04^{\circ} 12' 47'' E$, a distance of 26.03 feet; thence $N 01^{\circ} 36' 19'' E$, a distance of 46.82 feet; thence $N 05^{\circ} 06' 28'' E$, a distance of 107.18 feet; thence $N 78^{\circ} 08' 58'' E$, a distance of 100.45 feet; thence $N 79^{\circ} 05' 53'' E$, a distance of 1.87 feet; thence $N 10^{\circ} 32' 19'' W$, a distance of 110.24 feet; thence $S 79^{\circ} 27' 41'' W$, a distance of 5.53 feet, to the beginning of a non-tangential curve thence along the arc of said curve turning to the left through an angle of $03^{\circ} 07' 05''$, a distance of 57.11 feet, having a radius of 1049.50 feet, and whose long chord bears $N 14^{\circ} 02' 11'' W$, a distance of 57.11 feet to a point of intersection with a non-tangential line; thence $S 79^{\circ} 27' 41'' W$, a distance of 109.20 feet; thence $N 19^{\circ} 09' 58'' W$, a distance of 232.28 feet; thence $N 20^{\circ} 45' 27'' W$, a distance of 14.26 feet; thence $N 31^{\circ} 17' 41'' W$, a distance of 46.82 feet; thence $N 37^{\circ} 42' 27'' W$, a distance of 11.03 feet; thence $N 52^{\circ} 09' 08'' W$, a distance of 46.82 feet; thence $N 62^{\circ} 14' 30'' W$, a distance of 13.45 feet; thence $N 65^{\circ} 08' 02'' W$, a distance of 56.82 feet; thence $N 59^{\circ} 50' 39'' W$, a distance of 15.20 feet; thence $N 74^{\circ} 40' 50'' W$, a distance of 61.45 feet to the beginning of a non-tangential curve; thence along the arc of said curve turning to the right through an angle of $30^{\circ} 32' 56''$, a distance of 171.42 feet, having a radius of 321.50 feet, and whose long chord bears $N 16^{\circ} 50' 49'' W$, a distance of 169.39 feet to a point of intersection with a non-tangential line; thence $N 83^{\circ} 20' 31'' E$, a distance of 51.04 feet to the beginning of a curve; thence along the arc of said curve turning to the right through $22^{\circ} 21' 09''$, a distance of 59.88 feet, having a radius of 153.50 feet, and whose long chord bears $S 85^{\circ} 28' 55'' E$, a distance of 59.51 feet to the beginning of a non-tangential curve; thence along the arc of said curve turning to the right through an angle of $47^{\circ} 07' 21''$, a distance of 173.95, having a radius of 211.50 feet, and whose long chord bears $N 21^{\circ} 30' 15'' E$, a distance of 169.09 feet; thence $N 45^{\circ} 03' 56'' E$, a distance of 147.42 feet to the beginning of a non-tangential curve; thence along the arc of said curve turning to the left through an angle of $01^{\circ} 39' 21''$, a distance of 12.59 feet, having a radius of 435.50 feet, and whose long chord bears $S 64^{\circ} 18' 22'' E$, a distance of 12.59 feet; thence $S 65^{\circ} 08' 02'' E$ a distance of 557.30 feet, to the beginning of a curve; thence along the arc of said curve turning to the right through an angle of $03^{\circ} 47' 12''$, a distance of 35.00 feet, having a radius of 529.50 feet, and whose long chord bears $S 63^{\circ} 14' 26'' E$ a distance of 34.99 feet to the White Hills Water Company parcel; thence along the lines of said White Hills Water Company Parcel the following Four (4) courses: (1) $S 00^{\circ} 35' 13'' W$, a distance

of 148.07 feet; (2) S 89° 30' 09" E, a distance of 200.00 feet; (3) N 00° 35' 13" E, a distance of 200.00 feet; (4) N 89° 30' 09" W, a distance of 6.48 feet; thence N 43° 18' 50" E, a distance of 3.27 feet; thence N 46° 46' 07" E, a distance of 55.65 feet to the beginning of a non-tangential curve; thence along the arc of said curve turning to the left through an angle of 11° 34' 23", a distance of 106.75 feet, having a radius of 528.50 feet, and whose long chord bears N 52° 06' 32" W, a distance of 106.57 feet to a point of intersection with a non-tangential line; thence N 34° 48' 33" E, a distance of 170.85 feet; thence N 72° 48' 53" W, a distance of 25.87 feet; thence N 08° 28' 48" E, for a distance of 133.49 feet; thence S 78° 59' 57" W, a distance of 6.39 feet; thence N 13° 16' 19" W, a distance of 55.54 feet; thence N 76° 11' 51" E, a distance of 6.31 feet to the beginning of a curve; thence along the arc of said curve turning to the right through 45° 11' 18", a distance of 543.37 feet, having a radius of 688.96 feet, and whose long chord bears S 81° 12' 57" E, a distance of 529.40 feet to the beginning of a non-tangential curve; thence along the arc of said curve turning to the left through 24° 37' 33", a distance of 157.91 having a radius of 367.41 feet, and whose long chord bears S 70° 50' 47" E, a distance of 156.70 feet to the beginning of a non-tangential curve; thence along the arc of said curve turning to the left through 48° 00' 20", a distance of 307.07 feet; having a radius of 366.50 feet, and whose long chord bears N 73° 01' 15" E, a distance of 298.17 feet to the beginning of a non-tangential curve; thence along the arc of said curve turning to the right through 22° 22' 54", a distance of 103.52 feet, having a radius of 265.00 feet, and whose long chord bears N 60° 12' 32" E, a distance of 102.86 feet to the beginning of a non-tangential curve; thence along the arc of curve turning to the left through an angle of 161° 23' 55", a distance of 8.45 feet, having a radius of 3.00 feet, and whose long chord bears N 09° 18' 01" W, a distance of 5.92 feet to a point of intersection with a non-tangential line; thence North, a distance of 8.00 feet; East, a distance of 138.98 feet; thence N 00° 00' 04" E, a distance of 3.39 feet to the beginning of a curve; thence along the arc of said curve turning to the left through 73° 06' 18", a distance of 22.33 feet, having a radius of 17.50 feet, and whose long chord bears N 36° 33' 06" W, a distance of 20.84 feet to the beginning of a non-tangential curve; thence along the arc of said curve turning to the right through 102° 49' 18", a distance of 94.22 feet, having a radius of 52.50 feet, and whose long chord bears N 21° 41' 35" W, a distance of 82.07 feet to the beginning of a non-tangential curve; thence along the arc of said curve turning to the left through 54° 22' 32", a distance of 198.35 feet, having a radius of 209.00 feet, and whose long chord bears N 02° 31' 48" E, a distance of 190.99 feet to the beginning of a non-tangential curve; thence along the arc of said curve turning to the right through 21° 04' 47", a distance of 36.79 feet, having a radius of 100.00 feet, and whose long chord bears N 14° 07' 04" W, a distance of 36.58 feet to the beginning of a non-tangential curve; thence along the arc of said curve turning to the left through an angle of 21° 33' 59", a distance of 18.82 feet; having a radius of 50.00 feet, and whose long chord bears N 14° 21' 41" W, a distance of 18.71 feet; thence N 25° 08' 40" W, a distance of 1.85 feet to the beginning of a curve; thence along the arc of said curve turning to the left through 25° 08' 11", a distance of 39.48 feet, having a radius of 90.00 feet, and whose long chord bears N 37° 42' 46" W, a distance of 39.17 feet to the beginning of a non-tangential curve; thence along the arc of said curve turning to the right through 96° 48' 53", a distance of 49.00 feet, having a radius of 29.00 feet, and whose long chord bears N 01° 52' 25" W, a distance of 43.37 feet to the beginning of a non-tangential curve; thence along the arc of said curve turning to the left through an angle of 46° 31' 58", a distance of 14.62 feet, having a radius of 18.00 feet, and whose long chord bears N 23° 16' 02" E, a distance of 14.22 feet to a point of intersection with

a non-tangential line; thence N 00° 27' 07" E, a distance of 6.28 feet; thence S 89° 32' 50" E, a distance of 1390.34 feet to the beginning of a non-tangential curve; thence along the arc of said curve turning to the right through an angle of 18° 18' 32", a distance of 295.58 feet, having a radius of 925.00 feet, and whose long chord bears S 80° 32' 55" E, a distance of 294.33 feet to a point of intersection with a non-tangential line; thence S 15° 41' 35" W, a distance of 105.35 feet to the beginning of a non-tangential curve; thence along the arc of said curve turning to the left through 01° 28' 21", a distance of 20.49 feet, having a radius of 797.29 feet, and whose long chord bears S 14° 56' 15" W, a distance of 20.49 feet to the beginning of a non-tangential curve; thence along the arc of said curve turning to the right through 09° 21' 30", a distance of 18.54 feet, having a radius of 113.50 feet, and whose long chord bears S 19° 34' 18" W, a distance of 18.52 feet to the beginning of a non-tangential curve; thence along the arc of said curve turning to the left through an angle of 24° 24' 44", a distance of 164.68 feet, having a radius of 386.50 feet, and whose long chord bears S 12° 02' 41" W, a distance of 163.43 feet; thence S 00° 09' 40" E, a distance of 8.76 feet to the beginning of a curve; thence along the arc of said curve turning to the left through an angle of 23° 03' 20", a distance of 310.05 feet, having a radius of 770.50 feet, and whose long chord bears S 11° 41' 20" E, a distance of 307.96 feet; thence S 23° 13' 00" E, a distance of 50.66 feet to the beginning of a curve; along the arc of said curve turning to the right through an angle of 80° 35' 36", a distance of 386.12 feet, having a radius of 274.50 feet, and whose long chord bears S 17° 04' 48" W, a distance of 355.06 feet; thence S 57° 22' 35" W, a distance of 118.75 feet to the beginning of a curve; thence along the arc of said curve turning to the left through an angle of 90° 20' 46", a distance of 23.65 feet, having a radius of 15.00 feet, and whose long chord bears S 12° 12' 13" W, a distance of 21.28 feet; thence S 32° 58' 10" E, a distance of 74.53 feet to the point of beginning.

Contains: 9,284,252 Sq. Ft., or 213.137 Acres