

**PROPOSED ADDITION OF SPECIFIC DEVELOPMENT DESIGNATIONS  
STIPULATING SETBACKS AND ARCHITECTURAL REQUIREMENTS FOR  
AGRICULTURAL BUILDINGS ON PROPERTY LOCATED AT 2673 WEST 11800  
SOUTH, REZONING THE PROPERTY FROM RR-22 TO RR-22/SD  
APPLICANT – BENJAMIN AND SARAH MILAR.**

## Jamie Larsen, Recorder

## Exhibit A

Amend the Riverton City Zoning Map from RR-22 to RR-22/SD for the property located at 2673 W 11800 S bearing Parcel ID#27-28-201-027, with the following SD Designations:

1. Animal shelters may be built with wood siding and metal roofs, as described and as shown in the attached exhibits.
2. Chicken coops may be built from natural wood siding and chicken wire enclosure for a chicken run, as described and as shown in the attached exhibits.
3. A greenhouse may be built with aluminum and glass/polycarbonate clear panels.
4. A greenhouse may be built with a 10 ft setback from property line adjacent to 2700 West.





1.28 Acres - 55,756.80  
 20% = 11,151.36  
 13,829 sf Grass  
 11,000 sf Bark  
 480 sq ft Greenhouse

- 1 - 52" tall fence with metal paneling
- 2 - 10'x48' greenhouse
- 3 - 8'x8' small animal enclosure
- 4 - 8'x12' animal enclosure
- 5 - 4'x8' small animal enclosure

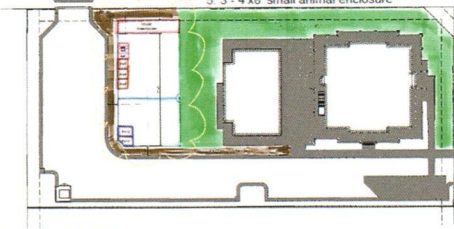

Greenhouse 2 - 10x24 Units  
 Greenhouse Sq Ft Total: 480  
 Greenhouse Occupancy: 10

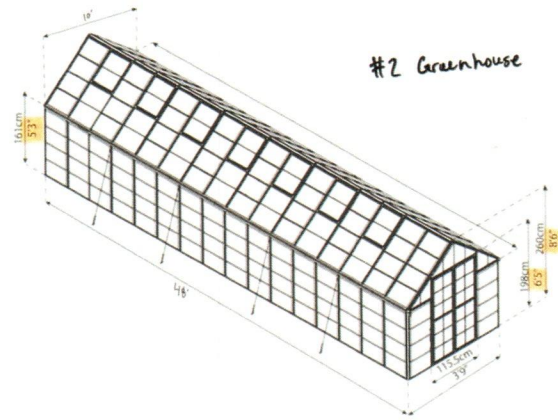

## CERTIFICATE OF POSTING

I, Jamie Larsen, the duly appointed and acting Recorder for Riverton City hereby  
Certify that the foregoing Ordinance No. 26-01 was adopted by the Riverton City Council on the  
20<sup>th</sup> day of January 2026 and that after its passage copies were posted at the following locations:

1. City Hall
2. Public Notice Website

Dated 20<sup>th</sup> day of January 2026.



\_\_\_\_\_  
Jamie Larsen, Recorder