



## NOTICE OF PASSAGE

### ORDINANCE 2025-02

AN ORDINANCE OF THE CITY COUNCIL OF OAKLEY ANNEXING CERTAIN  
UNINCORPORATED PROPERTY IN SUMMIT COUNTY IDENTIFIED AS COUNTY  
PARCEL CD-258 KNOWN AS THE "DEER MEADOWS RANCH"

### SUMMARY OF OAKLEY CITY ORDINANCE 2025-02

On October 22, 2025, the Oakley City Council enacted Ordinance No. 2025-02, annexing a portion of the Deer Meadows Ranch property at approximately 950 East Weber Canyon Road to the City of Oakley assigning the zone of AR-40 Agricultural Residential to the parcel.

A complete copy of Ordinance No. 2025-02 is available in the Oakley City offices located at 960 West Center Street, Oakley, UT 84055

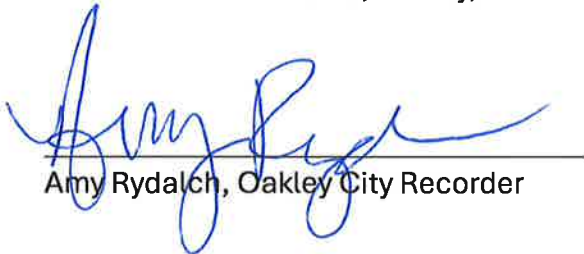
  
Amy Rydalch, Oakley City Recorder

### Voting:

	Aye	Nay
Councilmember J. Frazier	<input checked="" type="checkbox"/>	<input type="checkbox"/>
Councilmember K. Kimber	<input checked="" type="checkbox"/>	<input type="checkbox"/>
Councilmember D. Neff	<input checked="" type="checkbox"/>	<input type="checkbox"/>
Councilmember T. Smart	<input checked="" type="checkbox"/>	<input type="checkbox"/>
Councilmember S. Wilmoth	<input checked="" type="checkbox"/>	<input type="checkbox"/>



This notice was posted on the Utah Public Notice Website, [oakleyut.gov](http://oakleyut.gov), at the Oakley United States Post Office, and at the Oakley City Hall on October 23, 2025

## EXHIBIT A

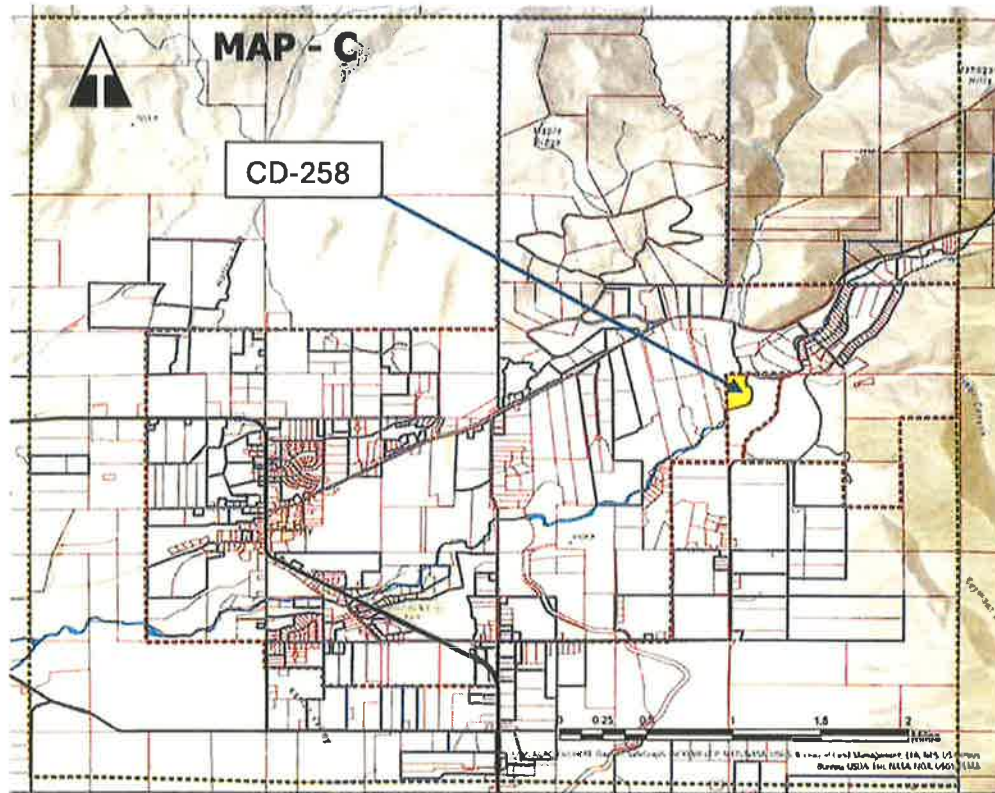

### The General Plan Maps of **Oakley City** Lots & Subdivisions

The Maps Which Define  
Oakley's Geography and  
Guide Future Planning

- Roads**
- Private
  - A
  - B
  - C
- Municipal Boundaries**
- Annexation Declaration**
- Weber River**
- Subdivisions**
- Parcels**

**NOTE:** All information and data on this map is for planning purposes and may be subject to field or source verification by Oakley City in actual project reviews.

Cartography by D. W. Evans 2021