



NOTICE OF REGULAR MEETING AND AGENDA

<u>Board of Directors:</u>	<u>Office:</u>	<u>Term Expires:</u>
Maria Mitchell	President	5/2027
Brian Cook	Secretary	5/2027
Peter Lubin	Treasurer/ Asst. Secretary	5/2029
Mary Ann J. Hartt	Director	5/2027
Mark Lamb	Director	5/2029

DATE: September 16, 2025 (Tuesday)

TIME: 6:00 P.M.

PLACE: District Headquarters, 911 Castello Ave, Fairplay; and Via Zoom

Click below to join meeting

<https://us02web.zoom.us/j/83726364581?pwd=EDzAXHkuMSqeDGfCzs3MYZHvYvx9wm.1>

Meeting ID: 837 2636 4581; Passcode: 132185

Telephone: 1 719 359 4580; OR 1 253 205 0468

I. ADMINISTRATIVE MATTERS/MANAGER'S ITEMS

- A. Call to Order/ Roll Call/ Declaration of Quorum/ Confirm Location and Notice of Meeting.
- B. Approve Agenda.
- C. Present disclosures of potential conflicts of interest.
- D. Review and consider approval of minutes of August 19, 2025, Regular Meeting. **(Enclosure)**
- E. Public Comment. Comments are limited to three (3) minutes per speaker.

II. DEPARTMENT/PERSONNEL MATTERS

- A. Report of the Chief. **(Enclosure)**
- B. Discussion and Approval of Purchase Ambulance in 2027. **(Enclosure)**
- C. Discussion and Approval of Purchase of Hamilton Ventilator. **(Enclosure)**

III. FINANCIAL MATTERS

- A. Ratify approval of claims for the period through August 31, 2025. **(Enclosure)**
- B. Review and accept Budget Vs. Actual for the period ending July 31, 2025. **(Enclosure)**

V. LEGAL MATTERS

VI. OTHER BUSINESS

A. Director Items.

VII. ADJOURNMENT –

The next regular meeting is scheduled for October 21, 2025

RECORD OF PROCEEDINGS

MINUTES OF A REGULAR MEETING OF
THE BOARD OF DIRECTORS OF THE
SOUTH PARK AMBULANCE DISTRICT
HELD
AUGUST 19, 2025

A Regular meeting of the Board of Directors of the South Park Ambulance District (referred to hereafter as "Board") was convened on Tuesday the 19th of August 2025, at 6:00 p.m., at District Headquarters, 911 Castello Ave, Fairplay, CO, 80440, and via ZOOM video.

ATTENDANCE

Directors in Attendance Were:

Maria Mitchell, President
Brian Cook, Secretary
Peter Lubin, Treasurer/ Asst. Secretary
Mary Ann J. Hartt, Director

Directors Absent, and Excused:

Mark Lamb, Excused

Also, in Attendance Were:

Kevin Borns, Chief; South Park Ambulance District.
Tracie Kaminski; Pinnacle Consulting Group, Inc.
Captain Alisha Wiltse, Captain Michael Wilson; Staff, South Park Ambulance District.
Ian Jolley, Community Paramedic, Staff; South Park Ambulance District.

Director Mitchell called the meeting to order at 6:00 P.M.

Director Mitchell declared that a quorum of the Board was present, with four of five members in attendance.

ADMINISTRATIVE MATTERS

Agenda: A proposed agenda was distributed for the Board's review and approval. Following review and discussion, upon motion duly made by Director Mitchell, seconded by Director Cook, and upon vote, unanimously carried, the Board approved the agenda as presented, and Director Lamb's absence was excused.

Disclosure of Potential Conflicts of Interest: Director Mitchell inquired whether there were any potential conflicts to disclose by Board members present, which have not already been adequately disclosed. There were no potential conflicts to disclose by Board members present.

Minutes: The Board reviewed the minutes of July 15, 2025, Special Board meeting. Following review and discussion, upon motion duly made by Director Cook, seconded by Director Hartt, and upon vote, unanimously carried, the Board approved the minutes of the July 15, 2025, Special Board meeting, as presented.

Public Comment: There were no Public Comments to bring before the Board.

DEPARTMENT
MATTERS

Chief's Report: Chief Borns reviewed with the Board the written Chief's report for August 2025. As of August 19, 2025, they have responded to 781 calls in 2025. The District has responded to 46 calls so far this month.

Vehicle Update: Chief Borns reported that there are minor issues with the new ambulance box doors, which Braun Northwest is currently addressing. In addition, minor repairs will be completed on the older Explorer vehicle to ensure the new Community Paramedic Captain has a reliable response vehicle while the District awaits delivery of the newer unit.

Buildings: Chief Borns reported that mold mitigation is underway at the Fairplay station. Two bids were received, and one was accepted for \$6,500 as the vendor completed the mitigation and material repairs.

Personnel: Chief Borns reported that the District had two paramedics end their employment due to personal reasons. Both positions were filled, and interviews are underway for the vacant position that will be created once the Community Paramedic Captain is moved off from the ambulance.

Donation of 2008 Ambulance #13 to Hartsel Fire Protection District in lieu of Mechanical Services Performed on Ambulance Unit #11: Chief Borns presented a proposal to Donate the 2008 Ambulance #13 to Hartsel Fire Protection District in lieu of Mechanical Services Performed on Ambulance Unit #11. Following review and discussion, upon a motion duly made by Director Lubin, seconded by Director Hartt, and upon vote, with Director Cook abstaining, the Board approved the Donation of 2008 Ambulance #13 to Hartsel Fire Protection District in lieu of Mechanical Services Performed on Ambulance Unit #11, as presented.

Financial
Matters

Approval of Claims: Ms. Kaminski reviewed with the Board the Claims for the period ending July 31, 2025, totaling \$100,428.82. Following review and discussion, upon a motion duly made by Director Cook, seconded by Director Hartt, and upon vote, unanimously carried, the board ratified the Claims for the period ending July 31, 2025, totaling \$100,428.82, as presented.

Unaudited Financial Statements for the period ending June 30, 2025: Ms. Kaminski presented the Unaudited Financial Statements for the period ending June 30, 2025, to the Board. Following review and discussion, upon a motion duly made by Director Lubin, seconded by Director Cook, and upon vote, unanimously carried, the Board approved the Unaudited Financial Statements for the period ending June 30, 2025, as presented.

LEGAL MATTERS

There were no Legal Matters to come before the Board.

OTHER
BUSINESS

Discussion was held concerning the Community Paramedic program. Chief Borns and Mr. Jolley answered questions regarding the establishment of the Community Paramedic Program. Ms. Kaminski noted that the Community Paramedic program will have a stand-alone budget beginning in 2026 to ensure funding allocation and expenditure tracking is done appropriately.

ADJOURNMENT

There being no further business to come before the Board, upon motion duly made by Director Mitchell, seconded by Director Cook, and upon vote, unanimously

carried, the meeting was adjourned.

Respectfully submitted,

By: _____
 Jake Downing,
 Secretary for the Meeting

Chief's Report

9/16/2025

Call stats:

At the time of this report 9/11/25 the district has responded to 884 requests for service and 36 calls so far in the month of September. 25 of those 36 calls have resulted in transport to the hospital. For comparison, we ran 113 total calls in August and only 45 of those resulted in a transport.

Vehicles:

We have 2025 Ford expedition ordered for the Community Paramedic vehicle with a lead time of 6 weeks and then it will go in to be wrapped. I will have total costs once I get the wrap cost and costs of outfitting the vehicle with emergency lights and a cage for secure transport. We will also discuss approval to sign for a new ambulance build, that if approved we would take delivery in early 2027. This would be a 2027 budget item. You will see the bid attached.

Equipment: We will discuss the purchase of ventilators for the ambulances. This is a new equipment item that we have not had in the past. However as we add the skill of Rapid sequence Induction (Think of what the anesthesiologist does during a surgery) at the request of Dr Smith, we will need these to safe ventilate patients during transport to the hospital.

Buildings:

No issues with the buildings.

Personnel:

We are currently holding interviews for one open position and a position to take Ian Jolley's spot on the ambulance so he can focus completely on the community paramedic program. We have multiple well-qualified applicants so we will take our time so that we make good offers.



150 North Star Drive / PO Box 1204 / Chehalis, WA 98532 / 360.748.0195 / 800.245.6303 / fax 360.748.0256

PROPOSAL

August 27, 2025

South Park Ambulance District
Attn: Kevin Borns
911 Castello Avenue
P.O. Box 417
Fairplay, CO 80440
chief@southparkambulance.com

RE: One (1) 2026 North Star 154-1 Ambulance

Braun Northwest is pleased to offer the following proposal:

One (1) 2026 North Star 154-1 Ambulance on a 2026 Ford F-450 Super Cab 4x4 ambulance prep gas chassis based upon NS vehicle #4129/30-1 "As-Built" specifications dated 4/3/2025 and drawings dated 4/10/2025 with the following change:

- **Utilize a 2026 Ford F-450 Super Cab 4x4 ambulance prep gas chassis, including current standard model year options**

Total F.O.B. Chehalis, WA \$287,749.00****
Sales tax not included

F.O.B.: Chehalis, Washington

Delivery: Approximately 530 – 580 days, based upon current manufacturing plan and receipt of chassis.

Terms: Ninety percent (90%) payment due upon receipt of vehicle. Balance due in thirty (30) days.

**Note: Above pricing includes a chassis flooring fee. You will be notified as soon as the chassis arrives at Braun Northwest. If chassis is paid in full within 30-days of arrival a credit will be issued (See Options Page).*

***The above pricing is based upon the availability of the current model year. Should the model year no longer be available at the time the order is placed, a newer model year will be offered with an adjustment in price.*

****In the event of chassis price increases due to the potentially implemented tariffs, which are out of Braun NW's control, customer will be notified of the cost change associated with the chassis, and adjustments will be made via a change order.*

*****Note: The above pricing is based upon foregoing the pre-construction meeting and going directly into production, maintaining the current specification design dated 4/3/2025. If a pre-construction meeting is scheduled and/or changes are made to design, the \$5,000.00 discount will be removed.*



EMERGENCY VEHICLES

www.braunnw.com



150 North Star Drive / PO Box 1204 / Chehalis, WA 98532 / 360.748.0195 / 800.245.6303 / fax 360.748.0256

(Note: This bid is contingent on use of customer's Government Ford Fleet Identification Number.) Failure to secure a FIN will increase the price by the amount of the GPC chassis discount.

Braun Northwest, Inc. is a Colorado Franchise Dealer (42321) and Manufacturer (42296) with insurance information available upon request.

Respectfully Submitted by:
Braun Northwest, Inc.

Tami McCallum
Tami McCallum, V.P. of Sales

Date: 8/27/25

We agree to accept the above proposal:
South Park Ambulance District

Signature **Date**

Printed Name **Title**

TM
cc TR/RC
Enclosures: Option page, specifications, drawings.



EMERGENCY VEHICLES

www.braunnw.com

**OPTIONS
FOR
*South Park Ambulance District
Fairplay, Colorado***

Please indicate if you want the following options by initialing in the space provided and checking the appropriate "yes" or "no" box, then sign where indicated below. After completion, please return this original form to our office along with the original proposal.

Thank you!

1. Pay for chassis in full within 30-days of receipt of chassis at Braun Northwest.
DEDUCT PER UNIT <\$4,000.00>
Do you want this option? ☐ Yes ☐ No _____ initials

(NOTE: THIS PRICING DOES NOT INCLUDE SALES TAX.)

APPROVED BY: (Please initial above choice (s) & sign below)

_____ (Signature)	_____ (Date)	_____ (Printed Name)	_____ (Title)
----------------------	-----------------	-------------------------	------------------

BRAUN NORTHWEST, INC.
DETAILED SPECIFICATIONS
FOR
SOUTH PARK AMBULANCE
FAIRPLAY, COLORADO
4129-1 AND 4130-1

1 CHASSIS

1.01 OEM CHASSIS

- 2024 Ford F-450 XLT, Super Cab, 4 x 4, meeting all the specifications of Section 1.01 (Note: Chassis is subject to model year changes)
 - Ambulance Prep Package (47A)
 - 3 year/36,000-mile Bumper-to-Bumper warranty
 - Dual rear wheels
 - Provided by Braun Northwest

1.01.01 SPECIFIC RATINGS

- Drive – 4 x 4
- G.V.W.R. – 16,500 lb.
- Front Axle – 7,000 lb.
- Rear Axle – 12,880 lb.
- Wheelbase – 192"
- Cab to Axle – 84"
- Front Spring Capacity – 7,000 lb.
- Rear Spring Capacity – 12,880 lb.
- Rear Differential – 4.88 ratio, limited slip wide track rear axle

1.01.02 POWER TRAIN

- Engine
 - 7.3L V8 Gas DEVCT NA PFI (99N)
 - Engine block heater
 - Oil Minder System
- Engine Cooling System
 - Heavy duty, closed-air, free-liquid state type
 - Coolant recovery system
 - 50/50 solution Permanent type antifreeze to –34 degrees F
- Transmission
 - TorqShift 10-speed automatic transmission with selectable drive modes (Normal, Eco, Slippery Roads, Tow/Haul)
 - External oil cooler in chassis grille area
 - Electronic Shift on the Fly
- Exhaust System
 - System complies with Federal Motor Carrier Safety Regulations, Part 393.83

Previous Builds: 2977-1, and 3029-3

- Suspended using three hangers, excluding manifold attachment
- Discharge at right rear side of module
- Tailpipe shall not terminate within twelve inches of the vertical axis of the fuel tank filler opening.

1.01.03 STEERING

- Power-assisted
 - Manual Tilt and telescoping steering wheel/column

1.01.04 SHOCK ABSORBERS/STABILIZER BARS

- Heavy-duty shock absorbers front and rear
- OEM front and rear stabilizer bars

1.01.05 BRAKES

- Heavy duty power-assisted four-wheel ABS; front and rear disc
- Front 15.39" diameter; Rear 15.75" diameter
- Trailer Brake Controller

1.01.06X TIRES AND WHEELS

- Seven OEM LT 225-70R-19.5G all-purpose steel belted radials
- Seven OEM 19.5" steel wheels
- Spare tire and wheel shipped loose
- OEM jack and tire changing tools
- OEM stainless steel wheel simulators with braided valve extenders **(945)**

1.01.07 ELECTRICAL

- Alternators – OEM dual rated at 410 Amps total
- Batteries – OEM Dual 750CCA 68AH/Group 65 AGM
- Stationary Elevated Idle Control

1.01.08 INSTRUMENT PANEL AND CONTROLS

- Gauges
 - Speedometer
 - Tachometer
 - Engine Coolant Temperature
 - Transmission Fluid Temperature
 - Fuel Level
 - Indicator lights
 - Odometer/Trip Odometer
- Cruise Control, with steering mounted controls
 - Audio – OEM AM/FM with MP3
 - SYNC 4 - 8" touchscreen in center stack
- 4.2" LCD Productivity Screen in IP Cluster with compass display
- Ford Pass® Connect 5G Wi-Fi Modem
- Ford Co-Pilot 360
 - Audible Lane Departure Alert
 - Pre-collision Assist with Automatic Emergency Braking
- Rearview Camera and Prep Kit **(872)**

1.01.09**CAB EXTERIOR**

- Trim Level – XLT
- Bumper – Chrome
- Tow Hooks – Two Front
- Mud Flaps – Two Front
- Horn – OEM dual electric
- Windows – Solar Tinted
- Windshield wipers – Two-speed electric, washer and intermittent speed control
- Mirrors
 - Two black manually telescoping trailer tow
 - Power, heated glass, upper portion
 - Turn indicators and clearance lights on outside edge
 - Lower portion convex
- Lights
 - Headlamps – Auto High-Beam, Quad-beam halogen
 - Roof clearance light
 - Daytime running lamps
- Fuel – OEM 40-gallon tank

1.01.10**CAB INTERIOR**

- Trim Level – XLT
- Seats – OEM
 - Cloth 40/20/40
 - Combination lap and shoulder harness
 - Side door armrest
- Flooring – Black vinyl
- Climate control – OEM
 - Heavy duty, fresh air, high-capacity heater/defroster
 - Dehumidifying air conditioning system
- Airbags
 - Driver and right-front passenger front
 - Front-seat side
- Other
 - Dome light, with dual map lights
 - Auxiliary Power Point
 - Interior hood release
 - Power door locks & windows
 - Remote keyless entry w/Antitheft

1.01.11**COLORS**

- Exterior – Oxford White (Z1)
- Interior – Medium Dark Slate

Previous Builds: 2977-1, and 3029-3

1.02 CHASSIS MODIFICATIONS

The following modifications shall be made to the chassis by Braun Northwest.

1.02.04 EXHAUST HEAT SHIELDS

Shall be formed from 20 ga. galvanized sheet metal with stamped reinforcements and formed edges. Access openings shall be provided for shock absorber, mounting bolts, etc. Heat shields shall be bolted to chassis frame and extend from back of cab to the frame cross member just behind the rear axle.

1.02.05G RUNNING BOARDS

Running boards made of 0.125" bright aluminum diamond plate with Grip Strut inserts embedded in the step surfaces for a Ford F-450 Super cab shall be securely mounted on both sides of the chassis with OEM fasteners.

1.02.07B AUTO THROTTLE

The OEM high idle feature shall be configured to automatically adjust the throttle based on demand for patient compartment heat or air conditioning.

1.02.08B RECOVERY EYES

Two rear recovery eyes, rated at 10,000 lb per pair, shall be installed in 6.75"W x 6.75"H x 4.375"D recessed pockets. Eyes shall be 1.8125"D, bolted to frame. These eyes shall not be used for towing or lifting of emergency vehicle.

1.02.09 MUD FLAPS

Mud flaps with the "NORTH STAR" logo shall be installed behind rear wheels.

1.02.14X SUSPENSION

A LiquidSpring rear suspension system shall be installed, with a kneeling feature to activate when the rear streetside patient compartment entrance door opens within 60 minutes of the chassis ignition being turned off. An override switch labeled "DUMP OVERRIDE" shall be installed on the curbside rear wall, accessible from rear curbside door. The LiquidSpring control panel shall be installed on the chassis dash to the left of the steering wheel. **Both surfaces shall be cleaned with alcohol prior to application of self-adhesive hook-and-loop fastener pads.**

1.02.17 CHASSIS FRAME EXTENSIONS

A 10"H frame extension shall be welded to each OEM frame rail to provide rear lateral and bumper support and to provide a step height of 13.5" from the bumper to the module floor.

1.02.18A BUMPER/GRILLE GUARD

A Bodyguard FT Series (#JEF23D) black aftermarket bumper/grille guard combo shall be installed on the front of the chassis.

Four Whelen T-Series grille lights with chrome housings shall be installed on the grille guard (Section 6.30.08 related).

Two Federal Signal siren speakers shall be installed in the aftermarket bumper (Section 6.30.10).

A 30" Rigid Industries LED lightbar (#132313) with bracket shall be installed on the aftermarket bumper (Section 6.33 related).

Previous Builds: 2977-1, and 3029-3

1.02.21D CHASSIS LIGHTING

One Weldon #8080-7000-13 LED red/white dome light shall be installed in the center of the ceiling (Section 6.11 related). Light shall be switched on at light head.

1.02.60 CAB CONDUIT

A 5.5" cab conduit shall be installed between the cab and module located behind the driver's seat. The driver's console harness shall be routed through the conduit.

1.03 MODULE-TO-CHASSIS MOUNTING SYSTEM**1.03.01 MODULE MOUNTING SYSTEM**

The module shall be bolted to the chassis frame in no fewer than twelve locations. Each mounting location shall include a hard rubber isolation pad between the chassis frame and the module lateral. The rearmost lateral(s) shall be connected to the frame extensions with 5/8" grade 8 bolts. All remaining laterals shall be connected with vertical 3/4" grade B7 eye bolts fastened to the frame rails with horizontal 3/4" grade 8 hex bolts. All bolts shall be secured with locking nuts.

1.03.02A CAB-TO-MODULE ATTACHMENT

The module shall be connected to the cab with a flexible watertight boot to allow cab-body flex as designed by the chassis manufacturer. The chassis rear window shall be replaced by an aluminum insert covered with black-painted polyurea thermoplastic elastomer, with a 16"W x 12.5"H opening on the cab side with a sliding clear 0.25" polycarbonate window and an extruded aluminum door pull, a 16"W x 15"H opening on the module side, and a stainless-steel cover to protect the bottom of the pass-thru (Sections 2.13 and 3.04.01 related).

2 MODULAR CONSTRUCTION

All material utilized shall be of the correct type, alloy, and thickness to withstand the intended usage and provide protection against cracking, corrosion, or metal fatigue. All materials utilized shall be of open stock origin, commonly available through local sources, for rapid and economical repair or modification of the body. Any use of proprietary parts or materials in the construction of the body is unacceptable, due to potential delays or difficulties in future repairs or service. NO EXCEPTIONS TO BE TAKEN IN THIS AREA. This specification has been designed and written to fill specific needs of this agency. Where brand name, make, or model of equipment has been specified, no exceptions shall be allowed. Where compartment and cabinet sizes have been specified, bidder must bid substantially (plus or minus 1") the size specified.

The module shall have a transferable lifetime structural warranty.

2.01

MATERIAL

<u>EXTRUSIONS</u>	<u>SIZE</u>	<u>ALLOY</u>
Structural Tubing	1" x 2" x 0.125" sq.	6063-T52
Structural Tubing	2" x 2" x 0.125" sq.	6063-T52
Structural Angle Cross Members	3" x 3" x 0.375"	6061-T6
Structural Channel Cross Members	1.5" x 0.25"	6061-T6
<u>FORMED SHEETING</u>	<u>SIZE</u>	<u>ALLOY</u>
Skin/Roof/Compartments/Subfloors/Doors	0.125"	5052-H32
Interior Cabinets	0.090"	5052-H32
Diamond Plate	0.125"/0.08"	3003-H22
Stainless Steel	16 ga., 20 ga.	304 # 4B

2.02

MODULE DIMENSIONS

Drop Skirt	4.00
------------	------

Overall Vehicle Dimensions (Specifications are listed as minimums.)

Length	26 '	7.75 "	319.75 "
Width (excluding mirrors)	8 '	0 "	96.00 "
Height (Approximate)	9 '	6.25 "	114.25 "

Exterior Module Dimensions (Specifications are listed as minimums.)

Length	12 '	10 "	154.00 "
Width	8 '	0 "	96.00 "
Height	7 '	8.37 "	92.37 "

Interior Dimensions (Specifications are listed as minimums.)

Length	Forward Wall to Rear Wall	148.00 "
Width	Left Wall to Right Wall	91.00 "
Floor Width	Left Cabinets to Squad Bench	50.25 "
Height	Floor to Ceiling	72.00 "

Load Height (Approximate)	37.00 "
With Suspension dumped	33.00 "

2.03 STRUCTURAL FRAMING

Side wall and rear wall construction shall consist of 2" x 2" x 0.125" aluminum square tubing extensions welded together with a maximum of 14" centers. 1" x 2" x 0.125" aluminum tubing may be utilized in addition to 2" x 2" tubing to accommodate custom compartment sizes. The bottom of the wall structure shall be sealed with a welded 2" x 2" tube, a 2" x 2" angle, or a 0.125" plate depending upon location. The wall structure shall be capped with a 2" x 4" x 0.125" header upon which a 2" x 2" x 0.125" roof structure is welded. This process provides a unitized roll cage structure for greater occupant safety. The front wall structure shall be constructed of formed aluminum channels to allow ample space for wiring raceways, heater hoses, and A/C hoses.

2.04 FOUNDATION SYSTEM

The foundation system shall consist of a 0.125" aluminum sheet subfloor with foundation members securely welded under the subfloor. Transverse members (laterals) shall consist of 3" x 3" x 0.375" structural angles. 0.25" x 1.5" aluminum stringers shall span longitudinally between the laterals.

2.05 MODULE SEAMS

All body and compartment seams at or below floor level shall be full-seam-welded. The entire perimeter of the subfloor shall be completely sealed with a caulking material, creating a watertight seam.

2.06 EXTERIOR SKIN

A Norton NORBOND closed-cell, polyurethane foam tape with high-performance acrylic adhesive shall be utilized full length on all front and rear wall and roof frame members. A polyurethane adhesive sealant shall be applied to the edges of framing members that are bonded with NORBOND tape. An advanced two-part methacrylate structural adhesive shall be used to bond all side wall tubes to the exterior skin and door frames.

The module shall be constructed utilizing full-size sheet construction to minimize body seams. There shall be no corner or mid-body seams.

2.07 MODULE ROOF

In order to improve module strength and minimize exposed seams, the roof shall be seamed transversely, shall be crowned, shall have a 1.5" radius along the edges, and shall be welded to 2" x 4" wall header tubes 4.75" below the roof line. The roof shall be supported by positive contact between sidewall framing and roof framing. All seams on the roof surface shall be continuously welded and body-worked on the outside. In order to avoid the possibility of paint and/or weld cracking, no extrusions shall be used in the exterior construction of the roof or corners of the module.

A contoured, 3/8" aluminum plate, painted to match the module, shall be welded to the roof structure and project through the center of the roof to serve as anchorage for personal fall arrest equipment. The anchorage is designed and rated for a single person only.

2.08**MODULE EXTERIOR COMPARTMENTS**

All compartments shall be constructed from formed 0.125" aluminum, securely welded to the subfloor and structural framing. A baffled drain hole shall be provided in all exterior compartment bottoms that extend below the floor line. All exterior adjustable shelves shall be mounted on aluminum track securely welded to compartment interiors. Each shelf shall support at least 300 lb of equipment.

COMPARTMENT #1

Interior Dimensions – 51"W x 45"H x 20"D

Doorway Dimensions – 51"W x 45"H

Location – Streetside, forward

Shelving – One adjustable

Door(s) – Double

Light(s) – Two LED strip lights (Section 6.26 related)

Additional Instructions –

- An aluminum mounting plate for the OEM spare tire shall be installed on two strips of aluminum track, on the back wall, aft (Section 4.19 related). The spare tire shall be mounted on the bracket.
- The 120 VAC Power Box shall be installed in the forward wall (Section 6.21 related), recessed so as not to protrude into the compartment.
- A vent with MERV 8 polyester filter media and a hex-punched stainless-steel cover shall be installed on the forward wall.

COMPARTMENT #2

Interior Dimensions – 20"W x 66.75"H x 12"D

Doorway Dimensions – 20"W x 66.75"H

Location – Streetside, aft

Shelving – None

Door(s) – Single

Light(s) – One LED strip light (Section 6.26 related)

Additional Instructions –

- This compartment shall have a welded bracket, painted to match the compartment, and three ratcheting straps with UHMW stiffeners set up for storage of a *customer-supplied-and-installed* H-size cylinder (Section 4.10 related).
- A vent with MERV 8 polyester filter media and a hex-punched stainless-steel cover shall be installed on the aft wall.

COMPARTMENT #3**Interior Dimensions** – 20"W x 76"H x 20"D**Doorway Dimensions** – 20"W x 70"H**Location** – Curbside, aft**Shelving** – Three adjustable, partial width**Door(s)** – Single**Light(s)** – One LED strip light (Section 6.26 related)**Additional Instructions** –

- A painted aluminum, fixed, full height and full depth vertical divider shall be installed in this compartment.
- Two backboard restraining straps shall be installed, from the vertical divider to the forward wall. A formed stainless steel gasket cover shall be installed on the lower doorframe edge so that backboards do not cut gasket material.
- Four strips of vertical aluminum track shall be installed, two on the aft wall, and two on the center divider (aft facing side). Three partial width adjustable shelves shall be installed aft of the divider, upper.
- A slide-out tool board with 20" slides, grab hole, gas shock, bracket and strap shall be installed by BNW on the aft side of the divider, for storage of a *customer-supplied-and-installed* Stryker stair chair (Section 4.27 related).
- A vent with MERV 8 polyester filter media and a hex-punched stainless-steel cover shall be installed on the aft wall.

COMPARTMENT #4**Interior Dimensions** – 25"W x 21.625"H x 20"D**Doorway Dimensions** – 23"W x 21.625"H**Location** – Curbside, aft of wheel well**Shelving** – One adjustable**Door(s)** – Single**Light(s)** – One LED strip light (Section 6.26 related)**Additional Instructions** – None**COMPARTMENT #5 – Inside/Outside Access****Interior Dimensions** – 22.75"W x 54.75"H x 29"D**Doorway Dimensions** – 22.75"W x 54.75"H**Location** – Curbside, forward**Shelving** – See Cabinet #19**Door(s)** – Single**Light(s)** – One LED strip light (Section 6.26 related)**Additional Instructions** –

- This compartment shall provide inside/outside access to Cabinet #19, with a full width stainless steel threshold on the floor level shelf. There shall be general storage located below the floor.

2.09**MODULE DOORS**

The doors shall be box-pan-formed with a total thickness of 2".

Previous Builds: 2977-1, and 3029-3

2.09.01 DOOR FRAME AND SEAL

Each door frame shall have a flange for the installation of an air cell hollow core 360-degree compression door seal. This seal creates watertight, dust-free compartment integrity. Door seal shall be knock-on type. Door frames shall be bonded to the adjacent tubes such that no exterior flange is required. A secondary wiper style seal shall be installed across the top and between the rear passage doors.

2.09.02 DOOR HINGES

Compartment and passage doors shall have full-length, piano-type, 2.5"W stainless steel hinges, positioned with 0.25" rivets at each end. The hinges shall be attached with #12 x 0.75" stainless steel truss head screws spaced 4" apart, sealed with Sikaflex. All curbside and streetside side-hinged single doors shall be hinged on the forward sides, rear passage doors shall be hinged on the outboard sides.

2.09.03A DOOR LATCHES

Exterior door handles shall be semi-flush, chrome-plated Eberhard E Grabber #21100. Passage doors shall have release handles on the inside of each door. All exterior doors shall have rotary latches and striker posts that meet FMVSS 206 requirements. Striker posts shall be adjustable and be secured with a nut from behind the door frame. The striker washer shall not be removed. Doors greater than 45" tall shall have double rotary latches activated by stainless steel rods. Once final adjustments have been made, threads shall have Loctite or equivalent applied. All double-door compartments shall have an exterior E Grabber handle and rotary latches on each door. Doors shall latch to doorframe-mounted striker posts only and not to one another. Curbside passage and rear curbside doors shall have interior handles with dual-point, rod-actuated, rotary latch systems that are lockable inside and out. All locks shall be keyed J236.

Rear passage doors shall both have emergency release levers, one at the top and bottom of each door and accessible from the inside of the module.

2.09.04X COMPARTMENT DOOR CONTROL

A spring-dampened gas shock capable of holding the door open at approximately a 90-degree angle on any road surface shall be installed at the top of each compartment door.

Two 2"H black seatbelt-type straps with footman loops shall be installed, one each at the top and bottom of the door frame of Compartments #1, #3, and #5, to protect the door from excessive overtravel.

2.09.05X CURBSIDE DOOR CONTROL

A spring-dampened gas shock capable of holding the door open at approximately a 90-degree angle on any road surface shall be installed at the top of the curbside passage door.

Two 2"H black seatbelt-type straps with footman loops shall be installed, one each at the top and bottom of the door frame to protect the door from excessive overtravel.

2.09.06 REAR DOOR CONTROL

Rear door controls shall be one grabber-type hold-open device with replaceable rubber catch, per door.

2.09.07 COMPARTMENT DOOR SKINS

Each compartment door skin shall be made of 0.080" bright aluminum diamond plate, shall be removable, and have a latch service opening with a 2.25" x 4.5" black rubber plug for lubrication and service. Door skins shall be secured with #8 pan head screws and Sikaflex. Red/white 1.5" conspicuity tape shall be installed on the outboard vertical edge of each door.

2.09.08X ENTRANCE DOOR SKINS

Each entrance door skin shall be made of 0.090" brushed aluminum and be removable to service door hardware. A removable stainless-steel bezel shall be installed at mid-height on the door skin to provide access to the latch hardware and electric lock motors (Section 6.40 related). Red/white 1.5" conspicuity tape shall be installed on the top, bottom, and outboard vertical edges of both the curbside passage door and rear curbside door. The streetside rear passage door shall have conspicuity tape on the top and bottom edges.

An override switch labeled "AUTO/OFF" shall be installed on the curbside passage door skin bezel to prevent the step from being extended (Section 4.17 related).

A Whelen #3SR00FRR Red Lens Red LED flasher shall be surface-mounted in the lower outboard corner of each passage door skin, to activate when the respective door is open (Section 6.51 related).

A 7 qt. waste container and bracket shall be mounted on the curbside entrance door skin (Section 5.26 related).

2.09.09 ENTRANCE DOORWAYS

One curbside and two rear module entrance doors shall be provided. The curbside doorway dimensions shall be 31"W x 77.75"H. The rear doorway dimensions shall be 49.75"W x 66"H.

2.09.10 THRESHOLDS

All compartment and module access door frames shall have full-width-formed stainless-steel threshold plates to protect the lower edge of frame.

2.10 MODULE INTERIOR CABINETS

Shall be formed of 0.090" aluminum and shall be securely welded or mounted to the structural framing. All interior adjustable shelves shall be mounted on 1" wide aluminum track.

CABINET #1

Dimensions – 27.50"W x 13.75"H x 15.75"D

Location – Streetside, forward

Shelving – One adjustable

Door(s) – Top-hinged clear 0.25" polycarbonate door with a twist-slam latch, two gas shock hold-opens, and an extruded aluminum door pull

Lighting – Blue LED under-cabinet strip light (Section 6.14 related)

Additional Instructions – None

CABINET #2**Dimensions** – 27.50"W x 13.75"H x 15.75"D**Location** – Streetside**Shelving** – One adjustable**Door(s)** – Top-hinged clear 0.25" polycarbonate door with a twist-slam latch, two gas shock hold-opens, and an extruded aluminum door pull**Lighting** – Blue LED under-cabinet strip light (Section 6.14 related)**Additional Instructions** –

- A 120 VAC fluid warmer with a 120 VAC GFCI duplex receptacle shall be installed, aft (Sections 6.21 and 6.35 related).

CABINET #3 – Angled Faceplate**Location:** Streetside, upper center**Lighting** – Blue LED under-cabinet strip light (Section 6.14 related)**Additional Instructions** –

- The following items shall be installed on an angled painted aluminum faceplate:
 - One digital thermostat (Section 5.17 related)
 - A four-switch attendant panel (Section 6.13 related)
 - Two punched areas for two *customer-supplied-and-installed* radio speakers (Section 6.18 related).

CABINET#4 – Glove Storage**Dimensions** – 40.625"W x 6.25"H x 4"D**Location** – Streetside, upper, above attendant area**Door(s)** – Bottom hinged, painted aluminum with four cutouts and two quarter-turn latches**Lighting** – Blue LED under-cabinet strip light (Section 6.14 related)**Additional Instructions** –

- This cabinet shall provide storage for four glove boxes in a horizontal orientation (Section 5.32 related).

CABINET #5**Dimensions** – 18"W x 18"H x 15.75"D**Location** – Streetside, aft**Shelving** – Two adjustable**Door(s)** – Top-hinged clear 0.25" polycarbonate door with a twist-slam latch, gas shock hold-open and an extruded aluminum door pull**Lighting** – None**Additional Instructions** – None**CABINET #6****Dimensions** – 18"W x 21"H x 7.625"D**Location** – Streetside, aft**Shelving** – Two adjustable**Door(s)** – Forward-hinged, clear 0.25" polycarbonate door with a twist-slam latch, and an extruded aluminum door pull**Additional Instructions** – None

#7 – Action Area**Dimensions** – 41.375"W x 25.375"H x 20"D**Location** – Streetside**Additional Instructions** –

- The following items shall be installed on the Action Area wall:
 - One dual rail oxygen outlet (Section 5.11 related)
 - A two-switch panel (Section 6.13 related)
 - One SCORR #22000 flush-mount suction regulator with a SCORR #22002 stainless steel wall mount bracket (Section 5.13 related)
 - One 120 VAC GFCI duplex receptacle (Section 6.21 related)
 - One 12 VDC power point receptacle (Section 6.25 related)
 - One inverter status panel (Section 6.31 related)
- Space for a *customer-supplied-and-installed* Technimount Bracket Pro swivel surface-mounted bracket for a *customer-supplied-and-installed* Life Pak 15 defibrillator/monitor shall be located on the aft end of the countertop (Section 5.39 related).
- A Wilsonart "Northern Melange" 9195MLA speckled gray acrylic full depth solid surface countertop with a 0.5" retaining lip and a 2"H backsplash shall be installed.

CABINET #8**Dimensions** – 23"W x 23"H x 14"D**Location** – Streetside, forward of action area**Shelving** – Two adjustable**Door(s)** – Sliding clear 0.25" polycarbonate with felt-lined anodized aluminum track, interlocking aluminum trim, and full extruded aluminum door pulls with integral door latch.**Additional Instructions** –

- The Action Area solid surface countertop shall extend in front of this cabinet.

CABINET #9 – Attendant Seating Area**Dimensions** – 48.75"W x 23.50"H x 20"D**Location** – Streetside**Additional Instructions** –

- A USSC Valor high-back forward/side-facing attendant seat, with a black four-point single buckle seat belt with individual emergency locking retractor retractors and upholstered with Morbern Dauphine DA-322 Ash gray Vacform upholstery, shall be installed in this area. Seat shall swivel, and be securely anchored to a low-rise swivel base (Section 5.10 related).
- An oxygen window shall be installed on the aft wall (Section 5.29 related).
- A 7 qt. waste container shall be mounted on a fixed bracket behind the attendant seat (Section 5.26 related).
- A 37.50"W x 18.75"H fixed window shall be installed on the streetside wall (Section 4.08 related).

CABINET #10**Dimensions** – 18"W x 27"H x 6.75"D**Location** – Streetside, lower aft**Shelving** – None**Door(s)** – None**Additional Instructions** –

- One ABC 10 lb fire extinguisher with an Amerex #809 SAE-J3043 compliant bracket shall be installed, aft (Section 5.31 related).
- A Zico #QR-D-2 vertical D-cylinder bracket shall be installed, forward (Section 5.35 related).
- A 4"H retaining lip shall be installed at the base of this cabinet, with a drainage hole in the aft corner for cleaning purposes.

#11 – Curbside Wall**Dimensions** – 68.5"W x 44"H**Location** – Curbside, above squad bench**Additional Instructions** –

- An oxygen outlet shall be installed on the wall at the forward end of the bench, upper (Section 5.11 related).
- A single switch labeled "DOME TIMER" shall be installed on the wall at the forward end of the bench (Section 6.16 related).
- A 37.50"W x 18.75"H fixed window shall be installed on the curbside wall (Section 4.08 related).

#12 – Glove Storage**Dimensions** – 27.625"W x 6.75"H x 4"D**Location** – Curbside, above curbside passage door**Shelving** – None**Door(s)** – Bottom-hinged, painted aluminum with a black quarter turn latch and three cut-outs**Additional Instructions** –

- This cabinet shall provide storage for three glove boxes in a horizontal orientation (Section 5.32 related).

CABINET #13 – Cylinder Storage**Dimensions** – 13"W x 25"H x 5.25"D**Location** – Right front stack, facing aisle**Shelving** – None**Door(s)** – Tip-out bottom-hinged painted aluminum door with a Southco C2 latch and nylon travel stop strap**Additional Instructions** –

- This cabinet shall provide storage for two *customer-supplied-and-installed "D"* oxygen cylinders (Section 5.35 related). A stainless-steel spring with dual flaps shall be installed to prevent cylinder rattling.

CABINET #14 – Squad Bench with Storage**Dimensions** – Bench: 58.625"W x 19.75"H x 20"D

Storage: 58.625"W x 8.625"H x 20"D

Location – Curbside**Door(s)** – Hinged aluminum bench lid, with high-density foam padding covered with seamless vinyl shall provide access to the storage area. It shall have a 1.5" overhang and automatic hold-open device, and stainless-steel paddle latch. The pad shall be removable.**Additional Instructions** –

- The squad bench base to be formed from aluminum and securely anchored to sub-floor.
- The squad bench back and head pads shall have high density foam padding covered with seamless vinyl (Section 3.08 related).
- Three sets of two-point automatic locking retractor seatbelts shall be installed on the bench with three additional lower receivers, set up for use with sit-up occupants or stretcher patients (Section 5.14 related).
- One Becton Dickinson 6.9 qt. sharps container and one 7 qt. waste container shall be installed at the forward end of the bench, with an outboard-hinged painted aluminum cover and a drop-in sharps hole (Section 5.26 related).
- A net system shall be installed on forward end of the bench (Section 5.34 related).

CABINET #15 – HVAC**Dimensions** – 35.75"W x 12.5"H x 24.875"D**Location** – Curbside front stack, upper**Shelving** – None**Door(s)** – None**Additional Instructions** –

- This area shall house the AC/heater and suction pump (Sections 5.12 and 5.17 related).

CABINET #16 – Electrical Cabinet**Dimensions** – 31.25"W x 14.75"H x 10"D**Location** – Front, center over pass-thru**Shelving** – None**Door(s)** – Aluminum, top hinged, swing up door with a hold-open device, a quarter turn slotted latch, and an automatic cabinet light (Section 6.14 related)**Additional Instructions** –

- This cabinet shall house the electrical component module (Section 6.01 related).
- An atomic clock shall be mounted on the face of this cabinet (Section 5.24 related).

CABINET #17 – Radio Cabinet**Dimensions** – 14"W x 25.875"H x 10"D**Location** – Left front stack, upper**Shelving** – None**Door(s)** – Painted aluminum lift-off panel with two Southco C2 latches, one upper left, one upper right, with precision punched areas for ventilation**Additional Instructions** –

- This cabinet is intended for mounting radio components and shall be supplied with access to the power component panel (Section 6.18 related).
- Antenna cables shall terminate in this cabinet (Section 6.19 related).

CABINET #18**Dimensions** – 26.75"W x 19"H x 23"D**Location** – Right front stack, upper**Shelving** – One adjustable**Door(s)** – Two clear 0.375" polycarbonate side-hinged doors, each with a 20 ga stainless steel brace, 0.375"D steel rods, slam latch and a paddle latch handle.**Additional Instructions** –

- One 120 VAC GFCI duplex receptacle and one 12 VDC receptacle shall be installed on the back wall, upper left inboard corner (Sections 6.21 and 6.25 related).

CABINET #19 – Inside/Outside Access**Dimensions** – 29"W x 36.875"H x 24.875"D**Location** – Right front stack, lower**Shelving** – Two adjustable**Door(s)** – None**Additional Instructions** –

- This cabinet shall be accessible from the outside, via Compartment #5.
- One 120 VAC GFCI duplex receptacle and one 12 VDC receptacle shall be installed on the back wall, upper left inboard corner (Sections 6.21 and 6.25 related).
- A 2.5" cord access opening shall be cut in each adjustable shelf, centered below the receptacles.
- Four vents shall be installed in a vertical plenum on the aisle side of right front stack, spaced evenly (Section 5.17 related).
- A wall port shall be installed in the vertical plenum to provide direct heat to a patient (Section 5.17 related).

#20 – Pull Out Tray**Dimensions** – 17.625"W x 2.5"H x 15"D**Location** – Streetside, above Drawers #21**Additional Instructions** –

- A 17.625"W x 2.5"H painted aluminum pull-out tray with 12" 50-pound capacity slides with a gas shock to hold the tray in the open or closed position, shall be installed above the streetside Drawers #21. Tray shall have 2"H lips on the back and sides, with a 1" x 1" tube on the front side to serve as a pull and wrist rest.

#21 – Drawers**Location** – Streetside, forward of Attendant Area #9**Additional Instructions** –

- There shall be two 16"W x 7"H x 15"D metal drawers. Drawers shall operate on slides rated at 300 lb per set and have a gas shock hold open/closed device to ensure drawers does not accidentally open or closed during operation of the vehicle. Drawers shall be of formed 0.125" aluminum construction, coated with textured polyurea, and painted to match the interior. Lance-punched divider supports shall be installed on the front and back of each drawer and four ABS dividers shall be provided for each drawer.
- One clear polycarbonate cover shall be loose on top of the dividers in the upper drawer for use as a writing surface.
- Space for a *customer-supplied-and-installed* 3.3 qt. sharps container shall be accommodated with the ABS dividers positioned for the furthest right section in the inboard side of the lower drawer (Section 5.26 related).

Previous Builds: 2977-1, and 3029-3

CABINET #22 – Inverter Cabinet

Dimensions – 14"W x 25.875"H x 10"D

Location – Left front stack, lower

Shelving – None

Door(s) – Painted aluminum lift-off panel with two Southco C2 latches, one upper left, one upper right, with precision punched areas for ventilation

Additional Instructions –

- A Samlex inverter shall be installed on the back wall, lower (Section 6.31 related).
- The cabinet door shall have precision punched areas, top and bottom, for ventilation.

2.11A

SIDE DOORSTEP

A recessed curbside double doorstep shall be provided which is 19"D x 31"W at the curbside passage door. There shall be a drain hole and light gray Matéflex floor tile which is removable for cleaning purposes. Aluminum diamond plate kick panel shall be installed on the sides and face of the doorstep.

2.13E

CAB TO MODULE PASSAGE

Shall be a pass-thru measuring 16"W x 12.5"H on the cab side, 16"W x 15"H on the module side.

2.14

WHEEL WELL LINERS

Wheel well liners made of formed aluminum shall be installed in the module wheel well openings.

2.15

ELECTROLYSIS PREVENTION

All external materials and fasteners shall be selected to prevent electrolysis and corrosion due to dissimilar materials and exposure to the elements. The module shall be painted before any exterior items (hinges, latches, door hold opens, etc.) are installed to provide an isolating film between dissimilar materials. Exterior fasteners used for direct connection to painted aluminum surfaces shall be coated with a corrosion inhibitor.

3 COATINGS AND FINISHES

3.01 MODULE FINISH PREPARATION

The module shall be seam sealed and all imperfections on aluminum surfaces of module shall be sanded smooth. The entire exterior shall be mechanically etched and washed with wax-and-grease-remover to ensure proper primer/sealant adhesion.

3.02 MODULE PRIMER

Module shall be sealed with a two-component, low VOC, direct-to-metal epoxy primer/sealant prior to applying the finish coat of acrylic urethane paint.

3.03 PAINT TYPE

Shall be Sherwin Williams acrylic urethane.

3.04 COLOR SCHEME

Base color: to match Oxford White (GLV-108340948)

3.04.01E CHASSIS COLOR

Chassis shall be OEM Oxford White (Section 1.01.11 related).

The back-of-cab insert shall be covered with black-painted polyurea thermoplastic elastomer.

3.06 COMPARTMENT FINISH

All compartments shall be sanded, etched, washed, primed, coated with textured polyurea thermoplastic elastomer finish and painted white with gray splatter paint (G2-33631 Alt 2 / GLV-51748).

All shelves and trays shall be sanded, etched, washed, primed, and painted white with gray splatter paint (G2-33631 Alt 2 / GLV-51748).

3.07 INTERIOR CABINETS FINISH

All interior cabinetry, drawers, headliner, and upper wall coverings shall be sanded, etched, washed, primed, coated with textured polyurea thermoplastic elastomer, and painted white with gray splatter paint (G2-33631 Alt 2 / GLV-51748).

All drawers, shelves, and trays shall be sanded, etched, washed, primed, and painted white with gray splatter paint (G2-33631 Alt 2 / GLV-51748).

3.08 MODULE UPHOLSTERY

Module upholstery material shall be Dove Gray Spradling Perform 60 seamless vinyl.

3.09 MODULE FLOORING MATERIAL

Shall be Altro Transflor Meta Genome (#TFM2702) Slip-Retardant Sheet flooring providing durability, ease of maintenance and stain resistance. It shall contain a high concentration of microscopic aluminum oxide particles and colored quartz crystals suspended throughout the thickness with silicon carbide grains in the entire wear surface for slip-retardant performance. It shall have an overall thickness of 0.11" nominal. Flooring shall be manufactured for Wear Resistance to meet ASTM C 501, indentation resistance in accordance with ASTM F 1303 and ASTM F 970, Grade 1 standards, shall meet ASTM D 2047 Slip Retardant, ASTM F 970 Static Load, ASTM E648, CMVSS, FMVSS 302, CAN ULC S102.2 Fire Data Tests.

An insulated floor shall be installed over the 0.125" aluminum subfloor and shall be comprised of 0.75" thick polyiso insulation between 0.75" x 0.75" x 0.063" square tubing, covered with a 0.125" aluminum sheet (Section 2.04 related).

Floor covering material shall be seamless and cove up the side walls a minimum of 5" as a seal.

3.10 COMPARTMENT LINING

Compartment floors shall be lined with light gray Matéflex floor tile and all shelves with mat.

3.11 CABINET LINING

Interior cabinet shelves shall be lined with easy sweep mats which are removable for ease of cleaning.

3.12 SURFACES AND FINISHES

All patient compartment surfaces and finishes shall be impervious to soap, disinfectants, and water, to permit washing and sanitizing.

4 MODULE EXTERIOR

4.01B STEP/BUMPER

The rear bumper shall be a welded construction of 3" x 3" x 0.375" aluminum angle and 1.5" x 0.25" flat bar and shall be covered by 0.125" bright aluminum diamond plate. The entire top shall be non-skid Grip Strut and shall provide a 7" step. Both outermost ends shall be angled to prevent dragging of corners in high angle of departure areas. Diamond plate shall be formed on front and rear edges for channel-type strength. The bumper shall be bolted directly to the chassis frame using high strength Grade 5 bolts. Bumper shall be easily removable and replaceable in case of damage. Bumper to be designed to accommodate a one-person-style cot.

4.02X RUB RAILS

Bright finished anodized aluminum rub rails of a 2.5"H x 0.75"D custom extruded design shall be installed along the lower streetside and curbside edges of the module A 0.5"H **blue/white** conspicuity reflective tape shall be installed in the center insert area.

4.03 FENDER RINGS

High grade weather-resistant industrial rubber fender rings with a rounded outer edge shall be installed on the module, following the full contour of the wheel well opening and projecting 2.5" from the module body.

4.04 DRIP RAILS

Extruded, anodized aluminum drip rails shall be installed the full length of the module front, rear, and sides near the roof. Drip rails shall be installed with bonding tape and mechanical fasteners on each end that shall withstand exposure to the elements. They shall be finished with 45-degree angled ends to avoid hooking materials which brush against the vehicle causing damage.

4.05X ROCK GUARDS

Bright aluminum diamond plate rock guards shall cover the front module corners, **30" up** from bottom of module, 2.5" wrapped around the sides of module, and 15" across the front of the module.

4.06 REAR KICK PANEL

A bright aluminum diamond plate rear kick panel shall extend from the bottom edge of the module up to the bottom of the rear doors, full-width formed and wrapped 2.5" around the sides of the module.

Two recovery eyes shall be installed in recessed pockets in the rear kick panel (Section 1.02.08 related).

A recessed rear license plate shall be centered in the rear kick panel (Section 4.16 related).

4.07 FUEL FILL

A polished cast aluminum fill well shall be installed on the streetside of the module and be properly vented. Fill and vent hoses shall be installed and protected in accordance with the chassis bodybuilder recommendations.

4.08X MODULE WINDOWS

All module windows shall be dark-tinted, have black anodized aluminum frames, and be attached with screws for ease of replacement. The side passage door window shall be 18.75" x 18.75" with sliding glass, a positive catch, and a screen. The rear door windows shall be 18.75" x 18.75" fixed glass to prevent exhaust from entering the module. Two 18.75" x 37.5" windows with fixed glass shall be installed; one above the streetside attendant seat, one above the curbside squad bench #14.

4.09 FUEL SPLASH GUARD

A stainless steel fuel splash guard shall be installed below the fuel fill.

4.10 EXTERIOR CYLINDER STORAGE

Compartment #2 shall have a welded bracket, painted to match the compartment, and three ratcheting straps with UHMW stiffeners set up for storage of a *customer-supplied-and-installed* H-size cylinder.

4.16C REAR LICENSE PLATE

A recessed license plate holder with dual Whelen #0AC0EDCR LED lights with angled chrome bezels shall be installed below rear doors in the rear kick panel (Section 4.06 related).

A hidden unlock switch and two spacers shall be installed behind the license plate (Section 6.40 related).

4.17B ELECTRIC STEP

A Zico VS-24-9 single electric step with a 7.625" drop shall be installed under the curbside passage door and shall be wired to extend and retract with the door.

An override switch labeled "AUTO/OFF" shall be installed on the curbside passage door skin bezel to prevent the step from being extended.

4.19A SPARE TIRE MOUNT

An aluminum mounting plate with bolt, washer and wing nut shall be installed in Compartment #1. The spare tire shall be mounted on the plate.

4.27D STAIR CHAIR STORAGE

A slide-out tool board with 20" slides, grab hole, gas shock, bracket and strap shall be installed by BNW in Compartment #3, for storage of a *customer-supplied-and-installed* Stryker stair chair.

Previous Builds: 2977-1, and 3029-3

4.28X**AIR FOIL**

A See II 200 white powder coated aluminum air foil shall be installed on the rear upper edge of the module to reduce snow/dust build-up. Bottom of foil shall be positioned 4.5” from rear of module, adjustment shall be confirmed at customer inspection and delivery.



(Reference photo from customer)

4.34**AUTOMOTIVE UNDERCOATING SEAL**

The module underbody shall be coated for reduced corrosion and additional thermal insulation.

5 MODULE INTERIOR

All interior hangers, supports, fasteners, latches, and hinges shall be of a near-flush-type design. The patient compartment shall be free of sharp projections. Exposed edges and corners shall be broken with a radius or protected with 1" high-density foam covered with heavy-duty vinyl color-matched upholstery.

5.01 UPPER WALL COVERING

The upper module interior walls shall consist of light gray, heavy-grade, 0.125" ABS vinyl panels attached to the wall structure with a closed-cell polyethylene foam tape coated on both sides with a permanent acrylic-based pressure-sensitive adhesive.

5.02A HEADLINER

The headliner shall be 0.125" aluminum which is sanded, etched, washed, primed, and coated with textured polyurea thermoplastic elastomer, and painted white with gray splatter paint (G2-33631 Alt 2 / GLV-51748).

5.03 HEAD PADS/CUSHIONS

Head pads located over all module access openings shall be 1.5" foam covered with heavy-duty seamless vinyl upholstery.

Head pads and seat backs for seating positions shall be 1.5" foam covered with heavy-duty seamless vinyl upholstery.

Seat cushions shall be 3" foam covered with heavy-duty seamless vinyl upholstery (Section 3.08 related).

5.04 LOWER WALL COVERING

The squad bench sides and lower portion of the streetside wall shall be nonporous, color-coordinated material.

5.05 GRAB RAIL

One 75"L x 1.250"D stainless steel grab rail with three support brackets shall be securely mounted to roof structural framing running through centerline.

5.06 ACCESS DOOR GRAB RAILS

Each module access door shall have a 1.250"D L-style stainless steel grab handle which may also be used as an entry assist rail.

5.07 IV HANGERS

Two ceiling-mounted Cast #IV2008 recessed IV hangers shall be installed in the ceiling, one over the primary cot, one offset toward curbside.

5.08D COT MOUNT

A *customer-supplied* Stryker Power-LOAD #6390 cot fastener system with safety hook shall be installed by BNW (Section 8.02 related). The Power-Load anchor assembly shall be installed to position the aft end of the cot 11" forward of the rear doors.

No rear rail clamp shall be installed.

5.10X ATTENDANT SEATS

A USSC Valor high-back bucket attendant seat with a built-in child safety seat, black four-point single-buckle seat belt with individual emergency locking retractors and upholstered with Morbern Dauphine DA-322 Ash gray Vacform upholstery shall be located at the head of the cot position and provide easy access to all action wall controls and outlets, and to the patient. Seat shall be securely anchored to a swivel base on a Valor 6"H cabinet, with door facing aft.

A USSC Valor high-back forward/side-facing attendant seat, with a black four-point single-buckle seat belt with individual emergency locking retractor retractors and upholstered with Morbern Dauphine DA-322 Ash gray Vacform upholstery, shall be installed in the Streetside Attendant Area #9. Seat shall swivel, and be securely anchored to a low-rise swivel base.

5.11 OXYGEN SYSTEM

The entire oxygen system shall be assembled with certified oxygen hose (200 PSI maximum working pressure) with brass fittings, be pressure tested, and certified. A 50 PSI regulator shall be included, a bulkhead connector shall be installed in the ceiling of Compartment #2 and one oxygen tank wrench shall be attached to the compartment wall with hook-and-loop tape.

Two Ohio-type outlets shall be installed:

- One dual rail outlet in Action Area #7
- One on the curbside wall above the squad bench

5.12 SUCTION PUMP

The unit shall have an electric pump as the source of suction, installed in HVAC Cabinet #15, and be vented to the outside of the vehicle under the module body. The pump shall be controlled by an on/off switch labeled "SUCTION" on the attendant panel in Action Area #7 (Section 6.13 related).

5.13A SUCTION COLLECTOR

A flush mount SSCOR #22000 suction regulator and #22002 stainless steel wall-mount bracket with a 1200cc Bemis disposable canister shall be installed in the Action Area #7.

5.14X SEATBELTS

Black DOT-compliant seatbelts shall be installed at each seating position. Three sets of two-point automatic locking retractor seatbelts shall be installed on the squad bench with three additional lower seatbelt buckle ends and be set up for use with sit-up or stretcher patients. The streetside attendant seat, and head of cot attendant seat shall each have a four-point, single-buckle seat belt.

5.16 INSULATION

The module side, ends, roof, doors, and floor shall be insulated to enhance the interior environment and to restrict heat, cold, and external noise from entering the module. The insulation shall be a non-settling foam plank material of 1.5", or 0.75" thickness depending upon location and available space.

Roof, doors, wall, and floor insulation shall be polyisocyanurate.

A 3" wide, 60-mil, closed cell polyethylene foam tape shall be used as a thermal break on the inside surface of the wall tubes.

5.17X MODULE CLIMATE CONTROL SYSTEM

The module HVAC system shall incorporate a combination heating/air conditioning unit with 43,300 BTU/hr. heating and 32,000 BTU/hr. cooling capacity. The unit shall have a 580 CFM fan and controls independent of the cab system. A 12 VDC booster pump shall be installed to optimize the heating capacity in the module. A return air path with open area equal to at least twice the blower outlet area shall be incorporated into the evaporator closeout.

The module system shall be controllable by a digital thermostat located on the streetside Angled Faceplate #3.

Four adjustable air conditioning discharge louvers shall be installed in a vertical plenum on the aisle side of right front stack, spaced evenly.

A Beam #015715 wall port shall be installed in the vertical plenum to provide direct heat to a patient. A **7 ft. hose** shall be shipped loose (Section 8.01 related).

5.18 EXTERNAL AIR INTAKE

To supplement heated or cooled air with fresh air, an external air intake shall be installed on the side of the module. The intake shall consist of an opening protected by an aluminum vent cover. The interior chamber of the intake shall be made of aluminum and be formed to prevent the collection of moisture. Washable filter media shall be installed in the intake chamber.

5.19 AIR RETURN

A return air path with an open area equal to at least twice the blower outlet area shall be incorporated into the evaporator closeout.

5.20 EXHAUST VENT

A motor-powered exhaust vent with a chrome Perko cover shall be located in the rear curbside corner of the module. A switch labeled "VENT" shall be installed in the streetside angled faceplate #3 attendant panel to turn on/off the exhaust vent (Section 6.13 related).

5.24 CLOCK

An atomic-controlled clock shall be installed on the face of Electrical Cabinet #16. The clock shall be LCD display and show hours (12/24 selectable), minutes, seconds, date, day, and temperature. Clock is powered by two AA alkaline batteries.

5.26X SHARPS/HAZARDOUS WASTE CONTAINERS

One Becton Dickinson 6.9 qt. sharps container and one 7 qt. waste container shall be installed at the forward end of the curbside squad bench #14, with an outboard-hinged painted aluminum cover with a drop-in sharps hole.

A 7 qt. waste container and bracket shall be mounted on the curbside entrance door skin.

A 7 qt. waste container shall be mounted on a stainless-steel bracket behind the streetside attendant seat #9.

Space for one *customer-supplied-and-installed* Becton Dickinson 3.3 qt. sharps container shall be accommodated with the ABS dividers positioned as a bracket in the inboard side of the lower Drawer #21.

5.29 OXYGEN WINDOW

A 6" x 11" clear polycarbonate oxygen window with knob and self-closing hinges shall be installed on the forward-facing wall at the aft end of the Streetside Attendant Area #9.

5.31 INTERIOR FIRE SUPPRESSION

One ABC 10 lb fire extinguisher with an Amerex #809 SAE-J3043 compliant bracket shall be installed in the Cabinet #10.

5.32 GLOVE BUTLERS

Storage for four glove boxes in a horizontal orientation shall be provided in Cabinet #4, above the streetside attendant seat. Storage for three glove boxes in a horizontal orientation shall be provided in Cabinet #12, above the curbside passage door.

5.34C BENCH NET

A net system shall be installed at the forward end of the curbside squad bench. The net system shall be constructed of black 2" webbing and shall be easily detached for cleaning or replacement.

A BNW #65144 short buckle end shall be used to make the upper net connection beneath the glove box storage cabinet.

5.35X INTERIOR OXYGEN CYLINDER STORAGE

A Zico #QR-D-2 vertical strapless D-cylinder bracket shall be installed in Cabinet #10.

Tip-out latching storage for two *customer-supplied-and-installed* D-cylinders shall be provided in Cabinet #13, with a wedge-shaped stainless-steel spring to prevent cylinder rattling.

5.39X MONITOR/DEFIBRILLATOR BRACKET

Space for a *customer-supplied-and-installed* Technimount Bracket Pro Series 35-HD swivel surface-mounted bracket for a *customer-supplied-and-installed* Life Pak 15 defibrillator/monitor shall be located on the aft end of the Action Area #7 countertop.

6 ELECTRICAL

All added body and chassis electrical equipment shall be served by circuits separate and distinct from the vehicle chassis circuits. All vehicle wiring shall be copper and conform to all SAE J1128 requirements. The wiring shall be colored, numbered, or function coded every 3" for permanent identification and correspond with the vehicle schematics. Solderless, insulated connectors shall be used. Slotted Panduit-style wiring duct shall be used in electrical component module to ensure air circulation throughout power component wiring. The wiring shall be routed in conduit or looms and wiring shall be secured to the underbody or frame with insulated metal cable straps. All power distribution cabling shall be covered with a protective split loom. Where wiring passes over the exhaust, a heat shield shall be installed. The electrical component module shall be equipped with positive locking plugs to provide easy disconnect for remount or repair of body. All wiring devices, switches, outlets, etc., except circuit breakers, shall be rated to carry 125% of the maximum ampere load for which the circuit is protected.

The vehicle electrical system shall be tested and certified to AMD 005 requirements.

6.01 ELECTRICAL LOAD DEVICES

Body electrical wiring shall utilize overload protective devices of the automotive-type circuit breaker. In addition, one single pole, 20-amp circuit breaker shall be provided for future use. The circuit breakers, relays, and other electrical devices shall be included as part of the enclosed electrical component module located in Electrical Cabinet #16.

6.02 VOLTMETER/AMMETER

A single display voltmeter/ammeter shall be installed on the side of the console, driver's side, which simultaneously displays voltage and alternator current when the ignition is on (Section 6.09 related). Display flashes to indicate low voltage.

6.04 IGNITION CONTROL

Chassis electrical circuits shall be controlled by the ignition switch as provided by the OEM chassis manufacturer. The auxiliary chassis-related functions shall be powered by one InPower #SSC20-100 solid state contactor, triggered by the chassis ignition.

6.05A MODULE POWER

Module power shall be controlled by a driver's console-mounted switch labeled "MODULE DISC." which activates an InPower #SSC42-275 solid state contactor (Section 6.09 related). An ignition interlock shall disconnect module power 15-20 minutes after the vehicle's ignition is turned off. The interlock shall also allow module power to be reactivated independently for 15-20 minutes by cycling the ignition switch.

6.06 WIRING ACCESS

All cabinets and compartments shall have removable panels as needed to access wiring harnesses and hoses.

6.07 BACK-UP ALARM

An SAE J994-compliant self-adjusting back-up alarm shall be installed, with a momentary disable switch labeled "BACK-UP DISABLE" in the driver's console (Section 6.09 related). If disabled while in reverse, the back-up alarm shall automatically reset when shifted out of reverse.

Previous Builds: 2977-1, and 3029-3

6.08 SERVICE LOOP

A 6" service loop of wire or harness shall be provided at all electrical components, terminals, and connection points.

6.09X DRIVER'S CONSOLE

A driver's console made of black-powder-coated formed aluminum shall be installed between the seats. It shall have:

- A digital voltmeter on the side of the console, facing the driver (Section 6.02 related)
- A custom cup holder plate with a cutout for a *customer-supplied-and-installed* Kenwood VM7000 remote head (Section 6.18 related)
- Two adjustable armrests
- A map holder with six mill-finished aluminum dividers
- A faceplate with the following layout:

1.		2.	3.	
Module Disc.	Passage Compt. D/O Lights	Emerg. Master	Back-up Disable	Siren (Section 6.30.09 related)

4.	5.	6.	7.	
Lightbar	White Lights	Flashers	Amber Flashers	Whelen Traffic Advisor Controller (Section 6.30.14 related)

8.	9.	10.	11.	12.	13.	
Left Scene	Rear Scene	Right Scene	Grille Lights	Driving Lights	USB A/C	Blank

<i>Customer-supplied-and-installed</i> Kenwood VM7000 remote head (Section 6.18 related)						
--	--	--	--	--	--	--

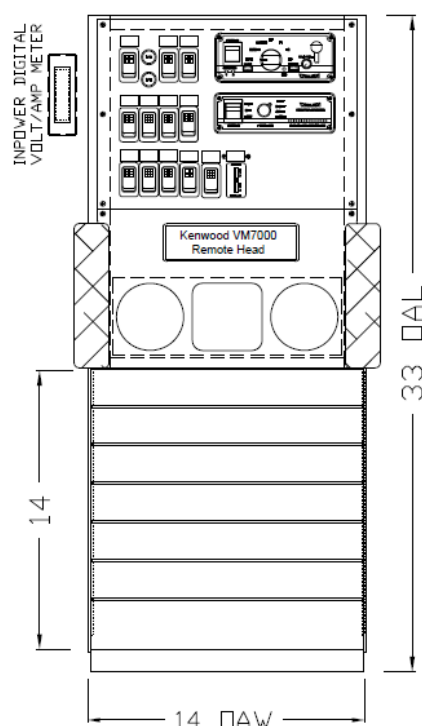

CONSOLE PROPOSAL DRAWING

6.10 SWITCHES

Switches installed in the driver's console and attendant panel(s) shall be rocker-type and permanently marked by function (Sections 6.09 and 6.13 related).

6.11X MAP LIGHT

One Weldon #8080-7000-13 LED red/white dome light shall be installed in the center of the cab ceiling (Section 1.02.21 related). Light shall be switched on at light head.

6.12 DOOR AJAR WARNING LIGHT

A flashing LED light with a red lens shall warn the driver of an open module passage door, and a flashing LED light with an amber lens shall warn the driver of an open module compartment door. The lights shall flash only if the ignition is on. Lights shall be installed on the driver's console (Section 6.09 related).

6.13 CONTROL PANEL

A four-switch control panel shall be located on the streetside Angled Faceplate #3 with the following switch layout:

1.	2.	3.	4.
Dome Hi-Off-Lo	Dome Hi-Off-Lo	Attendant Light	Vent

A two-switch control panel shall be located on the Action Area #7 wall with the following switch layout:

1.	2.
Suction	USB A/C

6.14X CABINET LIGHTING

The wall area below Cabinets #1, #2, #3, and #4 shall be lighted utilizing under-cabinet **Blue** LED strip lighting with an on/off switch labeled "ATTENDANT LIGHT" in the streetside attendant panel (Section 6.13 related).

An automatic cabinet light shall be installed in Electrical Cabinet #16.

6.16 MODULE INTERIOR LIGHTING

Shall be designed to keep vehicle height to a minimum without interfering with the structural integrity of the roof. Module interior lighting shall consist of six dual intensity Whelen #80C0EHCR LED recessed lights - one bank of three lights shall be positioned toward streetside and three lights toward curbside. There shall be a switch for each bank of lights on the streetside Angled Faceplate #3 control panel for "DOME HI-OFF-LO" (Section 6.13 related).

The curbside bank of lights shall be automatically activated on high intensity level when the rear or side doors are opened or by a momentary rocker switch labeled "DOME TIMER" mounted on the wall near the curbside passage door, which shall activate a battery hot timer. Pressing the switch once shall initiate 15-minute timed operation of the lights. Pressing the switch again shall cancel the timed operation.

6.17X BASIC EXTERIOR LIGHTING

Basic lighting shall include headlights, parking lights, directional signal lights, tail and stop lights, license plate light, back-up lights, hazard lights, identification lights, clearance lights, and side marker lights as required by FMVSS 108. Module identification lights, clearance lights, and side marker lights, unless included on a lightbar, shall be Truck-Lite LED Model 36. Rear and side reflex reflectors shall be installed in accordance with FMVSS 108 requirements.

Rear stop/tail, turn and back-up lights shall be Whelen M6 Series LED lights with chrome flanges, stacked vertically on the rear of the module, outboard above the rear kick panel, pattern from top to bottom: #M62BTT Red Lens red stop/tail light, #M62T Amber Lens Amber turn signal, and #M62BU Clear Lens Clear back-up light. The back-up lights shall activate automatically when the vehicle is placed in reverse.

A Whelen #M62BTT Clear Lens Red light head with a chrome flange shall be installed above the rear passage doors, for use as a third brake light.

6.18A COMMUNICATIONS EQUIPMENT

The customer shall be responsible for powering up and tuning of any radio equipment.

Item #1

Description: Pre-wire, including power and ground for future installation of One *customer-supplied-and-installed* Kenwood Viking VM7000 All-Band Multi-Deck Mobile radio transceiver with two remote heads.

Locations: From electrical panel to:

- Transceiver in Radio Cabinet #17
- One remote head on the driver's console (Section 6.09 related)
- One remote head below Cabinet #3 - Angled face plate

Additional Instructions: Pre-wiring to be capped and labeled at both locations. Wiring shall be installed at the power component module behind the Panduit cover.

6.19 ANTENNA MOUNTS AND CABLES

Two Larsen 27 MHz to 6 GHz NMO universal antenna mounts with RG-58U low loss, dual shield cables with FME male connectors shall be installed on the module roof. The antenna cables shall terminate in Radio Cabinet #17. Two mini-UHF style adapters shall be shipped loose (Section 8.01 related). A rain cap shall be installed on each base that does not have an antenna installed.

6.20A BLOCK HEATER

The OEM block heater connection shall not be modified.

6.21 120VAC/SHORELINE CIRCUIT BOX

Utility power shall be furnished from 120VAC shorepower via a Kussmaul 20 A Super Auto-Eject plug with a white cover on a stainless-steel plate with a green indicator light located on the streetside forward corner of the module, and distributed via a formed aluminum power box with an easily removable cover, recessed into the forward wall of Compartment #1.

Circuit breakers shall be installed for overcurrent protection and circuit isolation:

- Inverter (20 A)
- Receptacles (15 A)

All exposed receptacles shall be ground fault circuit interrupting (GFCI) and shall have a power on indicating light.

Four interior 120VAC GFCI duplex receptacles shall be mounted:

- One in Cabinet #2
- One in Action Area #7
- One in Cabinet #18
- One in Cabinet #19

6.22 BATTERY GROUNDS

In addition to OEM chassis grounds, the following ground circuits shall be added to reduce RF interference:

- A minimum 4 ga. ground cable from the power component panel to the chassis frame.
- Two braided ground straps with soldered ends from the module body to the chassis frame.

6.23 BATTERY CHARGER

A 60-amp battery charger shall be provided as part of the Samlex Pure Sine 1200-watt inverter system (Section 6.31 related).

6.24A BATTERY MODIFICATIONS

Chassis batteries shall be utilized in existing locations.

6.25 12 VDC POWER SUPPLY

Three 12 VDC, 15-amp power point receptacles shall be installed:

- One in Action Area #7
- One in Cabinet #18
- One in Cabinet #19

Two Kussmaul combination USB-A/USB-C switch-insert-style charging ports shall be installed:

- One in Action Area #7 control panel
- One in the driver's console

All 12 VDC power point receptacles, USB charge ports, 12 VDC charging circuits, electric air compressors, powered cots, and cool cabinets, if present, shall be powered from a 12 VDC auxiliary bus. An InPower LVD20-100-SPC540 low voltage disconnect switch shall deliver power to the auxiliary bus only when the supply voltage to the vehicle batteries is at or above 13.0 VDC.

6.26X COMPARTMENT LIGHTING

LED strip lighting shall be installed in each outside compartment, and shall be activated by the respective compartment door switch, except Compartment #1. Compartment #1 shall have two LED strip lights.

6.27 EXTERIOR DOOR SWITCHES

Shall be 1/2" mechanical door switches.

6.30 EMERGENCY WARNING SYSTEMS

All emergency lighting shall be controlled by the "EMERG. MASTER" switch on the driver's console (Section 6.09 related). When the switch is on, module power is on, and the vehicle is not in park, all emergency lighting shall be activated, and the hands-free function of the siren shall be enabled.

6.30.01X FRONT FLASHERS

Seven Whelen M9 Series flashers with chrome flanges shall be installed on the upper front of the module, evenly spaced, pattern curbside to streetside:

Curbside	#M9BC Clear Lens Blue LED flasher
	#M9DE Clear Lens Clear/Blue Duo LED flasher
	#M9RC Clear Lens Red LED flasher
Center	#M9C Clear Lens Clear LED flasher
	#M9BC Clear Lens Blue LED flasher
	#M9DD Clear Lens Clear/Red Duo LED flasher
Streetside	#M9RC Clear Lens Red LED flasher

The flashers shall be controlled by the "LIGHTBAR" switch in the driver's console (Section 6.09 related). The Clear M9s and Clear Splits shall disable when the vehicle is shifted into park. The white flashers shall also be controlled by the "WHITE LIGHTS" switch in the driver's console (Section 6.09 related).

6.30.02X REAR UPPER FLASHERS

Seven Whelen M Series light heads with chrome flanges shall be installed on the rear of the module, pattern curbside to streetside:

Curbside:	#M9RC Clear Lens Red LED flasher
	#M7BC Clear Lens Blue LED flasher
	#M7ZC LED scene light (Section 6.30.04 related)
Center:	#M62BTT Clear Lens Red LED third brake light (Section 6.17 related)
	#M7ZC LED scene light (Section 6.30.04 related)
	#M7BC Clear Lens Blue LED flasher
Streetside:	#M9RC Clear Lens Red LED flasher

The upper rear flashers shall be controlled by the "FLASHER" switch in the driver's console (Section 6.09 related).

The #M62BTT LED flasher installed above the rear doors shall function as a third brake light (Section 6.17 related).

6.30.03X FLASHERS

Four Whelen #M9DJ Clear Lens Red/Blue Duo LED flashers with chrome flanges shall be installed, two each on the streetside and curbside of the module in the upper corners.

Two Whelen #M9AC Clear Lens Amber LED flashers with chrome flanges shall be mounted on the rear of the module at window height.

Lights shall be controlled by the "EMERG. MASTER" switch on the driver's console (Section 6.09 related). Amber Flashers shall be controlled by a switch labeled "AMBER FLASHERS" on the driver's console (Section 6.09 related).

6.30.04 SCENE LIGHTS

Four Whelen #M9LZC LED scene lights with chrome flanges shall be installed - two each on the curbside and streetside of the module in the upper corners, inboard of the flashers. The curbside passage door shall activate the curbside scene lights. The scene lights shall also be controlled by the respective switches on the driver's console (Section 6.09 related). Two Whelen #M7ZC LED scene lights with chrome flanges shall be installed over the rear passage doors. The scene lights shall be activated by the rear passage doors or when the vehicle is placed in reverse. The scene lights shall also be controlled by the "REAR SCENE" switch on the driver's console (Section 6.09 related).

6.30.06X INTERSECTION LIGHTS

Four Whelen #TLI2J Red/Blue Duo LED flashers with chrome housings shall be installed, one on each cab fender and one above each module wheel well. Lights shall be controlled by the "FLASHER" switch on the driver's console (Section 6.09 related).

6.30.08X GRILLE LIGHTS

Four Whelen T-Series LED flashers with chrome housings shall be installed in a box shape on the aftermarket grille. Two #TLI2D Clear Lens Red/White Duo flashers shall be installed above, and two #TLI2E Clear Lens Blue/White Duo flashers shall be installed below. Lights shall flash in a "Wig-Wag" pattern, and be controlled by the "GRILLE LIGHTS" switch on the driver's console (Section 6.09 related).

6.30.09 SIREN

A Whelen 295SLSA1, 200 watt siren shall be installed in the driver's console (Section 6.09 related). Standard features shall include Radio Rebroadcast, Public Address, Manual, Wail, Yelp, Air horn, and Piercer tones. The siren's hands free function shall operate through the OEM horn ring circuit when the sirens rotary selector is in the HF position and the emergency master switch is on.

6.30.10X SIREN SPEAKERS

Two Federal Signal DynaMax #ES100C 100-watt speakers grilles shall be installed in the aftermarket bumper.

6.30.14X TRAFFIC ADVISOR

Eight Whelen #WIONSMCA Clear Lens Amber LED lights in chrome housings shall be installed on the module rear, above the upper rear flashers and drip rail.

These lights shall be controlled by a Whelen #TACTL5 Traffic Advisor controller located on the driver's console (Section 6.09 related).

6.31 INVERTER

A Samlex 1200-watt pure sine wave inverter with a 60-amp battery charger shall be installed on the back wall of Cabinet #22. The lift off door panel shall have punched areas at the top and bottom for ventilation.

An EVO-RC Plus inverter remote control panel shall be installed in the Action Area #7 wall. The inverter shall be configured to turn on and off with ignition.

6.33X DRIVING LIGHTS

A 30" Rigid Industries (#132313) LED lightbar with bracket shall be installed on the aftermarket bumper, with a switch labeled "DRIVING LIGHTS" on the driver's console (Section 6.09 related) and shall be tied to the OEM high beam control. Driving lightbar is intended for off-road use only.

6.35 FLUID WARMER

A 120 VAC fluid warmer with a 120 VAC GFCI duplex receptacle shall be installed in Cabinet #2 (Section 6.21 related). The warmer shall be thermostatically controlled at 95 to 115 degrees F. Space for 10 one-liter bags of fluids shall be provided with a 4" surround to contain the fluid bags.

6.40X ELECTRIC DOOR LOCKS

Electric door locks shall be installed on all compartment and module passage doors. Two lock/unlock switches shall be installed in the module: one located on the rear curbside passage door, and one located on the curbside passage door. The door locks for the cab and module shall be interconnected, to allow all doors to be locked/unlocked from either the cab or module.

Two hidden unlock switches shall be installed; one behind the license plate in the rear kick panel, one in the OEM grille area.

6.46I AUDIO/VIDEO/RECORDING EQUIPMENT**Item #1**

Description: A back-up camera system shall be installed, including a CabCam #A-ASC635M surface-mounted camera with automatic shutter and automatic heater with adapter cable, to display on OEM 8" in-dash screen.

Location: Camera on the rear of the module, centered above the rear passage doors.

Additional Instructions: Camera shall be wired ignition hot, and shall automatically display on monitor when the vehicle is placed in reverse. Camera shutter shall open only when the vehicle is placed in reverse.

6.51 DOOR SKIN FLASHERS

A Whelen #3SR00FRR Red Lens Red LED flasher shall be surface-mounted in the lower outboard corner of the interior door skin of each module entrance door. Lights shall flash when doors are open, and shall be tied to the "MODULE DISC" switch on the driver's console (Section 6.09 related).

7 SUPPORTING DOCUMENTATION

7.01 OWNERS MANUAL

Shall be provided with the vehicle and shall include the following items:

- Braun Northwest Contact Information
- Warranties
- Service and Operations Manual
- Electrical Drawings
- Parts list
- Specifications and Drawings
- Certifications
 - AMD 005 Low Voltage Electrical System Test
 - AMD 015 Ambulance Main Medical Gas System Test
 - AMD 021 Aspirator System Test
- Product Manuals
- Second OEM chassis key

7.03A LABELS

The following labels shall be provided in compliance with FMVSS and NFPA 1917.

NFPA 1917-2019 Section	Label Description	Location
	No Smoking/Oxygen Equipped	One each in cab and patient compt.
	Braun Northwest Paint Label	Inside of the electrical cabinet door
	FMVSS Certification Label	Adjacent to the chassis OEM stickers, typically on the B pillar (or inside of the electrical cabinet door if there is not room on the B pillar)
	Tire and Loading Information Label (for under 10k GVWR only)	
4.16.3	NFPA 1917 Certification and Payload (“Ambulance Data”) Label	
5.1.3	Overall Height and GVWR	Visible to the driver while seated
6.15.8	Cabinet Load Capacity	On each cabinet
6.21.3.4	Must be Seated and Belted	Visible from each seating position
6.28.10.3	Medical Gas Only	Medical gas storage compartment
6.28.12.2	Medical Gas Test Certification	Near the medical gas cylinder
7.12.3	Do Not Move Unit	Near the do not move unit (door open) light
8.2.2.5	Shorepower Cord End Rating	On the shipped-loose cord end
8.2.2.6	Shorepower Inlet Rating	Near the shorepower inlet
8.6.5.9.1	Line Voltage Receptacle Rating	At each receptacle

8 MISCELLANEOUS EQUIPMENT

8.01 LOOSE EQUIPMENT

The following equipment shall be shipped loose with the vehicle:

- Touch-up paint, one bottle each:
 - a. To match Oxford White (GLV-108340948)
 - b. White (G2-33631 Alt 2)
 - c. Gray (GLV-51748)
- Wheel simulator wrench
- Cord end for shoreline (20A)
- One 7 ft. hose
- Two mini-UHF style adapters
- Two sets of compartment keys, J236

8.02 CUSTOMER SUPPLIED EQUIPMENT

The customer shall provide the following equipment and have delivered to Braun Northwest within 30 days of the preconstruction meeting:

- Stryker Power-LOAD #6390 cot fastener system with safety hook

* * * * *

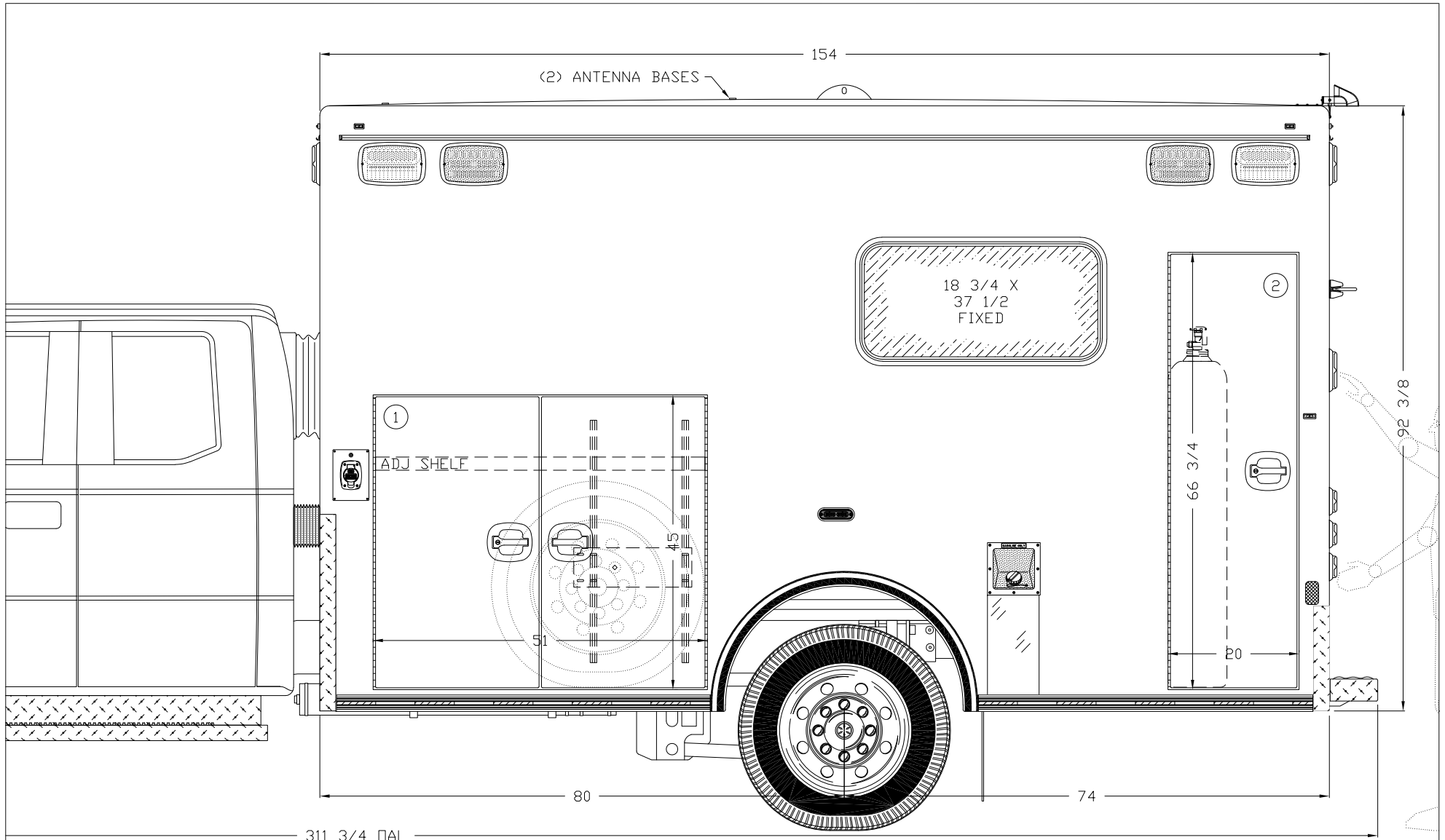

Braun Northwest, Inc.

Department	SALES		Rev
Dwg. Name	41291		AS
Client	SOUTH PARK AMBULANCE		BUILT
Date	04/10/2025	Drawing By	T.A.S.

TITLE: EXTERIOR S/S VIEW

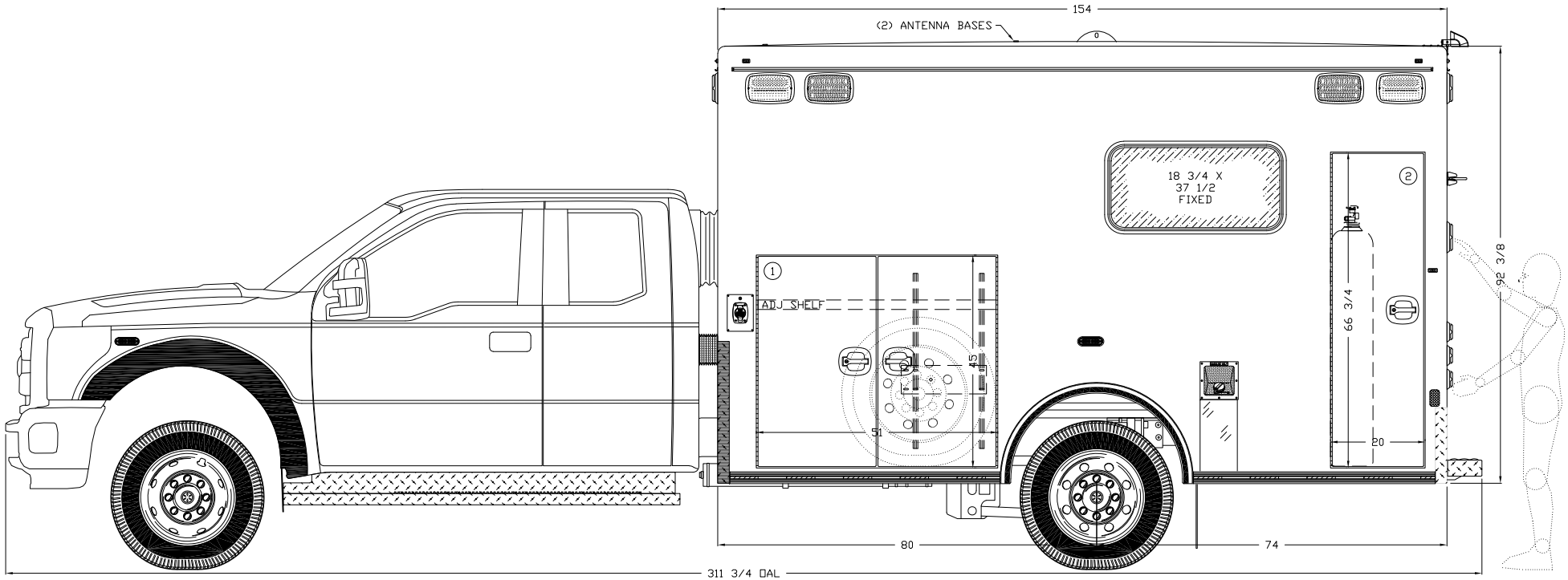

Braun Northwest, Inc.			
Department	SALES		Rev
Dwg. Name	41291		AS
Client	SOUTH PARK AMBULANCE		BUILT
Date	04/10/2025	Drawing By	T.A.S.

TITLE: EXTERIOR S/S VIEW

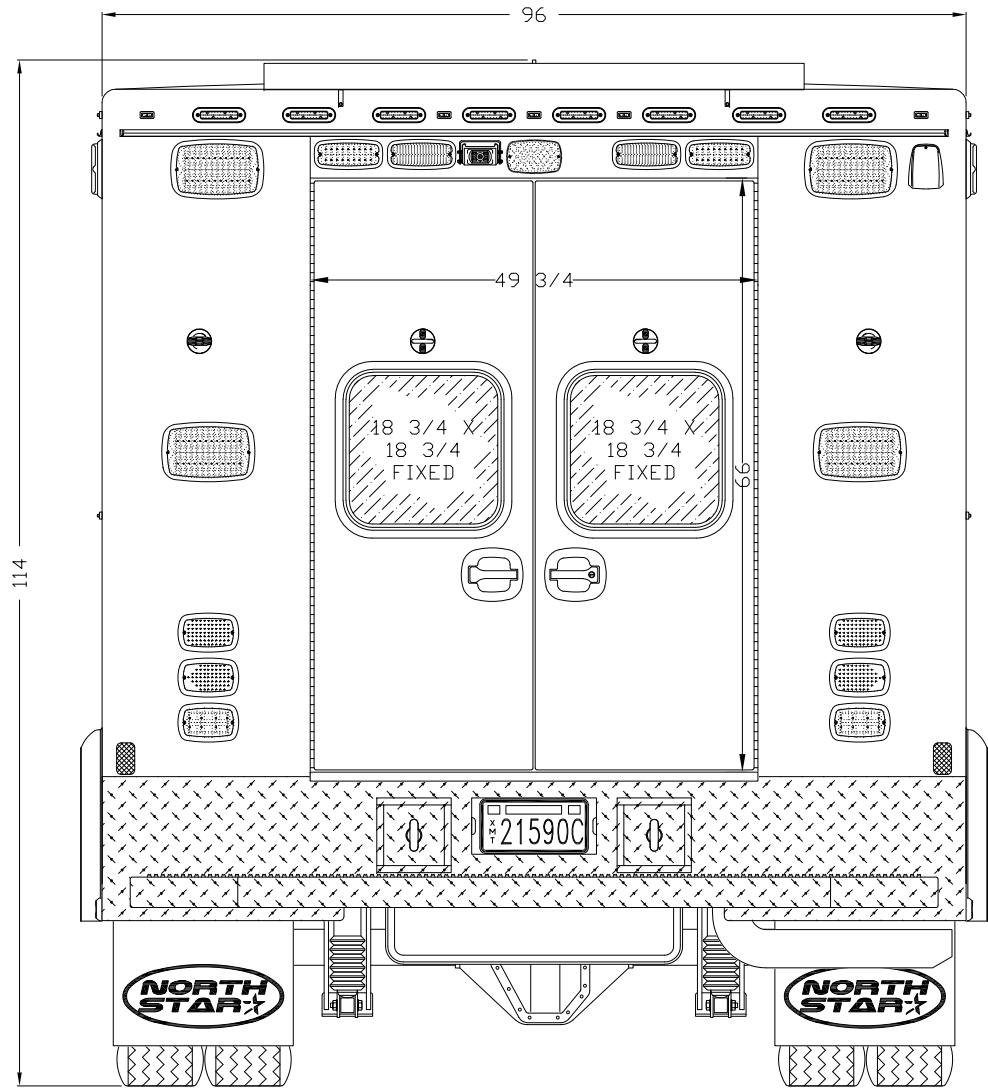

Braun Northwest, Inc.			
Department	SALES		Rev
Dwg. Name	41292		AS
Client	SOUTH PARK AMBULANCE		BUILT
Date	04/10/2025	Drawing By	T.A.S.

TITLE: EXTERIOR REAR VIEW

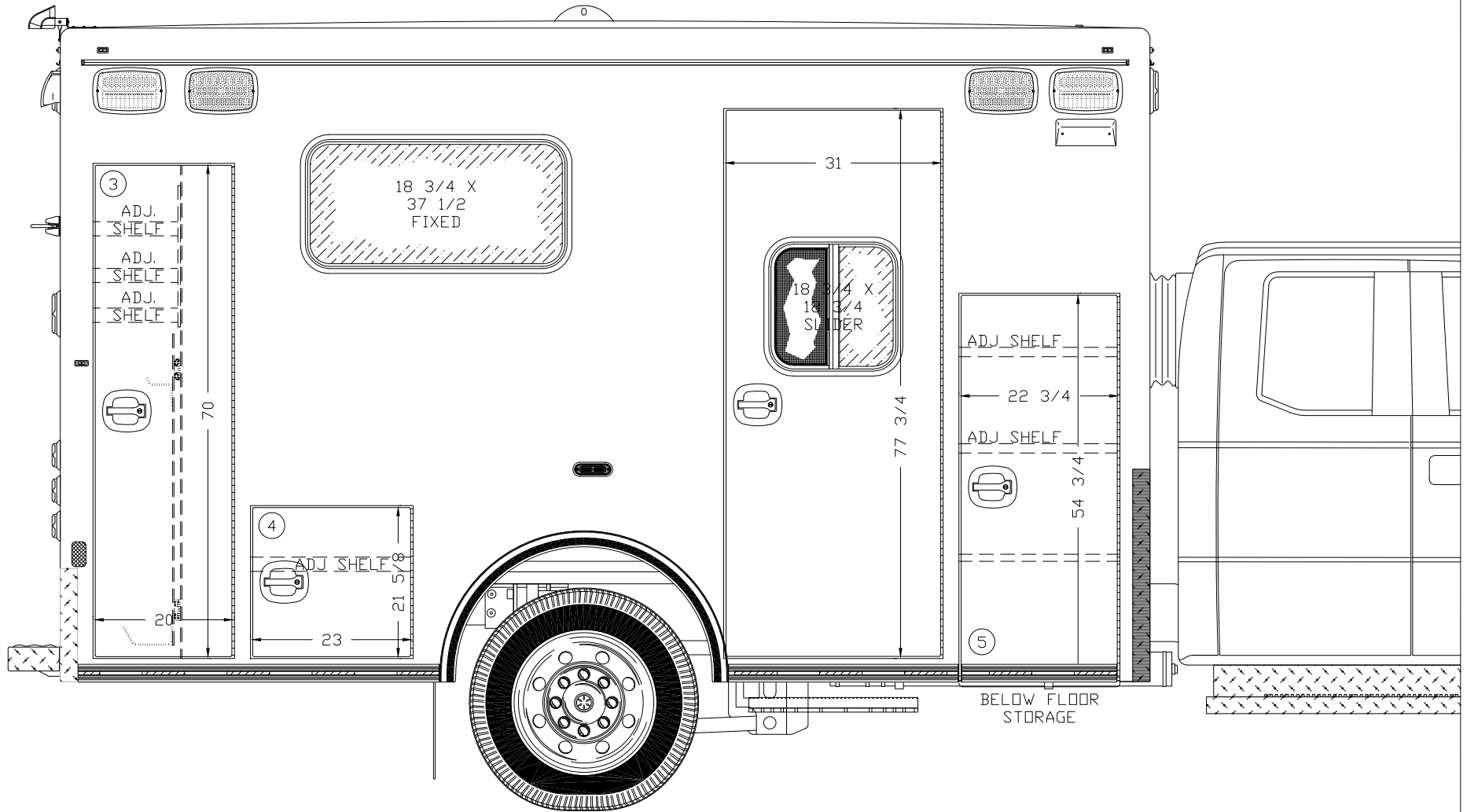

Braun Northwest, Inc.			
Department	SALES		Rev
Dwg. Name	41293		AS
Client	SOUTH PARK AMBULANCE		BUILT
Date	04/10/2025	Drawing By	T.A.S.

TITLE: EXTERIOR C/S VIEW

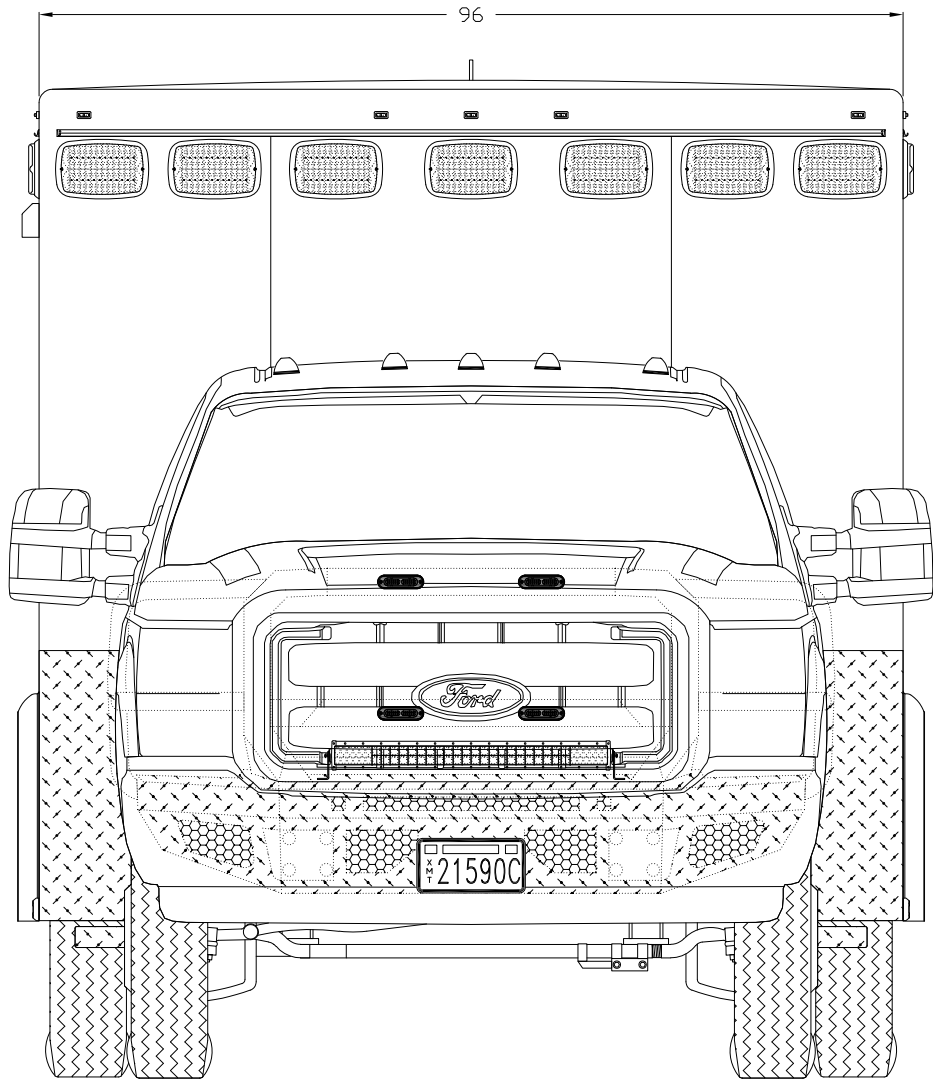

Braun Northwest, Inc.			
Department	SALES		Rev
Dwg. Name	41294		AS
Client	SOUTH PARK AMBULANCE		
Date	04/10/2025	Drawing By	T.A.S.

TITLE: EXTERIOR FRONT VIEW

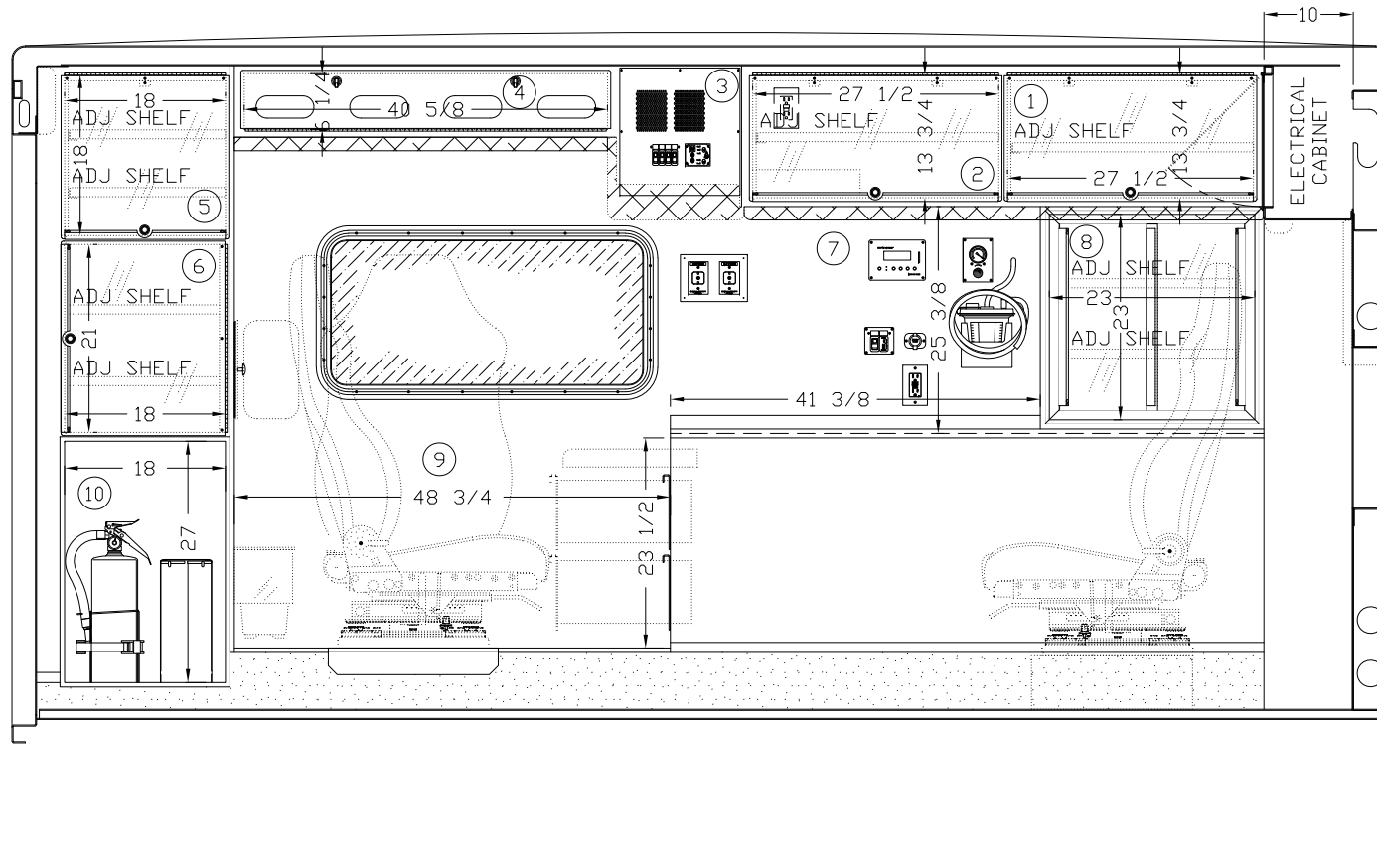

Braun Northwest, Inc.

Department	SALES		Rev
Dwg. Name	41295		AS
Client	SOUTH PARK AMBULANCE		BUILT
Date	04/10/2025	Drawing By	T.A.S.

TITLE: INTERIOR S/S VIEW

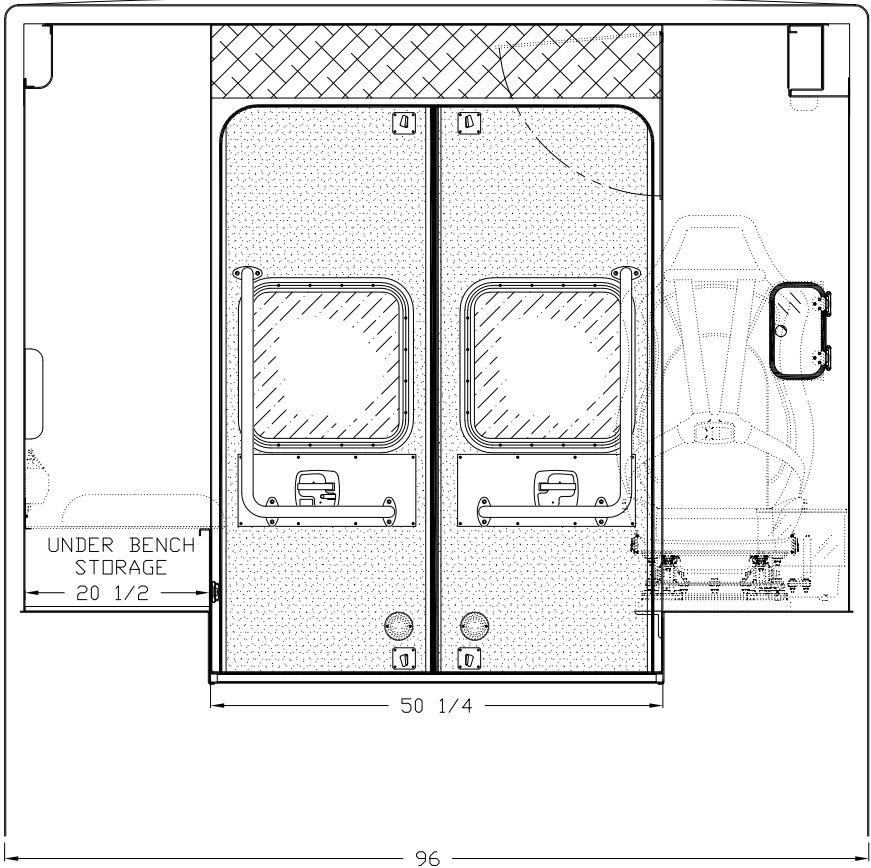

Braun Northwest, Inc.			
Department	SALES		Rev
Dwg. Name	41296		AS
Client	SOUTH PARK AMBULANCE		BUILT
Date	04/10/2025	Drawing By	T.A.S.

TITLE: INTERIOR REAR VIEW

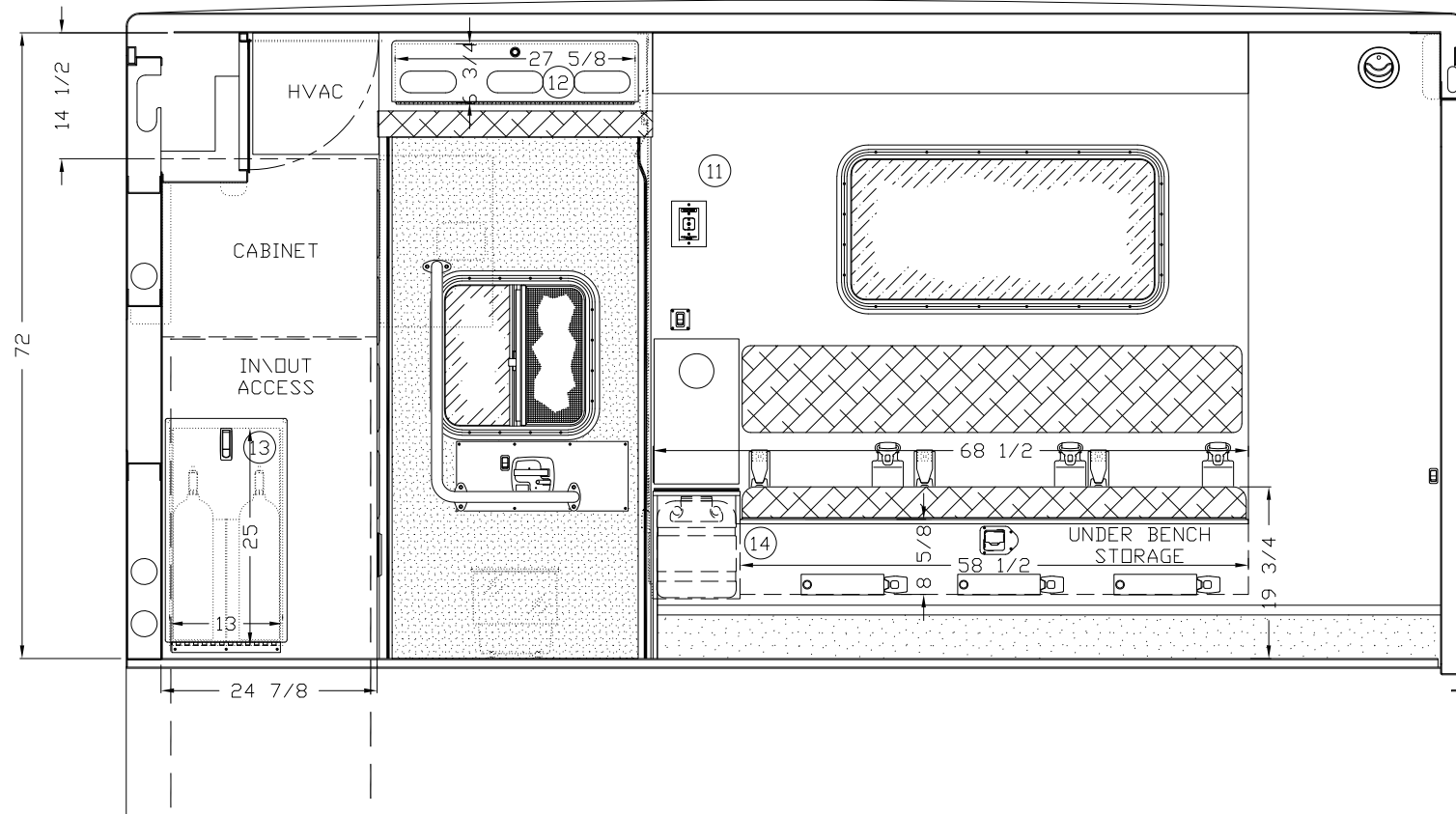

Braun Northwest, Inc.

Department	SALES	Rev
Dwg. Name	41297	AS
Client	SOUTH PARK AMBULANCE	BUILT
Date	04/10/2025	Drawing By
		T.A.S.

TITLE: INTERIOR C/S VIEW

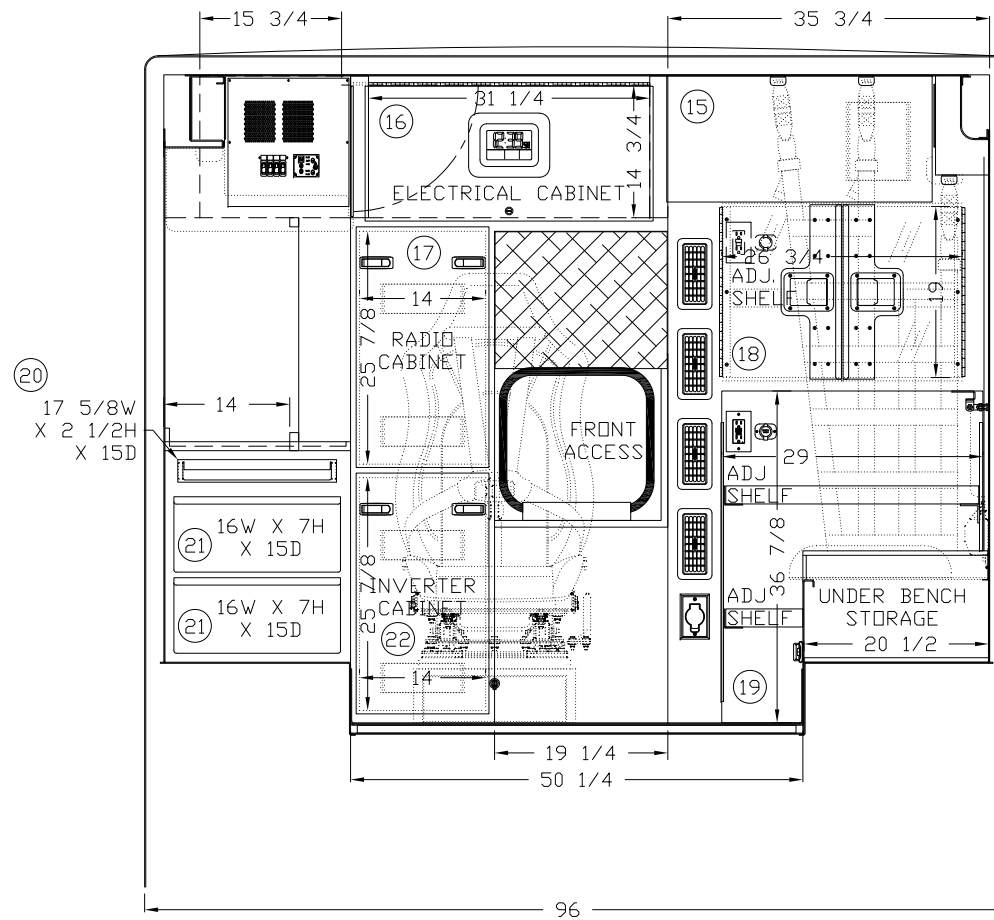

Braun Northwest, Inc.

Department	SALES		Rev
Dwg. Name	41298		AS
Client	SOUTH PARK AMBULANCE		BUILT
Date	04/10/2025	Drawing By	T.A.S.

TITLE: INTERIOR FRONT VIEW

Braun Northwest, Inc.			
Department	SALES		Rev AS BUILT
Dwg. Name	41299		
Client	SOUTH PARK AMBULANCE		
Date	04/10/2025	Drawing By	T.A.S.

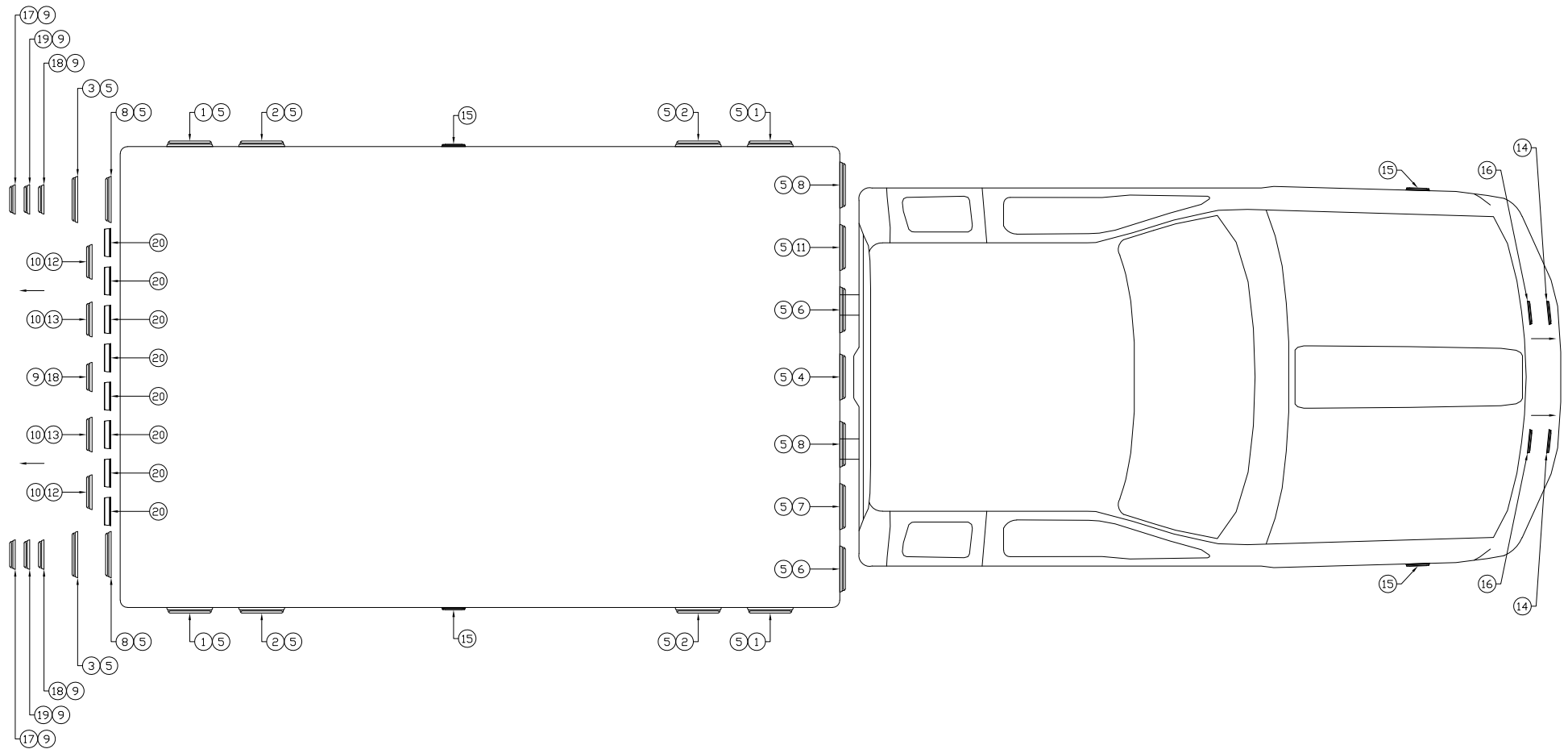

20	WHELEN #WIDNA CLR LENS AMB LED	7	10	WHELEN #M7FC CHROME FLANGE	7
19	WHELEN #M62T AMB LENS TURN	7	9	WHELEN #M6FC CHROME FLANGE	7
18	WHELEN #M6BTT CLR LENS BRAKE/TURN/TAIL	7	8	WHELEN #M9RC CLR LENS RED LED	4
17	WHELEN #M62BU CLR LENS WHT BACK UP LED	7	7	WHELEN #M9DE CLR LENS CLR/BLEUE DUD LED	1
16	WHELEN #TLI2D CLR LENS RED/WHT DUD LED	2	6	WHELEN #M9BC CLR LENS BLUE LED	4
15	WHELEN #TLI2J RED/BLEUE DUD LED	4	5	WHELEN #M9FC CHROME FLANGE	17
14	WHELEN #TLI2E CLR LENS BLUE/WHT DUD LED	1	4	WHELEN #M9C CLR LENS WHT LED	1
13	WHELEN #M7ZC LED SCENELIGHT	2	3	WHELEN #M9AC CLR LENS AMB LED	2
12	WHELEN #M7BC CLR LENS BLUE LED	2	2	WHELEN #M9LZC LED SCENELIGHT	4
11	WHELEN #M9DD CLR LENS CLR/RED DUD LED	1	1	WHELEN #M9DJ CLR LENS RED/BLEUE DUD LED	4
TAG	DESCRIPTION	QTY	TAG	DESCRIPTION	QTY

Braun Northwest, Inc.

Department	SALES		Rev
Dwg. Name	4129LTS		AS
Client	SOUTH PARK AMBULANCE		BUILT
Date	04/10/2025	Drawing By	T.A.S.

TITLE: EMERGENCY LIGHT LAYOUT

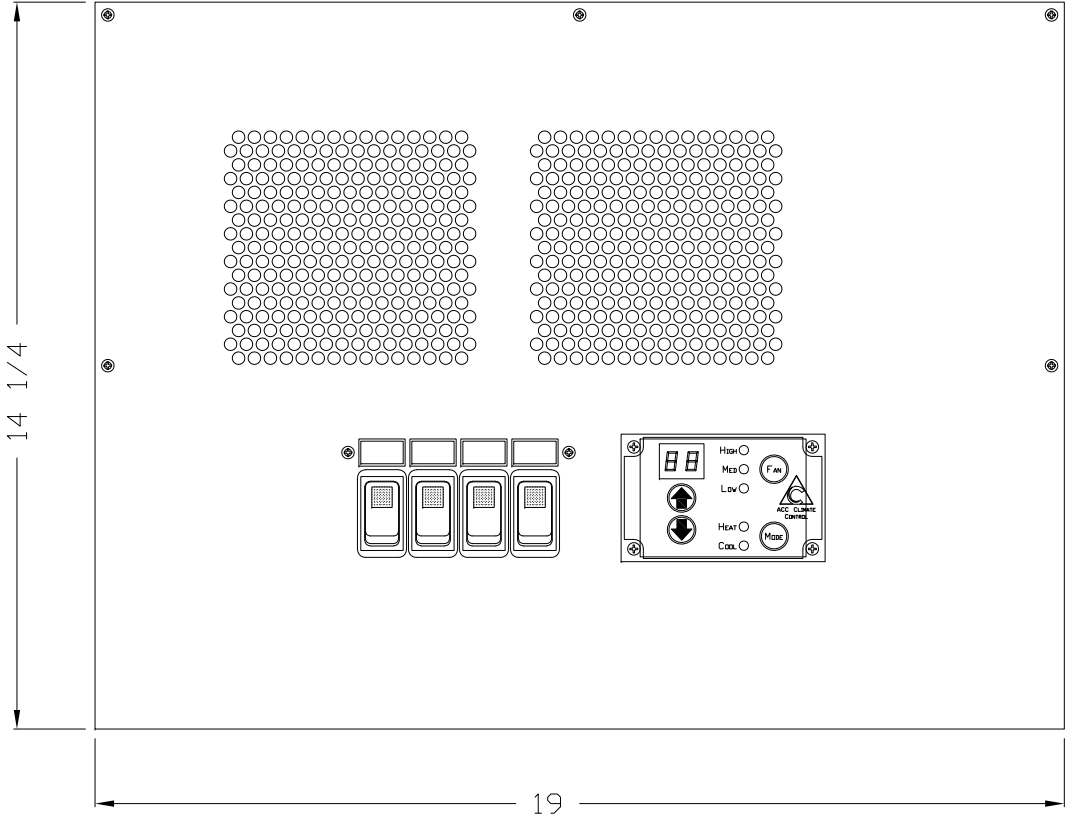

Braun Northwest, Inc.			
Department	FABRICATION		Rev AS BUILT
Dwg. Name	4129_SWITCH_PLATES		
Client	SOUTH PARK AMBULANCE		
Date	04/10/2025	Drawing By	T.A.S.

TITLE: S/S ATTENDANT SWITCH PLATE

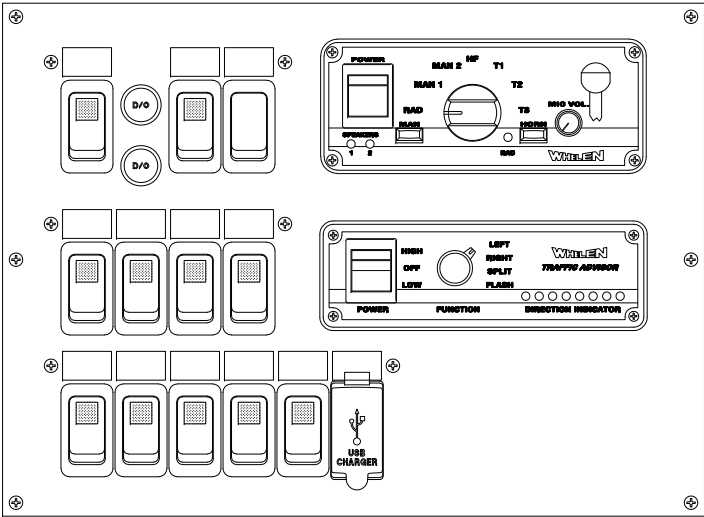

Braun Northwest, Inc.			
Department	FABRICATION		Rev
Dwg. Name	4129_SWITCH_PLATES		AS
Client	SOUTH PARK AMBULANCE		BUILT
Date	04/10/2025	Drawing By	T.A.S.

TITLE: DRIVERS CONSOLE SWITCH PLATE

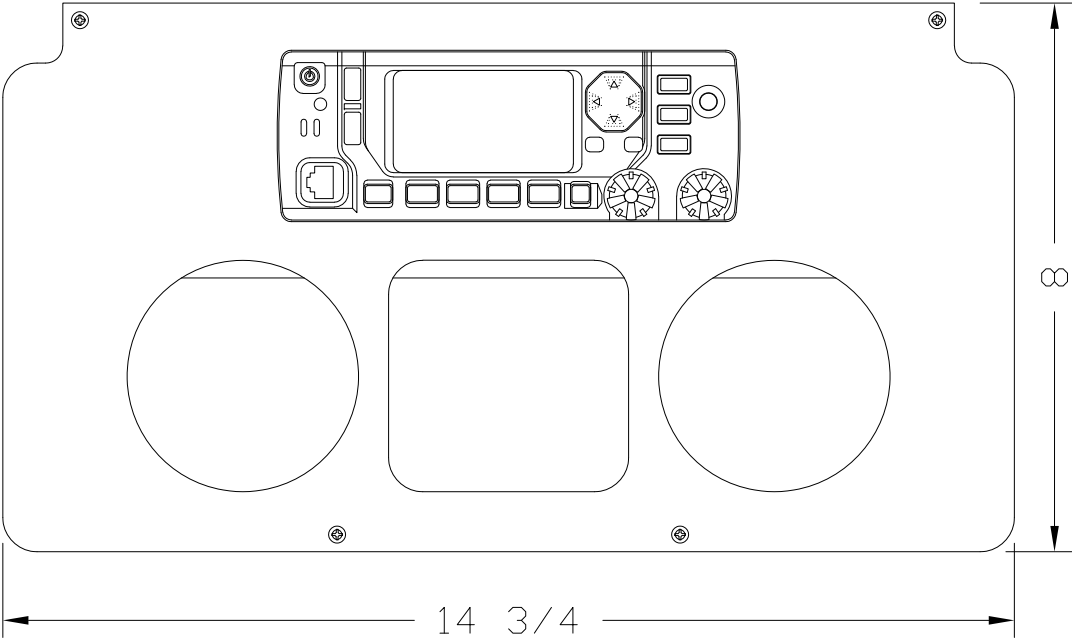

Braun Northwest, Inc.			
Department	FABRICATION		Rev
Dwg. Name	4129_SWITCH_PLATES		AS
Client	SOUTH PARK AMBULANCE		BUILT
Date	04/10/2025	Drawing By	T.A.S.

TITLE: DRIVERS CONSOLE CUP HOLDER

Quote Date: 8/19/2025

South Park Ambulance District-Station 1
911 Castello Avenue
Fairplay, CO 80440

Emergency Medical Services

SPAD1.4T1.081925.TE

Attention: Michael Wilson
(303) 944-5124
mwilson@southparkambulance.com

Qty	PART #	DESCRIPTION	UNIT LIST PRICE	QUOTED PRICE	EXTENDED DISCOUNT	EXTENDED PRICE
4	11001R	HAMILTON-T1 EMS Package	\$21,925.68	\$16,500.00	\$21,702.72	\$66,000.00
1	59600	Clinical Training	\$2,163.20			Included
4	161066	HAMILTON-T1 NIV, NIV S/T Application	\$2,143.22			Included
4	10102137	HAMILTON-T1 Universal Mount Handle	\$0.00			Included
4	355198	HAMILTON-C3/C2/C1/T1 POWER CORD	\$26.65			Included
4	160470	DISS CONNECTOR O2 - PLATFORM C	\$107.72			Included
4	10105900	HAMILTON-T1 O2 Cell- Initial Order	\$141.94			Included
4	10102336	HAMILTON-T1 English (USA) Language Kit	\$0.00			Included
4	10102150	HAMILTON-T1 Li-Ion Batteries (Qty 2)- Initial Order	\$617.97			Included
4	10102127	HAMILTON-T1 USA Customization	\$0.00			Included
4	10102122	HAMILTON-T1 Adult/Pediatric Configuration	\$0.00			Included
Sub Total						\$66,000.00
Additional Items						
4	10161088	Premium EMS HAMILTON-T1 Onsite One Year All-inclusive Service Contract	\$1,750.00	\$1,400.00		\$5,600.00
Sub Total						\$5,600.00
Trade-in						\$0.00
Sub Total						\$71,600.00
					Sales Tax	0.000% \$0.00
					Shipping Charges	\$0.00
					Quantity Discount	\$0.00
Quote Total						\$71,600.00
Finance Option			No. of Periods (Months)	60	Monthly Payment	\$1,468.98

Comments: Tier 1.

Hamilton Medical Inc. Emergency Medical Services Terms and Conditions of Sale

1. Prices

Prices are in US Dollars.

2. Payment terms

NET 30 days after invoice date. Payment terms are not extended while waiting for the issuance of a credit.

3. Freight terms

FOB Origin Pre-paid and added

4. Warranty

Two year parts & One year labor on new equipment. Ninety (90) day warranty on any upgrade parts. Extended warranties are available. The CO2 Capnostat 5 sensor and Aerogen cable have a One year manufacturer's warranty. All turbines installed in Hamilton-C1/T1/MR1/C6/C3 ventilators shipped from Hamilton Medical AG on or after July 1st, 2014 are warrantied for five (5) years against defects in design, material and workmanship under normal use for which it is intended. During the warranty period, Hamilton Medical will repair or replace, at its discretion, defective components or assemblies.

5. Validity:

The prices quoted are valid through November 30th, 2025.

6. Technical Support

Twenty four-hour/seven days per week / three hundred sixty five days per year telephone technical support is provided at no charge for the life of the Hamilton Medical, Inc. equipment.

7. Special Conditions

Hamilton Medical, Inc. does not supply; the cables, hardware, software or middle ware needed to integrate Hamilton Medical equipment with any facilities current Hospital Information or Electronic Medical Record systems.

8. Trade-In Equipment

Quotations that include trade-in equipment; Hamilton Medical may offer a trade-in credit, per competitive ventilator, on a one-to-one basis. To receive the trade-in credit, the serial numbers for all trade-in devices must be included with the purchase order. A mutual agreement for the arrangement of the disposal/transfer of the

64

South Park Ambulance District

Check Detail

August 2025

65

	Type	Num	Date	Name	Account	Paid Amount
	Bill Pmt -Check	Bill.com	08/01/2025	Zachary Roche	1-1072 · Bill.com Money Out Clearing	
	Bill	250140	02/13/2025		1-5291 · Meal Reimbursement	17.01
TOTAL						17.01
	Bill Pmt -Check	Bill.com	08/01/2025	Zachary Roche	1-1072 · Bill.com Money Out Clearing	
	Bill	Jan-25	01/14/2025		1-5291 · Meal Reimbursement	17.46
TOTAL						17.46
	Bill Pmt -Check	ACH	08/04/2025	Public Sector Healthcare Group	1-1100 · Checking (8101)	
	Bill	202508	07/10/2025		1-5130 · Health Insurance	35,388.95
TOTAL						35,388.95
	Bill Pmt -Check	ACH	08/06/2025	Dish Network	1-1100 · Checking (8101)	
	Bill	0130 08.25	07/19/2025		1-5320 · Utilities	80.10
TOTAL						80.10
	Bill Pmt -Check	ACH	08/06/2025	Dish Network	1-1100 · Checking (8101)	
	Bill	5288 08.25	07/19/2025		1-5320 · Utilities	80.10
TOTAL						80.10
	Bill Pmt -Check	ACH	08/11/2025	CenturyLink	1-1100 · Checking (8101)	
	Bill	334125739 07.25	07/19/2025		1-5320 · Utilities	164.86
TOTAL						164.86
	Bill Pmt -Check	ACH	08/11/2025	CenturyLink	1-1100 · Checking (8101)	
	Bill	334094461 07.25	07/19/2025		1-5320 · Utilities	390.25
TOTAL						390.25
	Bill Pmt -Check	ACH	08/11/2025	CORE Electric Cooperative	1-1100 · Checking (8101)	
	Bill	96628959 07.25	07/21/2025		1-5320 · Utilities	213.05
TOTAL						213.05
	Bill Pmt -Check	Bill.com	08/12/2025	Pinnacol Assurance	1-1072 · Bill.com Money Out Clearing	
	Bill	22104559	07/01/2025		1-5340 · Workmans Compensation	4,104.00
TOTAL						4,104.00

South Park Ambulance District
Check Detail
August 2025

66

	Type	Num	Date	Name	Account	Paid Amount
	Bill Pmt -Check	ACH	08/14/2025	Dish Network	1-1100 · Checking (8101)	
	Bill	3509 08.25	07/27/2025		1-5320 · Utilities	152.10
TOTAL						152.10
	Bill Pmt -Check	ACH	08/22/2025	Colorado Natural Gas, Inc.	1-1100 · Checking (8101)	
	Bill	2039524 07.25	07/31/2025		1-5320 · Utilities	237.80
TOTAL						237.80
	Bill Pmt -Check	ACH	08/26/2025	CORE Electric Cooperative	1-1100 · Checking (8101)	
	Bill	95657456 07.25	07/31/2025		1-5320 · Utilities	282.69
TOTAL						282.69
	Bill Pmt -Check	Bill.com	08/28/2025	South Park Ace Hardware & Lumber	1-1072 · Bill.com Money Out Clearing	
	Bill	22607/1	07/13/2025		1-5013 · Bldg. Supplies	17.99
TOTAL						17.99
	Bill Pmt -Check	Bill.com	08/28/2025	South Park Ace Hardware & Lumber	1-1072 · Bill.com Money Out Clearing	
	Bill	22804/1	07/25/2025		1-5013 · Bldg. Supplies	49.99
TOTAL						49.99
	Bill Pmt -Check	Bill.com	08/28/2025	Kevin Borns	1-1072 · Bill.com Money Out Clearing	
	Bill	HRA 07.25	07/31/2025		1-5131 · HRA Reimbursment	1,000.00
TOTAL						1,000.00
	Bill Pmt -Check	Bill.com	08/28/2025	South Park Ace Hardware & Lumber	1-1072 · Bill.com Money Out Clearing	
	Bill	22699/1	07/17/2025		1-5013 · Bldg. Supplies	59.99
TOTAL						59.99
	Bill Pmt -Check	Bill.com	08/28/2025	Wex Bank	1-1072 · Bill.com Money Out Clearing	
	Bill	106372950	07/31/2025		1-5332 · Gas/Oil/Diesel	4,177.04
TOTAL						4,177.04
	Bill Pmt -Check	Bill.com	08/28/2025	Mountain View Waste Systems	1-1072 · Bill.com Money Out Clearing	
	Bill	8678236V325	07/31/2025		1-5320 · Utilities	2.34
TOTAL						2.34

South Park Ambulance District
Check Detail
August 2025

67

	Type	Num	Date	Name	Account	Paid Amount
	Bill Pmt -Check	Bill.com	08/28/2025	SPT C/O Highline Services	1-1072 · Bill.com Money Out Clearing	
	Bill	10896698	07/31/2025		1-5320 · Utilities	191.75
TOTAL						191.75
	Bill Pmt -Check	Bill.com	08/28/2025	Alpinaire Healthcare	1-1072 · Bill.com Money Out Clearing	
	Bill	612373	07/29/2025		1-5003 · Supplies EMS	190.00
TOTAL						190.00
	Bill Pmt -Check	Bill.com	08/28/2025	Alpinaire Healthcare	1-1072 · Bill.com Money Out Clearing	
	Bill	609568	06/27/2025		1-5003 · Supplies EMS	20.00
TOTAL						20.00
	Bill Pmt -Check	Bill.com	08/28/2025	Alisha Wiltse	1-1072 · Bill.com Money Out Clearing	
	Bill	July-25	07/13/2025		1-5292 · Travel and Meals	22.99
TOTAL						22.99
	Bill Pmt -Check	Bill.com	08/28/2025	Captivate Billing, LLC	1-1072 · Bill.com Money Out Clearing	
	Bill	SP-2025-07	07/31/2025		1-5210 · Billing Fee	2,328.22
TOTAL						2,328.22
	Bill Pmt -Check	Bill.com	08/28/2025	Cummins Sales & Service	1-1072 · Bill.com Money Out Clearing	
	Bill	42-250748545	07/24/2025		1-5012 · Building Exp.	763.50
TOTAL						763.50
	Bill Pmt -Check	Bill.com	08/28/2025	Teleflex LLC	1-1072 · Bill.com Money Out Clearing	
	Bill	9510285852	07/17/2025		1-5003 · Supplies EMS	600.00
TOTAL						600.00
	Bill Pmt -Check	Bill.com	08/28/2025	Alpinaire Healthcare	1-1072 · Bill.com Money Out Clearing	
	Bill	612224	07/31/2025		1-5003 · Supplies EMS	8.00
TOTAL						8.00
	Bill Pmt -Check	Bill.com	08/28/2025	Alpinaire Healthcare	1-1072 · Bill.com Money Out Clearing	
	Bill	612467	07/29/2025		1-5003 · Supplies EMS	325.76
TOTAL						325.76

South Park Ambulance District

Check Detail

August 2025

68

	Type	Num	Date	Name	Account	Paid Amount
	Bill Pmt -Check	Bill.com	08/28/2025	Jason Trojan	1-1072 · Bill.com Money Out Clearing	
	Bill	July-25	07/27/2025		1-5291 · Meal Reimbursement	16.06
TOTAL						16.06
	Bill Pmt -Check	Bill.com	08/28/2025	Cummins Sales & Service	1-1072 · Bill.com Money Out Clearing	
	Bill	42-250748538	07/24/2025		1-5012 · Building Exp.	823.00
TOTAL						823.00
	Bill Pmt -Check	Bill.com	08/28/2025	Michael Wilson	1-1072 · Bill.com Money Out Clearing	
	Bill	Jul-25	07/21/2025		1-5291 · Meal Reimbursement	135.57
TOTAL						135.57
	Bill Pmt -Check	Bill.com	08/28/2025	Teleflex LLC	1-1072 · Bill.com Money Out Clearing	
	Bill	9510333519	07/29/2025		1-5003 · Supplies EMS	550.00
TOTAL						550.00
	Bill Pmt -Check	Bill.com	08/28/2025	Common Knowledge Technology LLC	1-1072 · Bill.com Money Out Clearing	
	Bill	67202	07/31/2025		1-5225 · IT Services	1,044.00
TOTAL						1,044.00
	Bill Pmt -Check	Bill.com	08/28/2025	SPT C/O Highline Services	1-1072 · Bill.com Money Out Clearing	
	Bill	10894243	07/31/2025		1-5320 · Utilities	104.95
TOTAL						104.95
	Bill Pmt -Check	Bill.com	08/28/2025	ESO Solutions	1-1072 · Bill.com Money Out Clearing	
	Bill	ESO-175005	07/31/2025		1-5213 · Trip Report System	1,744.66
TOTAL						1,744.66
	Bill Pmt -Check	Bill.com	08/28/2025	Alpinaire Healthcare	1-1072 · Bill.com Money Out Clearing	
	Bill	610014	07/28/2025		1-5003 · Supplies EMS	8.00
TOTAL						8.00
	Bill Pmt -Check	Bill.com	08/28/2025	Pinnacle Consulting Group, Inc.	1-1072 · Bill.com Money Out Clearing	
	Bill	28418	07/31/2025		1-5216 · Pinnacle Management	3,448.75
					1-5220 · Accounting	4,107.50
					1-51120 · Office & Other	0.74
TOTAL						7,556.99

South Park Ambulance District
Check Detail
August 2025

69

	Type	Num	Date	Name	Account	Paid Amount
	Bill Pmt -Check	Bill.com	08/28/2025	Mountain View Waste Systems	1-1072 · Bill.com Money Out Clearing	
	Bill	8680618V325	07/31/2025		1-5320 · Utilities	144.72
TOTAL						144.72
	Bill Pmt -Check	Bill.com	08/28/2025	Mountain View Waste Systems	1-1072 · Bill.com Money Out Clearing	
	Bill	8681260V325	07/31/2025		1-5320 · Utilities	124.04
TOTAL						124.04
	Bill Pmt -Check	Bill.com	08/28/2025	Verizon Wireless	1-1072 · Bill.com Money Out Clearing	
	Bill	6118491734	07/13/2025		1-5110 · Communications	442.30
TOTAL						442.30
	Bill Pmt -Check	Bill.com	08/28/2025	Jamie Morgan	1-1072 · Bill.com Money Out Clearing	
	Bill	Jul-25	07/18/2025		1-5291 · Meal Reimbursement	20.00
TOTAL						20.00
	Bill Pmt -Check	Bill.com	08/28/2025	Ian Jolley	1-1072 · Bill.com Money Out Clearing	
	Bill	July-25	07/27/2025		1-5291 · Meal Reimbursement	38.36
TOTAL						38.36
	Bill Pmt -Check	Bill.com	08/28/2025	Mark Mahan	1-1072 · Bill.com Money Out Clearing	
	Bill	July-25	07/13/2025		1-5291 · Meal Reimbursement	102.23
TOTAL						102.23
	Bill Pmt -Check	Bill.com	08/28/2025	Zachary Roche	1-1072 · Bill.com Money Out Clearing	
	Bill	Jul-25	07/19/2025		1-5291 · Meal Reimbursement	34.99
TOTAL						34.99
	Bill Pmt -Check	Bill.com	08/28/2025	Bound Tree Medical LLC	1-1072 · Bill.com Money Out Clearing	
	Bill	85866005	07/31/2025		1-5003 · Supplies EMS	681.45
TOTAL						681.45
	Bill Pmt -Check	Bill.com	08/28/2025	Bailey Propane Company, Inc.	1-1072 · Bill.com Money Out Clearing	
	Bill	3977 07.25	07/31/2025		1-5320 · Utilities	182.00
TOTAL						182.00

South Park Ambulance District
Check Detail
August 2025

70

	Type	Num	Date	Name	Account	Paid Amount
	Bill Pmt -Check	Bill.com	08/28/2025	Park County Government	1-1072 · Bill.com Money Out Clearing	
	Bill	2508	07/31/2025		1-5320 · Utilities	105.00
TOTAL						105.00
	Bill Pmt -Check	Bill.com	08/28/2025	Pinnacol Assurance	1-1072 · Bill.com Money Out Clearing	
	Bill	22127358	07/31/2025		1-5340 · Workmans Compensation	5,498.00
TOTAL						5,498.00
	Bill Pmt -Check	Bill.com	08/28/2025	Verizon Connect	1-1072 · Bill.com Money Out Clearing	
	Bill	615000075725	07/31/2025		1-5110 · Communications	377.10
TOTAL						377.10
	Bill Pmt -Check	Bill.com	08/28/2025	Wendy West	1-1072 · Bill.com Money Out Clearing	
	Bill	Jul-25	07/12/2025		1-5291 · Meal Reimbursement	28.38
TOTAL						28.38
	Bill Pmt -Check	Bill.com	08/28/2025	WildRock Public Relations & Marketing	1-1072 · Bill.com Money Out Clearing	
	Bill	3800	07/31/2025		1-5110 · Communications	3,000.00
TOTAL						3,000.00
	Bill Pmt -Check	Bill.com	08/28/2025	Town of Fairplay	1-1072 · Bill.com Money Out Clearing	
	Bill	412.00 07.25	07/31/2025		1-5320 · Utilities	923.80
TOTAL						923.80
	Bill Pmt -Check	Bill.com	08/28/2025	Centura Health - St. Anthony Summit	1-1072 · Bill.com Money Out Clearing	
	Bill	6848	07/24/2025		1-5003 · Supplies EMS	653.76
TOTAL						653.76
	Bill Pmt -Check	Bill.com	08/28/2025	The Salt Licking Goat Clothing Company	1-1072 · Bill.com Money Out Clearing	
	Bill	3757	07/16/2025		1-5310 · Uniforms	519.80
TOTAL						519.80
	Bill Pmt -Check	Bill.com	08/28/2025	Cummins Sales & Service	1-1072 · Bill.com Money Out Clearing	
	Bill	42-250748540	07/24/2025		1-5012 · Building Exp.	743.50
TOTAL						743.50

South Park Ambulance District
Check Detail
August 2025

71

	Type	Num	Date	Name	Account	Paid Amount
	Bill Pmt -Check	Bill.com	08/28/2025	Chaney Pest Elimination	1-1072 · Bill.com Money Out Clearing	
	Bill	34807	07/14/2025		1-5320 · Utilities	85.00
TOTAL						85.00
	Bill Pmt -Check	Bill.com	08/28/2025	Utopia Fairplay, Inc.	1-1072 · Bill.com Money Out Clearing	
	Bill	87070	07/31/2025		1-5333 · Repairs and Maintenance	279.38
TOTAL						279.38
	Bill Pmt -Check	Bill.com	08/28/2025	Sam Martin	1-1072 · Bill.com Money Out Clearing	
	Bill	July-25	07/24/2025		1-5291 · Meal Reimbursement	71.77
TOTAL						71.77
	Bill Pmt -Check	Bill.com	08/28/2025	VFIS c/o M&T Bank	1-1072 · Bill.com Money Out Clearing	
	Bill	356002132	07/31/2025		1-5140 · Insurance	57,660.00
TOTAL						57,660.00
	Bill Pmt -Check	Bill.com	08/28/2025	Bound Tree Medical LLC	1-1072 · Bill.com Money Out Clearing	
	Bill	85860748	07/29/2025		1-5003 · Supplies EMS	2,891.67
TOTAL						2,891.67
	Bill Pmt -Check	Bill.com	08/28/2025	South Park Ace Hardware & Lumber	1-1072 · Bill.com Money Out Clearing	
	Bill	22733/1	07/21/2025		1-5013 · Bldg. Supplies	38.97
TOTAL						38.97
	Bill Pmt -Check	Bill.com	08/28/2025	South Park Ace Hardware & Lumber	1-1072 · Bill.com Money Out Clearing	
	Bill	22605/1	07/13/2025		1-5013 · Bldg. Supplies	19.18
TOTAL						19.18
	Bill Pmt -Check	Bill.com	08/28/2025	Kathleen Hind	1-1072 · Bill.com Money Out Clearing	
	Bill	July-25	07/23/2025		1-5291 · Meal Reimbursement	26.54
TOTAL						26.54
	Bill Pmt -Check	Bill.com	08/28/2025	Chaney Pest Elimination	1-1072 · Bill.com Money Out Clearing	
	Bill	34794	07/14/2025		1-5320 · Utilities	85.00
TOTAL						85.00

South Park Ambulance District
Check Detail
August 2025

72

	Type	Num	Date	Name	Account	Paid Amount
	Bill Pmt -Check	Bill.com	08/28/2025	Bound Tree Medical LLC	1-1072 · Bill.com Money Out Clearing	
	Bill	85842674	07/14/2025		1-5003 · Supplies EMS	154.42
TOTAL						154.42
	Bill Pmt -Check	ACH	08/31/2025	Chase CC	1-1100 · Checking (8101)	
	Bill	3270 07.25	07/31/2025		1-5292 · Travel and Meals	50.31
					1-5292 · Travel and Meals	50.40
					1-5292 · Travel and Meals	38.78
					1-5292 · Travel and Meals	259.80
					1-5292 · Travel and Meals	8.75
					1-5292 · Travel and Meals	140.00
					1-5292 · Travel and Meals	1,713.12
					1-5292 · Travel and Meals	15.57
					1-5292 · Travel and Meals	40.66
					1-5013 · Bldg. Supplies	272.56
					1-5002 · Equipment EMS	119.92
					1-5003 · Supplies EMS	102.63
					1-5310 · Uniforms	7.95
					1-5012 · Building Exp.	3,013.33
					1-8803 · Building	1,308.27
					1-5020 · Public Education	97.05
					1-5150 · Miscellaneous	150.98
TOTAL						7,390.08
					Total	145,190.61

South Park Ambulance District
Profit & Loss Budget vs. Actual
January through July 2025

73

	Jan - Jul 25	Budget	\$ Over Budget	% of Budget
Ordinary Income/Expense				
Income				
Other Income				
1-4400 · Donation	2,750.00	25,000.00	-22,250.00	11.0%
1-4500 · Misc.	3.92	0.00	3.92	100.0%
1-4600 · GEMT Medicaid Supplemental	35,098.70	400,000.00	-364,901.30	8.78%
1-4800 · Impact Asst. Grant	11,813.47	0.00	11,813.47	100.0%
Other Income - Other	0.00	7,000.00	-7,000.00	0.0%
Total Other Income	49,666.09	432,000.00	-382,333.91	11.5%
1-4000 · Ambulance Fees	709,075.40	1,110,000.00	-400,924.60	63.88%
1-4100 · Property Tax Revenue	4,850,469.19	5,116,959.00	-266,489.81	94.79%
1-4110 · SO Taxes	276,565.89	409,357.00	-132,791.11	67.56%
1-4200 · Interest Income	220,708.30	200,000.00	20,708.30	110.35%
Total Income	6,106,484.87	7,268,316.00	-1,161,831.13	84.02%
Expense				
Salaries				
1-5250 · Administrative	191,827.06	350,000.00	-158,172.94	54.81%
1-5260 · EMS	606,989.90	1,825,000.00	-1,218,010.10	33.26%
1-5270 · Overtime	337,880.41	0.00	337,880.41	100.0%
1-5271 · Regular Overtime	0.00	505,000.00	-505,000.00	0.0%
Total Salaries	1,136,697.37	2,680,000.00	-1,543,302.63	42.41%
1-5000 · EMS Supplies & Equip				
1-5002 · Equipment EMS	34,465.19	0.00	34,465.19	100.0%
1-5003 · Supplies EMS	48,453.28	0.00	48,453.28	100.0%
1-5000 · EMS Supplies & Equip - Other	0.00	256,000.00	-256,000.00	0.0%
Total 1-5000 · EMS Supplies & Equip	82,918.47	256,000.00	-173,081.53	32.39%
1-5010 · Building Expense				
1-5011 · Bldg. pmt.	45,727.31	0.00	45,727.31	100.0%
1-5012 · Building Exp.	32,056.01	0.00	32,056.01	100.0%
1-5013 · Bldg. Supplies	9,073.95	0.00	9,073.95	100.0%
1-5010 · Building Expense - Other	0.00	50,000.00	-50,000.00	0.0%
Total 1-5010 · Building Expense	86,857.27	50,000.00	36,857.27	173.72%
1-5020 · Public Education	97.05	15,000.00	-14,902.95	0.65%
1-5030 · Payroll Taxes				
1-5031 · Unemployment	0.00	47,000.00	-47,000.00	0.0%
1-5032 · Employer FICA	87,829.60	120,000.00	-32,170.40	73.19%
Total 1-5030 · Payroll Taxes	87,829.60	167,000.00	-79,170.40	52.59%
1-5040 · Advertising	390.90	0.00	390.90	100.0%
1-5049 · Ambulance Adjustments				
1-5050 · Bad Debt/Collections	-3,431.24	675,000.00	-678,431.24	-0.51%
1-5055 · Patient W/O	59,676.21	0.00	59,676.21	100.0%
1-5056 · Auto INS W/O	0.00	0.00	0.00	0.0%
1-5060 · Commercial C/A	3,827.74	0.00	3,827.74	100.0%
1-5070 · Medicaid C/A	132,557.51	0.00	132,557.51	100.0%
1-5075 · Medicaid (MCO)	2,266.65	0.00	2,266.65	100.0%
1-5080 · Medicare C/A	98,560.83	0.00	98,560.83	100.0%
1-5085 · Medicare (HMO)	38,867.93	0.00	38,867.93	100.0%
1-5090 · Recovered W/O	-631.39	0.00	-631.39	100.0%
1-5049 · Ambulance Adjustments - Other	0.00	37,000.00	-37,000.00	0.0%
Total 1-5049 · Ambulance Adjustments	331,694.24	712,000.00	-380,305.76	46.59%
1-5100 · Bank Charges	270.00	0.00	270.00	100.0%
1-5110 · Communications	27,232.10	51,000.00	-23,767.90	53.4%
1-51120 · Office & Other	3,707.23	12,000.00	-8,292.77	30.89%
1-5120 · Dues and Subscriptions	6,057.50	4,000.00	2,057.50	151.44%
1-5125 · Director Fees	4,000.00	0.00	4,000.00	100.0%

South Park Ambulance District
Profit & Loss Budget vs. Actual
January through July 2025

74

	Jan - Jul 25	Budget	\$ Over Budget	% of Budget
1-5130 · Health Insurance				
1-5131 · HRA Reimbursement	5,758.00	15,000.00	-9,242.00	38.39%
1-5130 · Health Insurance - Other	261,455.31	450,000.00	-188,544.69	58.1%
Total 1-5130 · Health Insurance	267,213.31	465,000.00	-197,786.69	57.47%
1-5140 · Insurance	57,398.00	120,000.00	-62,602.00	47.83%
1-5150 · Miscellaneous	1,438.43	10,000.00	-8,561.57	14.38%
1-5151 · Election Expense	1,175.50	60,000.00	-58,824.50	1.96%
1-5155 · Dispatch User Fee	0.00	70,000.00	-70,000.00	0.0%
1-5170 · Payroll Expenses	331.00	0.00	331.00	100.0%
1-5180 · Payroll Services	20,850.88	0.00	20,850.88	100.0%
1-5190 · Pension Contribution	54,202.23	125,000.00	-70,797.77	43.36%
1-5208 · Professional Services				
1-5209 · Background Checks	136.00	2,600.00	-2,464.00	5.23%
1-5210 · Billing Fee	16,810.03	30,000.00	-13,189.97	56.03%
1-5213 · Trip Report System	11,936.10	20,000.00	-8,063.90	59.68%
1-5216 · Pinnacle Management	19,452.50	46,035.00	-26,582.50	42.26%
1-5220 · Accounting	39,021.25	76,725.00	-37,703.75	50.86%
1-5221 · Audit	9,450.00	9,300.00	150.00	101.61%
1-5225 · IT Services	9,010.50	0.00	9,010.50	100.0%
1-5230 · Legal	2,830.35	30,000.00	-27,169.65	9.44%
1-5231 · Web Site Design & Maintenance	250.00	25,000.00	-24,750.00	1.0%
1-5232 · Waystar Merchant Fee	2,359.74	4,200.00	-1,840.26	56.18%
Total 1-5208 · Professional Services	111,256.47	243,860.00	-132,603.53	45.62%
1-5255 · Salaries Admin OT	11,400.27	25,000.00	-13,599.73	45.6%
1-5280 · Seminars and Training				
1-5282 · Training	27.75	0.00	27.75	100.0%
1-5280 · Seminars and Training - Other	3,059.64	15,000.00	-11,940.36	20.4%
Total 1-5280 · Seminars and Training	3,087.39	15,000.00	-11,912.61	20.58%
1-5290 · Travel and Meals				
1-5291 · Meal Reimbursement	3,920.57	6,000.00	-2,079.43	65.34%
1-5292 · Travel and Meals	6,705.46	5,000.00	1,705.46	134.11%
Total 1-5290 · Travel and Meals	10,626.03	11,000.00	-373.97	96.6%
1-5300 · Treasurer's Fees	144,846.92	102,339.00	42,507.92	141.54%
1-5310 · Uniforms	17,774.63	15,000.00	2,774.63	118.5%
1-5320 · Utilities	34,919.18	80,000.00	-45,080.82	43.65%
1-5330 · Vehicle Expense				
1-5331 · Equipment	0.00	5,000.00	-5,000.00	0.0%
1-5332 · Gas/Oil/Diesel	23,137.31	50,000.00	-26,862.69	46.28%
1-5333 · Repairs and Maintenance	9,901.60	30,000.00	-20,098.40	33.01%
1-5334 · Supplies	295.16	2,000.00	-1,704.84	14.76%
Total 1-5330 · Vehicle Expense	33,334.07	87,000.00	-53,665.93	38.32%
1-5340 · Workmans Compensation	26,496.96	0.00	26,496.96	100.0%
1-5800 · EMS Grant	0.00	50,000.00	-50,000.00	0.0%
1-8800 · Capital Expense			0.00	0.0%
1-8803 · Building	1,308.27	455,748.00	-454,439.73	0.29%
1-8804 · Equipment	285,461.42	0.00	285,461.42	100.0%
Total 1-8800 · Capital Expense	286,769.69	455,748.00	-168,978.31	62.92%
1-8820 · Capital Expense, Station Const				
1-8827 · Lease Purchase Ambulances	536,674.47	0.00	536,674.47	100.0%
Total 1-8820 · Capital Expense, Station Const	536,674.47	0.00	536,674.47	100.0%
1-8834 · Vehicle (Other) Payment	0.00	700,000.00	-700,000.00	0.0%
Total Expense	3,387,547.16	6,581,947.00	-3,194,399.84	51.47%
Net Ordinary Income	2,718,937.71	686,369.00	2,032,568.71	396.13%
Net Income	2,718,937.71	686,369.00	2,032,568.71	396.13%