



**WASATCH**  
EXTRACTION

# **Medical Cannabis**

## **Processing**

Application

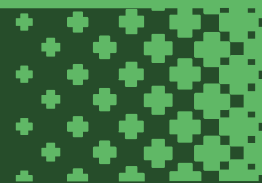

## COMPANY OVERVIEW

Wasatch Extraction was started in January of 2019 and was created to be the best hemp extractor in Utah. Wasatch Extraction transitioned into medical cannabis extraction and through the use of state of the art equipment, a food grade facility, and quality employees, we have created great products and medicine and earned a good reputation with the patients of Utah.

- 
- **Company Summary:** Wasatch Extraction is a GMP compliant extraction lab with the capacity to extract cannabis using ethanol, BHO, solventless, and CO2 extraction methods.
  - **Mission Statement:** To provide the patients of Utah with the finest quality medical cannabis at an affordable price.
  - **Company History:** Wasatch Extraction was created to be a top tier hemp extraction lab in Utah to service the farmers and cultivators that embraced the cannabis sativa plant. When we began, we had little more than CO2 extractors but quickly built out a potency lab for inhouse testing and then expanded our capacity by investing in high throughput ethanol extraction equipment. Wasatch became a medical cannabis extractor in 2020 and since then, has primarily focused on the medical side of the industry. Since becoming a licensed medical extractor, we have expanded our extraction capabilities to include solventless and BHO extraction.
  - **Location:** Our facility is located close to the Salt Lake City Airport and just 3 miles from the Utah Department of Agriculture and Food and the Utah Department of Health. We believe this central location is beneficial as Salt Lake is the heart of Utah and the proximity to the overseeing government entities will allow us to maintain a close relationship. The physical address of the facility is [REDACTED].
  - **Markets, Products and Services:** Wasatch Extraction will primarily focus on extracting oils and concentrates for the use of medical patients throughout Utah. Our facility allows us to create final products with oils such as tinctures, topicals, vape carts, and edibles. We also have the space to package flower and other end use goods.
-

## Business Team

- 
- [REDACTED] has been a successful business owner for the past 18 years and helped establish Wasatch Extraction in January 2019. [REDACTED] has extensive knowledge regarding cannabis cultivation and extraction and has spent a lot of time as a consultant in California to optimize grow and extraction processes for various farms and facilities.
  - [REDACTED]: Graduated from BYU-Idaho with a bachelor's degree in construction management with a minor in business management. [REDACTED] co-created Wasatch Extraction and has been a managing partner since January 2019. [REDACTED] has a strong background in cost control management, safety, environmental and legal compliance, and project management.
-

## Contact Information

- 1) Ownership Entity: Wasatch Extraction, LLC
- 2) DBA: None
- 3) Processing Facility Address: [REDACTED]
- 4) Mailing Address: [REDACTED]
- 5) Business Phone: [REDACTED]
- 6) Facility Manager Contact: [REDACTED]
- 7) Inspection Contact: [REDACTED]
- 8) Contact Person for Sampling/Results: [REDACTED]  
[REDACTED]
- 9) Manager: [REDACTED]
- 10) Other Hemp License:



- 10a) Future Hemp Operations:

- Wasatch Extraction currently has hemp on site. We have had a state inspector out a few times to supervise the disposal of our old hemp material. We will continue to dispose of this material as it is old and we have no intention of using it for extraction. In the meantime, we will keep the bulk hemp away from the medical cannabis onsite. Although we will be renewing our hemp processor's license, Wasatch Extraction does not have any immediate plans to extract industrial hemp. The hemp processors license is primarily for tax purposes.
- 

## Ownership Information

### Ownership Information

An owner is a person who, if the company is privately held, has a financial **or voting interest** of 2% or greater in the cannabis production establishment; or if the entity is publicly traded has more than a 2% financial interest in the company; or is an individual who has the power to direct or cause the management or control of a facility, in other words is a general manager of daily operations.

List all Owners and their positions in the Company.

Legal Name (First & Last)	Role in the Company's Finances and Decisions	Listed on initial Application (Yes/ No)	Agent Card (Yes/ No)
[REDACTED]	President & Founder	Yes	Yes
[REDACTED]	CEO	Yes	Yes

## Processing Facility Information

- 
- **11) Application For:** Tier 1
  - **12) Days Open (Projected):** Monday – Thursday 9:00am – 3:00pm, Fridays 9:00am – 1:00pm
-

# Processing Establishment Property Information

- 13)

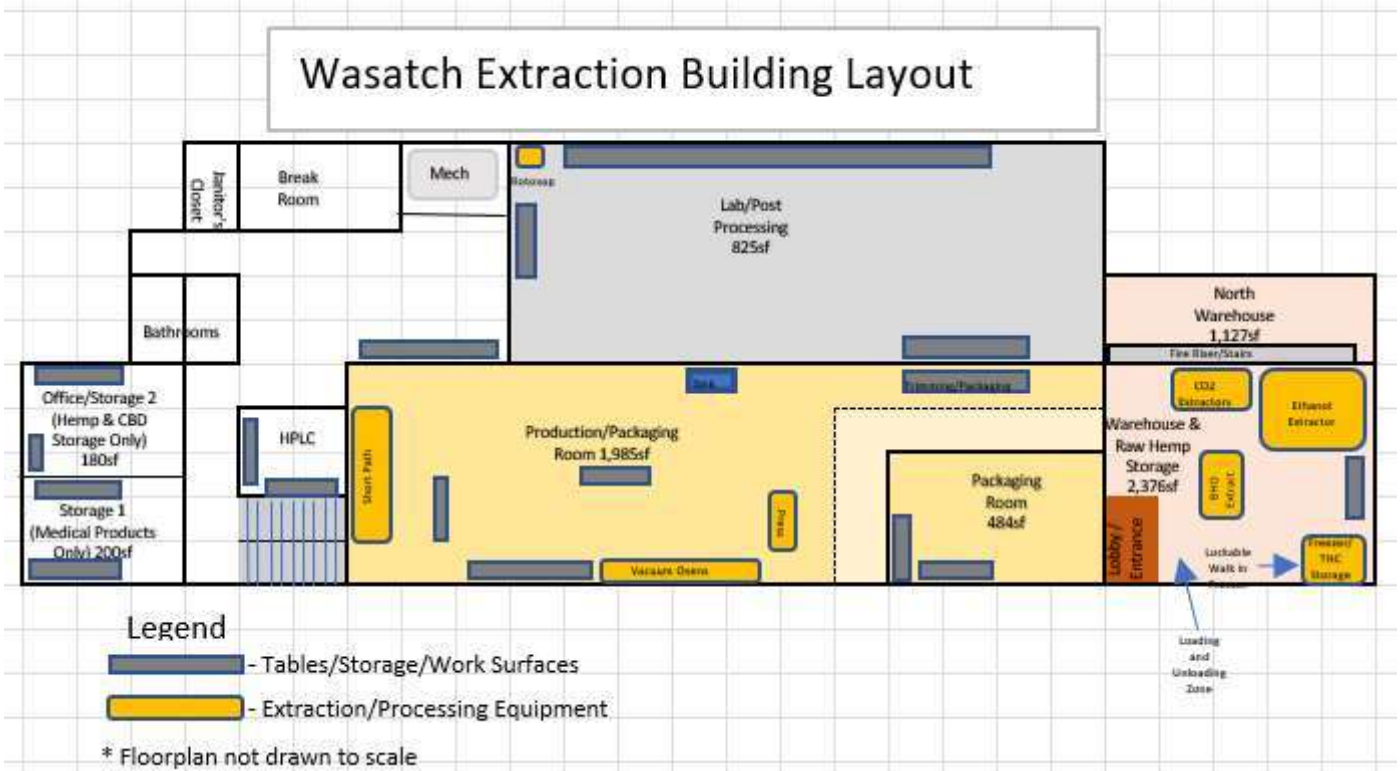





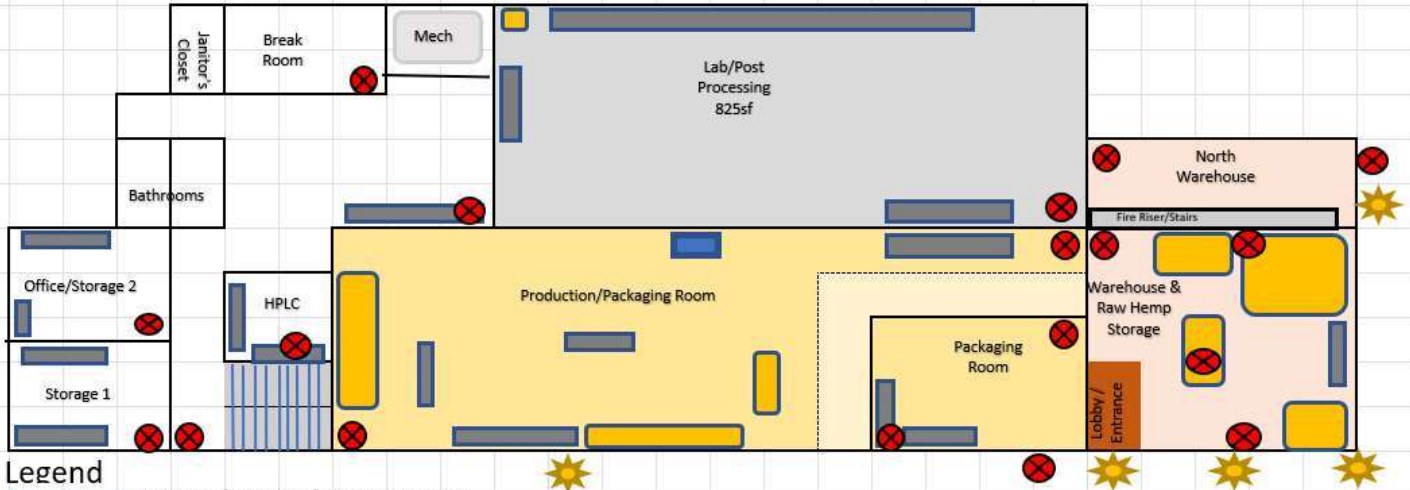

## Wasatch Extraction Camera & Lighting Layout



### Legend

-  Tables/Storage/Work Surfaces
-  Extraction/Processing Equipment
-  Camera Location
-  Exterior Lighting

\* Floorplan not drawn to scale

## Operating Plan

---

- **14) Products to be Produced in the Upcoming Year:** Wasatch Extraction plans on creating a variety of products. These products include: THC Distillate, RSO/Crude, Shatter, Crumble, Wax, Diamonds, Rosin, Bubble Hash, Pressed Pills and/or Gel Capsules, Tinctures, Gummies, Distillate Vape Carts, Rosin Vape Carts, Lotions, Salves, Balms, and Topical Oils.
- **15) Extraction Methods:**
- **CO2 Extraction:** CO2 is the extraction method that Wasatch Extraction opened its doors with. Wasatch has two MRX 20LE machines in current operation. These machines hold 10-12 pounds of ground material each and using chilled and compressed CO2, concentrated plant material is extracted from ground biomass. The product extracted from these machines is called butter and has a foamy consistency. This butter is then mixed with some ethanol and placed in a sub-zero temperature deep freezer. This winterization process helps separate the waxes from the active ethanol/cannabis mixture. The waxes are then filtered out and the ethanol/cannabis mixture is placed in a rotary evaporator (rotovap). With temperature and vacuum, the rotovap reclaims the ethanol and leaves crude cannabis oil behind. This crude oil will then go through short path distillation equipment. This final step separates the purified cannabis oil from other undesirable components. The result of this process is an amber colored oil called distillate. For more detailed information, please refer to the Wasatch's SOP #9 submitted to UDAF.
- **Ethanol Extraction:** Wasatch owns a Delta Separation CUP-30 extractor. This unit gets filled with up to 30 pounds of ground cannabis biomass and then super chilled food-grade ethanol is injected into the machine to saturate the plant matter. The biomass holding tub will agitate much like a washing machine so that the ethanol can penetrate as much of the ground cannabis as possible. The ethanol pulls out the oils from the biomass to create an ethanol/cannabis tincture. This tincture flows into receiving tank where it can then be pumped into kegs. These kegs of tincture are poured/pumped through filters to remove any unwanted waxes or particulates. The result is a filtered ethanol/cannabis tincture which can then be placed into a rotovap or a Delta Separations Falling Film Evaporator. Both machines can reclaim the ethanol so that it can be reused. Once the ethanol has been removed, the resulting product is considered a crude oil. This crude oil can be further refined in the short path or in our Delta Separations Rolled Film Evaporator. Both machines convert crude into distillate. For more detailed information, please refer to the Wasatch's SOP #10 submitted to UDAF.
- **Butane Extraction (BHO):** Wasatch recently procured a BVV 10lb Active BHO Extractor along with the ancillary equipment and extraction booth required to operate the machine. This equipment functions in a similar fashion to CO2 but utilizes butane as the solvent. Biomass is added to the extraction vessel and butane is pumped through the material under pressure. As the butane saturates the plant matter, it strips the plant of its oils where they can be collected in a receiving vessel. This method and equipment should have much higher yields than our other extraction methods and the oil output has properties that allow us to create a variety of end use concentrates such as crumble, wax, BHO shatter, diamonds, and BHO sauce. For more detailed information, please refer to the Wasatch's SOPs #21 submitted to UDAF.

- **Press Extraction:** Our facility is equipped with a PurePressure Longs Peak Rosin Press. This machine utilizes 2 heated plates and 8 tons of pressure to squeeze cannabis material to extract the oils inside. To use the machine, small mesh bags are filled with cannabis and then placed in the jaws of the press. The press uses slightly heated plates and pressure to extract what is called live rosin. This rosin can be collected and jarred and is considered a solventless or non-solvent concentrate. For more detailed information, please refer to the Wasatch's SOPs #22 submitted to UDAF.
- **Bubble Hash/Water Bath Extraction:** Wasatch is currently procuring water bath extraction equipment. This method is performed by adding biomass into filtered bags and place them in a vessel that gets flooded with filtered ice water. The biomass is then mixed and agitated in the chilled water, and the ice water will pull out the active ingredients. This cannabis water will then be filtered and what is left behind in the filter is a frothy material of active cannabis. This frothy substance can then be placed in a vacuum oven and dehydrated. This will produce a dried crumbly extract that can be packaged. As stated, this is in the procurement stage and more detail of the equipment will be provided to UDAF once the material is ordered and on site.
- **16) Is the Facility Doing CBD to TCH Conversion?:** No. Wasatch will not be converting hemp waste into medical THC but Wasatch would like to reserve the right to purchase such products through the proper channels and use them in accordance with the law.
- **17) Emergency Procedures:**
  - **Fire:** In the event of a fire, employees are instructed to call 911 and to address the situation to determine if it would be safe to attempt to put out the fire with an extinguisher. If the fire is small enough, the employees are instructed to use an extinguisher to put out the flames. If the fire is large enough or there is danger to the employees, they are instructed to leave the premises using the nearest exterior door. Under no circumstances are employees to attempt to fight a fire that is not containable by an extinguisher.
  - **Chemical Spills:** If a chemical spill takes place, the employees are to determine if the spill is safe to attempt to clean by themselves. This assessment can be made by using the MSDS sheets provided in the facility. For most spills that might take place in our facility, rubber gloves and cloths are all that are needed to clean up the contents.
  - **Earthquake:** In the event of an earthquake, employees are to stay away from windows, glass objects, or machinery that might tip over. If near a door, they can move outside. If they are in the lab or packaging area, they are instructed to take shelter under one of the many steel tables in the area. After the earthquake has stopped, employees are to meet outside where they can be safe in the event of aftershocks and wait for futher instruction.
- **18) Security Plan:**
  - **A) Security System:** Our facility is currently outfitted with a security system monitored by Clover. Each exterior door is equipped with sensors, there are glass break sensors in any room with windows, even those on the second floor. There are motion sensors and 16 interior cameras that meet the resolution

requirements outlined by R68-28-6-2(a) and 2 exterior cameras which cover the doors. We also have two video doorbell cameras.

- **B) Persons Notified in Case of Breach:** Both Steve and Darren will be alerted automatically by the phone app associated with our alarm system. An alarm system operator will also physically call Steve to confirm the emergency and ask if police dispatch is required.
- **C) Video Storage Device Location:** Video footage is stored on a large local hard drive located on the second floor within the utility room. This room has lockable steel doors and is rarely opened. The hard drive space is sufficient to retain uninterrupted video footage for 45 consecutive days.
- **D) Visitors:** Visitors to Wasatch will be required to sign into our visitor log and a visitor badge will be issued to them. The badge must be worn and visible while on the premises. Visitors will be escorted by a licensed agent and must remain within view of an employee at all times.
- **E) Visitor Log:** All visitors to Wasatch must sign in using the log book found near the front door. The log book collects the following information; a) Name of visitor; b) Time of arrival; c) Purpose of visit; d) Time of departure; e) Badge number. The log book and information will be kept and available for UDAF inspectors to view at any time. The pages within the log book will be kept on record for at a minimum of one year.
- **F) Procedures to Provide UDAF Inspectors Immediate Access to Current and Archived Video Footage:** Wasatch employees can log in from the office computer and share video footage with inspectors. Also, UDAF was provided with Wasatch video login information so it can be accessed remotely at any time.
- **19) Storage Protocols:**
- **General Storage:** Storage areas will be: a) be maintained in a clean and orderly condition; and b) be free from infestation by insects, rodents, birds, or vermin. As a processing facility, we will: a) track and label each cannabis plant product and cannabis concentrate; b) ensure each unfinished product is stored in a secure location; and c) immediately after completion of the process or at the end of the scheduled business day return to a secure location. If a manufacturing process cannot be completed at the end of a working day, the processor shall securely lock the processing area or tanks, vessels, bins, or bulk containers containing cannabis inside an area or room that affords adequate security.
- **Cannabis Raw Product Storage:** Raw product will be kept in a lockable metal lined walk in freezer where the material will await processing or in our cannabis storage room behind locked doors. A solo tag or other compliant identification tag will accompany all raw product in storage.
- **Cannabis Oil & In Process Material Storage:** Concentrate and bulk products waiting to be packaged or made into finalized product will be kept in our cannabis storage room which is behind a solid lockable door. All products will be labeled and have a solo tag or other compliant identification tag to accompany them
- **Final Product Storage:** Final/Packaged product will be kept in the cannabis storage room and will be marked with solo tags or other compliant identification tags.

- **CBD Product Storage:** CBD and other minor cannabinoid concentrates will be stored in our CBD storage room unless it is logged into the medical system. Once these concentrates/isolates enter the medical system, they will be moved into storage room 1 and will be shelved with our THC concentrates.
- **20) Recall Plan:**
- If Wasatch initiates a recall due to a condition that poses a sufficient risk to consumers to warrant a recall appropriate under R68-28-14, the Recall Coordinator will promptly take the following steps:
- Identify the affected product
- Secure, isolate, and prevent the further distribution of all affected product in the possession of Wasatch;
- Notify the department that Wasatch intends to initiate a voluntary recall;
- Identify which dispensaries, labs, or individuals may have received any of the affected product, and immediately issue a stop use warning to the relevant persons regarding the affected product. Such persons may be contacted by phone, email, hand-delivered notice, or personal visit, whichever may be most expedient;
- Promptly retrieve all affected product from all identified recipients as soon as practicable in a manner compliant with the rules applicable to the pick-up and delivery of cannabis products in the state;
- In appropriate cases, as determined in consultation with the department's enforcement officer, issue a press release and other notices designed to ensure that consumers are notified of the recall and provided relevant information about the affected product;
- In coordination with the department enforcement officer, specifically identify the affected product to determine whether such a product may be remediated or otherwise salvaged;
- In the event any or all of the affected product must be destroyed, carry out the destruction of the affected product in a manner satisfactory to the department, which destruction will be subject to the oversight of the department enforcement officer;
- Track the total amount of affected product and the amount of affected product returned to the Company in response to the recall, and provide weekly (or more frequent) reports to the department regarding the progress of the recall; and
- Fully cooperate with the department enforcement officer to ensure that a recommendation of "recall closure" can be made to the department as soon as practicable.
- **Recall Coordinators:** Darren Johnson and Steve Gosdis are the two recall coordinators for Wasatch Extraction.

- [REDACTED]
- **21) Disposal Plan:** Products needing to be discarded for whatever reason will go through the following processes:
  - Biomass/Flower waste will be ground and mixed with a dirt, sawdust, sand, clay, or some other contaminant so that the marijuana material will at max make up 49% of the resultant mixture and will be rendered unusable and unrecognizable. All cannabis waste will follow state and local regulations and be mixed to at least the 50/50
  - Final product needing to be discarded for whatever reason will go through the following processes:
    - Cart Disposal – Cartridges that require disposal will be crushed with a sledge hammer. This will first contaminate the product with glass shards but we will then mix the product with dirt, cat litter, sawdust, or some other material to make the contents unusable and then it will be discarded into the trash. All cannabis waste will follow state and local regulations and be mixed to at least the 50/50
    - Tincture/Oil/Salve/Balm Disposal – These products will be poured into a bucket and mixed with dirt, cat litter, sawdust, bleach, or some other material that will make up at least 51% of the total volume of what is being destroyed. Afterwards, the contents will be thrown into the trash. All cannabis waste will follow state and local regulations and be mixed to at least the 50/50
    - Pill Disposal – Pills will be crushed and mixed with dirt, cat litter, sawdust, bleach, or some other material that will make up at least 51% of the total volume of what is being destroyed. Afterwards, the contents will be thrown into the trash. All cannabis waste will follow state and local regulations and be mixed to at least the 50/50
    - Concentrate Disposal – Shatter, Diamonds, Crumble, or and other concentrate will be mixed with dirt, cat litter, sawdust, bleach, or some other material that will make up at least 51% of the total volume of what is being destroyed. Afterwards, the contents will be thrown into the trash. All cannabis waste will follow state and local regulations and be mixed to at least the 50/50
    - Gummy Disposal – Gummies will be placed in a bucket, covered in bleach, and then mixed with dirt, cat litter, sawdust, bleach, or some other material that will make up at least 51% of the total volume of what is being destroyed. Afterwards, the contents will be thrown into the trash. All cannabis waste will follow state and local regulations and be mixed to at least the 50/50
    - Wastewater – Wasatch does not produce any real wastewater other than standard restroom wastewater and dishwashing. The extraction methods currently in use don't produce any water byproduct. The tools and glassware used in post processing get cleaned first in ethanol baths before going to the dishwashing stations. The ethanol baths are disposed of with our solvent disposal method.
    - Solvent Disposal – Solvents left over from extraction that are no longer usable will be discarded. This primarily applies to ethanol. Ethanol can be reused multiple times before it loses its extraction ability but once that happens, the ethanol will be stored in 5 gallon buckets with lids until it is ready for disposal. Once ready for disposal, bleach will be mixed with the ethanol and then the mixture will be taken to the

Salt Lake Valley Landfill at the Health Department Hazardous Waste area. All cannabis waste will follow state and local regulations and be mixed to at least the 50/50

- Lab Waste Disposal – Lab waste which includes ‘heads’ and ‘tails’ from the short path will be disposed of by combining the waste into a 5 gallon plastic bucket with a lid. Because this waste contains cannabis byproducts, under video recording (both from shop surveillance and by phone video recording) we will mix the waste with bleach. Once this waste has been sufficiently destroyed with bleach, we will contact the State and inform them of our intention to transport the material to the disposal site. Once given authorization from the State to transport the waste, we will deliver it to the Salt Lake Valley Landfill and have it disposed of at the Hazardous Waste area. All cannabis waste will follow state and local regulations and be mixed to at least the 50/50
- Each batch of product to be disposed of will be tracked and logged within MJ Freeway.
- **22) Transportation:** Wasatch will follow the following laws regarding transportation:
  - **22-1)** A printed transport manifest shall accompany each transport of cannabis.
  - **22-2)** The manifest shall contain the following information:
    - a) the cannabis production establishment address and license number of the departure location;
    - b) physical address and license number of the receiving location;
    - c) strain name, quantities by weight, and unique identification numbers of each cannabis material to be transported;
    - d) date and time of departure;
    - e) estimated date and time of arrival
    - f) name and signature of each agent accompanying the cannabis.
  - **22-3)** The transport manifest may not be voided or changed after departing from the original cannabis production establishment.
  - **22-4)** A copy of the transport manifest shall be given to the receiving cannabis production establishment or medical cannabis pharmacy.
  - **22-5)** When receiving product, Wasatch shall ensure that the cannabis material received is as described in the transport manifest and shall:
    - a) record the amounts received for each strain into the inventory control system; and
    - b) document any differences between the quantity specified in the transport manifest and the quantities received in the inventory control system.
  - **22-6)** During transportation, cannabis shall be:

- a) shielded from the public view;
- b) secured; and
- c) temperature controlled if perishable.
- **22-7)** Wasatch will contact the department within 24 hours if a vehicle transporting cannabis is involved in an accident that involves product loss.
- **22-8)** Only the registered agents of the cannabis processing facility may occupy a transporting vehicle.
- Agents transporting cannabis products must have a valid driver's license and a vehicle with current registration.
- **Current list of transportation vehicles used at Wasatch Extraction:**

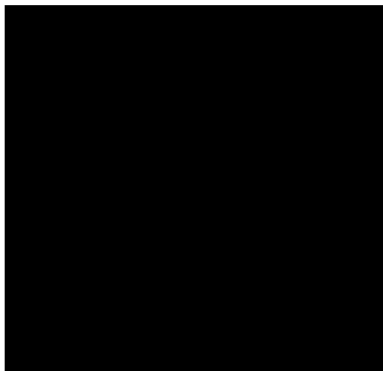

## Compliance



**23) Performance Bond:**



**PROSURE GROUP**  
BONDING TOGETHER. BUILDING TOGETHER.

7217 Benjamin Road  
Tampa, FL 33634

(813) 243-1110  
(813) 243-1109 fax  
commercialbonds@prosuregroup.com  
www.prosuregroup.com

**CONTINUATION CERTIFICATE**

The **Lexington National Insurance Corporation** (hereinafter called the Company) hereby continues in force ~~with no lapse in coverage~~ its Bond No. **L213297-2105** in the sum of **Fifty Thousand & 00/100 U.S. Dollars (\$50,000.00)**, on behalf of **Wasatch Extraction, LLC** in favor of **Utah Department of Agriculture and Food** for the (extended) term beginning on **April 24, 2024**, and ending on **April 23, 2025**, subject to all the covenants and conditions of said Bond.

This Continuation is executed upon the express condition that the Company's liability under said Bond and this and all continuations thereof shall not be cumulative and shall in no event exceed the sum of **Fifty Thousand & 00/100 U.S. Dollars (\$50,000.00)**.

IN WITNESS WHEREOF, the Company has caused this instrument to be signed by its officers proper for the purpose and its corporate seal to be hereto affixed this March 7, 2024.

Witness: Brandy Bai

**Lexington National Insurance Corporation**  
(Surety)

By: David B. Shick

**David B. Shick, Attorney-In-Fact**  
(Title)



**SURETY BONDS**

Performance Bonds | Contract Bonds | License Bonds | Court Bonds



**24 & 25) Scale Compliance & Food Establishment Certification:**



26) Local Business License:

NOTICE: THIS CERTIFICATE MUST BE POSTED IN A CONSPICUOUS PLACE

---

**SALT LAKE CITY CORPORATION**

CITY I.D. Number: **LIC2019-01002** (311225)

THIS IS TO CERTIFY THAT THE HEREIN NAME, HAVING COMPLIED WITH THE ORDINANCE IN FORCE, RELATED TO LICENSES, IS HEREBY LICENSED TO TRANSACT THE BUSINESS OF:

**Fats and Oils Refining and Blending** Expiration Date: **Mar 31, 2025**

Commercial License	1
Manufacturing	1
Employees	5

WITHIN SALT LAKE CITY, UTAH AT THE ADDRESS INDICATED BELOW:

**Wasatch Extraction**

[Redacted Address]

IN TESTIMONY WHEREOF, I HAVE HEREUNTO SET MY HAND:

Attest: 



---

THIS LICENSE IS NOT TRANSFERABLE

27) Registered Agents with Wasatch Extraction:

---

