

Start Recycling with **sZy's** **recyclops**

Proudly serving Sanpete and Nephi
435-267-3021

Sign up now for curbside recycling
pick up, and keep more waste out
of our landfills!

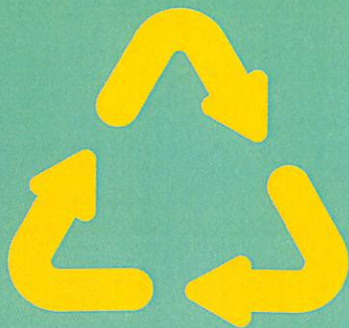

Scan QR code to sign up or
visit
<https://recyclops.com/signup/>



**CONSTRUCTION BUDGET FOR THE SPRING CITY ACTIVITY CENTER
RESTROOMS**

JULY 6, 2023

<u>Item</u>	<u>Cost</u>
Design	Not included
Project Management	Not included
Demolition	\$3,000.00 (Mostly by City Employees)
Concrete Work	\$3,000.00 (Mostly by City Employees)
Seismic Stabilization	\$0.00
Framing	\$1,000.00
Masonry	\$2,300.00
Door & Hardware	\$3,500.00
Drywall & Plaster	\$2,000.00
Ceramic Tile	\$20,500.00
Toilet Partitions & Accessories	\$11,000.00
Painting	\$0.00
Plumbing	\$20,000.00
Exhaust Fans	\$3,500.00 (By City Employees)
Electrical	(By City Employees)
Gutters & Downspouts	<u>\$4,000.00</u>
TOTAL	\$73,000.00

JOEL HILL CONSTRUCTION

CERAMIC TILE CONTRACTORS

675 NORTH MAIN STREET
MAPLETON, UTAH 84664
PH 801-376-6528
FAX 801-491-3713

PROPOSAL

DATE OF PROPOSAL: 6/27/23

PROPOSAL SUBMITTED TO:

PAULSEN CONSTRUCTION
ATTN: CRAIG

JOB INFORMATION:

SPRING CITY REC CTR

WE HEREBY SUBMIT SPECIFICATIONS AND ESTIMATES FOR:

PROVIDE AND INATALL CERAMIC TILE IN RESTROOMS AS PER PLAN USING SELECTED TILE
USING DAL TILE SELECTIONS

WE PROPOSE HEREBY TO FURNISH MATERIALS LABOR COMPLETE IN ACCORDANCE WITH THE ABOVE
SPECIFICATIONS FOR THE SUM OF:

NINETEEN THOUSAND NINE HUNDRED FIFTY EXACTLY

\$19,950.00

PAYMENT TO BE MADE AS FOLLOWS:

MONTHLY DRAWS

AUTHORIZED SIGNATURE: _____

NOTE: THIS PROPOSAL MAY BE WITHDRAWN BY US IF NOT ACCEPTED WITHIN 30 DAYS

ACCEPTANCE OF PROPOSAL: THE ABOVE PRICES, SPECIFICATIONS, AND CONDITIONS ARE SATISFACTORY
AND ARE HEREBY ACCEPTED. YOU ARE AUTHORIZED TO DO THE WORK AS SPECIFIED, PAYMENT WILL BE



550 South Main Gunnison, UT 84634
Phone: (435)528-3365 Email: petersonref@hotmail.com

Prepared by: Clint Mackay
Cell: 435-340-1340

GOOD FAITH BUDGET ESTIMATE

For: Paulsen Construction

Date: July 5, 2023

Email: craig@paulsenconstruction.com

Job: Spring City Activity Center

We hereby submit Good Faith Budget Estimate for:

Plumbing Installed Complete As Per Specs.....\$12,531.89 _____ Initial

Bid Includes: (5) Wall Hung Water Closets with Seats; (5) Sloan Battery Operated Sensor Side Mount Flush Valve Actuators; (1) ADA Tank Water Closet with Seat; (1) ADA Wall Hung Lavatory with Moen L64601 Single Handle Chrome Faucet; Lav Guard kit; (1) Electric 50 Gallon Water Heater & Expansion Tank; (1) 48" Stainless Grab Bar; (1) 36" Stainless Grab Bar; (1) 18" Stainless Grab Bar; Tax; Labor & Miscellaneous Materials to Install Complete.

Option for Sensor Faucet for Wall Hung Lav ADD.....\$412.69 _____ Initial

Option for Toilet Carriers for 5 Toilets ADD.....\$4,215.56 _____ Initial

**Excludes Any Concrete Cutting, Patching or Repairs.*

Price quotes good for 30 days & secured upon acceptance signature. All material is guaranteed to be as specified. All work to be completed in a workmanlike manner according to standard practices. Any alteration or deviation from above specifications involving extra costs will be executed only upon written orders, and will become an extra charge over and above the estimate. All agreements contingent upon strikes, accidents or delays beyond our control. Owner to carry fire, tornado and other necessary insurance. Our workers are fully covered by Workman's Compensation Insurance.

Price Quotes exclude Building Permits and Inspections.

Please Mail signed quote with 50% down if you decide to accept this bid, so equipment can be ordered.

50% Due upon completion. No credit card charges over \$1000.00 please.

Authorized Signature
for Peterson Refrigeration & Mech.

Authorized Acceptance Signature
for Paulsen Construction

Date _____

Midwest D-Vision Solutions
965 West Beardsley Place
Salt Lake City, UT 84119
www.d-visionsolutions.com

Proposal

Midwest



GLASS

Phone: 801-377-4355
Mobile: 801-885-7517

Proposal: 230626P1
Date: 6/26/2023

To: PAULSEN CONSTRUCTION Attn: Christine Groberg 3075 South 230 West Salt Lake City, UT 84115	Project: Spring City Rec Center
--	---

Salesperson	Tax Included	Addenda Reviewed
Justin Dahl	Included	n/a

Scope of Work

No specs provided. Please review notes in individual scope sections below.
Bid is presented as a lump sum, all or nothing proposal. Awards or contracts for individual scopes of work are not to be entertained.

Exclusions

Backing or Blocking
Dumpster Rental
Multiple Mobilizations

Reference	Description	Quantity	UOM	Extended Price
10.1500 Toilet Compartments				\$6,512

** No specs provided. Detail 604/G003 indicates floor to ceiling configuration for toilet partitions, but does not specify material type. We have included Hadrian powder coated steel partitions in a floor to ceiling configuration in our bid. If another material type is wanted, please ask for quote. **

** Unisex toilet stall scales to 91" deep front to back. Largest depth offered by Hadrian is 82" deep. We have included an 82" deep stall in the Unisex restroom. **

Toilet Partitions - Material/Freight	1	LS	
Floor to Ceiling Powder Coated Steel - Install	5	EA	
Floor to Ceiling Post Mounted Urinal Screen Powder Coated Steel - Install	1	EA	

10.2800 Toilet, Bath, and Laundry Accessories

\$2,888

** Under Lavatory Guards are EXCLUDED. **

** No specs provided. We have included typical Bobrick commercial grade accessories. See attached submittals for info on toilet accessories priced. **

Proposal

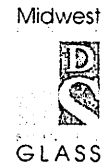

Reference	Description	Quantity	UOM	Extended Price
	Toilet and Bath Accessories Material/Freight	1	LS	
	Grab Bar 18" - Install	2	EA	
	Grab Bar 36" - Install	2	EA	
	Grab Bar 42" - Install	2	EA	
	Toilet Paper Dispenser - Install	5	EA	
	Sanitary Napkin Disposal - Install	3	EA	
	Seat Cover Dispenser - Install	5	EA	
	Soap Dispenser - Install	3	EA	
	Paper Towel Dispenser - Install	3	EA	
	Framed Mirror 24x36 - Install	3	EA	
	Mop Strip - Install	1	EA	

Bid is good for 30 days - Afterwards we reserve the right to review and revise pricing as needed.

Proposal Total: \$9,400

Acceptance

Accepted by: _____

Title: _____

Date: _____

General Exclusions - Unless specifically noted above.
1 - Performance and Payment Bonds
2 - Furnishing of or installation of solid backing/blocking
3 - Furnish and install of backer rods and sealants
4 - Cutting or patching of existing work
5 - Dumpster costs/charges for use of the dumpster
6 - Electrical wiring or electric connections of any kind.
7 - Final cleaning or protection of installed work.
8 - Prevailing wages

PRICE ESCALATION

As of the date of this agreement, certain markets providing essential materials to the Project are experiencing or are expected to experience significant, industry-wide economic fluctuation during the performance of the agreement that may impact price, availability, and delivery. In the event that material costs on which the Contract Price is based rise in excess of five percent (5%) during the course of the work, General Contractor agrees that these increased costs, in their entirety, shall be billed to General Contractor as an automatic adjustment to the Agreement.

NOTICE OF MANUFACTURER AND SUPPLY CHAIN DISRUPTIONS

Quoted leads times are based on the most up to date information Midwest D-Vision Solution / Bountiful Glass has from our manufacturing partners. Published manufacturing lead times can change without notice at any time. Midwest D-Vision Solution / Bountiful Glass cannot guarantee lead times or delivery dates for any manufacturer / vendor. Manufacturer supply chains and distribution networks have been and may continue to be disrupted until further notice. Manufacturers may ship incomplete orders, or certain line items on orders may be shipped at different times.

FORCE MAJEURE

Midwest D-Vision Solution / Bountiful Glass shall not be considered in default of any obligations under this quotation if their performance is delayed, altered or rendered impossible by acts of God, war, civil commotion, government action, economic disruption, health epidemic / pandemic, national strike, construction delay, storm, fire, explosion, or other industrial or natural disturbance, or any other cause that is beyond their reasonable control ("Force Majeure Event"). In the event of any Force Majeure Event, parties acknowledge and agree that the dealer and/or manufacturer will not be in default, and will take alternative measures, when available, in order to continue performance under this agreement.

Bobrick Washroom Equipment, Inc.

Washroom Accessory Submittal

Quote: **3756463-1**

Quote Date: **6/26/2023**

Job Name: **Spring City Rec Center**

MIDWEST D-VISION SOLUTIONS LLC

987 S WEST TEMPLE

SALT LAKE CITY, UT 84101

(801) 359-7681

Item	Description	Qty
6806X18	Straight Grab Bar 18" (457Mm)	2
6806X36	Straight Grab Bar 36" (914mm)	2
6806X42	Straight Grab Bar 42" (1067mm)	2
2888	Surf Mtd. Tp Disp	5
270	Contura Surf Mtd Napkin Disp	3
221	Seat Cover Dispenser	5
2112	Tank Sur-Mt Soap Disp-Series-D	3
262	Surf Mtd Paper Towel Disp	3
165 2430	Mirror 24"W X 30"H (61Cm X 76Cm)	3
224X36	Shelf And Mop Holder-36 In	1

BOBRICK

Technical Data

1½" (38mm) DIAMETER STAINLESS STEEL GRAB BARS WITH SNAP FLANGE

B-6806 SERIES

Specify Finish Required:

- ☐ Satin-finish, slip-resistant surface
☐ Peened surface; add suffix .99 to model number

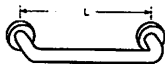
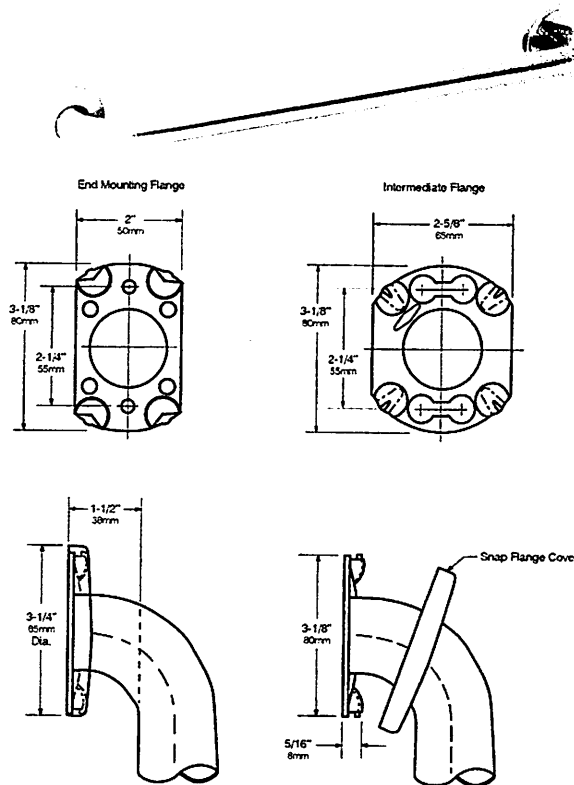

HORIZONTAL

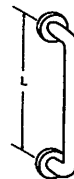

VERTICAL

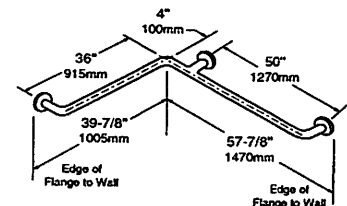
TWO-WALL WHEELCHAIR
COMPARTMENT

B-6806 x 12, 18, 24, 30, 36, 42, 48

B-68137

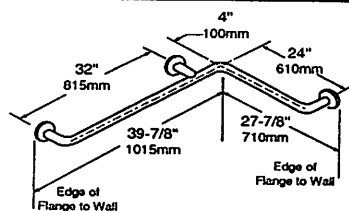
HORIZONTAL TUB / SHOWER
COMPARTMENT BAR 24 x 36

B-68616

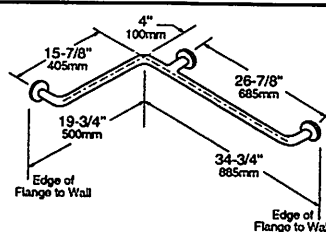
HORIZONTAL TWO-WALL BAR
for Shower Stall

B-6861

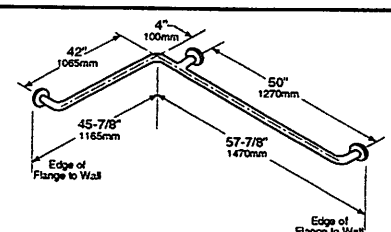
TWO-WALL
TOILET COMPARTMENT BAR 42 x 54

B-6897

continued . . .

MATERIALS:

Grab Bar — 18-8 S, type-304, 18-gauge (1.2mm) stainless steel tubing with satin-finish, slip-resistant surface. 1-1/2" (38mm) outside diameter. Ends are heliarc welded to flanges. Clearance between the grab bar and wall is 1-1/2" (38mm).

Concealed Mounting Flanges — 18-8 S, type-304, 11-gauge (3.2mm) thick, stainless steel plate; end flanges 2" x 3-1/8" (50 x 80mm) with holes for attachment to wall. Intermediate flanges 2-5/8" x 3-1/8" (65 x 80mm) wide x 3-1/8" (80mm) diameter.

Snap Flange Covers — 18-8 S, type-304, 22-gauge (0.8mm) drawn stainless steel with satin-finish. 3-1/4" (85mm) diameter x 1/2" (13mm) deep. Each cover snaps over mounting flange to conceal mounting screws.

STRENGTH:

Bobrick grab bars that provide 1-1/2" (38mm) clearance from wall can support loads in excess of 900 pounds (408kg) if properly installed. Other grab bar configurations can support loads in excess of 250 pounds (113kg) if properly installed, complying with accessible design (including ADAAG in the U.S.A.) for structural strength.

Safety Warning: Grab bars are no stronger than the anchors and walls to which they are attached and, therefore, must be firmly secured in order to support the loads for which they are intended. To avoid potential injury, the building owner or maintenance personnel should remove the grab bar from service if the grab bar is not adequately secured to wall or if there is any observed damage to the welds.

INSTALLATION:

Provide concealed anchor device or backing as specified or required in accordance with local building codes before wall is finished. Fasten concealed mounting flanges to anchor device or backing with at least two screws opposing each other in each flange. Snap flange covers over each mounting flange to conceal mounting screws. Concealed anchor devices and mounting screws are not included with Bobrick grab bars and must be specified as an accessory.

For Grab Bars with an Intermediate Flange(s), Pull Snap-Flange Covers away from mounting flanges. Place grab bar in desired mounting location. Use intermediate flange as a template to mark location of mounting screws at intermediate flange only. Mark screw locations at the center of the slot in the middle of the double-keyhole shaped mounting holes (2) in the intermediate flange. Remove grab bar from wall. Drive the intermediate flange mounting screws into wall at marked locations. **Note:** Make sure to leave a space of just over 1/8" (3.17mm) between the underside of the screw head and the wall. Install grab bar on the wall by placing the round ends of the intermediate flange double-keyhole shaped mounting holes over the mounting screws (2) are located in the middle of the flange slots. Install the mounting screws into the wall at the end flanges and secure tightly. Tighten the mounting screws at the intermediate flange. Press all snap-flange covers into place to conceal mounting flanges.

Note: Recommend use of 1/4" or #14 sheet metal or wood screws to install Intermediate Flange. #12 screws may also be used.

Important Notes:

1. **Mounting Kits** — Bobrick offers a mounting kit for installing grab bars; one Bobrick mounting kit is required for each flange.

Mounting Kit No.	Description
252-30	Consists of # (3) 14 x 2½" type-304 stainless steel, Phillips round-head, sheet-metal screws.

2. **Grab Bar Fastener** — Bobrick offers a grab bar fastening system that secures all Bobrick grab bar series; one Bobrick fastener is required for each flange. Install grab bar without backing in wall requires minimum 5/8" (16mm) thick painted or tiled drywall.

WingIt™ Fastener No.	Description
251-4	Consists of 10–32 x 5/16" round-head, Phillips 18/8 stainless steel screws. (1) WingIt grab bar fastener.

3. **Optional Anchor Device** — Bobrick grab bar anchor device includes stainless steel machine screws to be used for attaching grab bars to anchors. one Bobrick concealed anchor device is required for each flange.

Optional Anchor No.	Description
2583	Anchor for 3/4" to 1" (19-25mm) panel 1 anchor required for each flange.
2586	Anchor for 1/2" to 1" (13mm) panel 1 anchor required for each flange.

SPECIFICATION:

Grab bar shall be type-304 stainless steel with satin-finish, slip-resistant surface. Grab bar shall have 18-gauge (1.2mm) wall thickness and 1-1/2" (38mm) outside diameter. Clearance between the grab bar and wall shall be 1-1/2" (38mm). Concealed mounting flanges shall be 11-gauge (3.2mm) thick stainless steel plate, 2" x 3-1/8" (50 x 80mm), and equipped with at least two screw holes for attachment to wall. Flange covers shall be 22 gauge (0.8mm), 3-1/4" (85mm) diameter x 1/2" (13mm) deep, and shall snap over mounting flange to conceal mounting screws and/or WingIt fasteners. Ends of grab bar shall pass through concealed mounting flanges and be heliarc welded to form one structural unit. Grab bar shall comply with accessible design (including ADAAG in the U.S.A.) for structural strength.

Grab Bar shall be Model _____ (insert model number) of Bobrick Washroom Equipment, Inc., Clifton Park, New York; Jackson, Tennessee; Los Angeles, California; Bobrick Washroom Equipment Company, Scarborough, Ontario; Bobrick Washroom Equipment Pty. Ltd., Australia; and Bobrick Washroom Equipment Limited, United Kingdom.

BOBRICK

Technical Data

1½" (38mm) DIAMETER STAINLESS STEEL GRAB BARS WITH SNAP FLANGE

B-6806 SERIES

Specify Finish Required:

- ☐ Satin-finish, slip-resistant surface
☐ Peened surface; add suffix .99 to model number

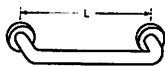
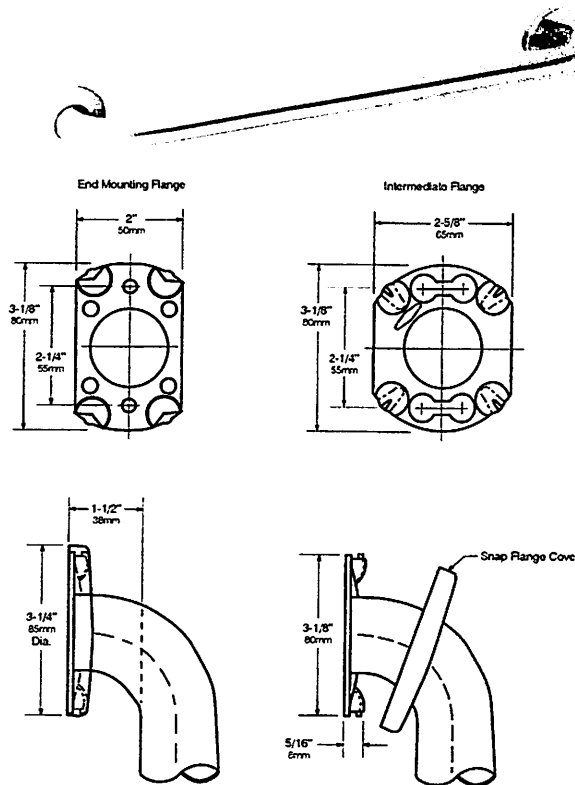

HORIZONTAL

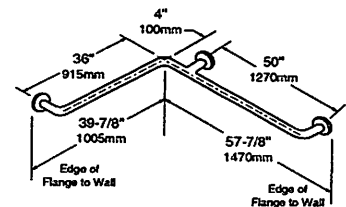

VERTICAL

TWO-WALL WHEELCHAIR
COMPARTMENT

B-6806 x 12, 18, 24, 30, 36, 42, 48

B-68137

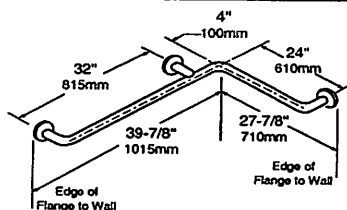
HORIZONTAL TUB / SHOWER
COMPARTMENT BAR 24 x 36

B-68616

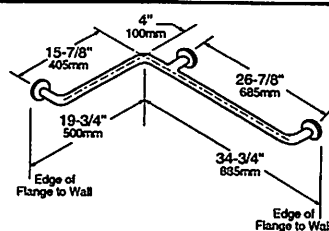
HORIZONTAL TWO-WALL BAR
for Shower Stall

B-6861

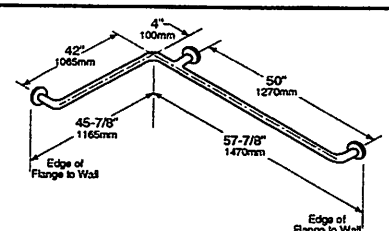
TWO-WALL
TOILET COMPARTMENT BAR 42 x 54

B-6897

continued . . .

MATERIALS:

Grab Bar — 18-8 S, type-304, 18-gauge (1.2mm) stainless steel tubing with satin-finish, slip-resistant surface. 1-1/2" (38mm) outside diameter. Ends are heliarc welded to flanges. Clearance between the grab bar and wall is 1-1/2" (38mm).

Concealed Mounting Flanges — 18-8 S, type-304, 11-gauge (3.2mm) thick, stainless steel plate; end flanges 2" x 3-1/8" (50 x 80mm) with holes for attachment to wall. Intermediate flanges 2-5/8" x 3-1/8" (65 x 80mm) wide x 3-1/8" (80mm) diameter.

Snap Flange Covers — 18-8 S, type-304, 22-gauge (0.8mm) drawn stainless steel with satin-finish. 3-1/4" (85mm) diameter x 1/2" (13mm) deep. Each cover snaps over mounting flange to conceal mounting screws.

STRENGTH:

Bobrick grab bars that provide 1-1/2" (38mm) clearance from wall can support loads in excess of 900 pounds (408kg) if properly installed. Other grab bar configurations can support loads in excess of 250 pounds (113kg) if properly installed, complying with accessible design (including ADAAG in the U.S.A.) for structural strength.

Safety Warning: Grab bars are no stronger than the anchors and walls to which they are attached and, therefore, must be firmly secured in order to support the loads for which they are intended. To avoid potential injury, the building owner or maintenance personnel should remove the grab bar from service if the grab bar is not adequately secured to wall or if there is any observed damage to the welds.

INSTALLATION:

Provide concealed anchor device or backing as specified or required in accordance with local building codes before wall is finished. Fasten concealed mounting flanges to anchor device or backing with at least two screws opposing each other in each flange. Snap flange covers over each mounting flange to conceal mounting screws. Concealed anchor devices and mounting screws are not included with Bobrick grab bars and must be specified as an accessory.

For Grab Bars with an Intermediate Flange(s), Pull Snap-Flange Covers away from mounting flanges. Place grab bar in desired mounting location. Use intermediate flange as a template to mark location of mounting screws at intermediate flange only. Mark screw locations at the center of the slot in the middle of the double-keyhole shaped mounting holes (2) in the intermediate flange. Remove grab bar from wall. Drive the intermediate flange mounting screws into wall at marked locations. **Note:** Make sure to leave a space of just over 1/8" (3.17mm) between the underside of the screw head and the wall. Install grab bar on the wall by placing the round ends of the intermediate flange double-keyhole shaped mounting holes over the mounting screws (2) are located in the middle of the flange slots. Install the mounting screws into the wall at the end flanges and secure tightly. Tighten the mounting screws at the intermediate flange. Press all snap-flange covers into place to conceal mounting flanges.

Note: Recommend use of 1/4" or #14 sheet metal or wood screws to install Intermediate Flange. #12 screws may also be used.

Important Notes:

1. **Mounting Kits** — Bobrick offers a mounting kit for installing grab bars; one Bobrick mounting kit is required for each flange.

Mounting Kit No.	Description
252-30	Consists of # (3) 14 x 2½" type-304 stainless steel, Phillips round-head, sheet-metal screws.

2. **Grab Bar Fastener** — Bobrick offers a grab bar fastening system that secures all Bobrick grab bar series; one Bobrick fastener is required for each flange. Install grab bar without backing in wall requires minimum 5/8" (16mm) thick painted or tiled drywall.

WingIt™ Fastener No.	Description
251-4	Consists of 10–32 x 5/16" round-head, Phillips 18/8 stainless steel screws. (1) WingIt grab bar fastener.

3. **Optional Anchor Device** — Bobrick grab bar anchor device includes stainless steel machine screws to be used for attaching grab bars to anchors. one Bobrick concealed anchor device is required for each flange.

Optional Anchor No.	Description
2583	Anchor for 3/4" to 1" (19-25mm) panel 1 anchor required for each flange.
2586	Anchor for 1/2" to 1" (13mm) panel 1 anchor required for each flange.

SPECIFICATION:

Grab bar shall be type-304 stainless steel with satin-finish, slip-resistant surface. Grab bar shall have 18-gauge (1.2mm) wall thickness and 1-1/2" (38mm) outside diameter. Clearance between the grab bar and wall shall be 1-1/2" (38mm). Concealed mounting flanges shall be 11-gauge (3.2mm) thick stainless steel plate, 2" x 3-1/8" (50 x 80mm), and equipped with at least two screw holes for attachment to wall. Flange covers shall be 22 gauge (0.8mm), 3-1/4" (85mm) diameter x 1/2" (13mm) deep, and shall snap over mounting flange to conceal mounting screws and/or WingIt fasteners. Ends of grab bar shall pass through concealed mounting flanges and be heliarc welded to form one structural unit. Grab bar shall comply with accessible design (including ADAAG in the U.S.A.) for structural strength.

Grab Bar shall be Model _____ (insert model number) of Bobrick Washroom Equipment, Inc., Clifton Park, New York; Jackson, Tennessee; Los Angeles, California; Bobrick Washroom Equipment Company, Scarborough, Ontario; Bobrick Washroom Equipment Pty. Ltd., Australia; and Bobrick Washroom Equipment Limited, United Kingdom.

BOBRICK
Technical Data

**1½" (38mm) DIAMETER
STAINLESS STEEL GRAB
BARS WITH SNAP FLANGE**

**B-6806
SERIES**

Specify Finish Required:

- ☐ Satin-finish, slip-resistant surface
☐ Peened surface; add suffix .99 to model number

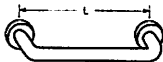
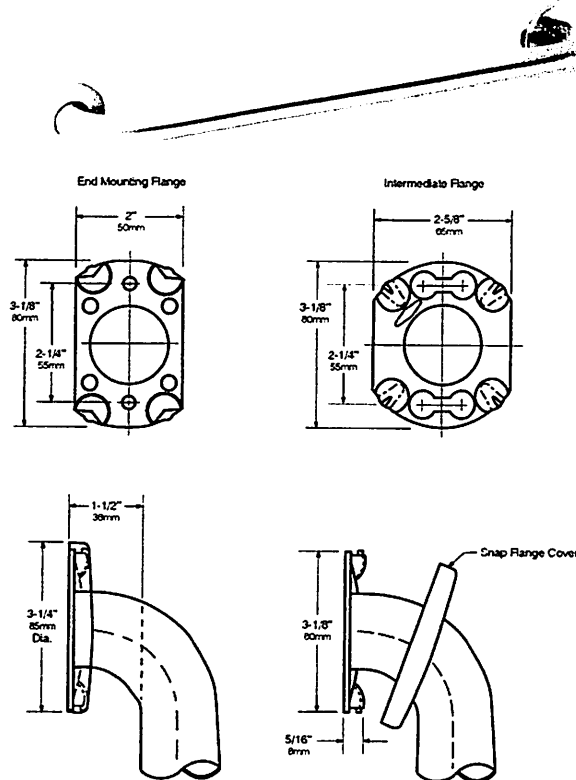

HORIZONTAL

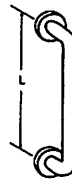

VERTICAL

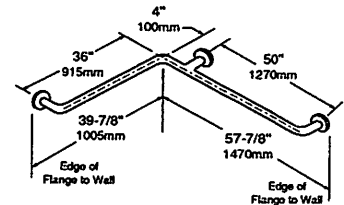

**TWO-WALL WHEELCHAIR
COMPARTMENT**

B-6806 x 12, 18, 24, 30, 36, 42, 48

B-68137

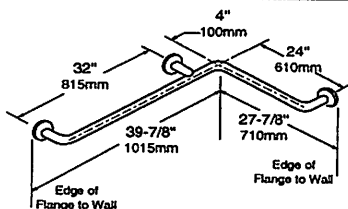

**HORIZONTAL TUB / SHOWER
COMPARTMENT BAR 24 x 36**

B-68616

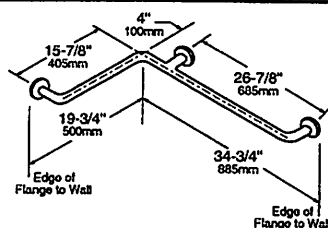

**HORIZONTAL TWO-WALL BAR
for Shower Stall**

B-6861

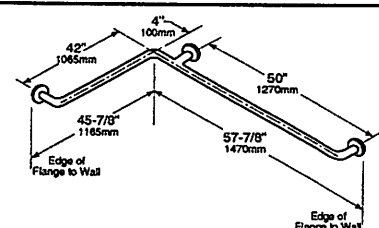

**TWO-WALL
TOILET COMPARTMENT BAR 42 x 54**

B-6897

continued . . .

MATERIALS:

Grab Bar — 18-8 S, type-304, 18-gauge (1.2mm) stainless steel tubing with satin-finish, slip-resistant surface. 1-1/2" (38mm) outside diameter. Ends are heliarc welded to flanges. Clearance between the grab bar and wall is 1-1/2" (38mm).

Concealed Mounting Flanges — 18-8 S, type-304, 11-gauge (3.2mm) thick, stainless steel plate; end flanges 2" x 3-1/8" (50 x 80mm) with holes for attachment to wall. Intermediate flanges 2-5/8" x 3-1/8" (65 x 80mm) wide x 3-1/8" (80mm) diameter.

Snap Flange Covers — 18-8 S, type-304, 22-gauge (0.8mm) drawn stainless steel with satin-finish. 3-1/4" (85mm) diameter x 1/2" (13mm) deep. Each cover snaps over mounting flange to conceal mounting screws.

STRENGTH:

Bobrick grab bars that provide 1-1/2" (38mm) clearance from wall can support loads in excess of 900 pounds (408kg) if properly installed. Other grab bar configurations can support loads in excess of 250 pounds (113kg) if properly installed, complying with accessible design (including ADAAG in the U.S.A.) for structural strength

Safety Warning: Grab bars are no stronger than the anchors and walls to which they are attached and, therefore, must be firmly secured in order to support the loads for which they are intended. To avoid potential injury, the building owner or maintenance personnel should remove the grab bar from service if the grab bar is not adequately secured to wall or if there is any observed damage to the welds.

INSTALLATION:

Provide concealed anchor device or backing as specified or required in accordance with local building codes before wall is finished. Fasten concealed mounting flanges to anchor device or backing with at least two screws opposing each other in each flange. Snap flange covers over each mounting flange to conceal mounting screws. Concealed anchor devices and mounting screws are not included with Bobrick grab bars and must be specified as an accessory.

For Grab Bars with an Intermediate Flange(s), Pull Snap-Flange Covers away from mounting flanges. Place grab bar in desired mounting location. Use intermediate flange as a template to mark location of mounting screws at intermediate flange only. Mark screw locations at the center of the slot in the middle of the double-keyhole shaped mounting holes (2) in the intermediate flange. Remove grab bar from wall. Drive the intermediate flange mounting screws into wall at marked locations. **Note:** Make sure to leave a space of just over 1/8" (3.17mm) between the underside of the screw head and the wall. Install grab bar on the wall by placing the round ends of the intermediate flange double-keyhole shaped mounting holes over the mounting screws (2) are located in the middle of the flange slots. Install the mounting screws into the wall at the end flanges and secure tightly. Tighten the mounting screws at the intermediate flange. Press all snap-flange covers into place to conceal mounting flanges.

Note: Recommend use of 1/4" or #14 sheet metal or wood screws to install Intermediate Flange. #12 screws may also be used.

Important Notes:

1. **Mounting Kits** — Bobrick offers a mounting kit for installing grab bars; one Bobrick mounting kit is required for each flange.

Mounting Kit No.	Description
252-30	Consists of # (3) 14 x 2½" type-304 stainless steel, Phillips round-head, sheet-metal screws.

2. **Grab Bar Fastener** — Bobrick offers a grab bar fastening system that secures all Bobrick grab bar series; one Bobrick fastener is required for each flange. Install grab bar without backing in wall requires minimum 5/8" (16mm) thick painted or tiled drywall.

WingIt™ Fastener No.	Description
251-4	Consists of 10–32 x 5/16" round-head, Phillips 18/8 stainless steel screws. (1) WingIt grab bar fastener.

3. **Optional Anchor Device** — Bobrick grab bar anchor device includes stainless steel machine screws to be used for attaching grab bars to anchors. one Bobrick concealed anchor device is required for each flange.

Optional Anchor No.	Description
2583	Anchor for 3/4" to 1" (19-25mm) panel 1 anchor required for each flange.
2586	Anchor for 1/2" to 1" (13mm) panel 1 anchor required for each flange.

SPECIFICATION:

Grab bar shall be type-304 stainless steel with satin-finish, slip-resistant surface. Grab bar shall have 18-gauge (1.2mm) wall thickness and 1-1/2" (38mm) outside diameter. Clearance between the grab bar and wall shall be 1-1/2" (38mm). Concealed mounting flanges shall be 11-gauge (3.2mm) thick stainless steel plate, 2" x 3-1/8" (50 x 80mm), and equipped with at least two screw holes for attachment to wall. Flange covers shall be 22 gauge (0.8mm), 3-1/4" (85mm) diameter x 1/2" (13mm) deep, and shall snap over mounting flange to conceal mounting screws and/or WingIt fasteners. Ends of grab bar shall pass through concealed mounting flanges and be heliarc welded to form one structural unit. Grab bar shall comply with accessible design (including ADAAG in the U.S.A.) for structural strength.

Grab Bar shall be Model _____ (insert model number) of Bobrick Washroom Equipment, Inc., Clifton Park, New York; Jackson, Tennessee; Los Angeles, California; Bobrick Washroom Equipment Company, Scarborough, Ontario; Bobrick Washroom Equipment Pty. Ltd., Australia; and Bobrick Washroom Equipment Limited, United Kingdom.

BOBRICK

Technical Data

ConturaSeries® SURFACE-MOUNTED SANITARY NAPKIN DISPOSAL

B-270

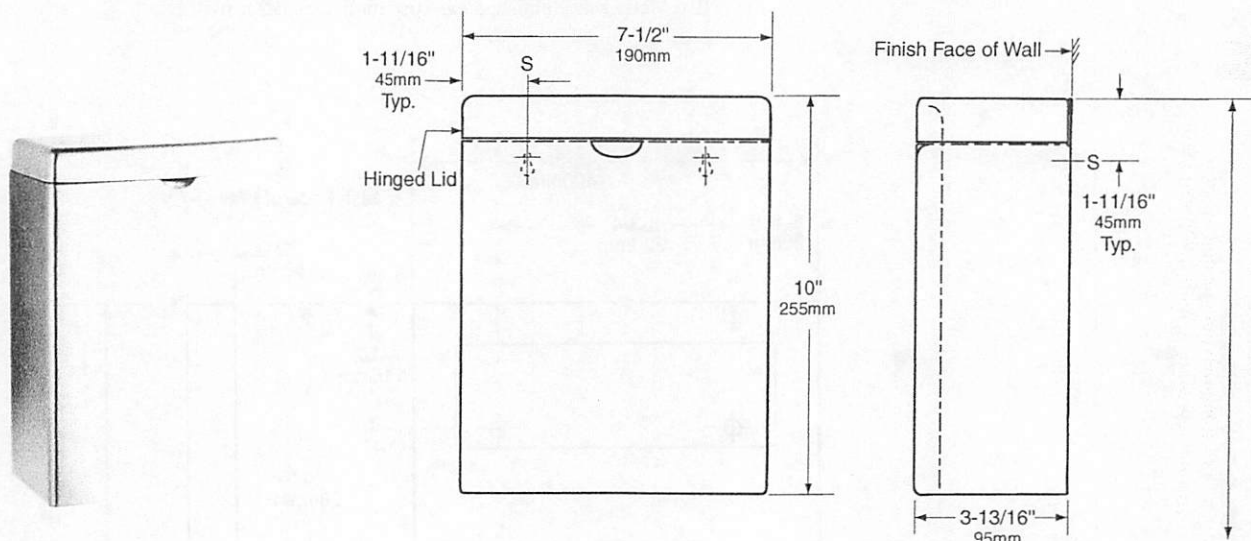
**MATERIALS:**

Container — 18-8, type-304, 22-gauge (0.8mm) stainless steel. All-welded construction. Exposed surfaces have satin finish. Integral finger depression for opening cover. Front of container has same degree of arc as front of cover and other Bobrick ConturaSeries washroom accessories. Radius on side edges of container match corners and edges of cover and other ConturaSeries accessories.

Cover — 18-8, type-304, 22-gauge (0.8mm) stainless steel with satin finish. Drawn, one-piece, seamless construction. Front of cover has same degree of arc as front of container and other Bobrick Contura Series washroom accessories. Radius on corners and edges of cover match side edges of container and other Contura Series accessories. Secured to container with a full-length stainless steel piano-hinge.

OPERATION:

Cover flips up for disposal of sanitary napkins and for servicing container.

INSTALLATION:

For partitions with particle-board or other solid core, secure with two #8 x 3/4" (4.2 x 19mm) sheet-metal screws (not furnished) at all points indicated by an S, or provide through-bolts, nuts, and washers.

For hollow-core metal partitions, provide solid backing into which sheet-metal screws can be secured. If two units are installed back-to-back, then provide threaded sleeves and machine screws for the full thickness of partition.

For masonry walls, provide fiber plugs or expansion shields for use with sheet-metal screws, or provide 3/16" (5mm) toggle bolts or expansion bolts.

For plaster or dry wall construction, provide concealed backing to comply with local building codes, then secure unit with sheet-metal screws.

SPECIFICATION:

Surface-mounted sanitary napkin disposal shall be type-304 stainless steel with all-welded construction; exposed surfaces shall have satin finish. Front of sanitary napkin disposal shall have same degree of arc and match other Bobrick ConturaSeries accessories in the washroom. Radius on corners and edges of sanitary napkin disposal shall complement other Bobrick ConturaSeries washroom accessories. Cover shall be drawn, one-piece, seamless construction and secured to container with a full-length stainless steel piano-hinge. Container shall have integral finger depression for opening cover.

Surface-Mounted Sanitary Napkin Disposal shall be Model B-270 of Bobrick Washroom Equipment, Inc., Clifton Park, New York; Jackson, Tennessee; Los Angeles, California; Bobrick Washroom Equipment Company, Scarborough, Ontario; Bobrick Washroom Equipment Pty. Ltd., Australia; and Bobrick Washroom Equipment Limited, United Kingdom.

Specify Finish Required

- ☐ Stainless Steel, Satin Finish
☐ Matte Black Finish, please use model no. B-221.MBLK

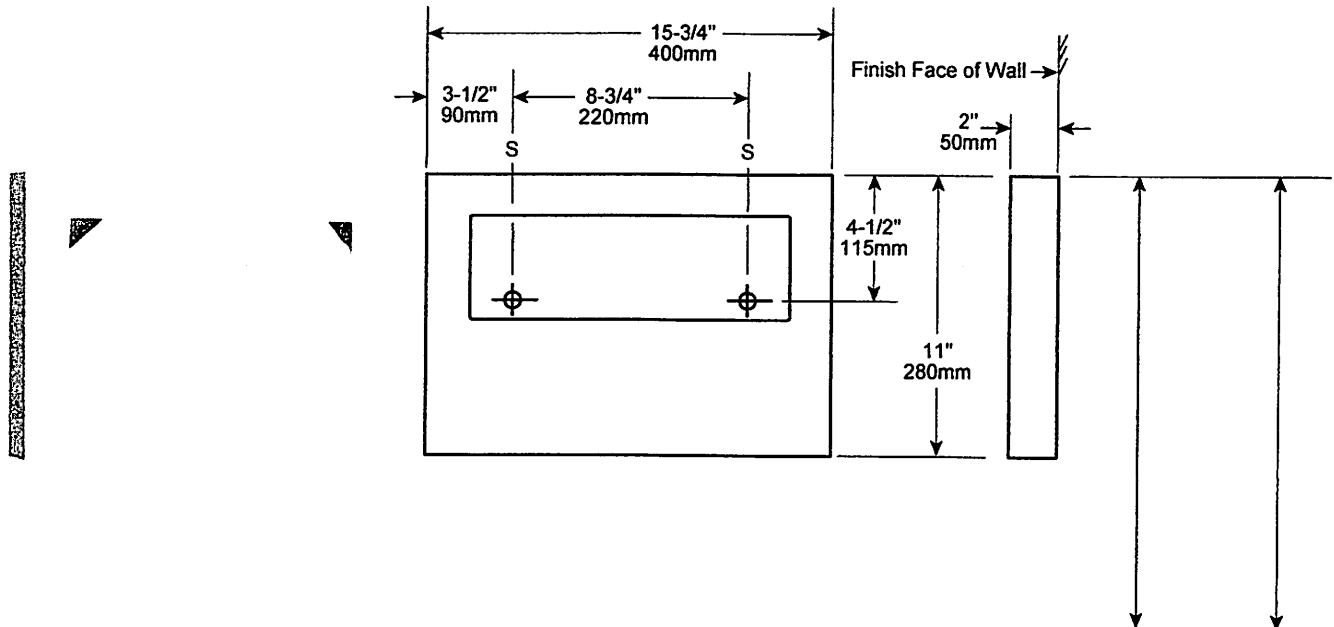

MATERIALS:

18-8, type-304, 22-gauge (0.8mm) stainless steel with satin finish. All-welded construction with beveled opening.

OPERATION:

Dispenses single- or half-fold paper toilet seat covers from beveled opening. Dispenser fills from bottom through concealed opening. Capacity: 250 toilet seat covers or one box.

INSTALLATION:

Mount unit on wall or toilet partition with two flat-head screws, not furnished by manufacturer, at points indicated by an S. For plaster or dry wall construction, provide concealed backing that complies with local building codes, then secure unit with flat-head screws not furnished. For other wall surfaces, provide fiber plugs or expansion shields for use with screws, not furnished, or provide 1/8" (3mm) toggle bolts or expansion bolts.

Note: Provide a 5" (125mm) minimum clearance from bottom of dispenser to top of any horizontal projection to provide room for filling dispenser from bottom.

SPECIFICATION:

Surface-mounted toilet-seat-cover dispenser shall be type-304, 22-gauge (0.8mm) stainless steel with all-welded construction; exposed surfaces shall have satin finish. Dispenser shall have a concealed opening in bottom for filling. Capacity shall be 250 paper toilet seat covers or one box.

Surface-Mounted Seat-Cover Dispenser shall be Model B-221 of Bobrick Washroom Equipment, Inc., Clifton Park, New York; Jackson, Tennessee; Los Angeles, California; Bobrick Washroom Equipment Company, Scarborough, Ontario; Bobrick Washroom Equipment Pty. Ltd., Australia; and Bobrick Washroom Equipment Limited, United Kingdom.

BOBRICK

Technical Data

ClassicSeries® SURFACE-MOUNTED SOAP DISPENSER

B-2112

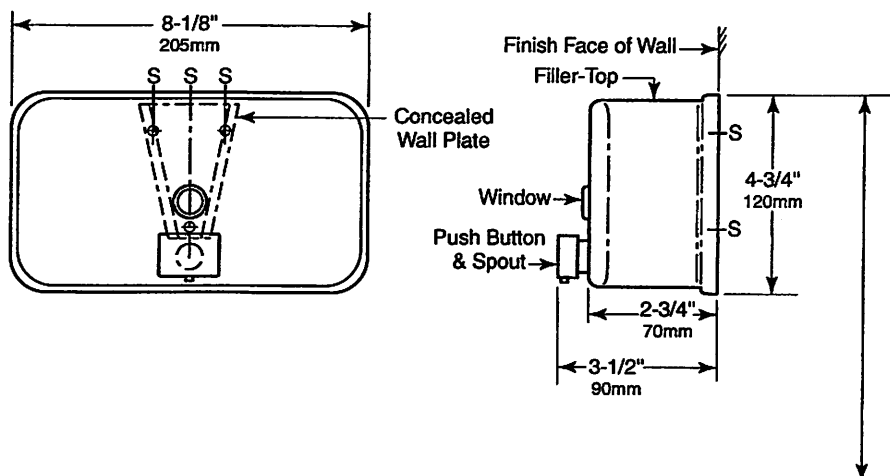
**MATERIALS:**

Container — 18-8, Type-304, 22-gauge (0.8mm) stainless steel with satin-finish. Body is drawn, one-piece, seamless construction. Back plate has mounting bracket attached. Furnished with concealed wall plate. Equipped with a clear acrylic soap refill-indicator window and a locked, hinged stainless steel lid for top filling. Capacity: 40-fl oz (1.2-L).

Valve — Black molded plastic push button and spout. Soap head-holding mushroom valve. Stainless steel spring. U-packing seal and duckbill. Antibacterial-soap-resistant plastic cylinder.

OPERATION:

Corrosion-resistant valve dispenses commercially marketed all-purpose hand soaps. To prevent corrosion of the tank, use only chloride-free pH-neutral liquid soaps. Valve is operable with one hand, without tight grasping, pinching, or twisting of the wrist, and with less than 5 pounds of force (22.2 N) to comply with accessible design guidelines (including ADAAG in U.S.A.). Window indicates when refill is required. The locked, hinged lid opens for top filling only with special key provided. Concealed, vandal-resistant mounting.

INSTALLATION:

Secure wall plate to the wall with three sheet-metal screws, furnished by manufacturer, at points indicated by an S. Slide mounting bracket of container down onto wall plate and secure unit with furnished locking-screw. For plaster or dry wall construction, provide concealed backing to comply with local building codes and secure with sheet-metal screws furnished. For other wall surfaces, provide fiber plugs or expansion shields for use with sheet-metal screws furnished, or provide 1/8" (3mm) toggle bolts or expansion bolts.

Note: Surface-mount the dispenser plumb and true with valve 6" (150mm) to right or left of lavatory center. Provide 4" (100mm) minimum clearance from the lid to the underside of any horizontal projection. Push buttons should be located 44" (1120mm) maximum above the finish floor.

SPECIFICATION:

Surface-mounted soap dispenser shall be Type-304 stainless steel with satin-finish. Corrosion-resistant valve shall dispense commercially marketed all-purpose hand soaps, non-iodine based soaps and do not use alcohol based sanitizers. To prevent corrosion of the tank, use only chloride-free pH-neutral liquid soaps. Valve shall be operable with one hand and with less than 5 pounds of force (22.2 N) to comply with accessible design guidelines (including ADAAG in U.S.A.). Container shall be equipped with a clear acrylic soap refill-indicator window; a locked, hinged stainless steel lid for top filling; and shall have a capacity of 40-fl oz (1.2-L). Unit shall have concealed, vandal-resistant mounting.

Surface-Mounted Soap Dispenser shall be Model B-2112 of Bobrick Washroom Equipment, Inc., Clifton Park, New York; Jackson, Tennessee; Los Angeles, California; Bobrick Washroom Equipment Company, Scarborough, Ontario; Bobrick Washroom Equipment Pty. Ltd., Australia; and Bobrick Washroom Equipment Limited, United Kingdom.

BOBRICK

Technical Data

ClassicSeries® SURFACE-MOUNTED PAPER TOWEL DISPENSER

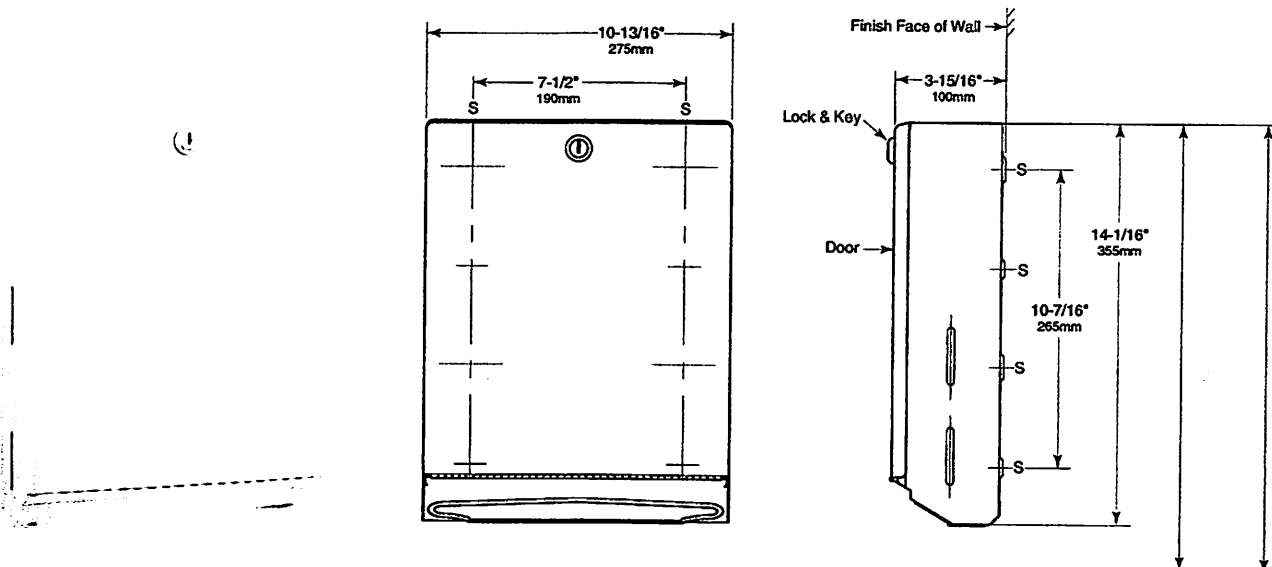
B-262**MATERIALS:**

Cabinet — 18-8, type-304, 22-gauge (0.8mm) stainless steel. All-welded construction. Exposed surfaces have satin finish. Towel tray has hemmed opening to dispense paper towels without tearing.

Door — 18-8, type-304, 22-gauge (0.8mm) stainless steel with satin finish. Secured to cabinet with a full-length stainless steel piano-hinge. Equipped with a tumbler lock keyed like other Bobrick washroom accessories.

Optional: Order Bobrick Part No. 262-130 TowelMate® available as an optional accessory. TowelMate accessory allows for paper towels to dispense one at a time without bulging, sagging or falling through the towel tray opening. TowelMate fits Gamco and most manufacturers' similar models.

OPERATION:

Unit dispenses C-fold and multifold paper towels 3-1/8" to 3-13/16" (79–97mm) deep. Slots in sides of cabinet indicate refill time. Capacity: 400 C-fold or 525 multifold paper towels. To dispense narrower towels 2-1/2" to 3-1/8" (64–79mm) deep, order optional TowelMate accessory Bobrick Part No. 262-130.

INSTALLATION:

Mount unit on wall with four #10 x 1-1/4" (4.8 x 32mm) sheet-metal screws (not furnished) at four of the eight mounting holes indicated by an S (top slots and bottom holes preferable). For plaster or dry wall construction, provide concealed backing to comply with local building codes, then secure with sheet-metal screws. For other wall surfaces, provide fiber plugs or expansion shields for use with sheet-metal screws, or provide 1/8" (3mm) toggle bolts or expansion bolts.

SPECIFICATION:

Surface-mounted paper towel dispenser shall be type-304 stainless steel with all-welded construction; exposed surfaces shall have satin finish. Door shall be secured to cabinet with a full-length stainless steel piano-hinge and equipped with a tumbler lock keyed like other Bobrick washroom accessories. Paper towel tray shall have hemmed opening to dispense paper towels without tearing. Unit shall be capable of dispensing 400 C-fold or 525 multifold paper towels measuring 3-1/8" to 3-13/16" (79 to 97mm) deep. Narrower paper towels 2-1/2" to 3-1/8" (65 to 79mm) deep may be efficiently dispensed with the use of an optional TowelMate accessory, Bobrick Part No. 262-130. TowelMate accessory allows for paper towels to dispense one at a time without bulging, sagging or falling through the towel tray opening.

Surface-Mounted Paper Towel Dispenser shall be Model B-262 of Bobrick Washroom Equipment, Inc., Clifton Park, New York; Jackson, Tennessee; Los Angeles, California; Bobrick Washroom Equipment Company, Scarborough, Ontario; Bobrick Washroom Equipment Pty. Ltd., Australia; and Bobrick Washroom Equipment Limited, United Kingdom.

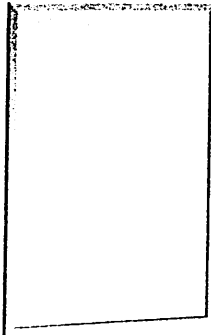

Designer's Notes:

1. Special-order sizes available on request.
2. Maximum size mirror available, 96" x 72" (244 x 183cm); minimum size, 12" x 12" (30 x 30cm).
3. All Bobrick framed mirrors are manufactured to overall width and height dimensions. EXAMPLE: A 24" x 36" (61 x 91cm) mirror will be furnished 24" x 36" (61 x 91cm) outside-of-frame to outside-of-frame.
4. To specify special sizes use Series Number followed by width x height in inches. EXAMPLE: B-165 2024 20" x 24" (51 x 61cm)
5. Bobrick framed mirrors are manufactured to a tolerance 1/8" (3.2mm).
6. For sufficient space to lift mirror onto wall hanger(s), provide 1" (25mm) minimum clearance above top of mirror frame.
7. Provide 1/2" (12.7mm) minimum clearance on each side.

**Snap Locking Design
(Rear View)**

Figure: 1

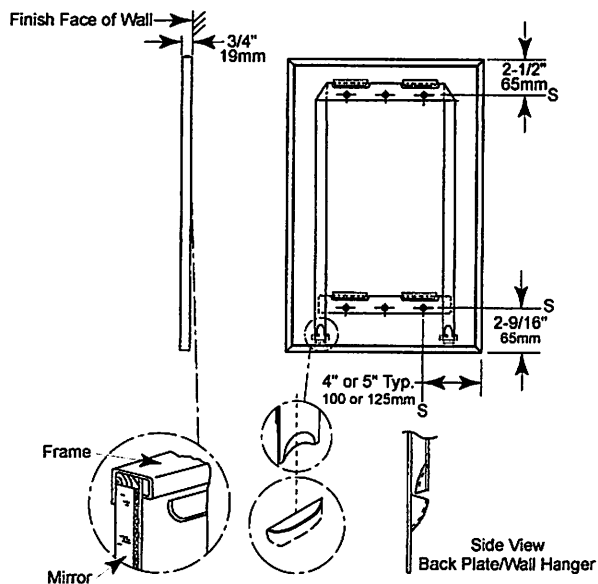

**"2S" Tab Design
(Rear View)**

- for all other mirrors up to a width of 36"

Figure: 2

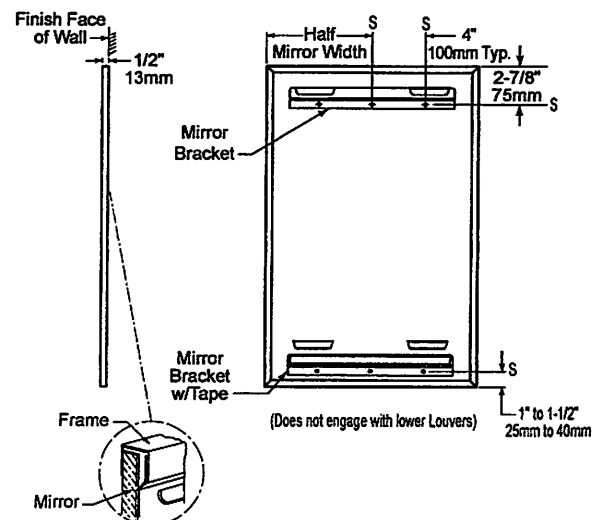

STANDARD B-165 SERIES MIRRORS

MODEL NO.	OVERALL SIZE	
	W	H
B-165 1824	18" (46cm)	24" (61cm)
B-165 1830	18" (46cm)	30" (76cm)
B-165 1836	18" (46cm)	36" (91cm)
B-165 2430	24" (61cm)	30" (76cm)
B-165 2436	24" (61cm)	36" (91cm)
B-165 2448	24" (61cm)	48" (122cm)
B-165 2460	24" (61cm)	60" (152cm)

Note: Mirrors greater than 36" in width will have multiple hanger brackets with a typical 8" off each edge.

continued . . .

MATERIALS:

Frame — Type-430 stainless steel, 1/2" x 1/2" x 3/8" (13 x 13 x 9.5mm) channel with 1/4" (6mm) return at rear for Snap Locking Design; 1/2" x 1/2" x 1/2" (13 x 13 x 13mm) channel for Lock Tab Design, with bright polished finish. One piece frame with 90 degree mitered corners. Galvanized steel back has integral horizontal hanging brackets near the top for hanging the mirror and near the bottom to prevent the bottom of the mirror from pulling away from the wall.

Mirror — No. 1 quality, 1/4" (6mm) select float glass: selected for silvering, electrolytically copper-plated by the galvanic process, and guaranteed for 15 years against silver spoilage. Back is protected by full-size, shock-absorbing, water-resistant, nonabrasive, polyethylene padding.

Concealed Wall Hanger — For snap locking design: Heavy gauge steel construction. Incorporates upper and lower members, which engage backplate louvers to keep mirror against the wall. For "2S"-Tab design: Incorporates upper bracket engaging in upper louver and double sided tape below the bottom louver securing mirror to concealed wall hanger.

INSTALLATION:

Mount wall hanger on wall with screws (not furnished) at points indicated by an S. For plaster or dry wall construction, provide backing to comply with local building codes, then secure wall hanger with screws (not furnished). When providing a concealed backing, allow backing to cover minimum range of mounting hole locations shown on drawing. For other wall surfaces, provide fiber plugs or expansion shields for use with screws (not furnished), or provide 1/8" (3mm) toggle bolts or expansion bolts.

Snap Locking Design: Hang mirror on wall hanger with all four backplate louvers engaged behind horizontal wall hanger members. To do this, mirror must be centered in front of the wall hanger horizontally, pressed flat against the wall approximately 1" (25mm) above final position and then lowered into final position.

"2S" Tab Design: Comprises of two brackets, while the bottom one is furnished with double side tape. Bottom hanger bracket's mounting holes must be 1" - 1 1/2" above mirror's bottom edge. Note: Bottom hanger bracket is not supposed to engage with louvers of mirror's backplate. Hang mirror on wall top hanger bracket with the top two louvers engaged behind top wall hanger bracket. To do this, mirror must be centered in front of the wall hanger horizontally, pressed only at the top against the wall approx. 1" (25mm) above final position and then lowered into final position. When lowering, pull mirror's bottom edge off the wall by preventing bottom bracket from engaging. Once lowered, mirror must be pressed against wall to engage with double sided tape of lower wall hanger bracket.

Snap Locking Design — Locking devices automatically secure mirror to concealed wall hanger when it is lowered into final position (see figure 3). Locking devices may be unlocked by inserting two flat blade screwdrivers behind each side of mirror near the bottom or under the bottom of the mirror and pulling mirror bottom forward and then up.

"2S" Tab Design — Secure mirror to concealed wall hanger by pressing mirror against double sided tape of lower hanger once it is lowered into final position (see figure 4).

**Snap Locking Design
(Front View)**

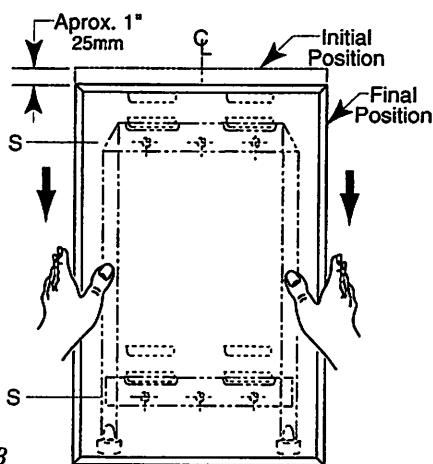

**"2S"-Tab Design - up to 36" Width
(Front View)**

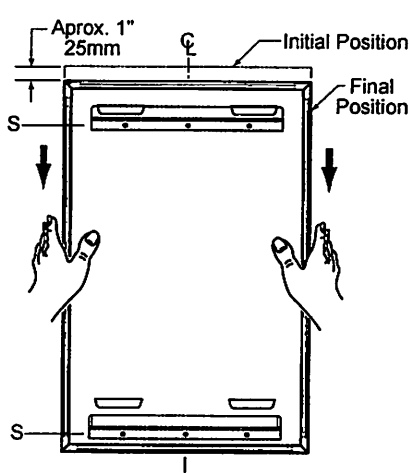

SPECIFICATION:

Mirror shall have a one-piece type-430 stainless steel channel frame, with 90° mitered corners; all exposed surfaces shall have bright polished finish. Select float glass mirror shall be guaranteed for 15 years against silver spoilage. The back shall be protected by full-size, shock-absorbing, water-resistant, nonabrasive, polyethylene padding. Galvanized steel back shall have integral horizontal hanging brackets located at top and bottom for mounting on concealed wall hanger to prevent the mirror from pulling away from the wall. Locking devices secure mirror to concealed wall hanger. Mirror shall be removable from the wall.

Framed Mirror shall be Model B-165 _____ (insert width and height) of Bobrick Washroom Equipment, Inc., Clifton Park, New York; Jackson, Tennessee; Los Angeles, California; Bobrick Washroom Equipment Company, Scarborough, Ontario; Bobrick Washroom Equipment Pty. Ltd., Australia; and Bobrick Washroom Equipment Limited, United Kingdom.

UTILITY SHELF WITH MOP/BROOM HOLDERS AND RAG HOOKS

B-224

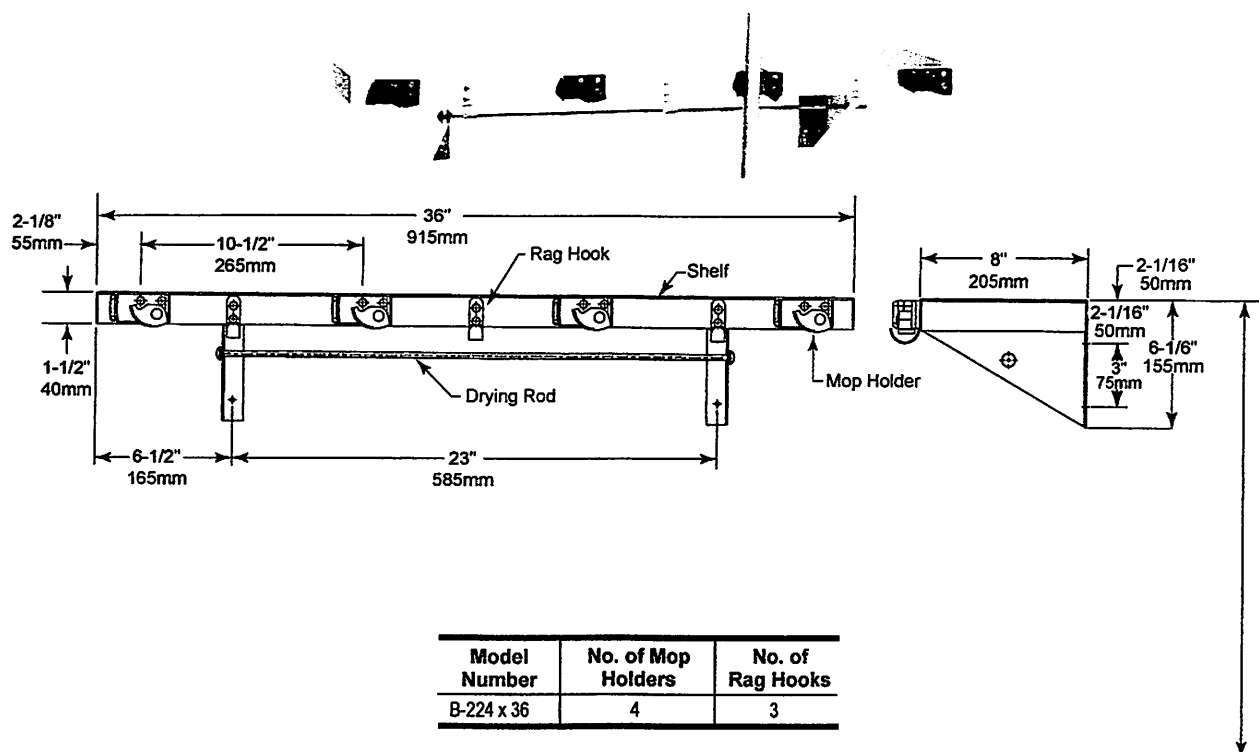

MATERIALS:

Shelf — 18-8, Type 304, 18-gauge (1.2mm) stainless steel with satin finish. Shelf has 1-1/2" (38mm) return edge for maximum rigidity.

Mounting Brackets — 18-8, Type 304, 18-gauge (1.2mm) stainless steel with satin finish; welded to shelf.

Mop/Broom Holders — Spring-loaded rubber cams with anti-slip coating.

Rag Hooks — 18-8, Type 304, 16-gauge (1.6mm) stainless steel with satin finish; secured to shelf with rivets.

Drying Rod — 18-8, Type 304, 1/4" (6mm) diameter stainless steel with satin finish.

OPERATION:

Surface-mounted utility shelf with holders is designed to keep mops and brooms away from wall. Spring-loaded rubber cam holders accommodate mop or broom handles from 7/8" to 1-1/4" (22-32mm) diameter. Hooks for conveniently storing rags are located on front of shelf. Rod for hanging wet rags is located below shelf between mounting brackets.

INSTALLATION:

Secure unit to wall with four sheet-metal screws, furnished by manufacturer, at points indicated by an S. For plaster or dry wall construction, provide concealed backing to comply with local building codes, then secure unit with sheet-metal screws furnished. For other wall surfaces, provide fiber plugs or expansion shields for use with sheet-metal screws furnished, or provide 1/8" (3mm) toggle bolts or expansion bolts.

SPECIFICATION:

Surface-mounted utility shelf with mop/broom holders and rag hooks shall be Type 304 stainless steel with satin finish. Shelf shall be 18 gauge (1.2mm) with 1-1/2" (38mm) return edge. Mounting brackets, welded to shelf, shall be 18 gauge (1.2mm).

Utility Shelf With Mop/Broom Holders And Rag Hooks shall be Model 224x36 of Bobrick Washroom Equipment, Inc., Clifton Park, New York; Jackson, Tennessee; Los Angeles, California; Bobrick Washroom Equipment Company, Scarborough, Ontario; Bobrick Washroom Equipment Pty. Ltd., Australia; and Bobrick Washroom Equipment Limited, United Kingdom.

SPRING CITY HERITAGE PARK

Summer/Fall 2023

The Ask:

To begin the beautification and improvement of this Main Street gathering area and focal point of town heritage for locals and visitors to enjoy.

The Canal Creek Daughters of Utah Pioneers have raised \$2,000.00 to put toward the Spring City Heritage Park located off Main Street behind the Old City Hall DUP Museum and the Old Firehouse. Our ask is for the Spring City Corporation to match funds utilizing a credit from the Shad Hardy cement company and to cover any nominal fees above the estimate in this proposal.

We are seeking these funds to build out the following.

Current Project:

SIDEWALK: See attached drawing. As of now visitors are finding it difficult to walk out to the back of this area without the stress of tripping. We have a children's museum set up as an old jail and schoolroom. Many families with members of all ages come to experience this museum and the ease of the sidewalk getting back there would make it safer for everyone. This sidewalk would go the perimeter of the park and eventually used as a Spring City history educational pathway.

HANDRAIL: ADA handrail and possible ramp leading up the steps to the old jail is necessary. The handrail could be made of wood or iron. Do any City employees know how to weld? Is there scrap pipe in the yard?

LAMP POST: To be installed in the center of the area with a cement skirt around the base. Kent Kummer has had this lamp post set aside for this purpose.

BACK ALLEYWAY: Included in this year's project would be to edge and gravel the back alley which leads from Center Street to the back of this park.

TIME FRAME: To begin project after electrical work in this area is completed for Spring City sometime at the beginning of August. Project to be finished by the end of September.

- Total sidewalk space 350 feet long x 4 feet wide.
- 2 inches of road base with 4-inch-deep cement.

Shad Hardy (702) 277-8511

- Spring City has a credit with him for \$2,100.00 which was prepaid a few years ago. The City used some of the credit but didn't have any projects to use the rest.
- He thinks we would need just under 18 yards/\$195 per yard of cement for given measurements. This will depend on how well the sidewalk area was prepared with the road base. If ends up deeper in some places could use more cement.
- \$3,510 total for cement.
- No tax/No travel charge
- Advises to do it in 3 pour stages. No extra charge to come back.

Christensen Ready Mix (435) 462-3228 - Talk to "Speedy"

- Quote on 20 yards of cement. This accounts for dips of thickness on prepared area. (Believes it will take this amount.)
- \$200/yard
- \$4,000 total
- \$25 fuel charge for each delivery
- No tax with City tax exempt number (Believes it's already in the system.)

American Eagle Ready Mix (801) 438-8490 - Waiting for response.

Altaview Concrete (435) 462-2058 - Waiting for response.

- Sidewalk Consultant - Kent Kummer
- Sod cutter - Daniel King
 - Donated cutter.
 - Donated labor with volunteers.
- Road Base - Joe McGriff
 - \$5.00/ton is Joe's cost at American Eagle normally \$10.00/ton.
 - 11 tons needed (1 truck load)
 - Estimated cost \$55.00
 - Donated labor/tractor work.
- Cement Forms - Spring City has these at the city yard.
- Sidewalk Installation - Volunteers (For the pocket park we had Nic Evans, Doug Fryer, Joe McGriff, Lawrence Gardner, and Brigham Nelson)

- Center Lamppost - Kent Kummer
 - Already wired.
 - Lamp post at City yard.
 - Would work labor into his work schedule.
- Alleyway Gravel - Joe McGriff
 - ½ load or 7 tons at \$14.00 a ton (his cost).
 - Donated delivery/labor and tractor work.
 - Estimated cost \$98.00
- Gravel Alleyway Edging - Daniel King
 - 80 feet long x 9 feet wide
 - \$440 edging materials
 - Labor donated with a couple volunteers.

<u>ESTIMATED COST to City:</u>	Cement:	\$3,510.00 (if 4-inch depth)
	Road Base:	55.00
	Gravel:	98.00
	Alley Edging:	<u>440.00</u>
	Subtotal:	\$4,103.00
If approved (City's credit):	-	<u>2,100.00</u>
		\$2,003.00
Money raised by DUP:	-	<u>2,000.00</u>
	\$	3.00 plus nominal amount over estimation.

Future Projects:

- Kiosks with pictures and written information would be placed around the new walking path each sharing with locals and visitors historical information about Spring City. These could include the history of the railroad, agriculture, sheep herding, water and mills, mulberry trees, the old fort - log cabins, commerce etc. This project could possibly be assisted by Monte Bona with a grant from the Highway Heritage Foundation.
- Water Wheel Fountain. Showing how mills in town used this method. Also, for beautification of park.
- Various Cabins/Outbuildings. Each would showcase the themed antiques we have collected and continue to be given.
- Picnic tables and benches.
- Trees and shrubbery.

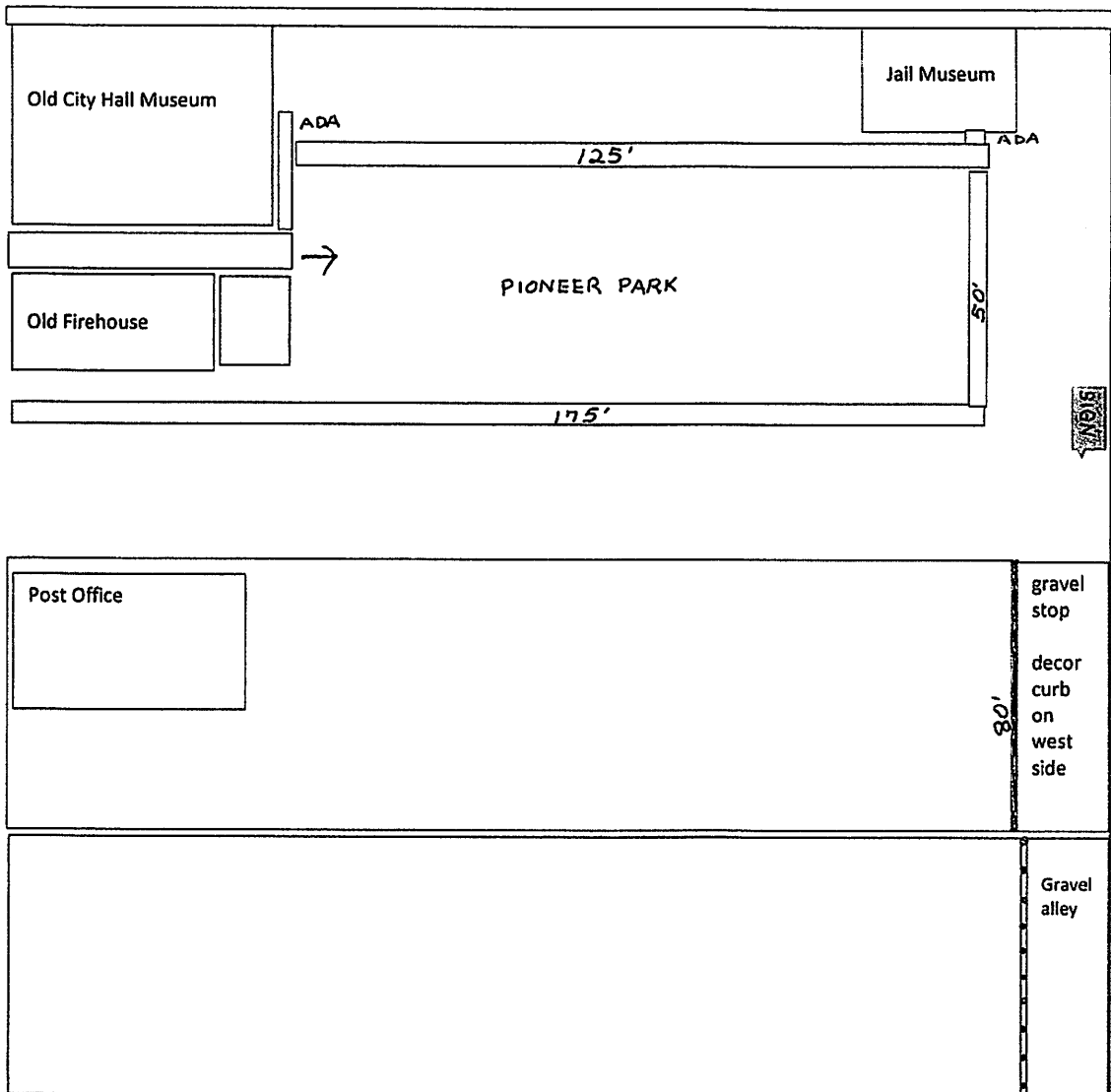

JBM Trailers

Estimate

543 S. State
Mt. Pleasant, UT 84647
(435)462-0266
(435)462-4447 FAX

Date	Estimate #
7/5/2023	07-607

Name / Address			
Spring City 150 E Center St. Spring City, Utah. 84662 462-2244		VIN #	
		58SBD1427NE029407	
Description	Qty	Cost	Total
EAST TX. 83 X 14 X 2' TANDEM AXLE DUMP TRAILER, 2-7K brake axles, (14,000 GVW) 10ply 16" tires & wheels, 2-5/16 adjustable coupler, drop leg jack 10K, skid loader package, spreader gate, 3/16 floor, 5" bore heavy duty scissor hoist with 3250 psi rated power unit with remote control, deep cycle battery, tarp kit, all LED lighting with 7-way plug, Color Black.	1	12,350.00	12,350.00T
spare tire & mount	1	0.00	0.00T
		Subtotal	<i>Jm</i> \$12,350.00
		Sales Tax (0.0%)	\$0.00
		Total	<i>Jm</i> \$12,350.00

Signature _____

White Brothers Trailer Sales

740 North Main
Nephi, UT 84648 US
threebrotherswhite@yahoo.com

INVOICE

BILL TO
Spring City Public Works

SHIP TO
Spring City Public Works

INVOICE 1783
DATE 07/05/2023
TERMS Net 30
DUE DATE 08/04/2023

SERVICE	DESCRIPTION	QTY	RATE	AMOUNT
14' Bumper pull #273915	Vin#16V1D1922P5273915	1	11,800.00	11,800.00
Big Tex Spare		1	200.00	200.00

SUBTOTAL	12,000.00
TAX	0.00
TOTAL	12,000.00
BALANCE DUE	\$12,000.00

Ace Auto & Trailer Sales, LLC
645 N 400 E
Huntington, UT 84528

Estimate

Date 7/5/2023
Estimate # 57

Name / Address

Spring City
Spring City UT

P.O. #

Terms

Due Date 7/5/2023
Other

Description	Qty	Rate	Total
7x14 Walton Dump Trailer standard sides tandem 7k axles	1	12,700.00	12,700.00T
Doc Fee		90.00	90.00T
tarp kit and installation fee	1	300.00	300.00T
Tax Exempt City			
		Subtotal	\$13,090.00
		Sales Tax (0.0%)	\$0.00
		Total	\$13,090.00

Ace Auto & Trailer Sales, LLC
ace7247@etv.net

435-749-1776

From: Patsy Stoddard stoddardpatsy@gmail.com
Subject: dump trailer
Date: Jul 5, 2023 at 12:09:24 PM
To: publicworks@springcityutah.org

I am attaching the quote. The tarp kits went up so the price reflects that. Let me know if you need anything else. If you accept the quote, we could deliver the dump trailer to you.

Let me know what the time frame is if you can.

Thanks,

Patsy
435-749-9025

ESTIMATE

MORLEY LAWN CARE, INC.
PO Box 468
Moroni, UT 84646

morleylawns@gmail.com
+1 (435) 851-4910



Spring City Corporation

Bill to
Spring City Corporation
P.O. Box 189
Spring City, UT 84662

Estimate details
Estimate no.: 1022
Estimate date: 06/26/2023

Product or service

- Equipment**
Husqvarna Lawn Mower
- Equipment**
Kubota Lawn Mower

1 unit x \$9,000.00

1 unit x \$600.00

Total

\$9,600.00

July 6 2023
Paid, Accepted
by owner
Amount
\$9,000.00
C. Hall

To whom it may concern:

June 20, 2023

In reference to the listing on Facebook

"Spring city Corporation currently is offering up for bid a Kubota riding lawnmower. For info please contact Cory Madsen or Mike Black at City Hall 435-462-2244. Bidding opens June 6 and will close June 27 at 4 PM at City Hall please deliver bids to the city office in a sealed envelope. The city reserves the right to accept or reject any or all bids. Please include your name phone number and a bid in the envelope. Mowers are available for public view during office hours."

For consideration and in reference to the Kubota riding lawnmower, which is being offered by sealed bid, I would like to bid the following: \$5201.00

My name is: James Poulson

My phone number is:

My address is:

Thank you for this opportunity.

James Poulson

James Poulson 6/20/2023

*Bid accepted
by Council
July 6 2023
Mike Black*