

West Layton Gymnasium

Layton City Parks and Recreation
City Council Work Meeting Presentation
November 3, 2016

Current Gym Regular Usage

- Adult Volleyball
 - 165 teams
- Boys Jr Jazz Basketball
 - 85 teams
- Competitive Basketball League
 - 120 teams
- Girls Jr Jazz Basketball
 - 21 teams
- Itty Bitty Basketball (K-3rd)
 - 64 teams
- Men's Basketball League
 - 18 teams
- Youth Volleyball
 - 100 participants
- Monday - Friday
 - 5:30pm-11:30pm
- Saturday
 - 8:00am – 11:00pm

Special Event Usage

- Layton City Comp Basketball Holiday Tournament
 - 16 teams
- Coast 2 Coast Preps ‘The League’ Tournament
 - 56 teams (Fl, Tx, Co, Wa, Ca, Nv, Ok, Il, Id, La)
 - Nationally ranked youth basketball teams
 - www.coast2coastpreps.com

UTAH ELITE & COAST 2 COAST PREPS
PRESENTS

THE LEAGUE UTAH

BASKETBALL TOURNAMENT
DATE JAN 28 29 2017

BOYS GRADES 3RD - 8TH
\$400.00 PER TEAM ENTRY FEE 3 GAME GUARANTEE
NATIONALLY RANKED TEAMS

REGISTER
REGISTER@UTAHHELITEATHLETICS.COM

CONTACTS
COACH ROSS 801 698 0564
RICKY COAST2COASTPREPS 213 842 4296

MEDIA COVERAGE
COAST 2 COAST PREPS
TAKE MY TALENT.COM
PREMIER BALL
WEST SIDE HOOPS TV
MEDIA WRITELPS ON PLAYER AND TOURNAMENTS

SPONSORS

Hampton Inn LAYTON, UT Layton City [Basketball Logo] [DJC Logo] [West Side Hoops Logo] TAKE MY TALENT .com

WHERE THE WEST MEETS THE WORLD

Comparison of Gymnasiums

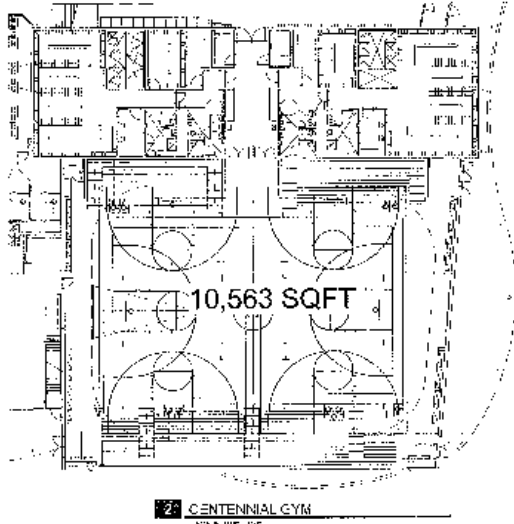
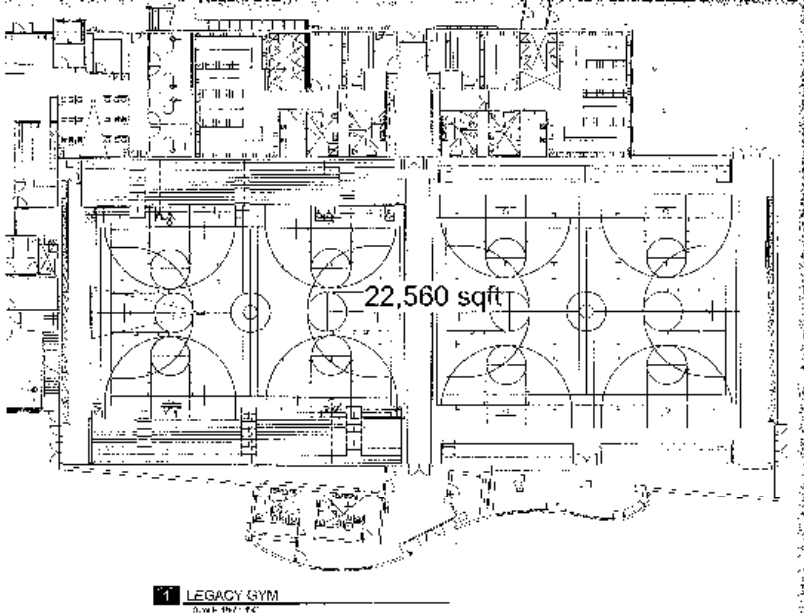
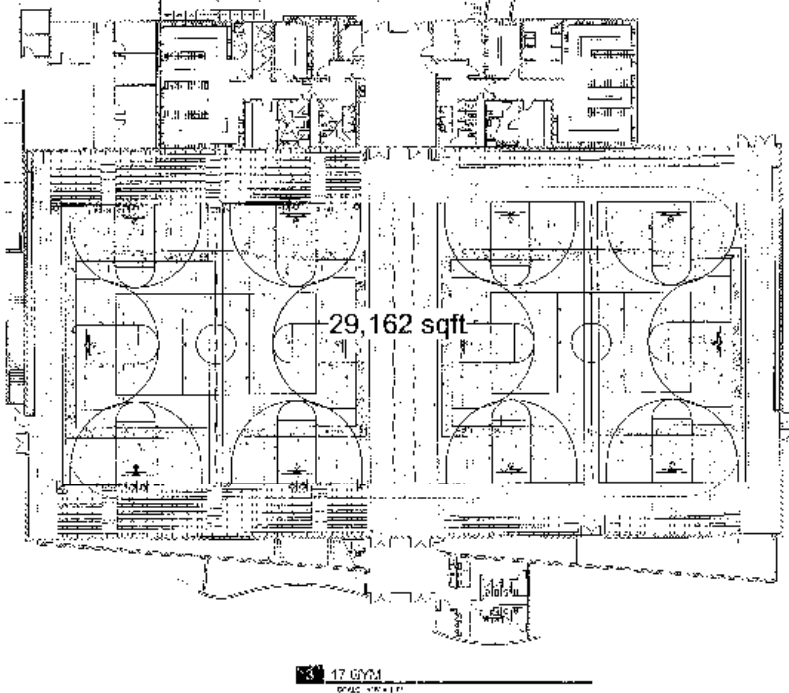

Matching Funding Sheet

RAMP PROJECT BUDGET: EXPENSES

Name of Project:		West Layton Jr High Gymnasium							
		Davis School District's Contribution				Layton City's Contribution			
	Total sqft	Size sqft	\$/sqft	Cost		Size sqft	\$/sqft	Cost	
Gym	27,000	13,500	\$200.00	\$2,700,000.00		13,500	\$200.00	\$2,700,000.00	
Track	9,212	9,212	\$120.00	\$1,105,440.00					
City Facilities	2,021			\$0.00		2021	\$200.00	\$404,200.00	
A/E Fee (6%)		-	-	\$228,326		-	-	\$162,000	
Total				\$4,033,766.40				\$3,266,200.00	
Total Cost for Gymnasium				\$7,299,966.40					
Davis School District				\$4,033,766.40					
Layton City				\$3,266,200.00					
City Funding requests and distribution dates:									
	<u>Requesting</u> <u>Year</u>	<u>RAMP Fund</u>	<u>City General</u> <u>Fund</u>						
	2017/18	\$544,366.67	\$544,366.67						
	2018/19	\$544,366.67	\$544,366.67						
	2019/20	\$544,366.67	\$544,366.67						

Comparison of Facilities

	Population	Size of Facility	Estimated Cost to Construct	Lane Pool	Leisure Pool	Splash Pad	Community Room	Kitchen	Racketball Courts	Meeting Room	Child Care	Locker Room	Cardio Area	Exercise Room (wooden floor)	Exercise Room (sports floor)	Weight Room	Indoor Courts (Basketball)	Indoor Track	Ice Rink
South Weber Family Activity Center	6,500	15,000	\$3,000,000.00														1		
Riverdale Community Center	9,000	18,000	\$3,600,000.00														2		
Farmington City (\$229.00 /SF)	22,566	37,000	\$8,500,000.00														2		
Clearfield Aquatic Center	30,500	84,000	\$16,800,000.00														4		
JL Sorensen Recreation Center (SLCo)	30,835																3		
Bountiful Recreation Center	43,784	180,000	\$27,000,000.00																
Lehi Legacy Center	54,000	96,000	\$19,200,000.00														3		
Layton City (Existing Facilities)	74,143																9		
Provo Recreation Center	116,300	161,200	\$32,240,000.00														4		

* Estimated Cost, is based on a current \$200.00 per square foot cost to construct.

Cost to provide staffing for public use

		Hours AM 5 - 7:30	Hours PM 5 - 10:00	Hours Midday 7:30 - 5
January	6 days a week	60	120	
February	6 days a week	60	120	
March	6 days a week	60	120	
April	6 days a week	60	120	
May	6 days a week	60	120	
June	6 days a week	60	120	228
July	6 days a week	60	120	228
August	6 days a week	60	120	228
September	6 days a week	60	120	
October	6 days a week	60	120	
November	6 days a week	60	120	
December	6 days a week	60	120	
	Sub-total of hours	720	1440	684
	Hourly wage	\$9.00	\$9.00	\$9.00
	Yearly cost per shift	\$6,480.00	\$12,960.00	\$6,156.00
	Estimated cost per year	\$25,596.00		

Program Growth

- Keep up with city growth and corresponding program growth
- Expand recreation programs
 - Futsal
 - Pickleball
- Expand competition program
 - Girls basketball
- Tournaments
 - In-house and co-sponsor with specialty organization
 - volleyball, basketball, pickleball, any indoor activity

Potential Public Use

- Public Hours / Open Hours
 - 5:00am – 7:30am
 - 5:00pm – 10:00pm
 - 7:30 – 5:00 Summers
- Open Courts
 - Basketball
 - Pickleball
 - Volleyball
- New Programs
 - Ballroom dance
 - Adult dodge ball
- Track

A Recreation Coordinators View...

Gymnasium

- Organized Recreation
- Leagues
- Teams
- Tournaments
- Programmed Space

- Many recreation center components do/can fit in a gymnasium.

Recreation Center

- Leisure Recreation
- Non-programmed Space
- Passive Recreation

- Gymnasium components do not fit in a recreation center. If you program recreation center spaces you lose the leisure, passive and openness the patrons sign up for.

Farmington, Utah (37,000 sq.ft. total -27,000 sq.ft. Gym space)





