

FIVE THINGS YOU NEED TO KNOW

April 9, 2024



MIDA Municipal Services Agreement

- *City and MIDA staff met March 25*
- *Updates in the works to certain provisions / language, as well as the rates in Exhibit B*
 - *Flat fee for police services; may include a component for patrol in addition to calls for service*
 - *Businesses located at Falcon Hill will no longer be charged the disproportionate fee when obtaining a business license*
- *City staff will be drafting proposed new language and rates for MIDA's input / review*
 - *Approval in May – June*

Signage Enforcement

- *Prohibited Signage*
- *Temporary Signage*
- *Illegal Signage*
- *Abandoned Signs*

Image of the City







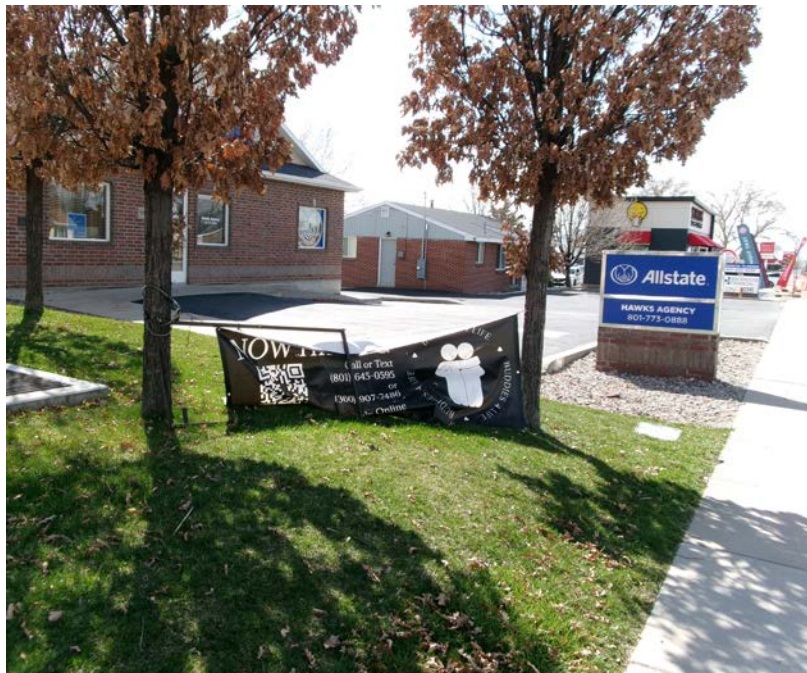



Signage Enforcement

- *Focus on Main Corridors*
 - *Main/State Street*
 - *700 South*
 - *Antelope Drive*
 - *300 North*
 - *1000 East and West*
 - *650 North*

Image of the City



Grant for Transportation Master Plan

- *Awarded Transportation and Land Use Connection grant by WFRC.*
- *Local Match (already in FY24 budget): \$24,000*
- *WFRC funding: \$106,000*
- *Total Project Budget: \$130,000*
- *Awaiting WFRC for the next steps and to solicit the proposals for the plan.*



WASATCH FRONT REGIONAL COUNCIL



TRANSPORTATION
AND
LAND USE CONNECTION



Clearfield High Reimagined

- *Mult-year project to reconstruct and remodel Clearfield High School.*
- *Phase 1 is included in the most recent bond. Future phases will need to be bonded for.*
- *Phase 1 is the Clearfield High Career Center*
 - *Automotive technologies*
 - *Cooking*
 - *Childcare*
 - *Etc.*
- *This will remove existing on-site parking that will not be replaced until future phases.*

Clearfield Career Center – May or June 2024

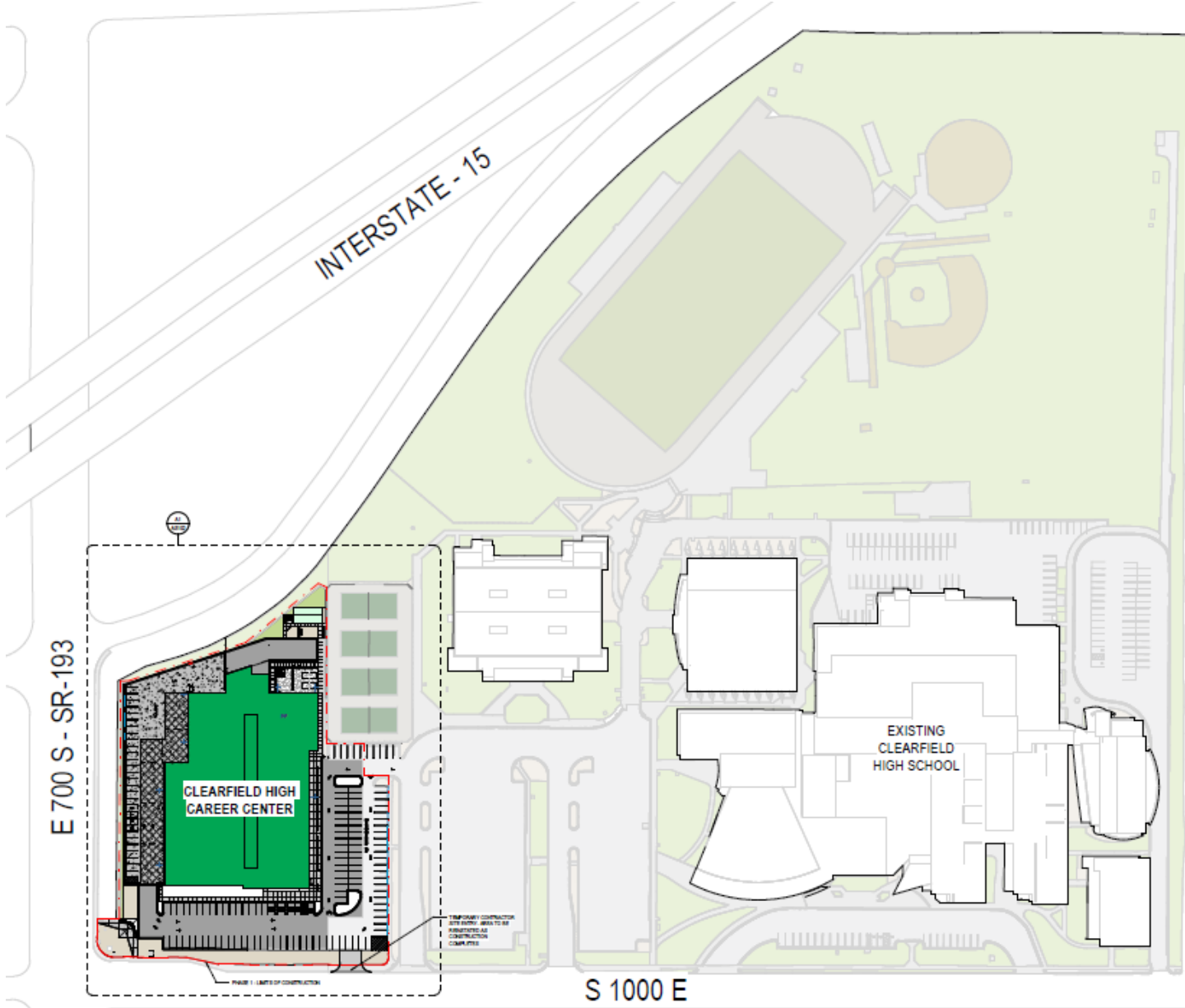

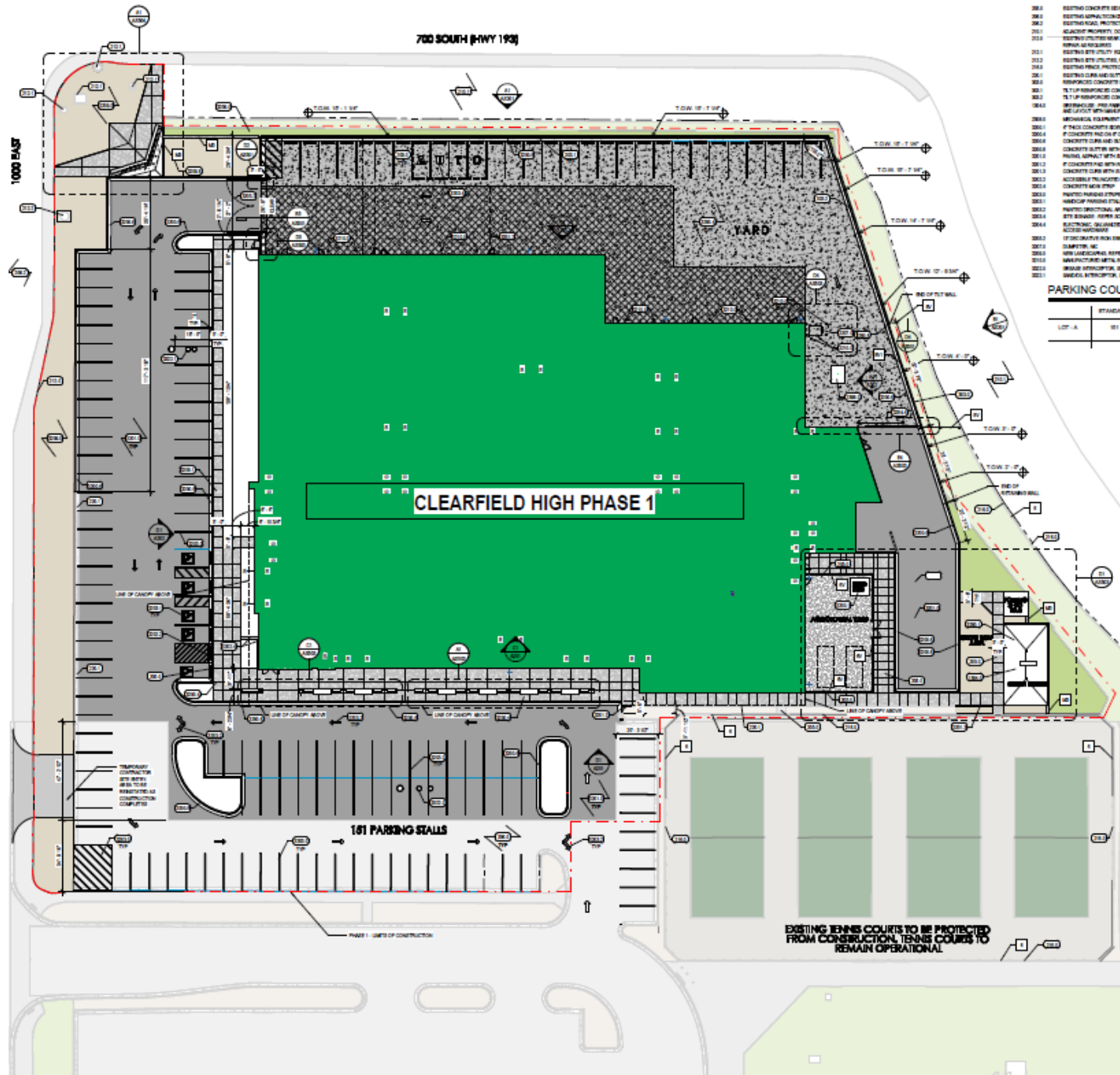

KEYED NOTES

- 300.0 EXISTING CONCRETE SIDEWALK, PROTECT AS NECESSARY, REPAIR AS REQUIRED
- 300.1 EXISTING ASPHALT DRIVE/DRIVE PAVING, PROTECT AS NECESSARY, REPAIR AS REQUIRED
- 300.2 EXISTING ROAD, PROTECT AS NECESSARY, REPAIR AS REQUIRED
- 300.3 ADJACENT PROPERTY, DO NOT DETAIL, PROTECT AS NECESSARY
- 300.4 EXISTING UTILITIES/SEWER AND/OR FIRE/PROPERITY USE, PROTECT AS NECESSARY, REPAIR AS REQUIRED
- 300.5 EXISTING SITE UTILITY EQUIPMENT, PROTECT AS NECESSARY, REPAIR AS REQUIRED
- 300.6 EXISTING SITE UTILITY, PROTECT AS NECESSARY, REPAIR AS REQUIRED
- 300.7 EXISTING FENCE, PROTECT AS NECESSARY, REPAIR AS REQUIRED
- 300.8 EXISTING CURB AND GUTTER, PROTECT AS NECESSARY, REPAIR AS REQUIRED
- 300.9 REINFORCE CONCRETE WALL, ARCHITECTURAL BRACK PILES WHEN SPECIFIED
- 300.10 1/4" OF REINFORCED CONCRETE RETAINING WALL WITH FORMS, SEE PLAN
- 300.11 1/4" OF REINFORCED CONCRETE RETAINING WALL, SEE PLAN
- 300.12 OVERHAUL/REPAIR AND/OR REPLACE, SEE SITE SURVEY/CONCRETE COORDINATE WITH THE CONTRACTOR, OWNER PROVIDED CONTRACTOR DETAIL
- 300.13 MECHANICAL EQUIPMENT
- 300.14 IF THIS CONCRETE SIDEWALK WITH REBAR
- 300.15 IF CONCRETE PAVING CONTRACTOR BASE
- 300.16 CONCRETE CURB AND GUTTER WITH REBAR
- 300.17 CONCRETE GUTTER WITH REBAR
- 300.18 PAVING ADJACENT WITH REBAR
- 300.19 IF CONCRETE AND WITH ADJACENT TANKS ONLY COMPACTED BASE REFER TO CIV.
- 300.20 CONCRETE CURB WITH REBAR
- 300.21 ACCESSIBLE PAVEMENT/CONCRETE CURB
- 300.22 CONCRETE NEW POOP
- 300.23 PAVING/PAVING STOPS AND ACCESS LANE
- 300.24 HANDICAP PARKING STALLS
- 300.25 PAVING/STRUCTURAL SERVICE
- 300.26 SITE SERVICE REFER SCHEDULE
- 300.27 ELECTRIC, SEE ELECTRICAL SCHEDULE FOR ALL OTHERS, AUTOMATED PROVIDE ACCESS AS REQUIRED
- 300.28 IF CONTRACTOR FOR SIGN SITE
- 300.29 SIGNING, SEE
- 300.30 NEW LANDSCAPING REFER TO LANDSCAPING DRAWINGS
- 300.31 UNRETRACTED METAL SIGNS
- 300.32 BRASS IDENTIFICATION, SEE CIV.
- 300.33 SIGNAL IDENTIFICATION, SEE CIV.

PARKING COUNTS

	STANDARD	ADA	TOTAL
LOT 'A'	81	8	158

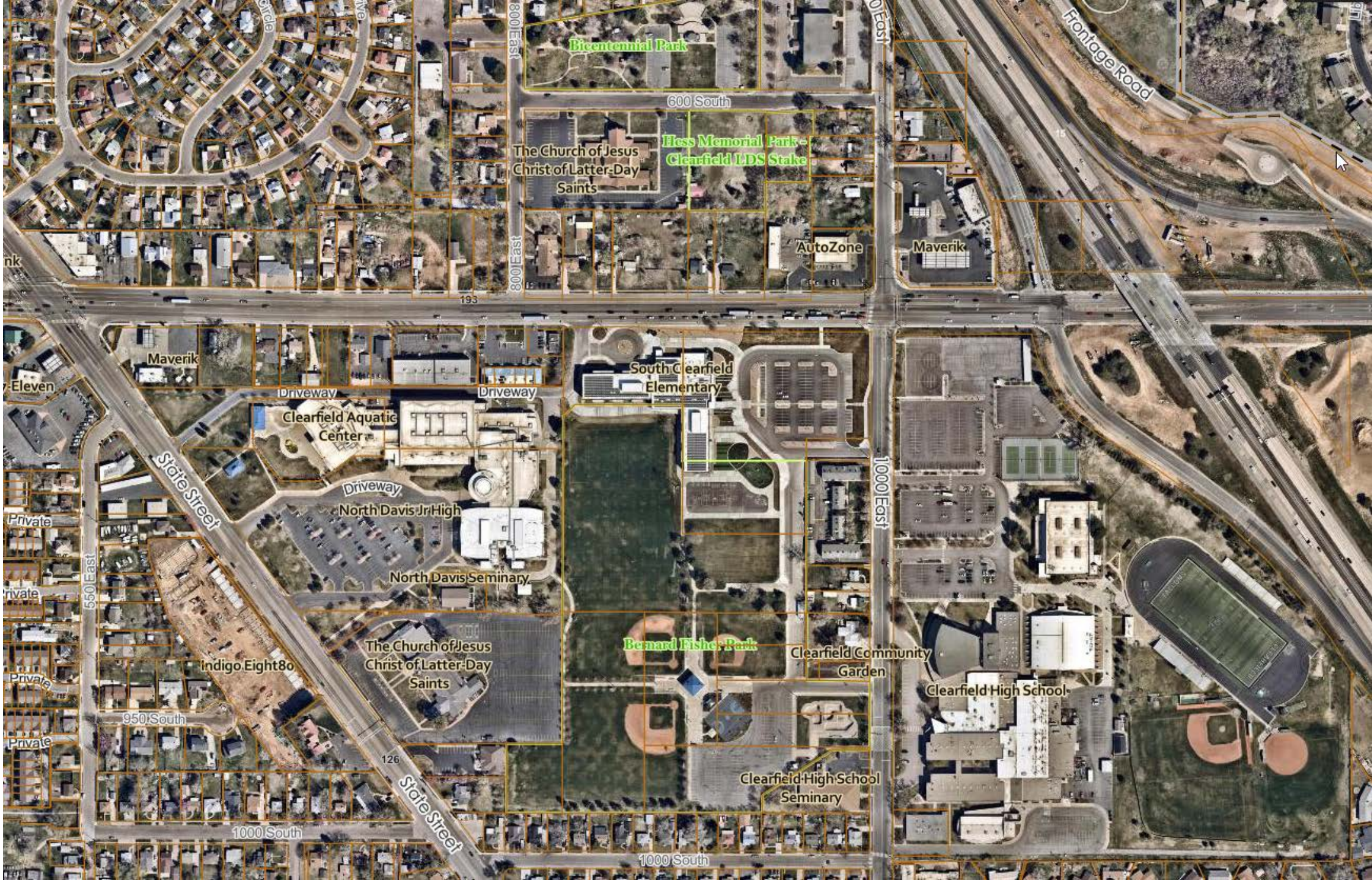



Clearfield High Reimagined

- *The City and DSD have an agreement to use each other's facilities if the owner is not in need of them.*
- *Each entity is the #2 priority when it comes to scheduling the other's facility.*
- *There is no charge for the use unless this would create increased cost to staffing due to being outside their normal hours of operation.*
- *This will impact our ability to rent fields to 3rd party entities.*

Clearfield High Reimagined

- *Parking/trash/vandalism at Fisher Park will most likely increase over the course of the project.*
- *We have a meeting April 16 with CHS to discuss possible impacts during the renovation*
 - *Discussion on facilities they will need for their extra-curricular activities (Athletics, Arts, etc.)*

Council Initiatives Update

- *Plane update - artists selected, 8/9 planes sold, invoices paid*
- *Downtown branding - logo final tweaks, website in the works, video creation in the works*
- *Need interview leads from council:*
 - *Residents that live in our new developments on the downtown corridor*
 - *Airmen & airwomen that live in our new developments on the downtown corridor*
 - *Businesses on the downtown corridor that are excited about the changes*
 - *Long-time residents in single-family homes that are excited about the changes*
 - *Long-time residents in single-family homes that have kids/family living in the new developments on the downtown corridor*